

Hayward 13 Miles

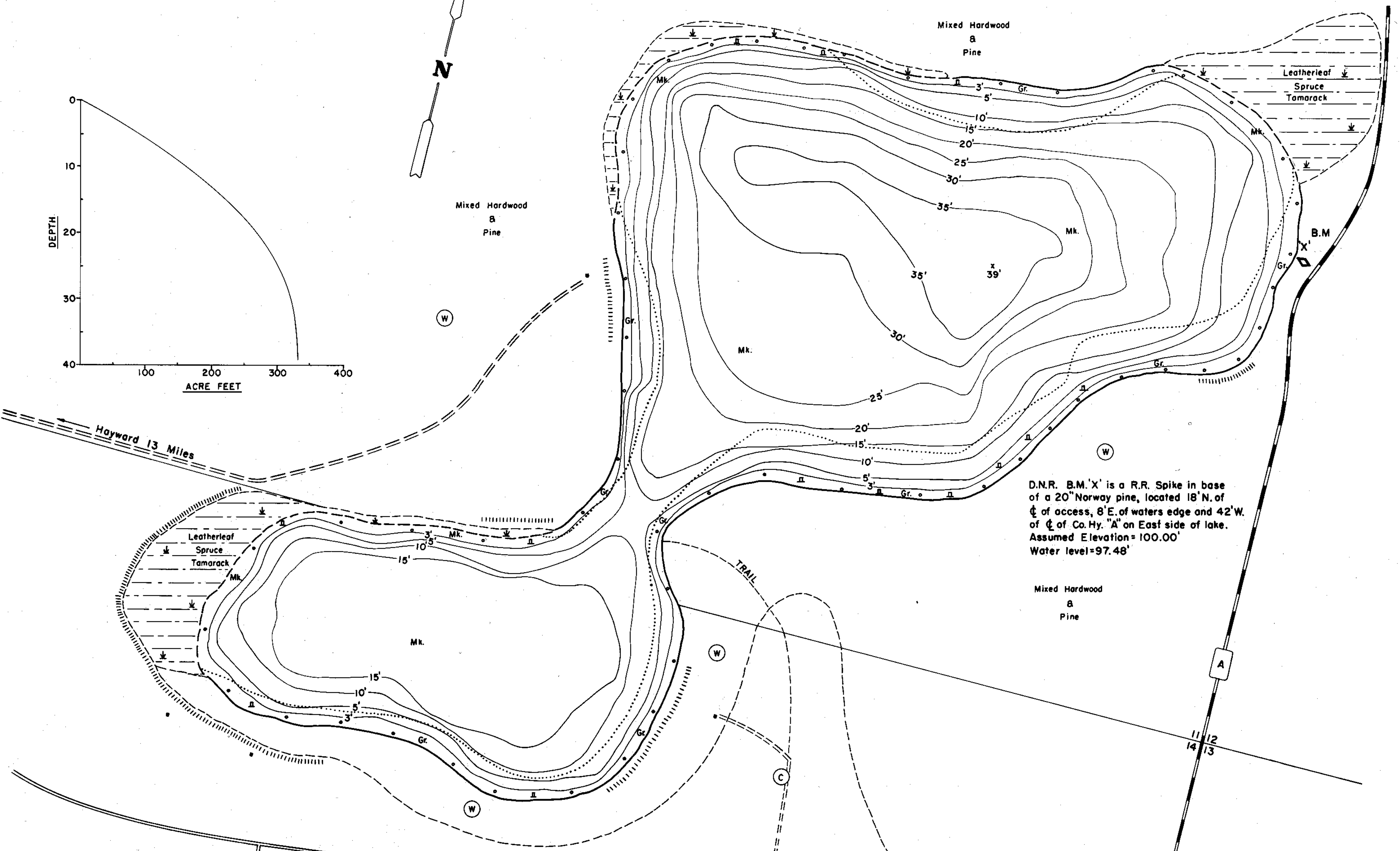

D.N.R. B.M. 'X' is a R.R. Spike in base of a 20" Norway pine, located 18' N. of center of access, 8' E. of waters edge and 42' W. of center of Co. Hy. "A" on East side of lake. Assumed Elevation = 100.00' Water level = 97.48'

EQUIPMENT RECORDING SONAR MAPPED JUNE 1973
MONTH YEAR

- | TOPOGRAPHIC SYMBOLS | | LAKE BOTTOM SYMBOLS | |
|-----------------------|----------------------------|---------------------|-----------------------------|
| (B) Brush | Steep slope | P. Peat | B Boulders |
| (PW) Partially wooded | - - - Indefinite shoreline | Mk. Muck | ⊙ Stumps & Snags |
| (W) Wooded | ⊙ Marsh | C. Clay | ⊙ Rock danger to navigation |
| (C) Cleared | ⊙ Spring | M. Marl | T Submergent vegetation |
| (P) Pastured | ⊙ Intermittent stream | Sd. Sand | I Emergent vegetation |
| (A) Agricultural | ⊙ Permanent inlet | St. Silt | ⊙ Floating vegetation |
| B.M. Bench Mark | ⊙ Permanent outlet | Gr. Gravel | ⊙ Brush shelters |
| ■ Dwelling | ⊙ Dam | R. Rubble | |
| ■ Resort | ⊙ D.N.R. State owned land | Br. Bedrock | |
| ■ Camp | | | |



Access Access with Parking Boat Livery
 Drawn by: G. Thuesen
 Field work by: C. Busch, K. Cable, L. Sather

SPECIES OF FISH	Abundance		
	Abundant	Common	Present
Muskie			
N. Pike			
Walleye			
L.M. Bass	X		
S.M. Bass			
Panfish	X		
Trout			

WATER AREA 18.86 ACRES
 UNDER 3 FT. 8 %
 OVER 20 FT. 36 %
 MAX. DEPTH 39 FEET.
 TOTAL ALK. 6 P.P.M.
 VOLUME 331.7 ACRE FT.
 MAIN SHORELINE .93 MI.
 ISLAND SHORELINE MI.

Source: Wisconsin Department of Natural Resources 608-266-2621
Currier Lake – Sawyer County, Wisconsin DNR Lake Map
Date – Jun 1973 - Historical Lake Map - Not for Navigation
A Public Document - Please Identify the Source when using it.