

3 Miles to Boulder Junction →

35 36 T. 42N R. 6E  
 2 1 T. 41N R. 6E

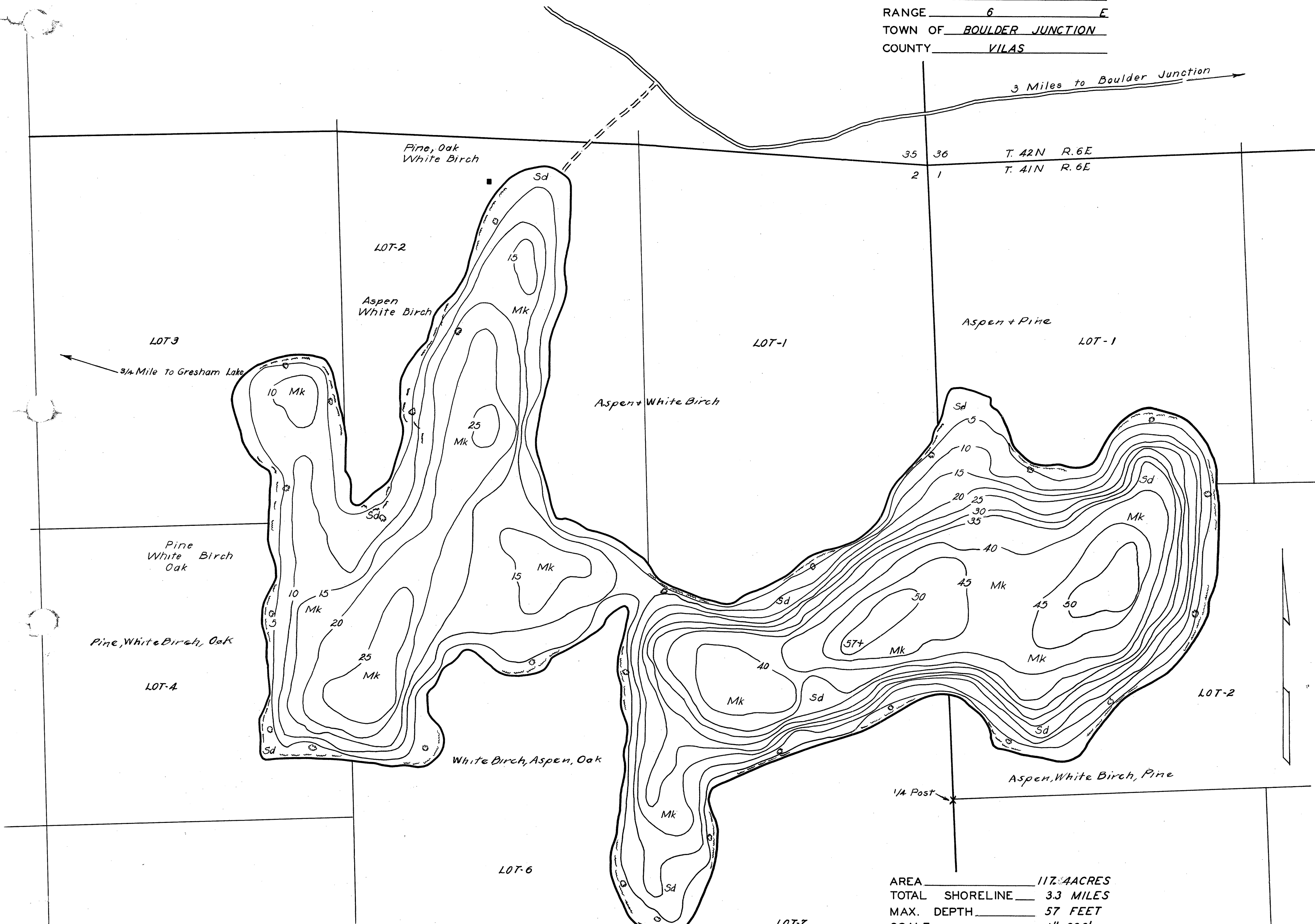

AREA 117.4 ACRES  
 TOTAL SHORELINE 3.3 MILES  
 MAX. DEPTH 57 FEET  
 SCALE 1" = 300'

DATE MAY 1941  
 COMPILED BY \_\_\_\_\_  
 TRACED BY B.W. CCC.  
 SOURCE OF INFORMATION CAMP CRYSTAL LAKE-LAKE SURVEY PROJECT AERIAL PHOTOGRAPH-FL II, B-9-39  
 SOUNDINGS 200' INTERVALS  
 DATES OF MAP REVISION \_\_\_\_\_  
 WORK AGENCY CCC

LAKE IMPROVEMENT RECORD

TYPE	DATE	1940	
⊕ BRUSH REFUGES	_____	<u>26</u>	_____
∞ SAPLING TANGLES	_____	<u>135</u>	_____
□ SPAWNING BOXES	_____	_____	_____
* MINNOW SPAWNERS	_____	_____	_____
TOTAL	_____	<u>161</u>	_____

- LEGEND
- ⊕ WEED BEDS
  - \* ROCKY SHOALS
  - Sd SAND
  - Cl CLAY
  - Gr GRAVEL
  - Mk MUCK
  - DWELLING
  - ABANDONED DWELLING
  - ▣ RESORT

Source: Wisconsin Department of Natural Resources 608-266-2621  
Day Lake – Vilas County, Wisconsin DNR Lake Map  
Date – May 1941 - Historical Lake Map - Not for Navigation .  
A Public Document - Please Identify the Source when using it.