

LAKE SURVEY MAP

LAKE FUR FARM
 SECTION 28-29
 TOWNSHIP 32 N
 RANGE 8 W
 TOWN OF SAMPSON
 COUNTY CHIPPEWA

FORM E-117

WISCONSIN CONSERVATION DEPARTMENT
 BIOLOGY DIVISION
 LAKE AND STREAM IMPROVEMENT SECTION

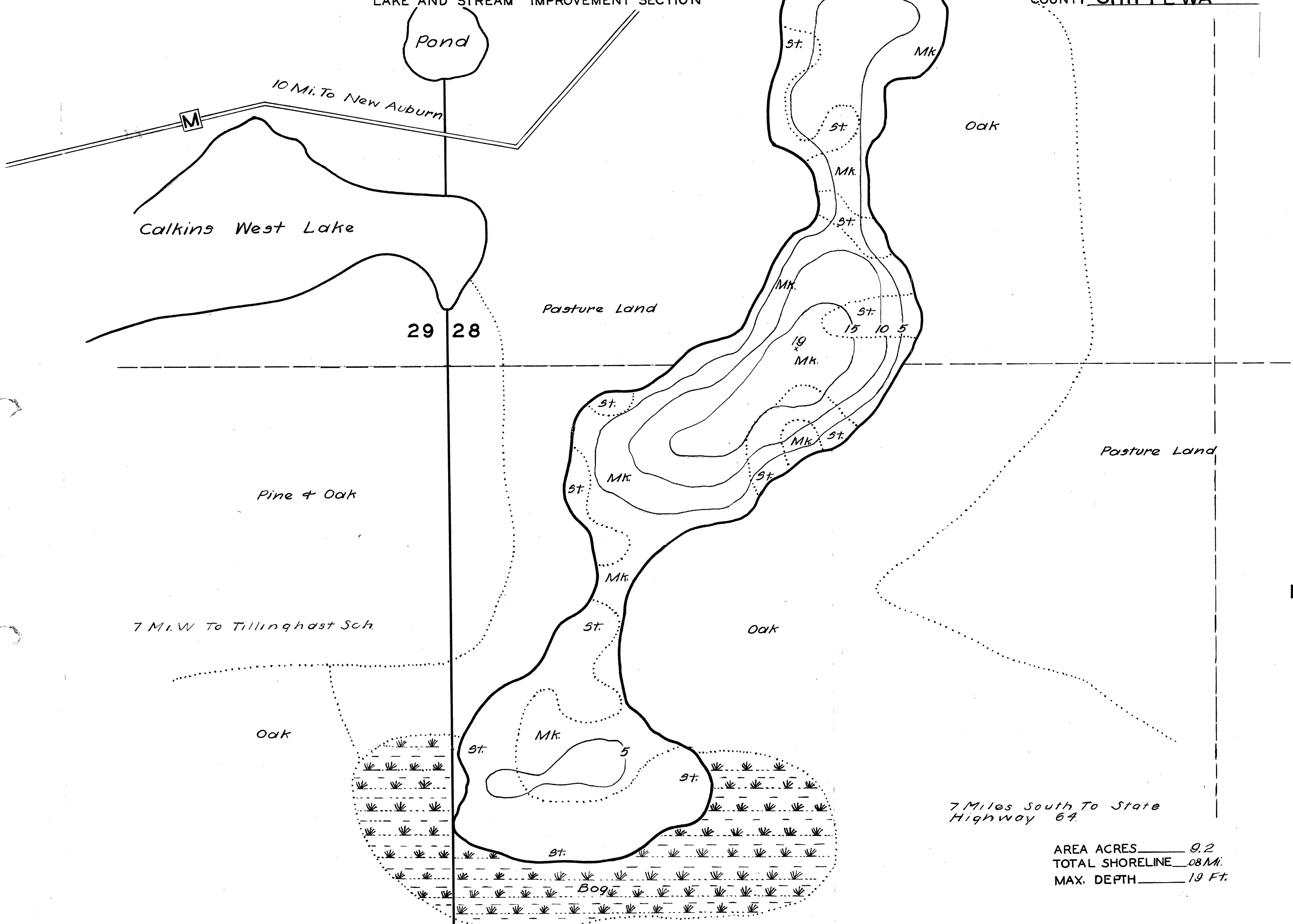

AREA ACRES 9.2
 TOTAL SHORELINE 0.8 Mi.
 MAX. DEPTH 19 Ft.

7 Miles South To State Highway 64.

DATE Feb 25 1941
 COMPILED BY _____
 TRACED BY W.R.S. (W.P.A.)
 SOURCE OF INFORMATION W.P.A. Survey Lake Project
 SOUNDINGS At 66' Intervals
 DATES OF MAP REVISION _____
 WORK AGENCY W. P. A.

CHECKED BY
 WRS - SA
 6-6-41

LAKE IMPROVEMENT RECORD			
TYPE	DATE		
BRUSH REFUGES			
SAPLING TANGLES			
SPAWNING BOXES			
MINNOW SPAWNERS			
TOTAL			

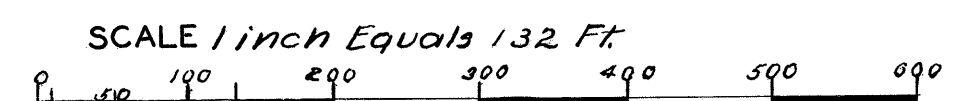

LEGEND	
	WEED BEDS
	ROCKY SHOALS
	SAND
	CLAY
	MUCK
	GRAVEL
	DWELLING
	ABANDONED DWELLING
	RESORT

Source: Wisconsin Department of Natural Resources 608-266-2621
Fur Farm Lake – Chippewa County, Wisconsin DNR Lake Map
Date – Feb 1941 - Historical Lake Map - Not for Navigation
A Public Document - Please Identify the Source when using it.