

# LAKE SURVEY MAP

WISCONSIN CONSERVATION DEPARTMENT  
BIOLOGY DIVISION  
LAKE AND STREAM IMPROVEMENT SECTION

LAKE PAYNE  
SECTION 30  
TOWNSHIP 32 N  
RANGE 8 W  
TOWN OF SAMPSON  
COUNTY CHIPPewa

FORM FH17

Lake Location  
S.W. 1/4 of N.W. 1/4  
Sec 30

SEC. 25  
SEC. 30

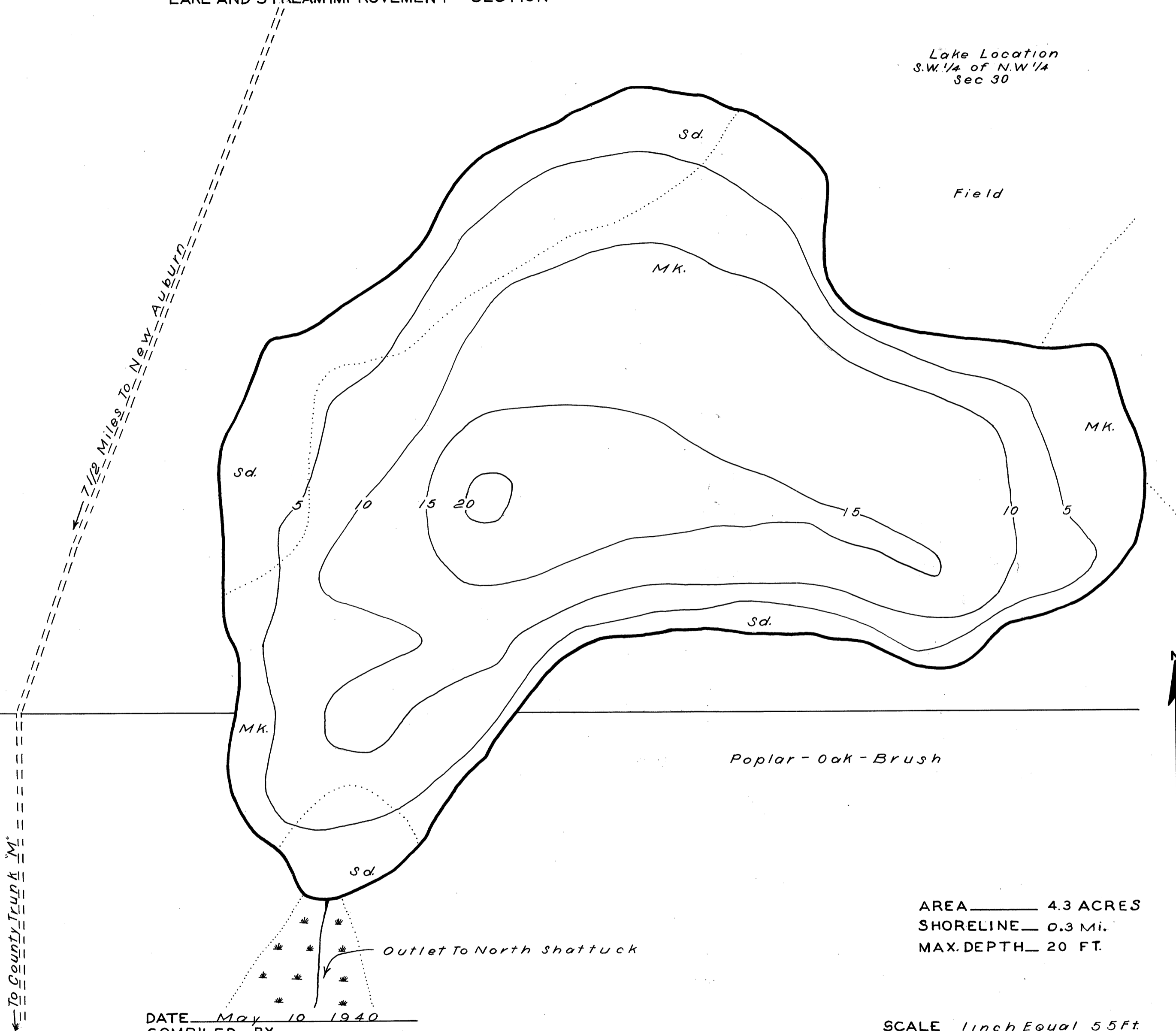

AREA 4.3 ACRES  
SHORELINE 0.3 Mi.  
MAX. DEPTH 20 FT.

DATE May 10 1940  
COMPILED BY \_\_\_\_\_  
TRACED BY R.C. (W.P.A.)  
SOURCE OF INFORMATION \_\_\_\_\_  
W.P.A. Lake Survey Project  
SOUNDINGS At 9.9 Ft Intervals  
DATES OF MAP REVISION \_\_\_\_\_  
April 1940  
WORK AGENCY W.P.A.  
CHECKED BY W.P.S.  
3-26-41

### LAKE IMPROVEMENT RECORD

TYPE	DATE			
Ø BRUSH REFUGES	_____	_____	_____	_____
~ SAPLING TANGLES	_____	_____	_____	_____
□ SPAWNING BOXES	_____	_____	_____	_____
* MINNOW SPAWNERS	_____	_____	_____	_____
TOTAL	_____	_____	_____	_____

SCALE 1 inch Equal 55 Ft.  
9 10 50 100 150 200

- LEGEND
- WEED BEDS
  - ⊘ ROCKY SHOALS
  - Sd. SAND
  - Cl. CLAY
  - Gr. GRAVEL
  - MK. MUCK
  - DWELLING
  - ABANDONED DWELLING
  - ▣ RESORT

Source: Wisconsin Department of Natural Resources 608-266-2621  
Payne Lake – Chippewa County, Wisconsin DNR Lake Map  
Date – Mar 1940 - Historical Lake Map - Not for Navigation  
A Public Document - Please Identify the Source when using it.