

LAKE SURVEY MAP

WISCONSIN CONSERVATION DEPARTMENT
BIOLOGY DIVISION
LAKE AND STREAM IMPROVEMENT SECTION

LAKE PICKEREL
SECTION 28-33
TOWNSHIP 32 N
RANGE 8 W
TOWN OF SAMPSON
COUNTY CHIPPEWA

FORM FI-117

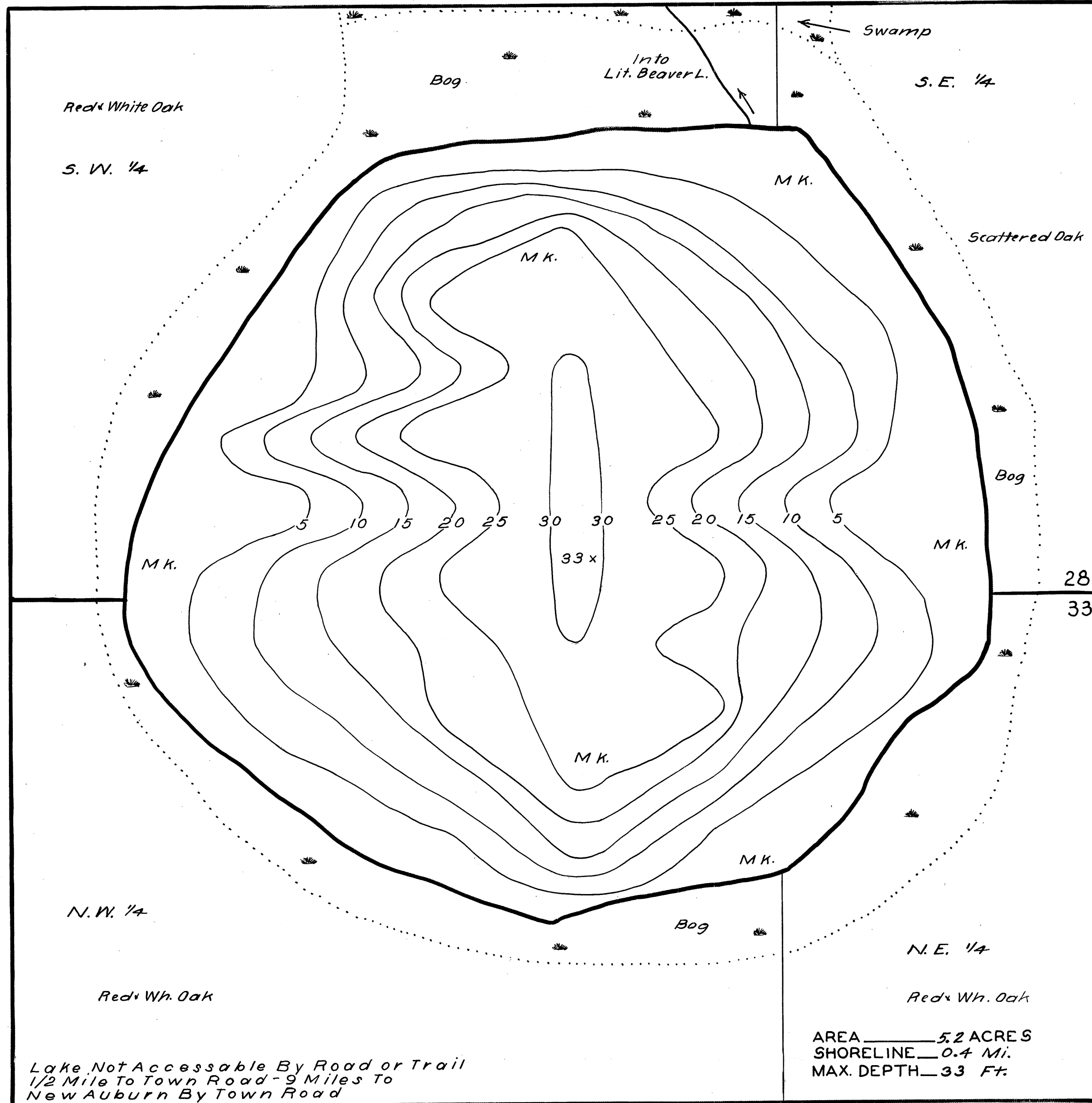

DATE February 14-1939
COMPILED BY H. H. Jr.
TRACED BY H. G. O.
SOURCE OF INFORMATION
W.P.A. Lake Survey Project
SOUNDINGS At 99 Ft. Intervals
DATES OF MAP REVISION
March 1940
WORK AGENCY W.P.A.
CHECKED BY W.P.S.
3-6-41

| LAKE IMPROVEMENT RECORD | | | |
|-------------------------|-------|-------|-------|
| TYPE | DATE | | |
| ⊙ BRUSH REFUGES | _____ | _____ | _____ |
| ~ SAPLING TANGLES | _____ | _____ | _____ |
| □ SPAWNING BOXES | _____ | _____ | _____ |
| * MINNOW SPAWNERS | _____ | _____ | _____ |
| TOTAL | _____ | _____ | _____ |

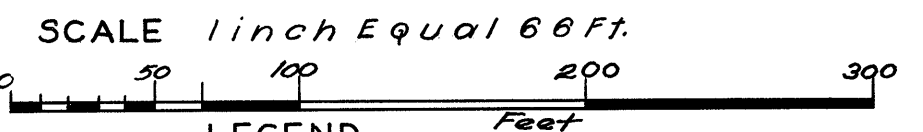

- LEGEND
- WEED BEDS
 - ROCKY SHOALS
 - sd SAND
 - cl CLAY
 - gr GRAVEL
 - MM MUCK
 - DWELLING
 - ABANDONED DWELLING
 - RESORT

Source: Wisconsin Department of Natural Resources 608-266-2621
Pickerel Lake – Chippewa County, Wisconsin DNR Lake Map
Date – Feb 1939 - Historical Lake Map - Not for Navigation
A Public Document - Please Identify the Source when using it.