

LAKE PRAIRIE  
 SECTIONS 27,34,2,3  
 TOWNSHIP T-33,34-N  
 RANGE R-10,11-W  
 TOWN STANLEY, PRAIRIE LAKE  
 COUNTY BARRON  
 Sheet 1 of 3

LEGEND

TOPOGRAPHIC SYMBOLS

- (B) Brush
- (PW) Partially wooded
- (W) Wooded
- (C) Cleared
- (P) Pastured
- (A) Agricultural
- B.M. Bench Mark
- Dwelling
- Resort
- ||||| Steep slope
- - - Indefinite shoreline
- ||||| Marsh
- Spring
- Intermittent stream
- Permanent inlet
- Permanent outlet
- Dam

LAKE BOTTOM SYMBOLS

- P. Peat
- Mk. Muck
- C. Clay
- M. Marl
- T. Submergent vegetation
- J. Emergent vegetation
- F. Floating vegetation
- Gr. Gravel
- R. Rubble
- Br. Bedrock
- Sd. Sand

SPECIES OF FISH

	Abundant	Common	Rare
Muskie			
N. Pike		X	
Walleye		X	
L.M. Bass		X	
S.M. Bass			X
Panfish	X		
Trout			

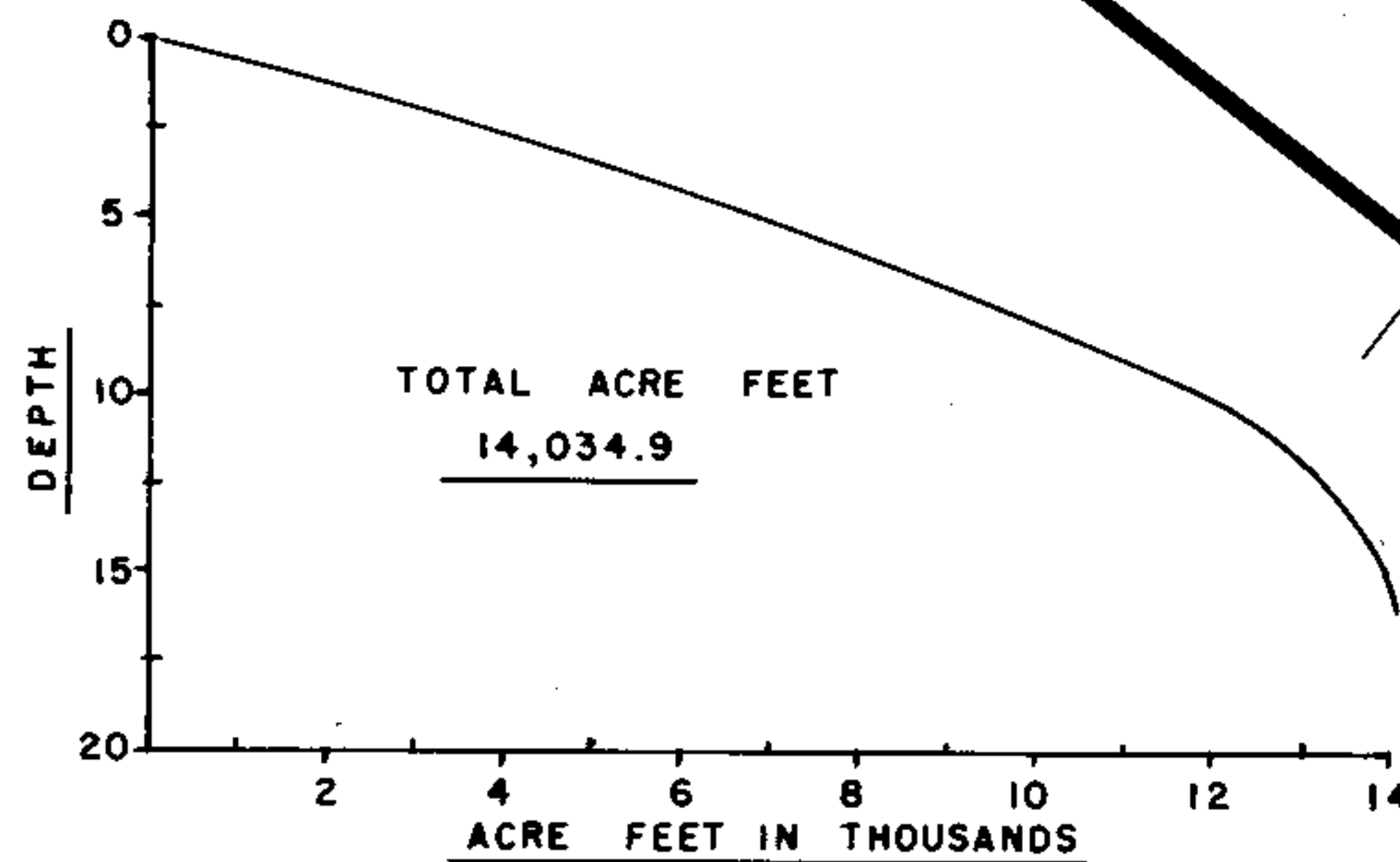
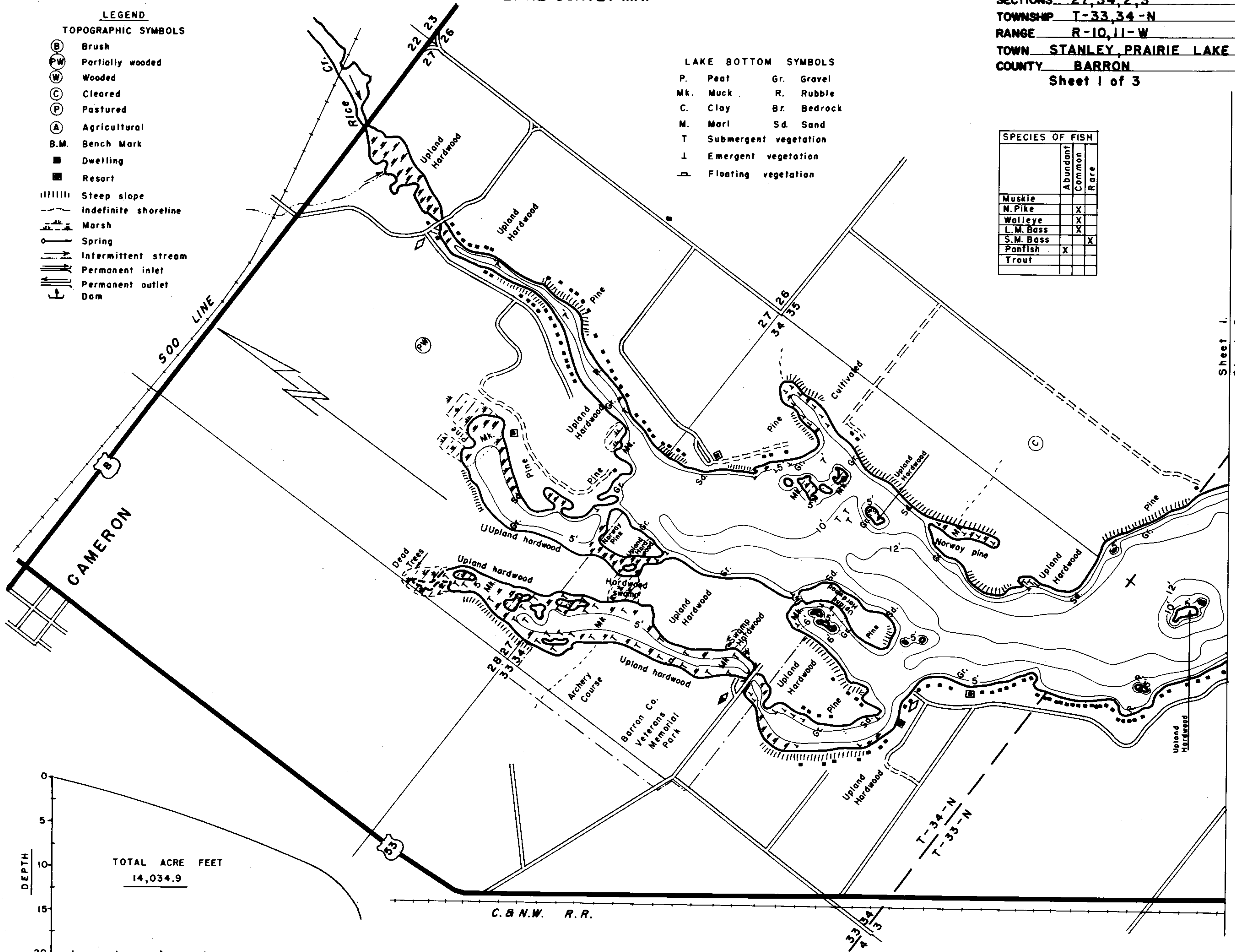

LAKE MAPPED AUGUST 1963  
 SOURCE OF INFORMATION W.C.D.  
 SOUNDINGS RECORDING SONAR  
 TOTAL ALK. 41 P.P.M.

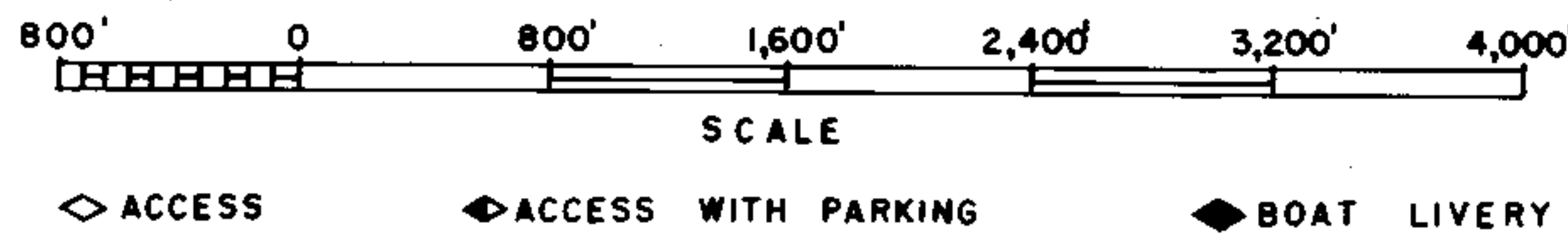

1,619.1 ACRES WITH ISLANDS  
 AREA 1,534.1 ACRES WITHOUT ISLANDS  
 TOTAL SHORELINE 25.4 MILES  
 MAX. DEPTH 16 FEET

Sheet 1.  
 Sheet 2.

LAKE PRAIRIE  
 SECTIONS 1, 2, 11, 12  
 TOWNSHIP T-33, 34-N  
 RANGE R-10, 11-W  
 TOWN STANLEY PRAIRIE  
 COUNTY BARRON  
 Sheet 2 of 3

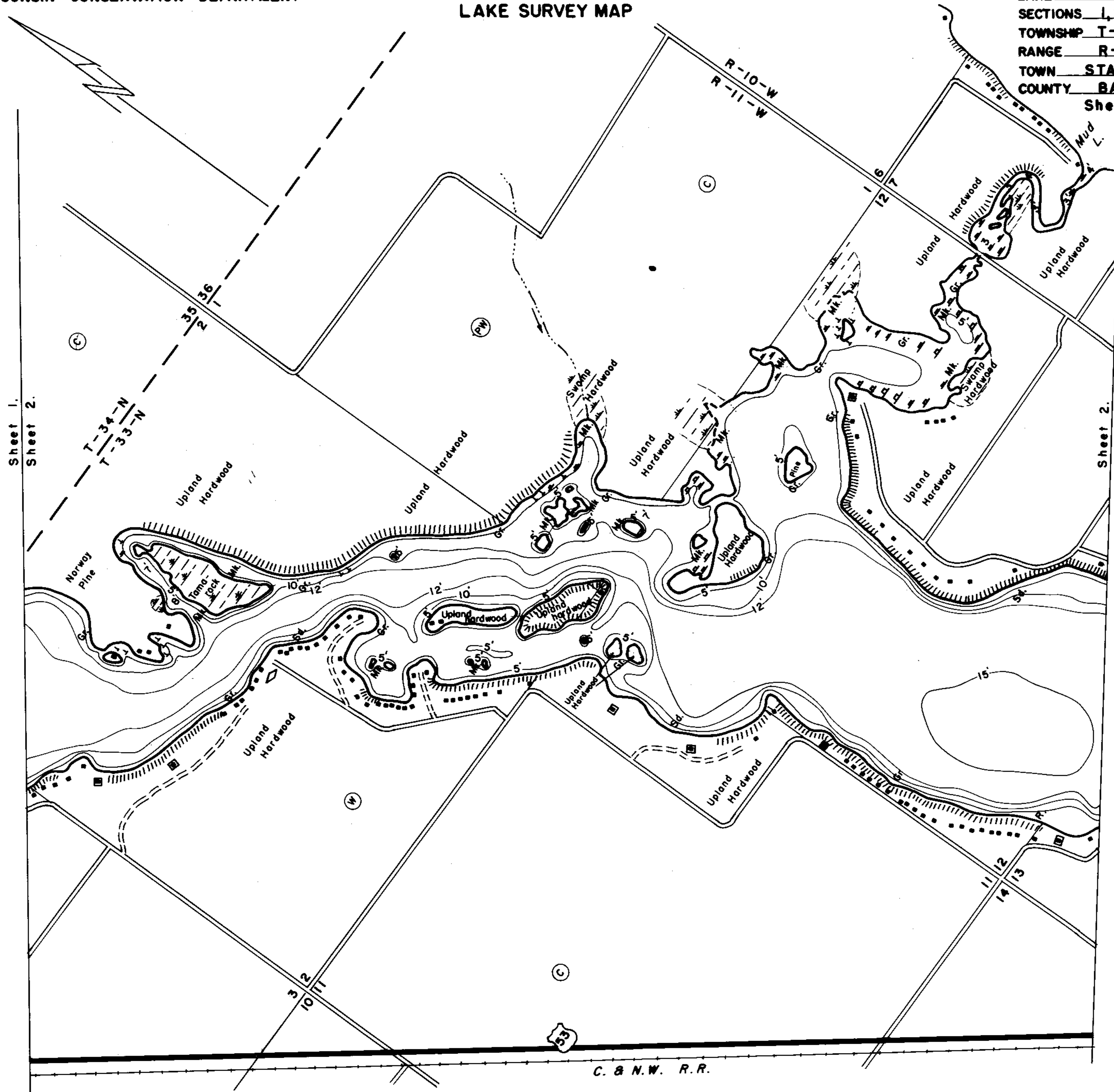

LAKE MAPPED AUGUST 1963  
 SOURCE OF INFORMATION W.C.D.  
 SOUNDINGS RECORDING SONAR  
 TOTAL ALK 41 P.P.M.

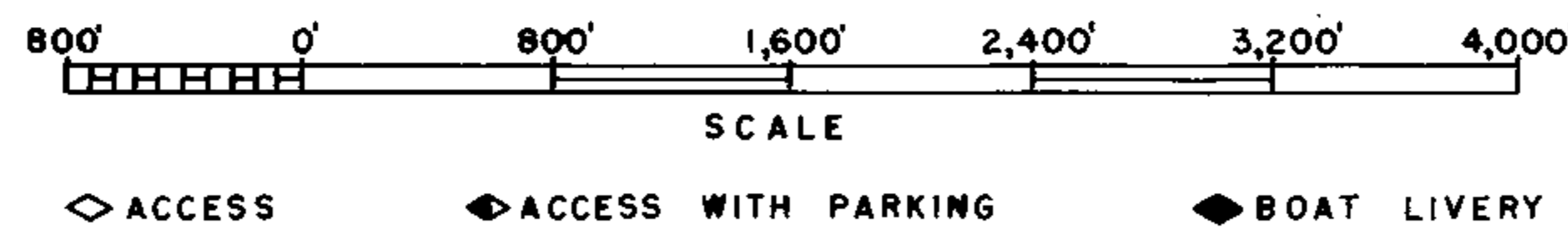

1,619.1 ACRES WITH ISLANDS  
 AREA 1,534.1 ACRES WITHOUT ISLANDS  
 TOTAL SHORELINE 25.4 MILES  
 MAX. DEPTH 16 FEET



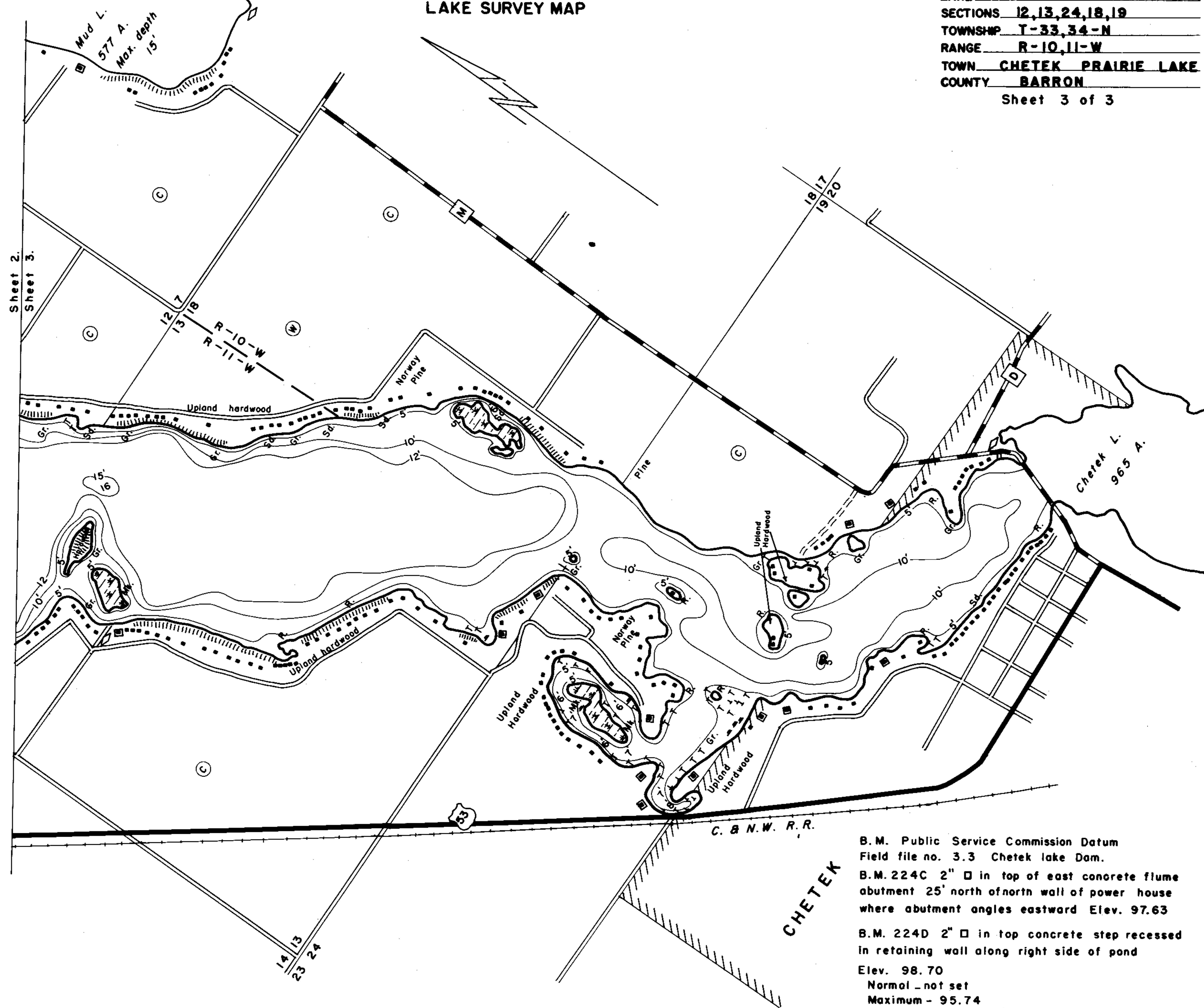

B.M. Public Service Commission Datum  
 Field file no. 3.3 Chetek lake Dam.  
 B.M. 224C 2" □ in top of east concrete flume  
 abutment 25' north of north wall of power house  
 where abutment angles eastward Elev. 97.63  
 B.M. 224D 2" □ in top concrete step recessed  
 in retaining wall along right side of pond  
 Elev. 98.70  
 Normal - not set  
 Maximum - 95.74  
 Minimum - 94.74

1,619.1 ACRES WITH ISLANDS  
 AREA 1,534.1 ACRES WITHOUT ISLANDS  
 TOTAL SHORELINE 25.4 MILES  
 MAX. DEPTH 16 FEET

Field work by: R. Hopke, E. Nelson  
 Drawn by: E. Eoten  
 LAKE MAPPED AUGUST 1963  
 SOURCE OF INFORMATION W.C.D.  
 SOUNDINGS RECORDING SONAR  
 TOTAL ALK. 41 P.P.M.

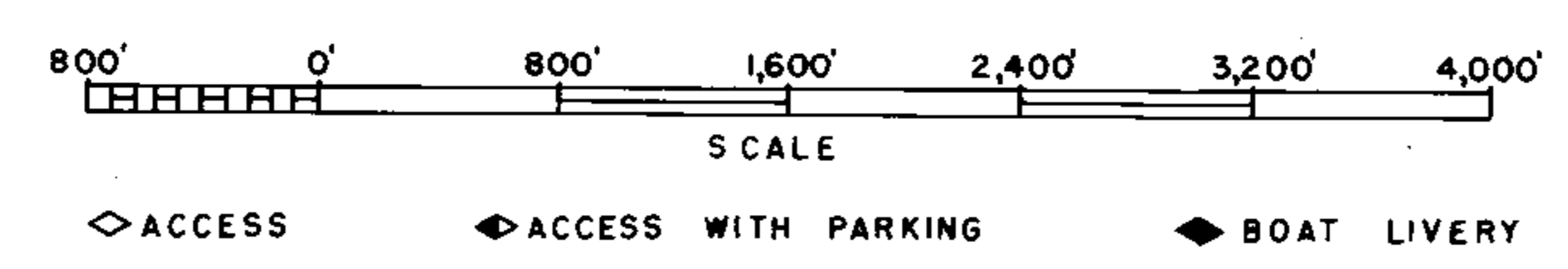

Source: Wisconsin Department of Natural Resources 608-266-2621  
Prairie Lake – Barron County, Wisconsin DNR Lake Map  
Date – Aug 1963 - Historical Lake Map - Not for Navigation  
A Public Document - Please Identify the Source when using it.