

LAKE SURVEY MAP

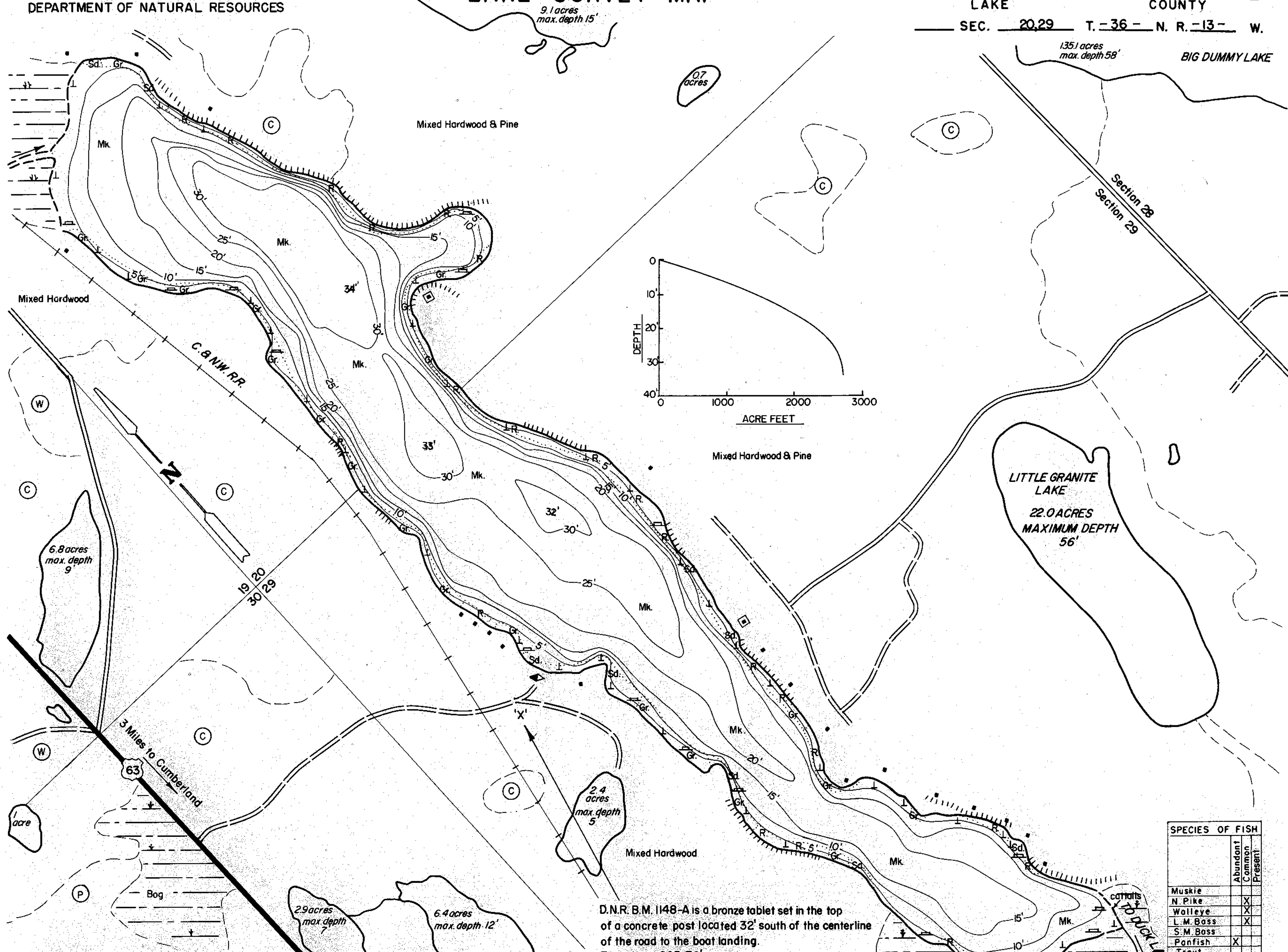

D.N.R. B.M. 1148-A is a bronze tablet set in the top of a concrete post located 32' south of the centerline of the road to the boat landing.
Elevation 1,263.78'
Water elevation 1,233.49'

SPECIES OF FISH		
	Abundant	Present
Muskie		
N. Pike	X	
Walleye	X	
L.M. Bass	X	
S.M. Bass		
Panfish	X	
Trout		

EQUIPMENT RECORDING SONAR MAPPED JUNE 1967
MO. YR.

- TOPOGRAPHIC SYMBOLS**
- (B) Brush
 - (PW) Partially wooded
 - (W) Wooded
 - (C) Cleared
 - (P) Pastured
 - (A) Agricultural
 - B.M. Bench Mark
 - Dwelling
 - Resort

- WATER ELEV. 1,233.49'**
- LAKE BOTTOM SYMBOLS**
- P. Peat
 - Mk. Muck
 - C. Clay
 - M. Marl
 - Sd. Sand
 - St. Silt
 - Gr. Gravel
 - R. Rubble
 - Br. Bedrock
 - T. Submergent vegetation
 - ↓ Emergent vegetation
 - Floating vegetation
 - ⊙ Stumps & Snags



◇ Access ◀ Access with Parking ◆ Boat Livery
Field work by: C. Busch, G. Winter, L. Sather Drawn by: J. Roth

AREA	153.69	ACRES
UNDER 3 FT.	6.6	%
OVER 20 FT.	41	%
VOLUME	2,722.91	ACRE FT.
TOTAL ALK.	25	P.P.M.
SHORELINE	3.4	MILES
MAX. DEPTH	34	FEET

Source: Wisconsin Department of Natural Resources 608-266-2621
Granite Lake – Barron County, Wisconsin DNR Lake Map
Date – Jun 1967 - Historical Lake Map - Not for Navigation
A Public Document - Please Identify the Source when using it.