

LAKE SURVEY MAP

LAKE ROBINSON
 SECTION 15-16
 TOWNSHIP 32 N
 RANGE 7 W
 TOWN OF BIRCH CREEK
 COUNTY CHIPPEWA

FORM F-117

WISCONSIN CONSERVATION DEPARTMENT
 BIOLOGY DIVISION
 LAKE AND STREAM IMPROVEMENT SECTION

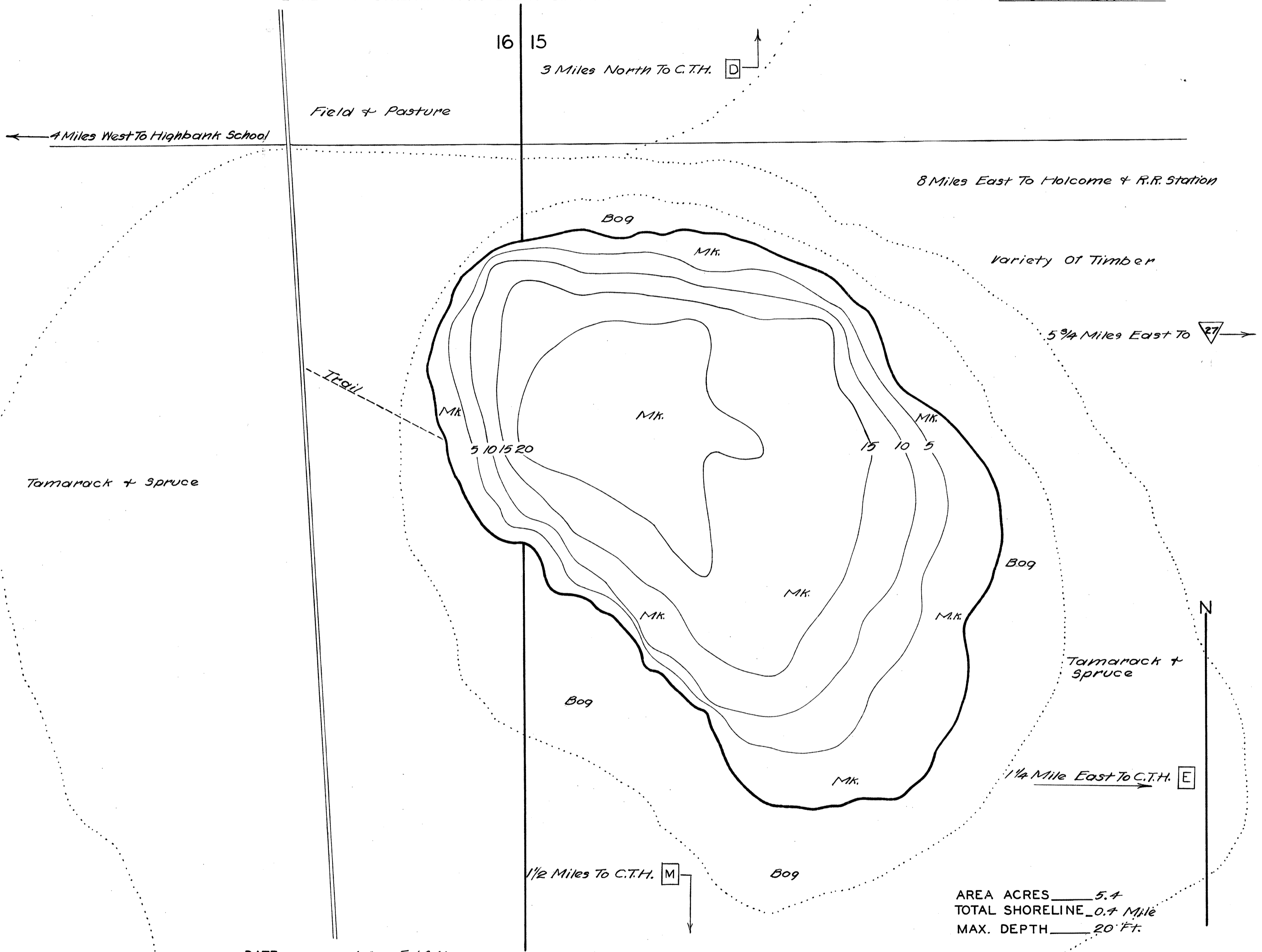

AREA ACRES 5.4
 TOTAL SHORELINE 0.7 Mile
 MAX. DEPTH 20 Ft.

SCALE 1 inch Equals 82.5 Ft.

DATE May 5 1941
 COMPILED BY _____
 TRACED BY W.R.S. (W.P.A.)
 SOURCE OF INFORMATION W.P.A. Lake Survey Project

 SOUNDINGS At 66 Ft. Intervals

 DATES OF MAP REVISION _____

 WORK AGENCY W. P. A.

CHECKED BY
 W.P.S.-E.M.K.
 6-13-41

LAKE IMPROVEMENT RECORD

| TYPE | DATE | | | | |
|-----------------|------|--|--|--|--|
| BRUSH REFUGES | | | | | |
| SAPLING TANGLES | | | | | |
| SPAWNING BOXES | | | | | |
| MINNOW SPAWNERS | | | | | |
| TOTAL | | | | | |

- LEGEND**
- WEED BEDS
 - ROCKY SHOALS
 - SAND
 - CLAY
 - GRAVEL
 - MUCK
 - DWELLING
 - ABANDONED DWELLING
 - RESORT

Source: Wisconsin Department of Natural Resources 608-266-2621
Robinson Lake – Chippewa County, Wisconsin DNR Lake Map
Date – May 1941 - Historical Lake Map - Not for Navigation
A Public Document - Please Identify the Source when using it.