

LAKE LADYSMITH FLOW  
 SECTIONS 25, 26, 34, 35  
 TOWNSHIP T 35 N  
 RANGE R 6 W  
 TOWN FLAMBEAU  
 COUNTY RUSK

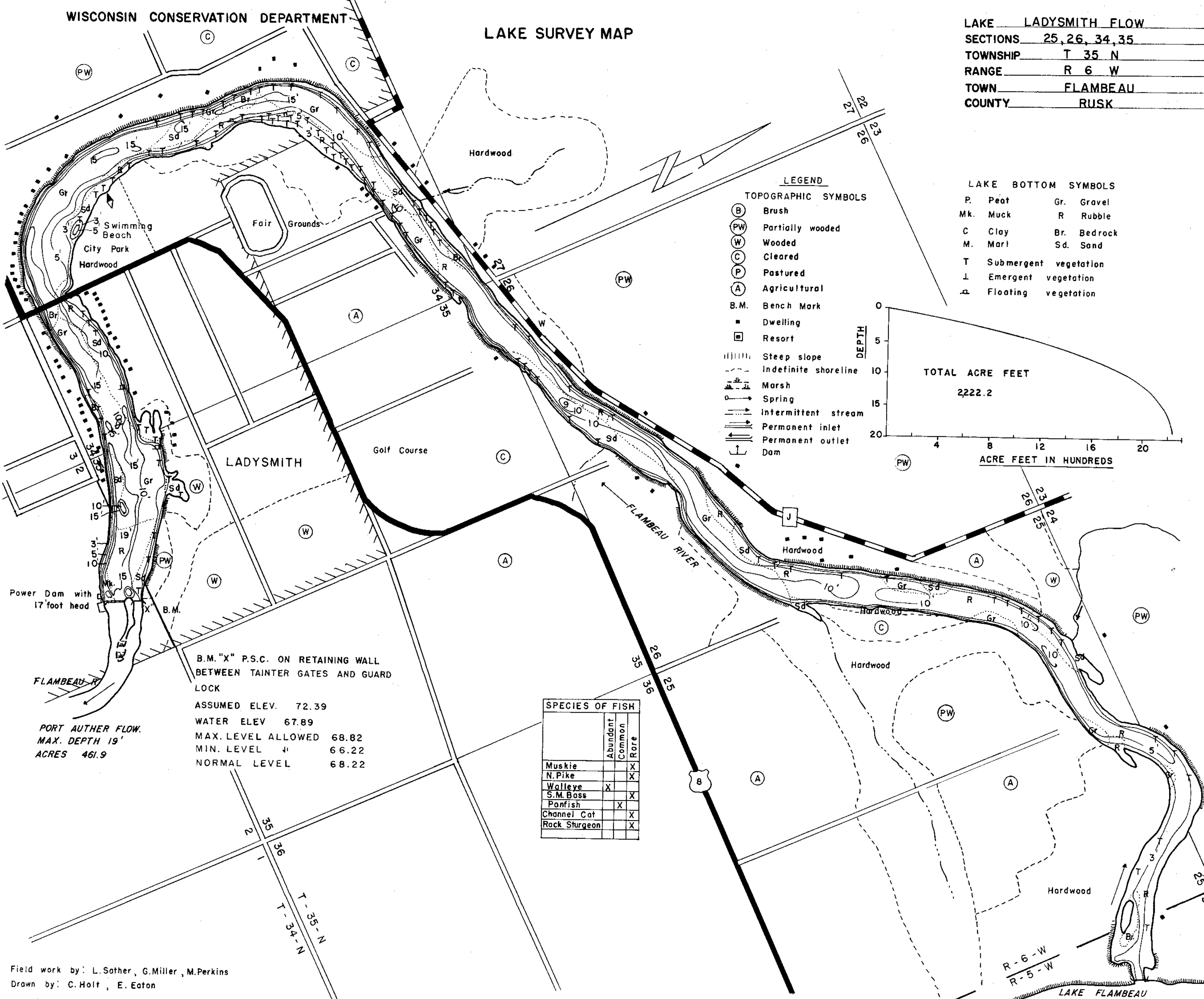

LEGEND

- TOPOGRAPHIC SYMBOLS
- (B) Brush
  - (PW) Partially wooded
  - (W) Wooded
  - (C) Cleared
  - (P) Pastured
  - (A) Agricultural
  - B.M. Bench Mark
  - Dwelling
  - Resort
  - |||| Steep slope
  - - - Indefinite shoreline
  - Marsh symbol
  - Spring symbol
  - Intermittent stream symbol
  - Permanent inlet symbol
  - Permanent outlet symbol
  - Dam symbol

LAKE BOTTOM SYMBOLS

- P. Peat
- Mk. Muck
- C. Clay
- M. Marl
- T. Submergent vegetation
- ⊥ Emergent vegetation
- △ Floating vegetation
- Gr. Gravel
- R. Rubble
- Br. Bedrock
- Sd. Sand

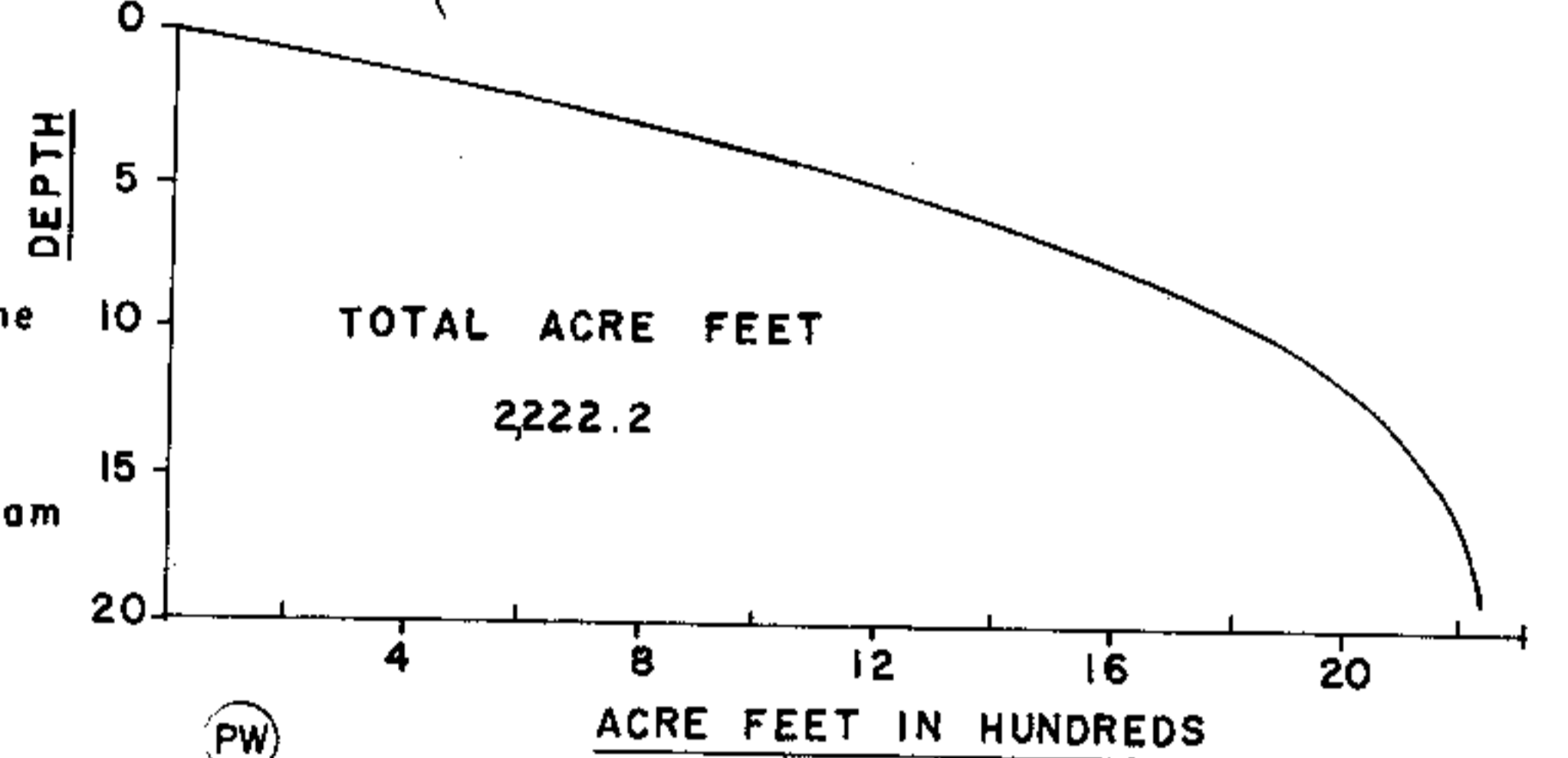

B.M. "X" P.S.C. ON RETAINING WALL  
 BETWEEN TAITER GATES AND GUARD  
 LOCK  
 ASSUMED ELEV. 72.39  
 WATER ELEV 67.89  
 MAX. LEVEL ALLOWED 68.82  
 MIN. LEVEL 66.22  
 NORMAL LEVEL 68.22

SPECIES OF FISH			
	Abundant	Common	Rare
Muskie			X
N. Pike			X
Walleye	X		
S.M. Bass	X		X
Panfish		X	
Channel Cat			X
Rock Sturgeon			X

PORT AUTHER FLOW.  
 MAX. DEPTH 19'  
 ACRES 461.9

LAKE FLAMBEAU  
 ACRES 1,743.9 70 Ft.

Field work by: L. Sather, G. Miller, M. Perkins  
 Drawn by: C. Holt, E. Eaton

LAKE MAPPED AUG 1965  
 SOURCE OF INFORMATION W.C.D.  
 SOUNDINGS SONAR  
 TOTAL ALK. 35 P.P.M.

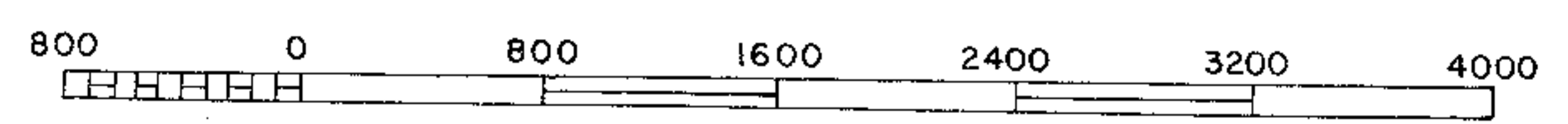

◇ ACCESS      ◀ ACCESS WITH PARKING      ● BOAT LIVERY

AREA 287.6 ACRES  
 TOTAL SHORELINE 10.4 MILES  
 MAX. DEPTH 19  
 UNDER 3' 20.8 % OVER 20' 0 %

Source: Wisconsin Department of Natural Resources 608-266-2621  
Ladysmith Flowage – Rusk County, Wisconsin DNR Lake Map  
Date – Aug 1965 - Historical Lake Map - Not for Navigation  
A Public Document - Please Identify the Source when using it.