

Sec. 29
Sec. 30

B.M. 'X' 1391-A Square cut in outcrop, 44' S. of lake, 14' E. of access.
Assumed elevation 100.00'
Water level 93.38'

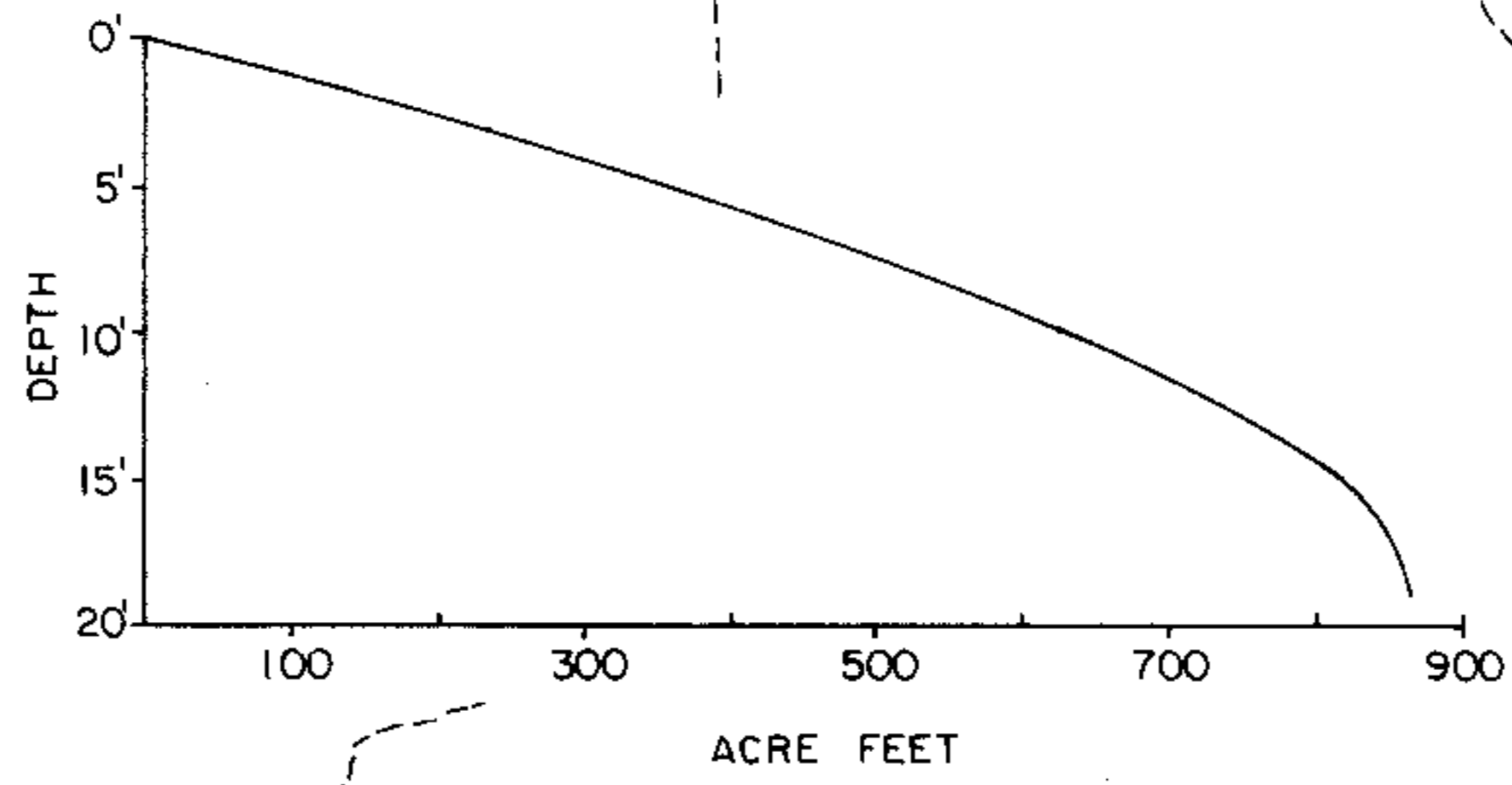
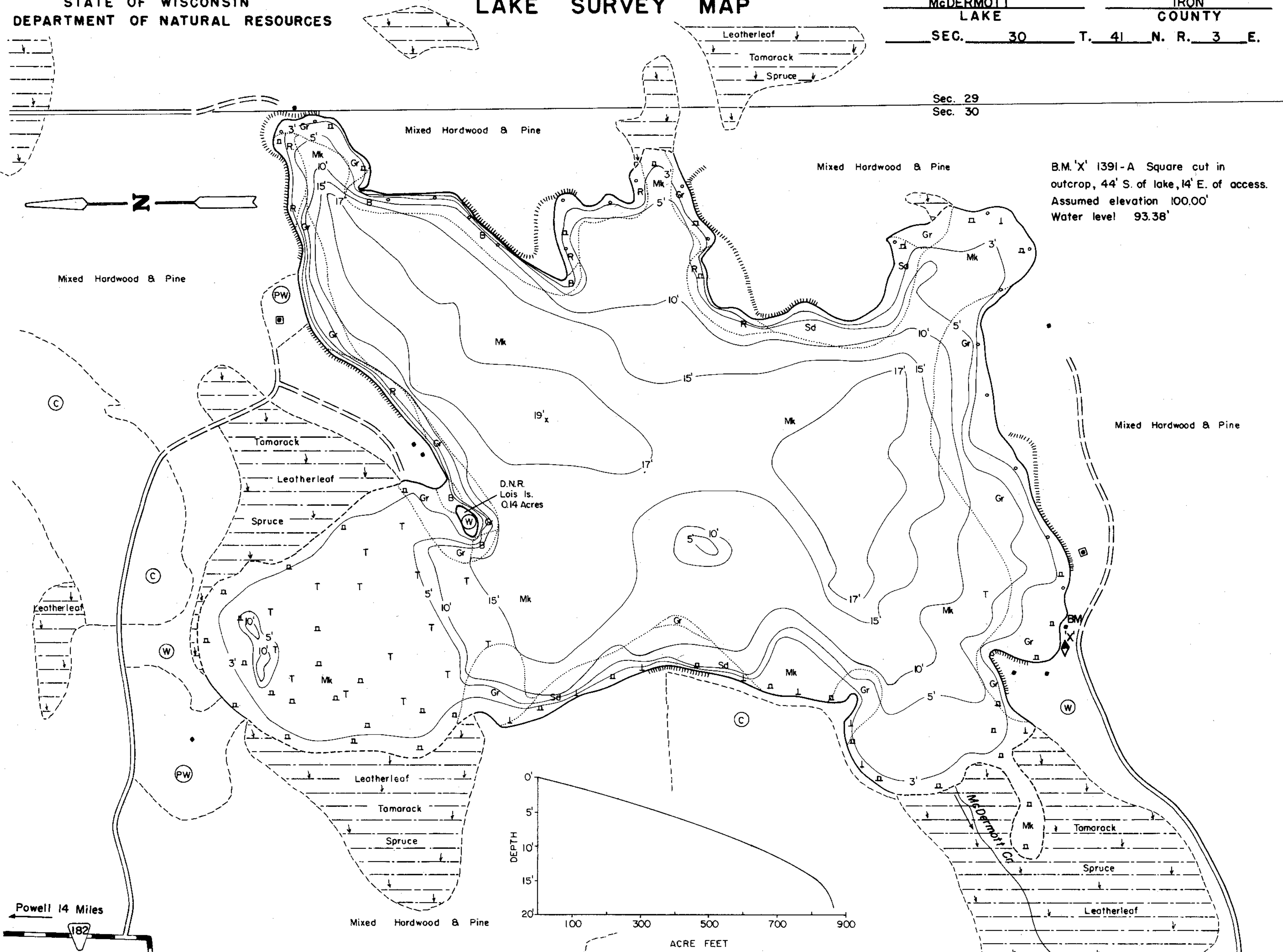

Powell 14 Miles
182

EQUIPMENT RECORDING SONAR MAPPED SEPT 1972

- TOPOGRAPHIC SYMBOLS
- (B) Brush
 - (PW) Partially wooded
 - (W) Wooded
 - (C) Cleared
 - (P) Pastured
 - (A) Agricultural
 - B.M. Bench Mark
 - Dwelling
 - Resort
 - ⊠ Camp
 - ||||| Steep slope
 - - - Indefinite shoreline
 - Marsh
 - Spring
 - Intermittent stream
 - Permanent inlet
 - Permanent outlet
 - Dam
 - D.N.R. State owned land

- LAKE BOTTOM SYMBOLS
- P. Peat
 - Mk. Muck
 - C. Clay
 - M. Marl
 - Sd. Sand
 - St. Silt
 - Gr. Gravel
 - R. Rubble
 - Br. Bedrock
 - B Boulders
 - ⊙ Stumps & Snags
 - ⊙ Rock danger to navigation
 - T Submergent vegetation
 - ↓ Emergent vegetation
 - ⊠ Floating vegetation
 - ⊠ Brush shelters



Access Access with Parking Boat Livery
 Drawn by: C. Holt
 Field work by: C. Busch, G. Lund, L. Sather

SPECIES OF FISH	Abundant Common Present		
	Abundant	Common	Present
Muskie		X	
N. Pike			X
Walleye			X
L.M. Bass	X		
S.M. Bass			
Panfish	X		
Trout			

WATER AREA 83.7 ACRES
 UNDER 3 FT. 11 %
 OVER 20 FT. 0 %
 MAX. DEPTH 19 FEET.
 TOTAL ALK. 38 P.P.M.
 VOLUME 865 ACRE FT.
 SHORELINE 2.52 MILES
 SHORELINE 2.59 MILES WITH IS.

Source: Wisconsin Department of Natural Resources 608-266-2621
McDermott Lake- Iron County, Wisconsin DNR Lake Map
Date: Sep 1972 - Historical Lake Map - Not for Navigation
A Public Document - Please Identify the Source when using it.