

# LAKE SURVEY MAP

LAKE TAMARACK LAKE  
 SECTION 17  
 TOWNSHIP 32 N  
 RANGE 8 W  
 TOWN OF SAMPSON  
 COUNTY CHIPPEWA

FORM F-117

WISCONSIN CONSERVATION DEPARTMENT  
 BIOLOGY DIVISION  
 LAKE AND STREAM IMPROVEMENT SECTION

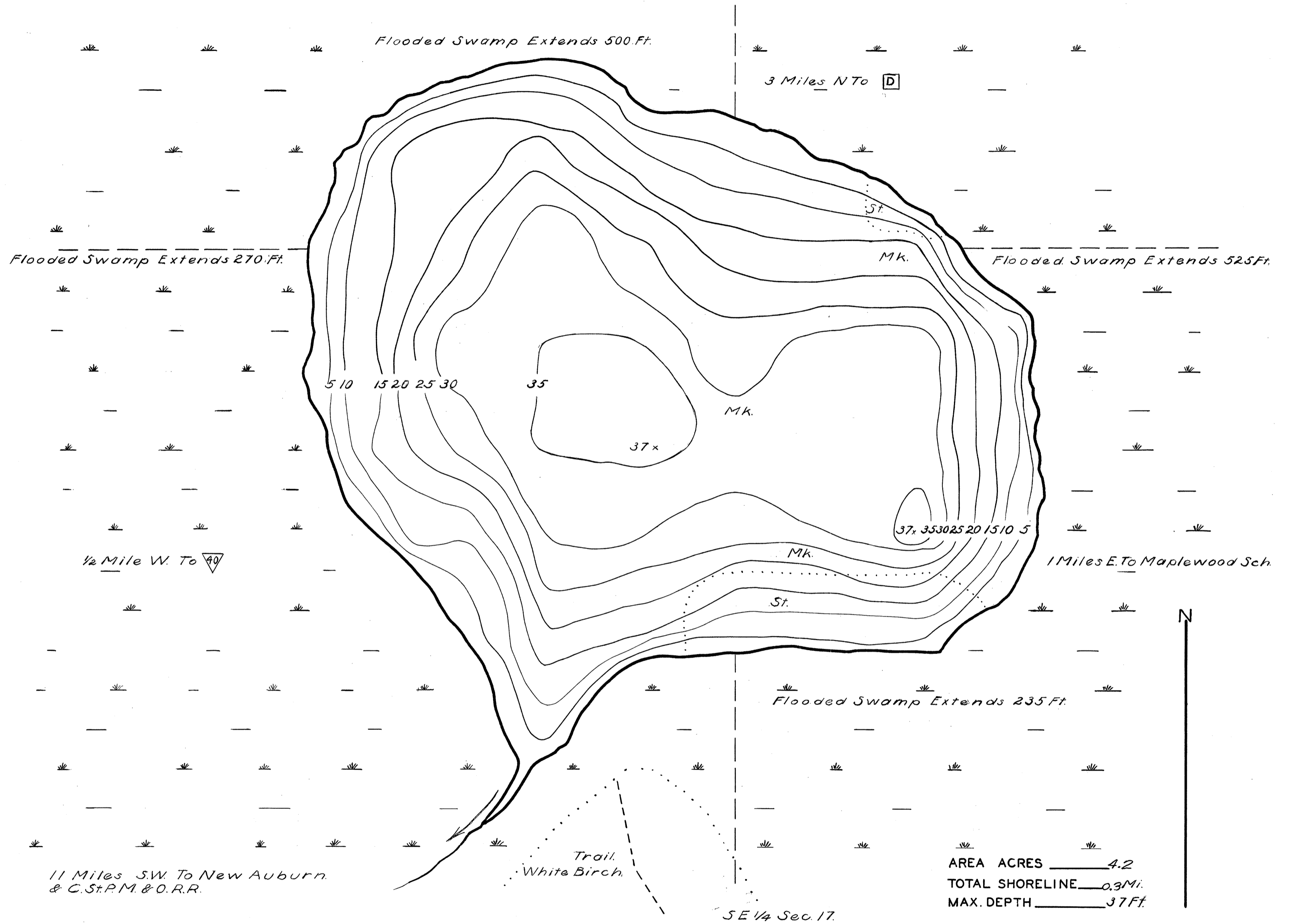

AREA ACRES 4.2  
 TOTAL SHORELINE 0.3 Mi.  
 MAX. DEPTH 37 Ft.



DATE April 18, 1941  
 COMPILED BY \_\_\_\_\_  
 TRACED BY NLM (WPA)  
 SOURCE OF INFORMATION \_\_\_\_\_  
WPA Lake Survey Project  
Jan 1941  
 SOUNDINGS At 66 Ft Intervals  
 \_\_\_\_\_  
 DATE OF MAP REVISION \_\_\_\_\_  
 \_\_\_\_\_  
 WORK AGENCY W. P. A.

CHECKED BY  
 W.P.S - E.M.G.  
 6-13-41

LAKE IMPROVEMENT RECORD			
TYPE	DATE	_____	_____
⊕ BRUSH REFUGES	_____	_____	_____
~ SAPLING TANGLES	_____	_____	_____
□ SPAWNING BOXES	_____	_____	_____
* MINNOW SPAWNERS	_____	_____	_____
TOTAL	_____	_____	_____

SCALE 1 inch Equals 55 Ft.

- LEGEND
- ⊕ WEED BEDS
  - ~ ROCKY SHOALS
  - Sd. SAND
  - Cl. CLAY
  - Gr. GRAVEL
  - Mk. MUCK
  - DWELLING
  - ABANDONED DWELLING
  - RESORT
  - St. SILT

Source: Wisconsin Department of Natural Resources 608-266-2621  
Tamarack Lake – Chippewa County, Wisconsin DNR Lake Map  
Date – Apr 1941 - Historical Lake Map - Not for Navigation  
A Public Document - Please Identify the Source when using it.