

LAKE SURVEY MAP

SAND LAKE RUSK CHIPPEWA COUNTY
SEC. 4, 33, 34 T. 32, 33 N. R. 8 W.

B.M. 'X' Railroad spike in the E. side of a 20" oak on the bank of lake 17' E. of outlet and 83' S.W. cottage on the N. side of lake.
Assumed elevation 100.00'
Water level 96.30'

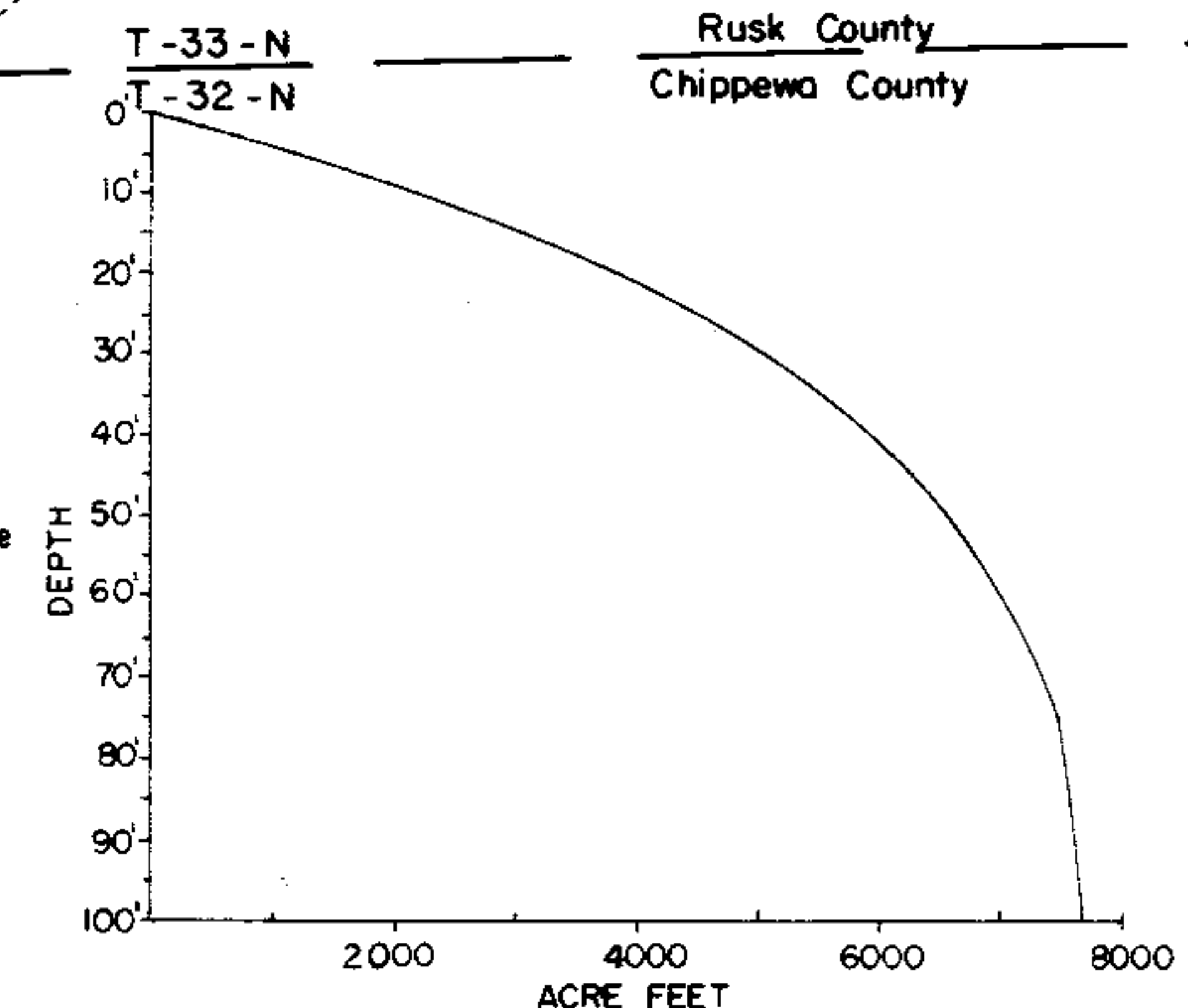
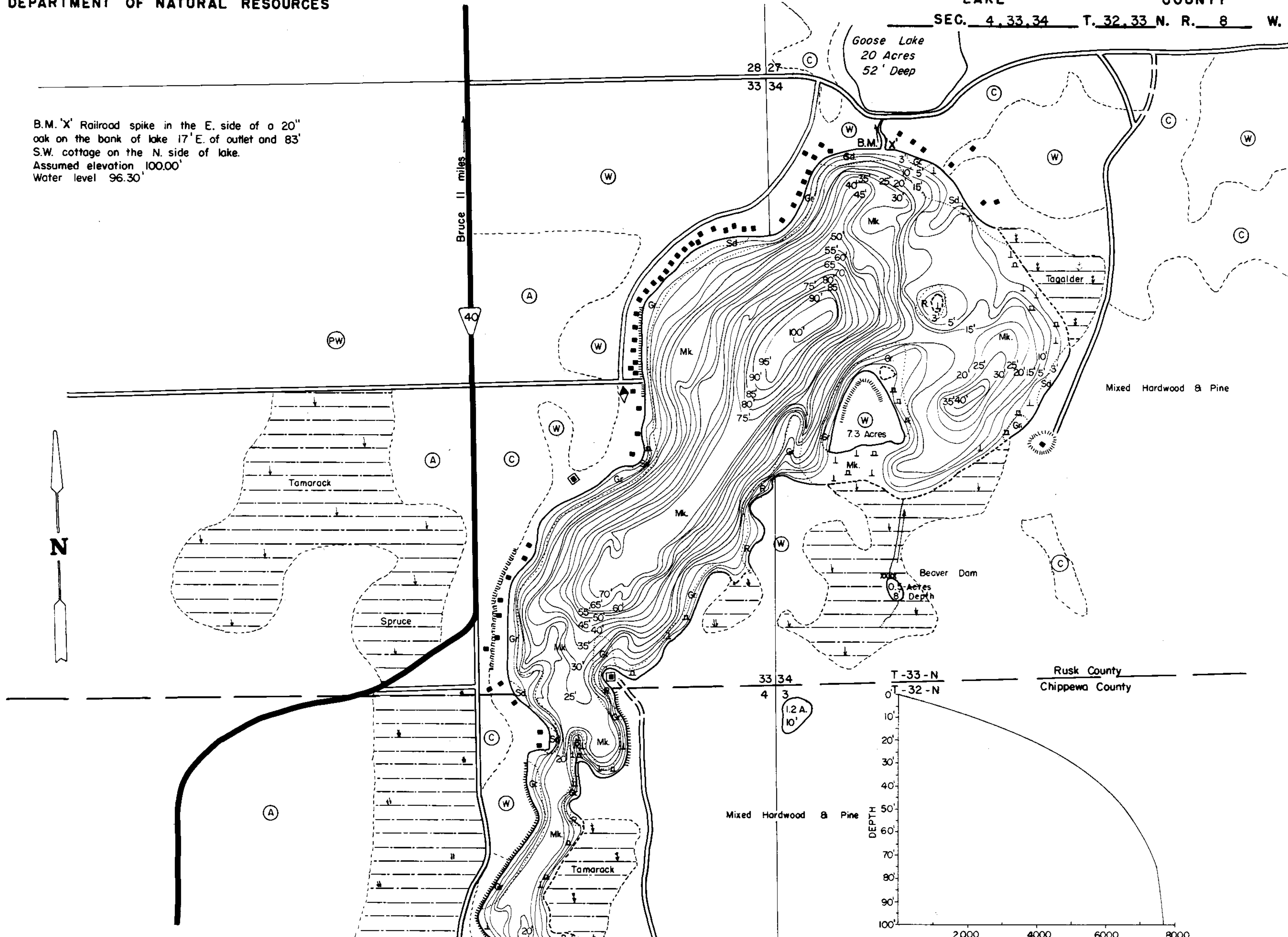

- EQUIPMENT RECORDING SONAR MAPPED JULY 1969
- | TOPOGRAPHIC SYMBOLS | | LAKE BOTTOM SYMBOLS | |
|-----------------------|-------------------------|---------------------|-----------------------------|
| (B) Brush | Steep slope | P. Peat | B Boulders |
| (PW) Partially wooded | ~ Indefinite shoreline | Mk. Muck | ⊙ Stumps & Snags |
| (W) Wooded | ~ Marsh | C. Clay | ⊙ Rock danger to navigation |
| (C) Cleared | ~ Spring | M. Marl | T Submergent vegetation |
| (P) Pastured | ~ Intermittent stream | Sd. Sand | ⊥ Emergent vegetation |
| (A) Agricultural | ~ Permanent inlet | St. Silt | ~ Floating vegetation |
| B.M. Bench Mark | ~ Permanent outlet | Gr. Gravel | ~ Brush shelters |
| ■ Dwelling | ~ Dam | R. Rubble | |
| □ Resort | D.N.R. State owned land | Br. Bedrock | |
| □ Camp | | | |

600' 0' 600' 1200' 1800' 2400'

SCALE

◆ Access ◆ Access with Parking ◆ Boat Livery

Drawn by: C. Holt
Field work by: C. Busch, C. Beller, S. Johannes

SPECIES OF FISH	ABUNDANCE		
	Abundant	Common	Present
Muskie	X		
N. Pike	X		
Walleye	X		
L. M. Bass	X		
S. M. Bass	X		
Panfish	X		
Trout			
Cisco			X

WATER AREA 261.9 ACRES
 UNDER 3 FT. 9 %
 OVER 20 FT. 52.5 %
 MAX. DEPTH 100 FEET.
 TOTAL ALK. 54 P.P.M.
 VOLUME 7,666.1 ACRE FT.
 SHORELINE 4.34 MILES
 SHORELINE 4.78 MILES WITH IS.

Source: Wisconsin Department of Natural Resources 608-266-2621
Sand Lake – Chippewa County, Wisconsin DNR Lake Map
Date – Jul 1969 - Historical Lake Map - Not for Navigation
A Public Document - Please Identify the Source when using it.