

LAKE SURVEY MAP

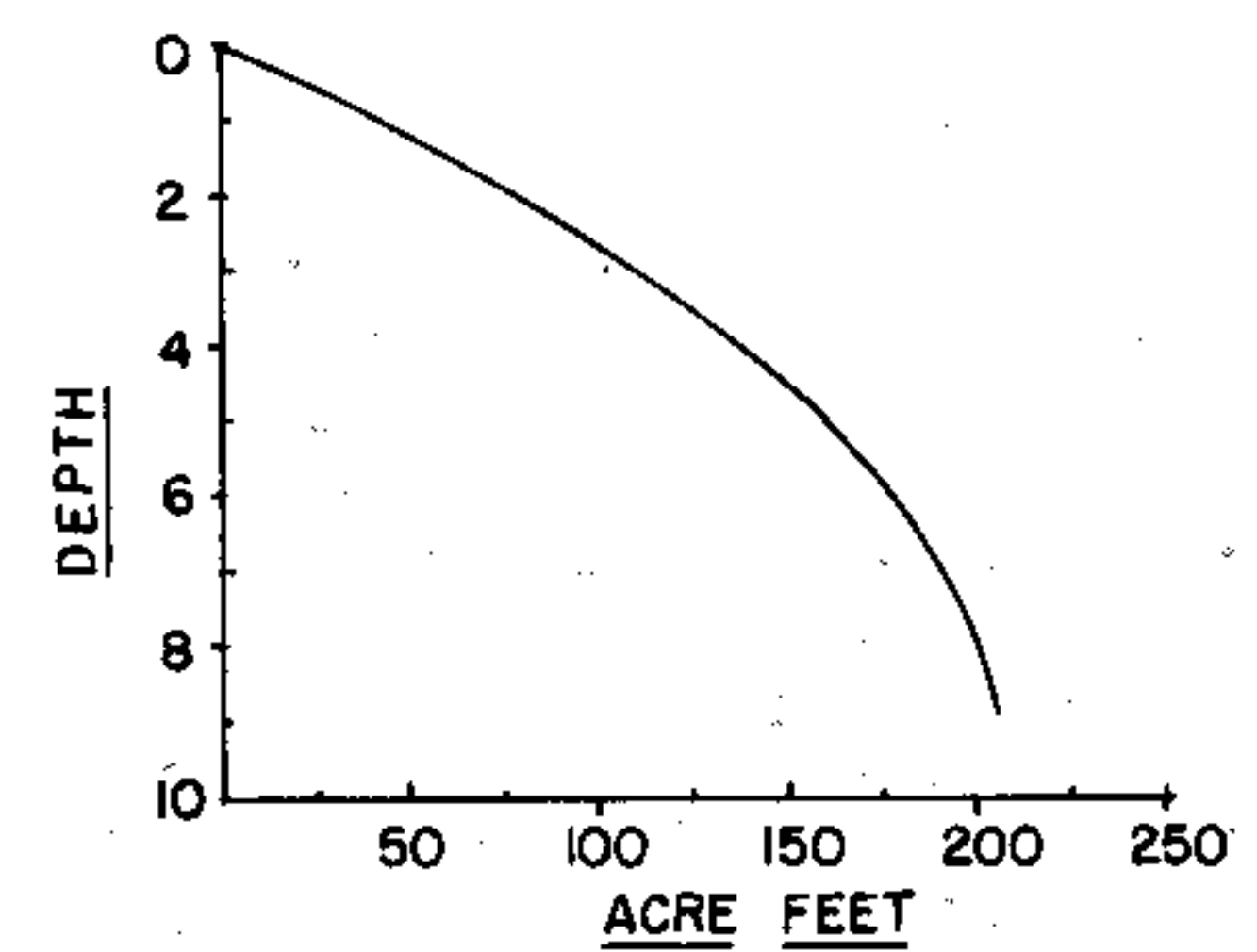

B.M. "X" is a railroad spike in the base of a 6" Birchtree located 18' W. of E of access trail and 150' N. of lake.
Assumed elevation = 100.00'
Water level = 97.95'

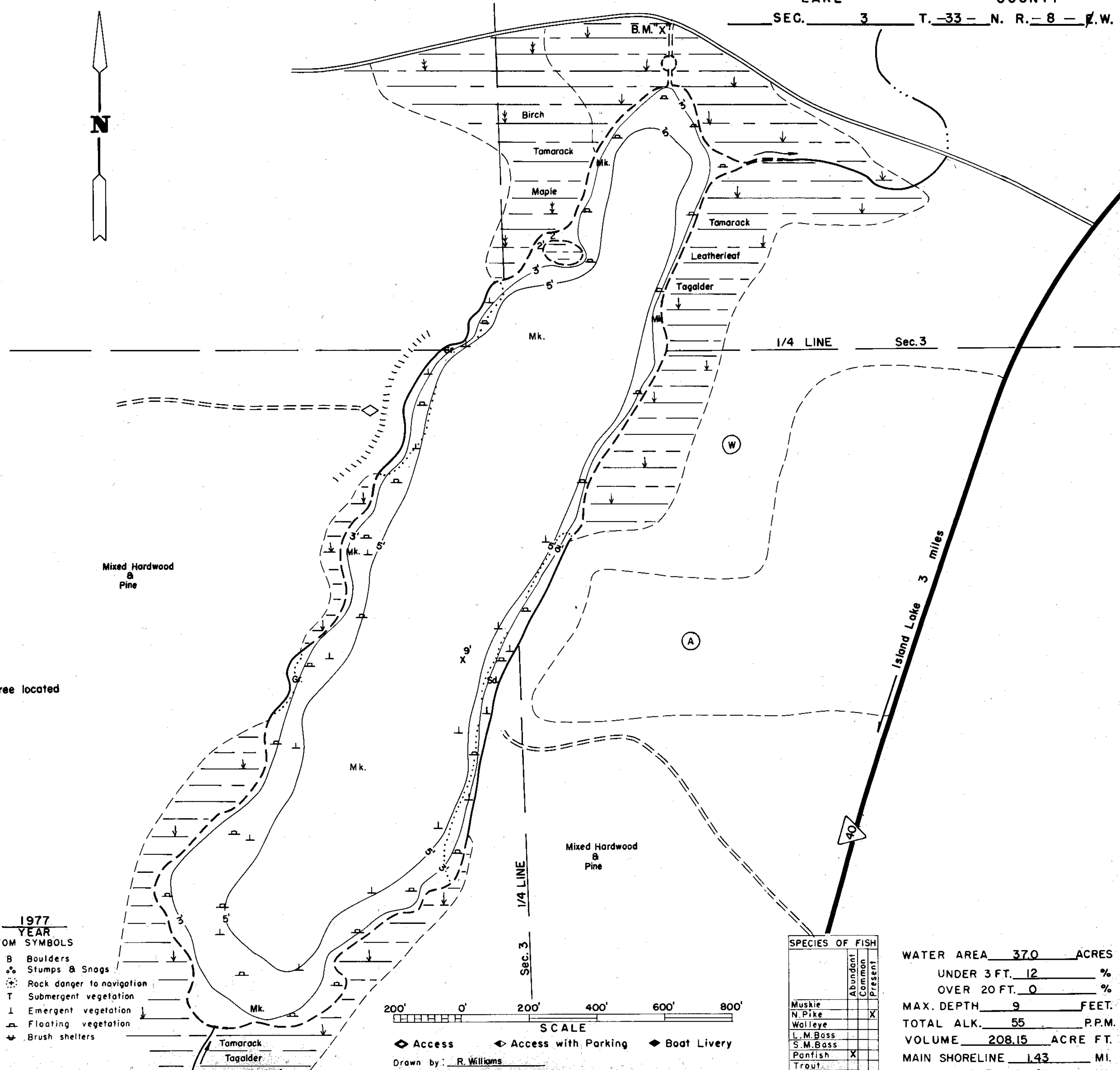

EQUIPMENT RECORDING SONAR MAPPED MAY 1977

- | TOPOGRAPHIC SYMBOLS | | LAKE BOTTOM SYMBOLS | |
|-----------------------|-------------------------|---------------------|-----------------------------|
| (B) Brush | Steep slope | P. Peat | B Boulders |
| (PW) Partially wooded | ~ Indefinite shoreline | Mk. Muck | o Stumps & Snags |
| (W) Wooded | ~ Marsh | C. Clay | o Rock danger to navigation |
| (C) Cleared | o Spring | M. Marl | T Submergent vegetation |
| (P) Pastured | ~ Intermittent stream | Sd. Sand | ⊥ Emergent vegetation |
| (A) Agricultural | ~ Permanent inlet | St. Silt | ~ Floating vegetation |
| B.M. Bench Mark | ~ Permanent outlet | Gr. Gravel | ~ Brush shelters |
| ■ Dwelling | ~ Dam | R. Rubble | |
| □ Resort | D.N.R. State owned land | Br. Bedrock | |



Access Access with Parking Boat Livery

Drawn by: R. Williams
Field work by: C. Beech, K. Cable, J. Sather

SPECIES OF FISH	Abundance	
	Abundant	Common
Muskie		
N. Pike		X
Walleye		
L.M. Bass		
S.M. Bass		
Panfish	X	
Trout		

WATER AREA 370 ACRES
 UNDER 3 FT. 12 %
 OVER 20 FT. 0 %
 MAX. DEPTH 9 FEET
 TOTAL ALK. 55 P.P.M.
 VOLUME 208.15 ACRE FT.
 MAIN SHORELINE 1.43 MI.
 ISLAND SHORELINE 0 MI.

Source: Wisconsin Department of Natural Resources 608-266-2621
Bog Lake – Rusk County, Wisconsin DNR Lake Map
Date – May 1977 - Historical Lake Map - Not for Navigation
A Public Document - Please Identify the Source when using it.