

B.M. 'X' Railroad spike in base of light pole in front of the Sunrise Point Resort on the N.W. side of the lake off the access road  
Assumed elevation 100.00'  
Water level 97.86'

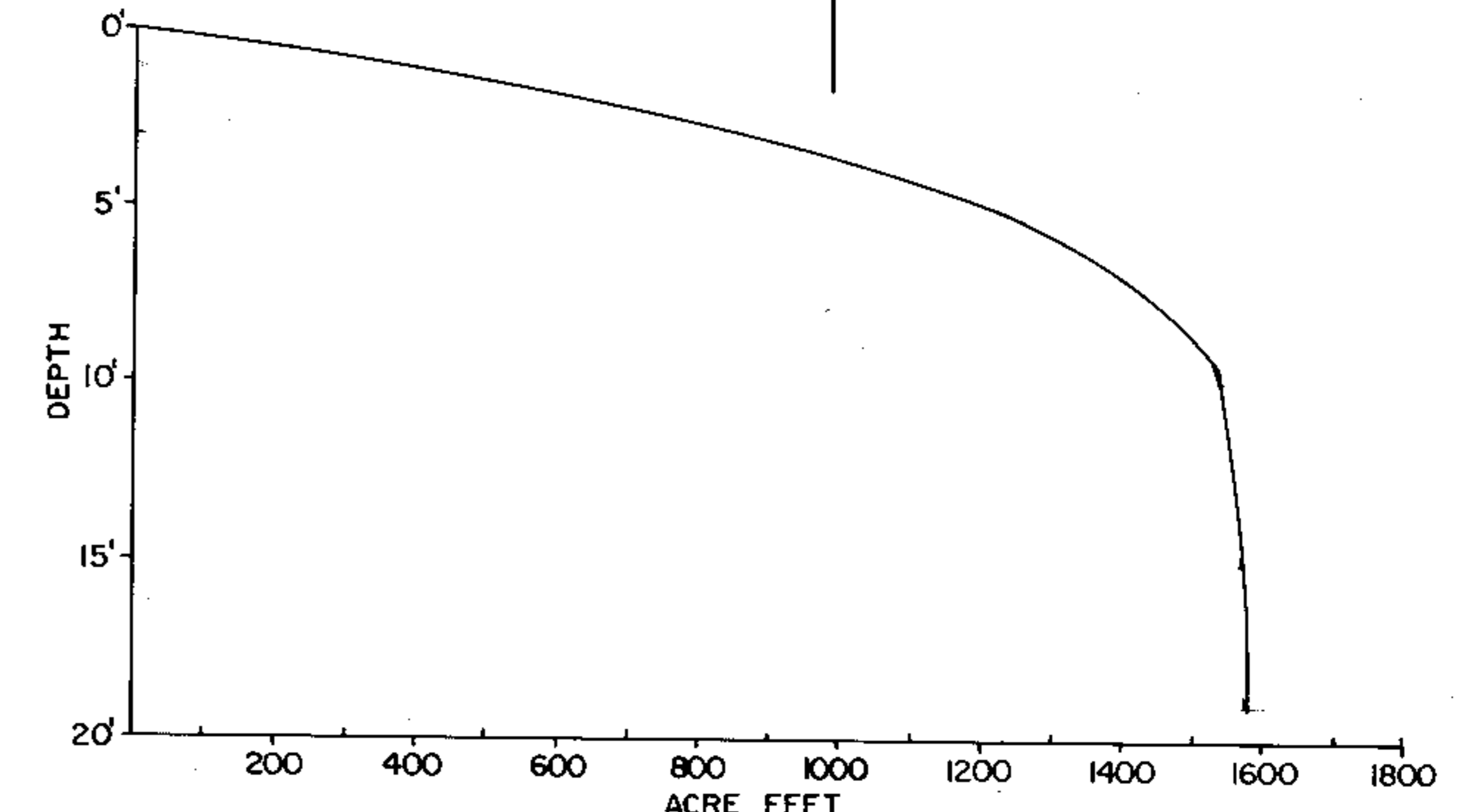
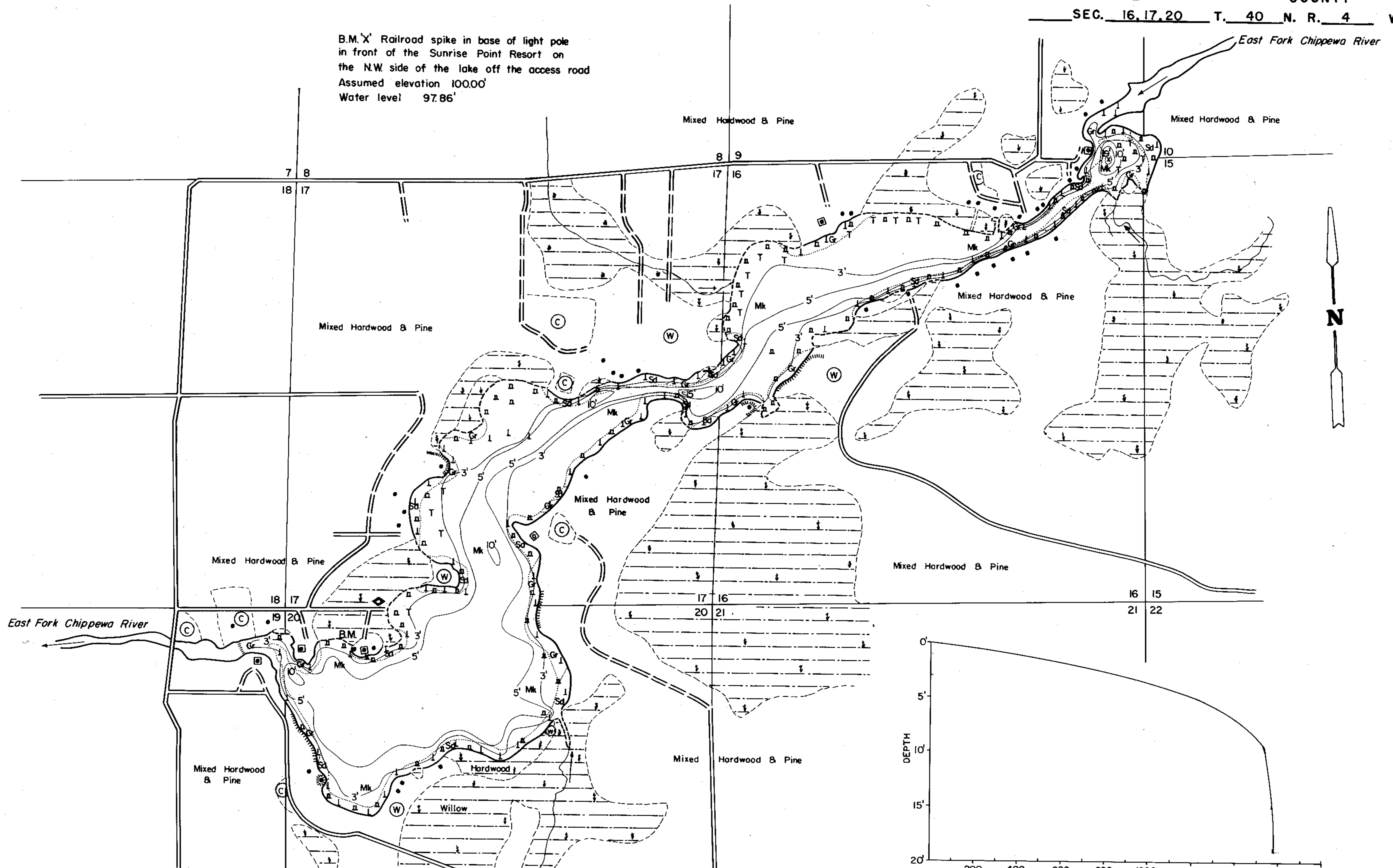

EQUIPMENT Recording Sonar MAPPED JULY 1973

TOPOGRAPHIC SYMBOLS

- (B) Brush
- (PW) Partially wooded
- (W) Wooded
- (C) Cleared
- (P) Pastured
- (A) Agricultural
- B.M. Dwelling
- Resort
- Camp
- Steep slope
- Indefinite shoreline
- Marsh
- Spring
- Intermittent stream
- Permanent inlet
- Permanent outlet
- Dam
- D.N.R. State owned land

- P. Peat
- Mk. Muck
- C. Clay
- M. Marl
- Sd. Sand
- St. Silt
- Gr. Gravel
- R. Rubble
- Br. Bedrock

LAKE BOTTOM SYMBOLS

- B Boulders
- Stumps & Snags
- Rock danger to navigation
- Submergent vegetation
- Emergent vegetation
- Floating vegetation
- Brush shelters

SPECIES OF FISH

Species	Abundance		
	Abundant	Common	Present
Muskie		X	
N. Pike		X	
Walleye		X	
L.M. Bass			X
S.M. Bass			X
Panfish		X	
Trout			

WATER AREA 356.1 ACRES  
 UNDER 3 FT. 25 %  
 OVER 20 FT. 0 %  
 MAX. DEPTH 19 FEET.  
 TOTAL ALK. 30 P.P.M.  
 VOLUME 1570 ACRE FT.  
 MAIN SHORELINE 7.55 MI.  
 ISLAND SHORELINE MI.



Access Access with Parking Boat Livery

Drawn by: C. Holt  
 Field work by: C. Busch, K. Cable, L. Sather

Source: Wisconsin Department of Natural Resources 608-266-2621  
Blaisdell Lake – Sawyer County, Wisconsin DNR Lake Map  
Date – Jul 1973 - Historical Lake Map - Not for Navigation  
A Public Document - Please Identify the Source when using it.