

B.M. "X" is a railroad spike in base of a power pole located on the east side of lake 325' N.E. of outlet and 21' E. of lake.
Assumed elevation = 100.00'
Water level = 95.18'

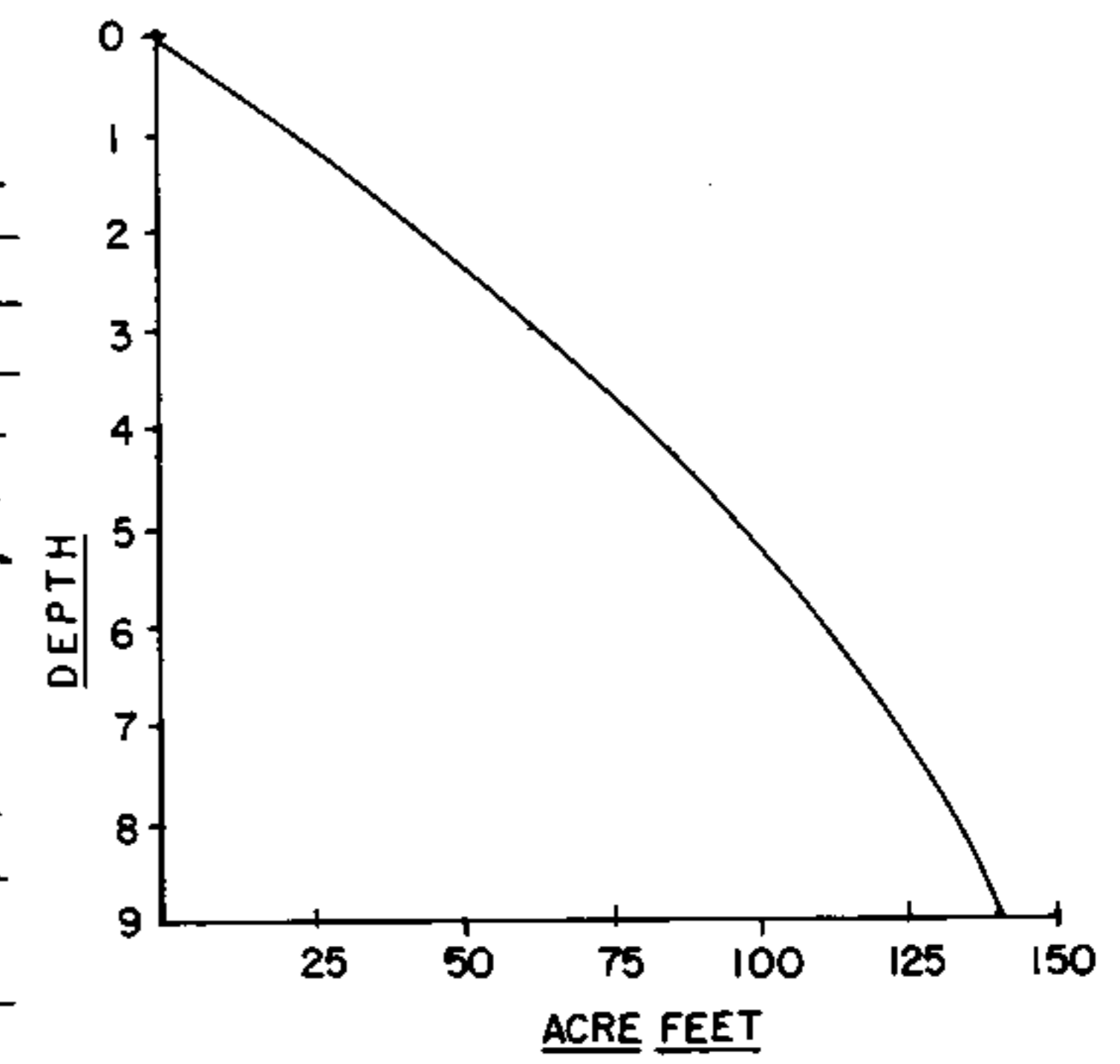
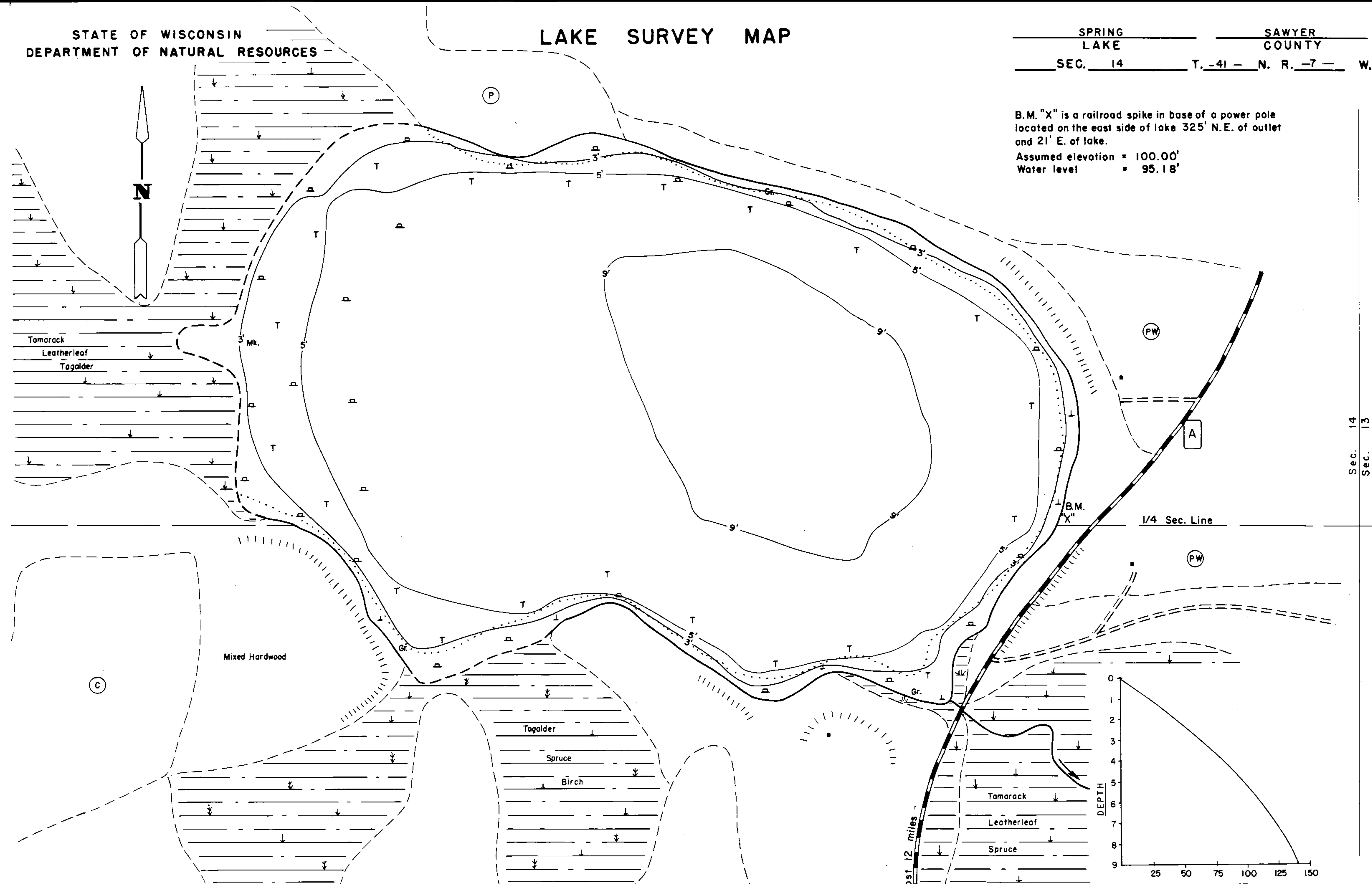

EQUIPMENT RECORDING SONAR MAPPED MAY 1977

- | TOPOGRAPHIC SYMBOLS | | LAKE BOTTOM SYMBOLS | |
|-----------------------|-------------------------------|---------------------|-----------------------------|
| (B) Brush | () Steep slope | P. Peat | B Boulders |
| (PW) Partially wooded | (---) Indefinite shoreline | Mk. Muck | ⊙ Stumps & Snags |
| (W) Wooded | (---) Marsh | C. Clay | ⊙ Rock danger to navigation |
| (C) Cleared | (---) Spring | M. Marl | T Submergent vegetation |
| (P) Pastured | (---) Intermittent stream | Sd. Sand | ⊙ Emergent vegetation |
| (A) Agricultural | (---) Permanent inlet | St. Silt | ⊙ Floating vegetation |
| B.M. Bench Mark | (---) Permanent outlet | Gr. Gravel | ⊙ Brush shelters |
| (■) Dwelling | (---) Dam | R. Rubble | |
| (■) Resort | (---) D.N.R. State owned land | Br. Bedrock | |
| (■) Camp | | | |

SPECIES OF FISH	Abundance	
	Abundant	Common
Muskie		
N. Pike		
Walleye		
L. M. Bass	X	
S. M. Bass		
Panfish	X	
Trout		

WATER AREA 21.7 ACRES
 UNDER 3 FT. 9 %
 OVER 20 FT. 0 %
 MAX. DEPTH 9 FEET.
 TOTAL ALK. 56 P.P.M.
 VOLUME 140.6 ACRE FT.
 MAIN SHORELINE .76 MI.
 ISLAND SHORELINE 0 MI.



Access Access with Parking Boat Livery
 Drawn by: R. Williams
 Field work by: C. Busch, K. Cable, L. Sather

Sec. 14
Sec. 13

Source: Wisconsin Department of Natural Resources 608-266-2621
Spring Lake – Sawyer County, Wisconsin DNR Lake Map
Date – May 1977 - Historical Lake Map - Not for Navigation
A Public Document - Please Identify the Source when using it.