

LAKE SURVEY MAP

GALLAHAN LAKE SAWYER COUNTY
SEC. 33, 34 T. 41 N. R. 7 W.

B.M. 'X' Bronze tablet set in concrete post. 75.6' E. of the S.E. corner of cottage and 67.2' N. of left upstream end of fishway
Assumed elevation 100.00'
Water level 95.75'

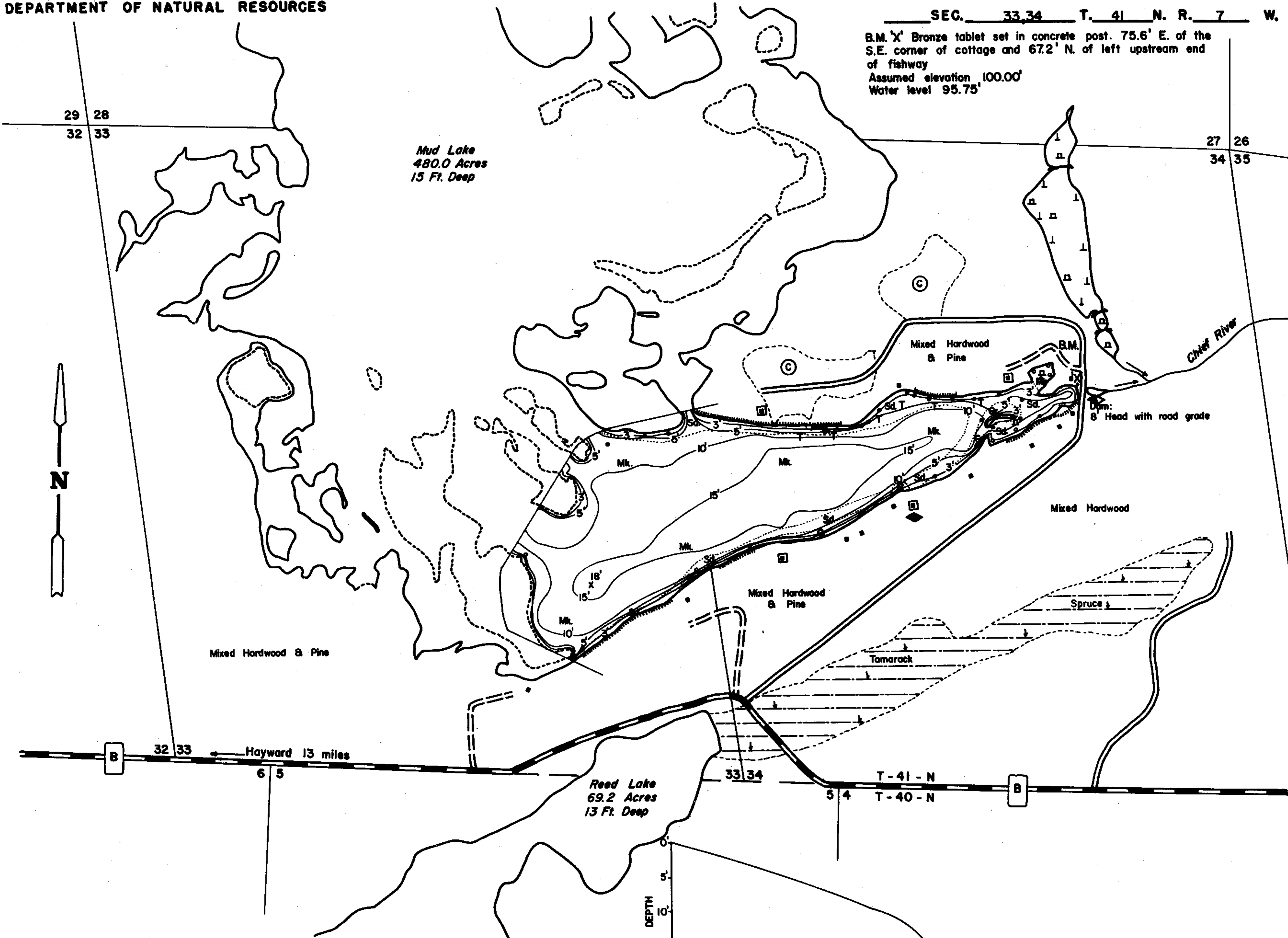

EQUIPMENT RECORDING SONAR MAPPED JUNE 1968

- | TOPOGRAPHIC SYMBOLS | | LAKE BOTTOM SYMBOLS | |
|-----------------------|-------------------------|---------------------|-----------------------------|
| (B) Brush | Steep slope | P. Peat | B Boulders |
| (PW) Partially wooded | ~ Indefinite shoreline | Mk. Muck | ⊙ Stumps & Snags |
| (W) Wooded | ~ Marsh | C. Clay | ⊙ Rock danger to navigation |
| (C) Cleared | ~ Spring | M. Marl | T Submergent vegetation |
| (P) Pastured | ~ Intermittent stream | Sd. Sand | ⊥ Emergent vegetation |
| (A) Agricultural | ~ Permanent inlet | St. Silt | ~ Floating vegetation |
| B.M. Bench Mark | ~ Permanent outlet | Gr. Gravel | ⊕ Brush shelters |
| ■ Dwelling | ~ Dam | R. Rubble | |
| □ Resort | D.N.R. State owned land | Bc Bedrock | |
| □ Camp | | | |

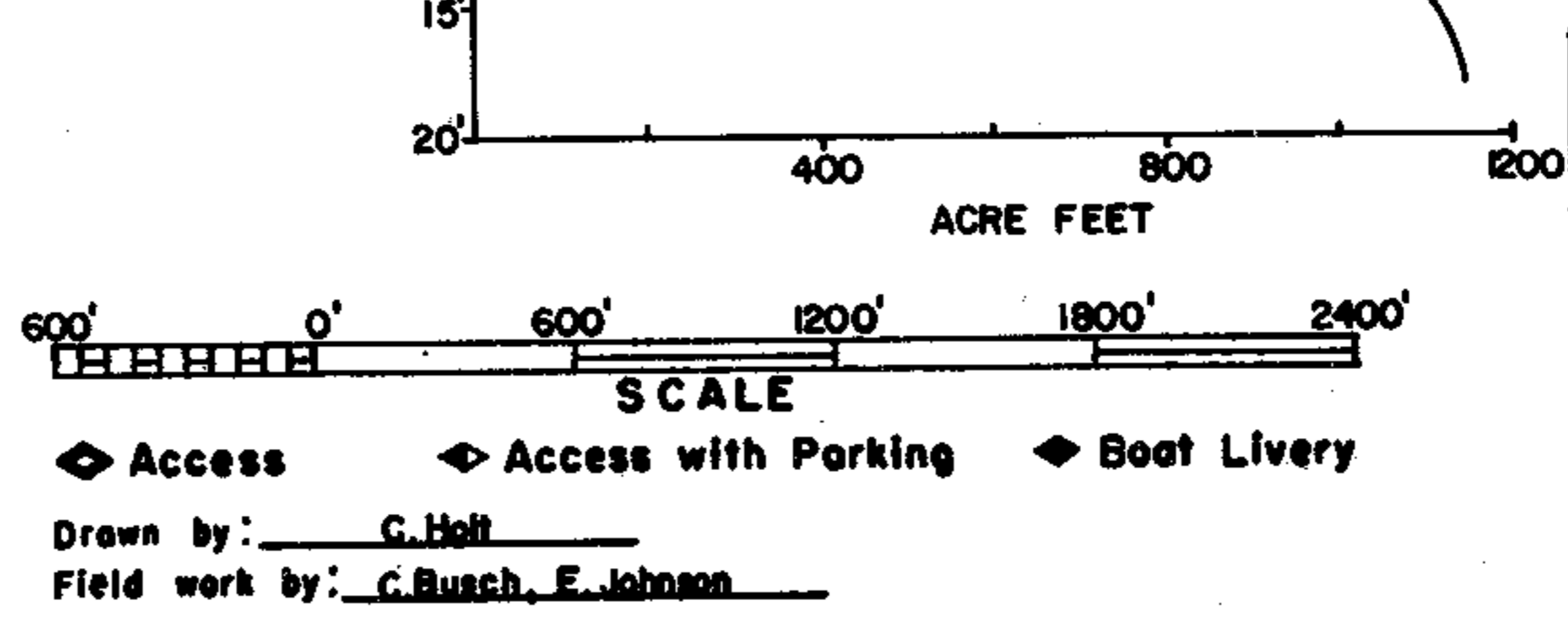

SPECIES OF FISH	ABUNDANCE		
	Abundant	Common	Present
Muskie	X		
N. Pike			
Walleye		X	
L.M. Bass	X		
S.M. Bass			
Pinfish	X		
Trot			

WATER AREA 105.8 ACRES
UNDER 3 FT. 14 %
OVER 20 FT. 0 %
MAX. DEPTH 18 FEET.
TOTAL ALK. 45 P.P.M.
VOLUME 1143.1 ACRE FT.
SHORELINE 2.0 MILES
SHORELINE 2.1 MILES WITH IS.

Source: Wisconsin Department of Natural Resources 608-266-2621
Callahan Lake – Sawyer County, Wisconsin DNR Lake Map
Date – Jun 1968 - Historical Lake Map - Not for Navigation
A Public Document - Please Identify the Source when using it.