

LAKE SURVEY MAP

GEORGE LAKE
BAYFIELD COUNTY
SEC. 18, 19 T. 45 N. R. 9 W.

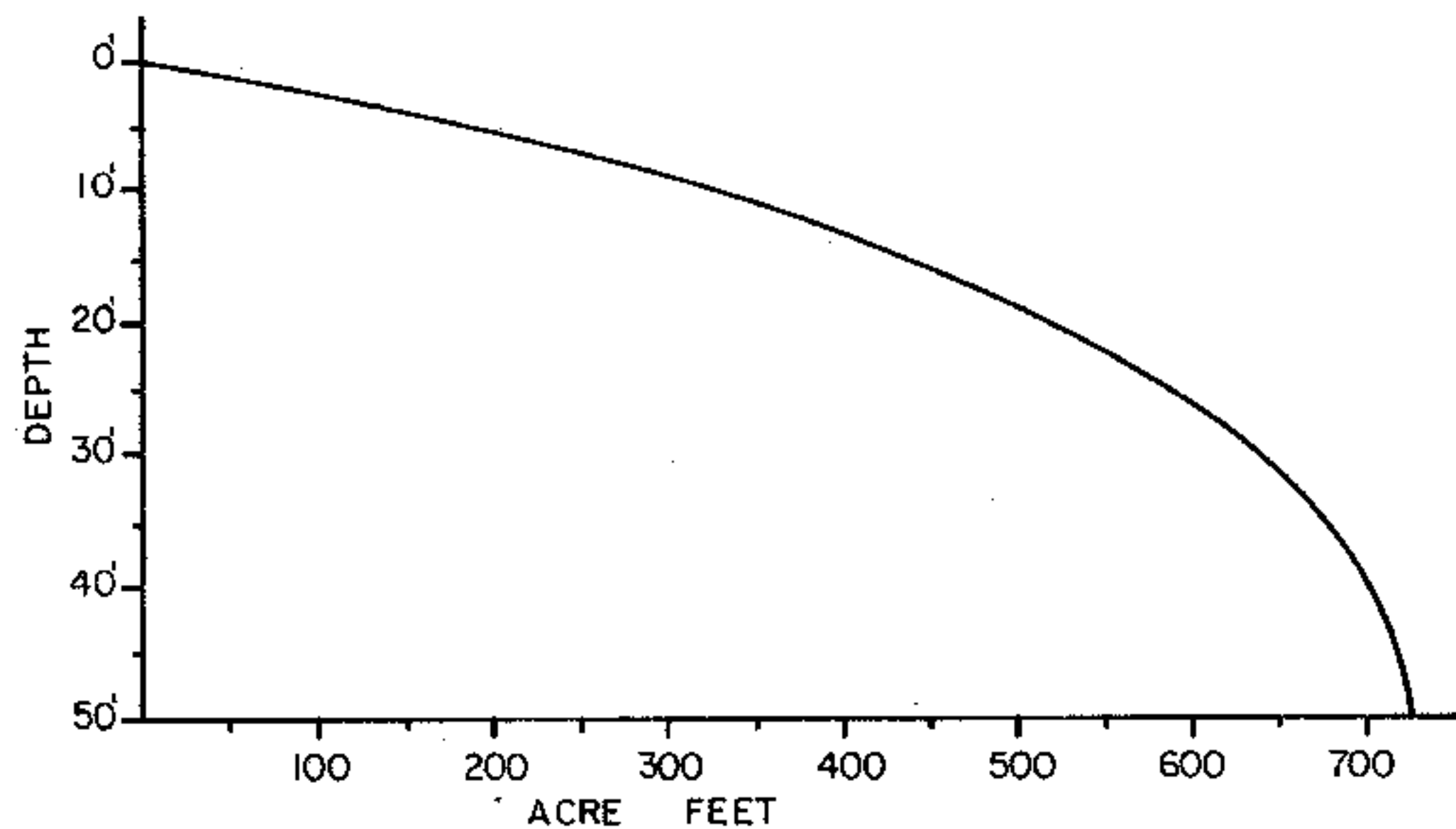

Department of Natural Resources B.M. 'X' is a 2" square cut in top & on W. side of dry well 48' W. of W. corner of cabin & 42' S. of lake.
Assumed elevation 100.00'
Water elevation 95.86'

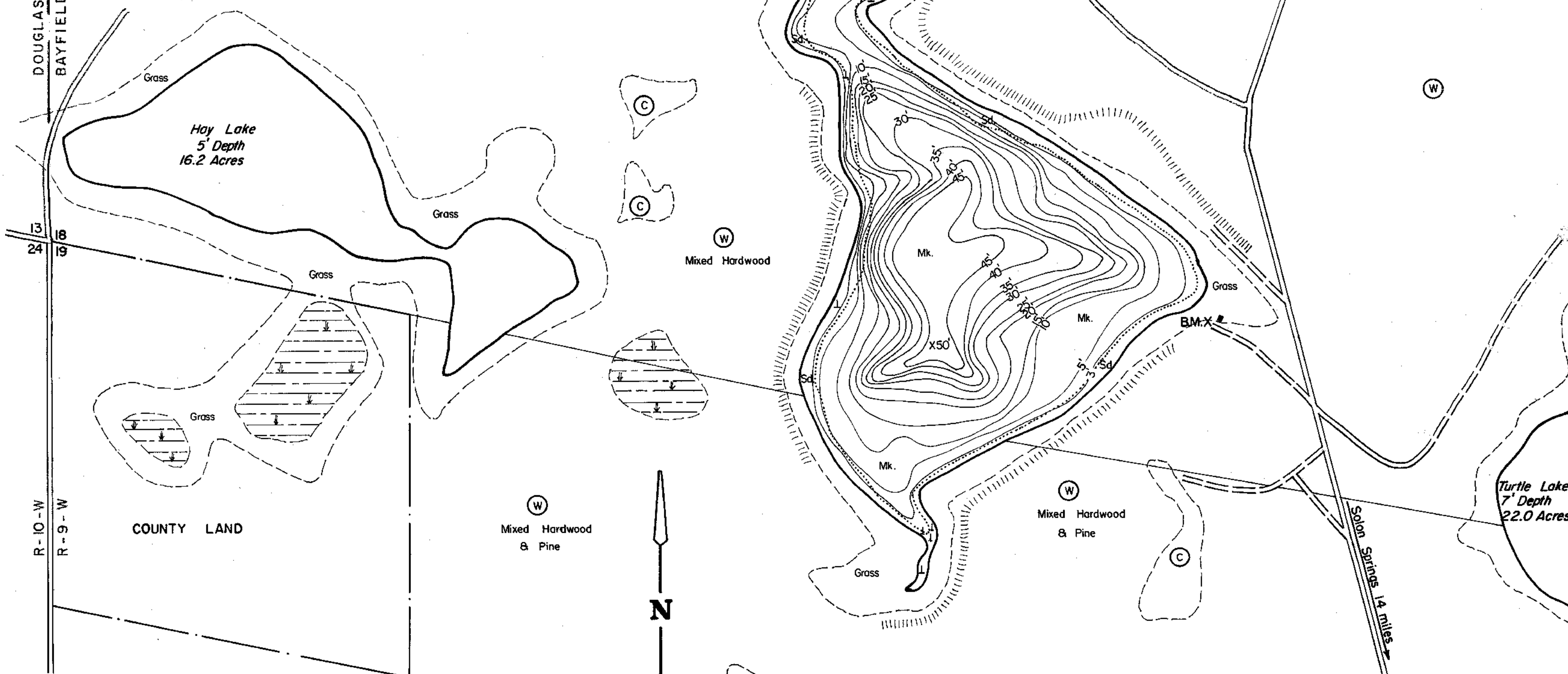

EQUIPMENT RECORDING SONAR MAPPED APRIL 1969
MONTH YEAR

- TOPOGRAPHIC SYMBOLS**
- (B) Brush
 - (PW) Partially wooded
 - (W) Wooded
 - (C) Cleared
 - (P) Pastured
 - (A) Agricultural
 - B.M. Bench Mark
 - Dwelling
 - Resort
 - Camp

- LAKE BOTTOM SYMBOLS**
- P. Peat
 - Mk. Muck
 - C. Clay
 - M. Marl
 - Sd. Sand
 - St. Silt
 - Gr. Gravel
 - R. Rubble
 - Br. Bedrock
 - ||||| Steep slope
 - - - Indefinite shoreline
 - Marsh
 - Spring
 - Intermittent stream
 - Permanent inlet
 - Permanent outlet
 - Dam
 - D.N.R. State owned land
 - B Boulders
 - Stumps & Snags
 - Rock danger to navigation
 - T Submergent vegetation
 - I Emergent vegetation
 - Floating vegetation
 - Brush shelters

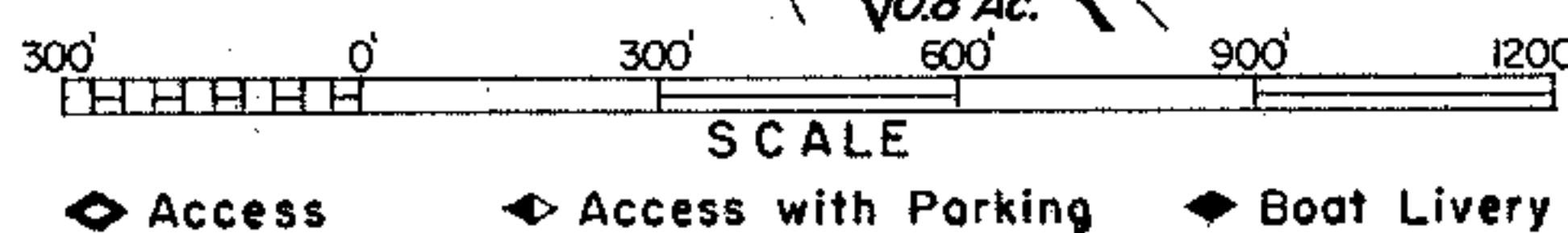

Drawn by: R.A. Bumkrant
Field work by: C. Busch, C. Belter, S. Johannes

SPECIES OF FISH	Abundant	
	Common	Present
Muskie		
N. Pike		
Walleye		
L.M. Bass	X	
S.M. Bass		
Panfish	X	
Trout		

WATER AREA 46.4 ACRES
 UNDER 3 FT. 12 %
 OVER 20 FT. 31 %
 MAX. DEPTH 50' FEET.
 TOTAL ALK. 27 P.P.M.
 VOLUME 727.1 ACRE FT.
 SHORELINE 1.64 MILES

Source: Wisconsin Department of Natural Resources 608-266-2621
George Lake – Bayfield County, Wisconsin DNR Lake Map
Date - Apr 1969 - Historical Lake Map - Not for Navigation
A Public Document - Please Identify the Source when using it.