

BURNETT
COUNTY
FOREST

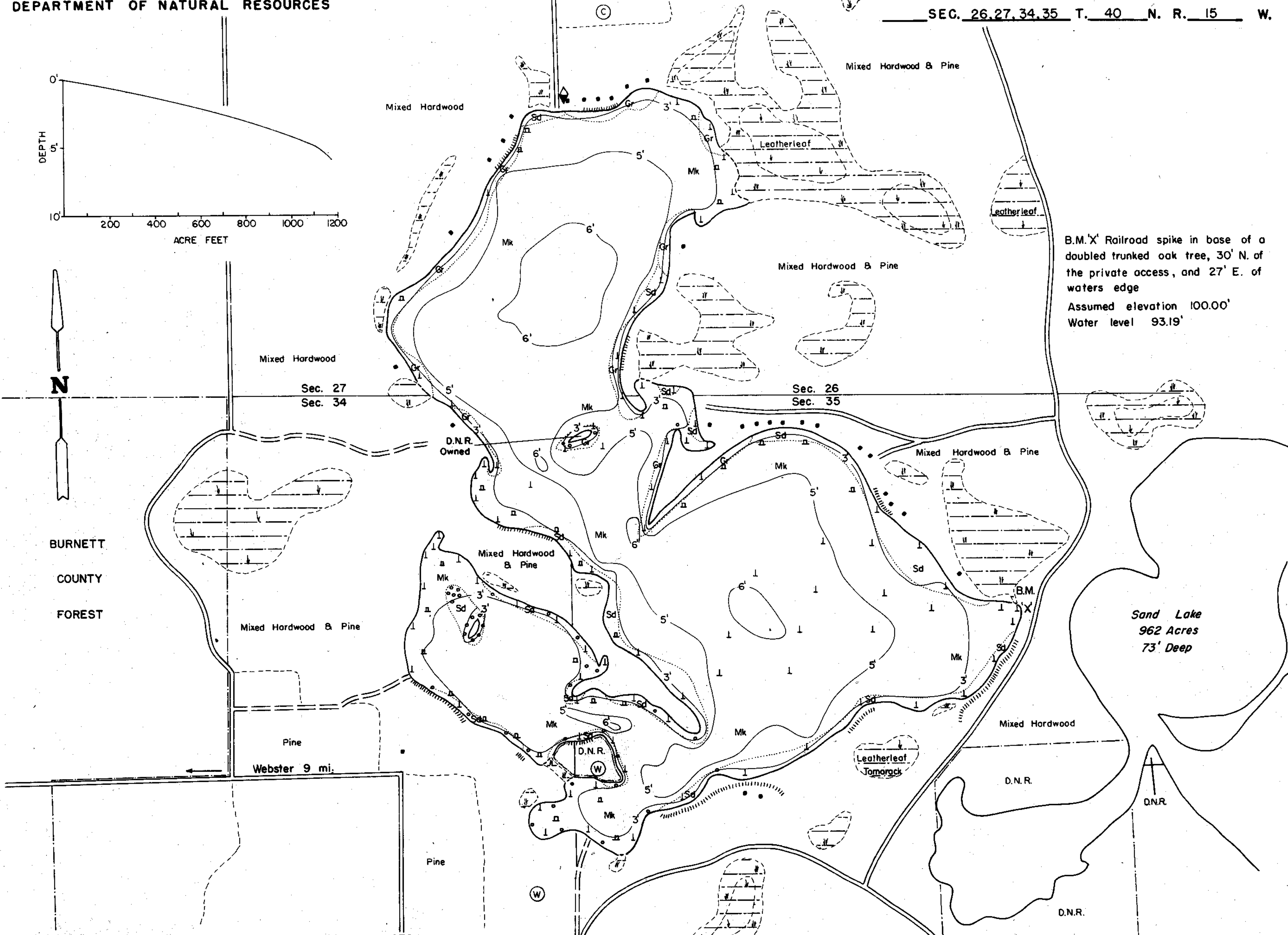

B.M. 'X' Railroad spike in base of a doubled trunked oak tree, 30' N. of the private access, and 27' E. of waters edge
Assumed elevation 100.00'
Water level 93.19'

Sand Lake
962 Acres
73' Deep

EQUIPMENT RECORDING SONAR MAPPED MAY 1972

- TOPOGRAPHIC SYMBOLS
- (B) Brush
 - (PW) Partially wooded
 - (W) Wooded
 - (C) Cleared
 - (P) Pastured
 - (A) Agricultural
 - B.M. Bench Mark
 - Dwelling
 - Resort
 - ⊞ Camp

- LAKE BOTTOM SYMBOLS
- P. Peat
 - Mk. Muck
 - C. Clay
 - M. Marl
 - Sd. Sand
 - St. Silt
 - Gr. Gravel
 - R. Rubble
 - Br. Bedrock
 - B Boulders
 - ⊙ Stumps & Snags
 - ⊙ Rock danger to navigation
 - T Submergent vegetation
 - ⊥ Emergent vegetation
 - ⊥ Floating vegetation
 - ⊥ Brush shelters



◆ Access ◆ Access with Parking ◆ Boat Livery
Drawn by: C. Holt
Field work by: C. Busch, G. Lund, J. Sather

| SPECIES OF FISH | Abundant | | Present |
|-----------------|----------|---------|---------|
| | Common | Present | |
| Muskie | | | |
| N. Pike | | | X |
| Walleye | | | X |
| L.M. Bass | | | X |
| S.M. Bass | | | X |
| Panfish | X | | |
| Trout | | | |

WATER AREA 274.3 ACRES
UNDER 3 FT. 16.8 %
OVER 20 FT. 0 %
MAX. DEPTH 6 FEET.
TOTAL ALK. 12 P.P.M.
VOLUME 1177 ACRE FT.
SHORELINE 5.25 MILES
SHORELINE 5.26 MILES WITH IS.

Source: Wisconsin Department of Natural Resources 608-266-2621
Green Lake – Burnett County, Wisconsin DNR Lake Map
Date – May 1972 - Historical Lake Map - Not for Navigation
A Public Document - Please Identify the Source when using it.