

LAKE SURVEY MAP

LOON LAKE DOUGLAS COUNTY
SEC. 13,24 T. 45 N. R. 10 W.

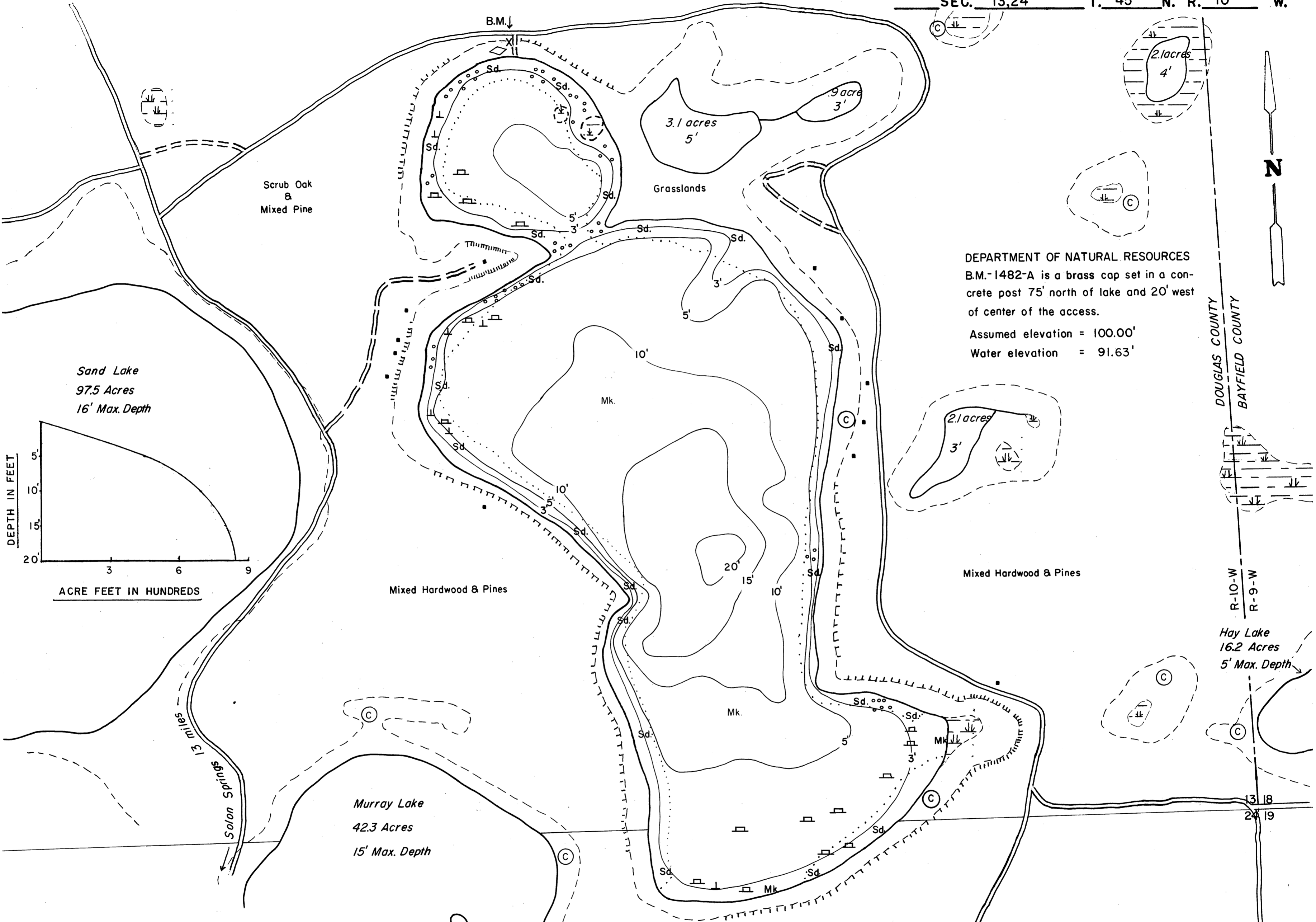

DEPARTMENT OF NATURAL RESOURCES
B.M.-1482-A is a brass cap set in a concrete post 75' north of lake and 20' west of center of the access.
Assumed elevation = 100.00'
Water elevation = 91.63'

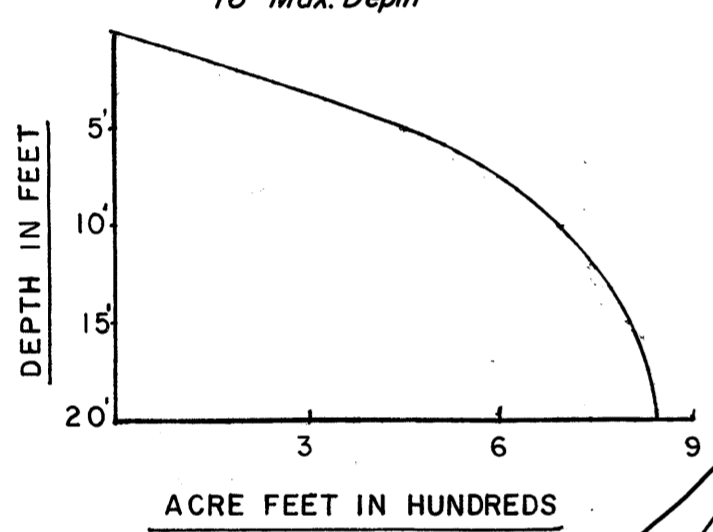

EQUIPMENT RECORDING SONAR MAPPED MAY 1969

- TOPOGRAPHIC SYMBOLS**
- (B) Brush
 - (PW) Partially wooded
 - (W) Wooded
 - (C) Cleared
 - (P) Pastured
 - (A) Agricultural
 - B.M. Bench Mark
 - Dwelling
 - Resort
 - Camp
 - ||||| Steep slope
 - - - Indefinite shoreline
 - Marsh
 - Spring
 - Intermittent stream
 - Permanent inlet
 - Permanent outlet
 - D.N.R. State owned land

- LAKE BOTTOM SYMBOLS**
- P. Peat
 - Mk. Muck
 - C. Clay
 - M. Marl
 - Sd. Sand
 - St. Silt
 - Gr. Gravel
 - R. Rubble
 - Br. Bedrock
 - B Boulders
 - Stumps & Snags
 - Rock danger to navigation
 - T Submergent vegetation
 - Emergent vegetation
 - Floating vegetation
 - Brush shelters



◆ Access ◆ Access with Parking ◆ Boat Livery

Drawn by: T. Ginder
Field work by: C. Busch & C. Belfer, S. Johannes

SPECIES OF FISH	ABUNDANCE		
	Abundant	Common	Present
Muskie			
N. Pike	X		
Walleye			
L.M. Bass		X	
S.M. Bass			
Panfish	X		
Trout			

WATER AREA 108.6 ACRES
 UNDER 3 FT. 13 %
 OVER 20 FT. 1 %
 MAX. DEPTH 20 FEET.
 TOTAL ALK. 40 P.P.M.
 VOLUME 843.5 ACRE FT.
 SHORELINE 2.07 MILES

Source: Wisconsin Department of Natural Resources 608-266-2621
Loon Lake - Douglas County, Wisconsin DNR Lake Map
May 1969 Historical Lake Map Not for Navigation
A Public Document - Please Identify the Source when using it.