

STATE OF WISCONSIN  
DEPARTMENT OF NATURAL RESOURCES

B.M. X' D.N.R. 1298-A Bronze tablet set in concrete post 106' W. of lake, 47' S. of 18" oak and 50' W. of storage shed at "Camp Croix" on N. side of lake  
Assumed elevation 100.00'  
Water level 89.10'

LAKE SURVEY MAP

ROONEY LAKE  
BURNETT COUNTY  
SEC. 10, 11, 14, 15 T. 40 N. R. 14 W.

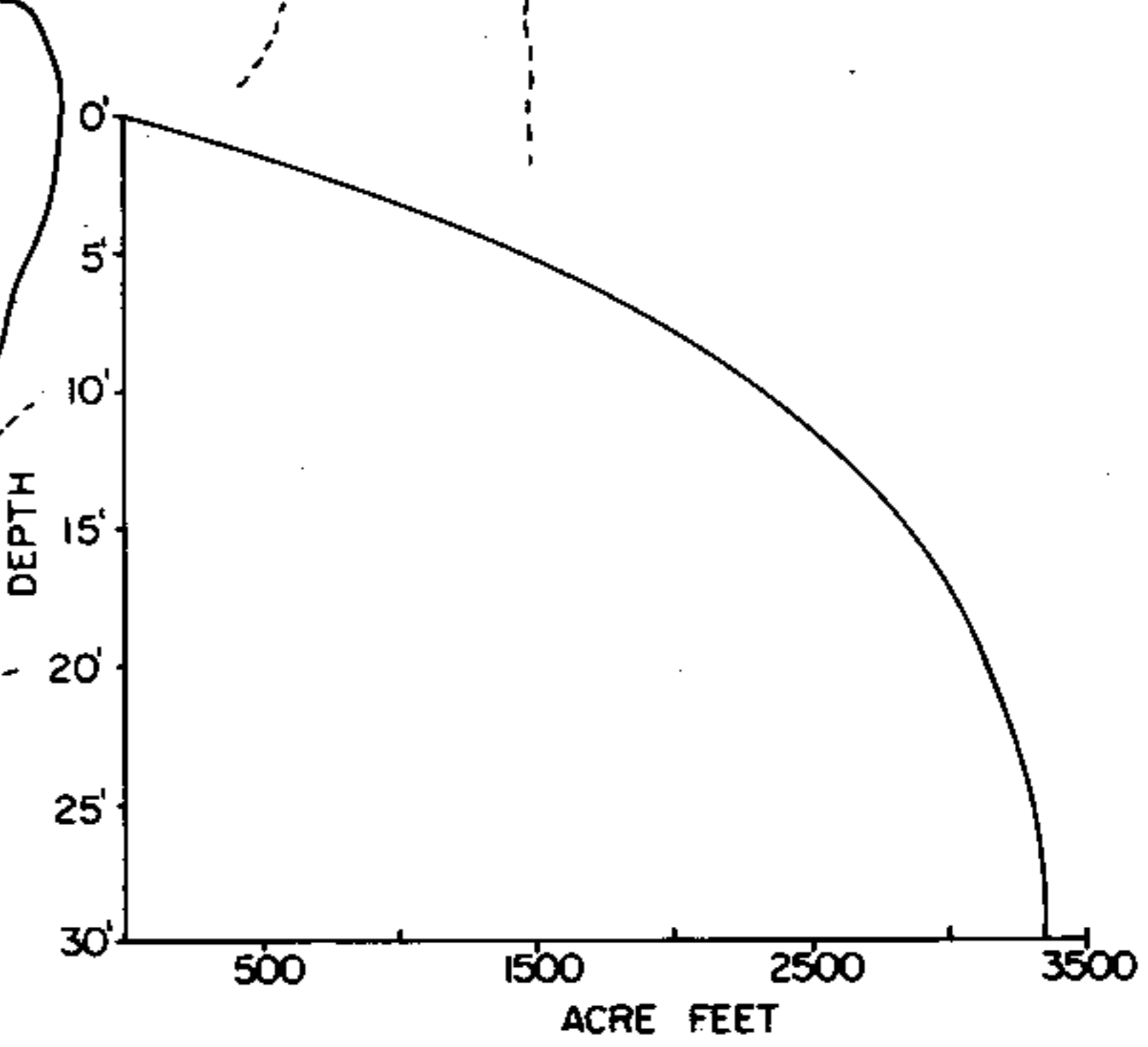
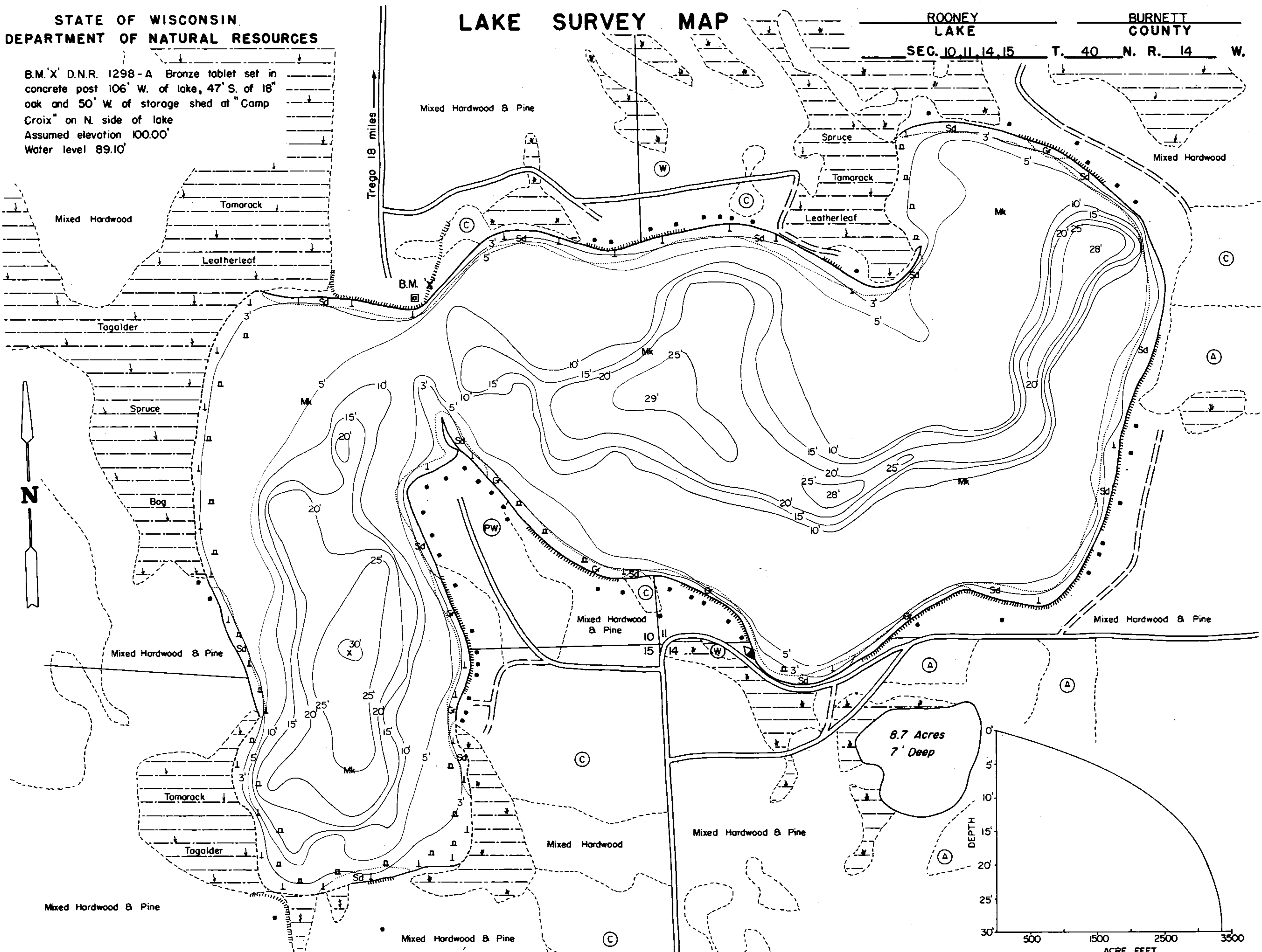

EQUIPMENT RECORDING SONAR MAPPED		JUNE 1971	
		MONTH	YEAR
TOPOGRAPHIC SYMBOLS		LAKE BOTTOM SYMBOLS	
(B) Brush	Steep slope	P. Peat	B Boulders
(PW) Partially wooded	----- Indefinite shoreline	Mk. Muck	⊙ Stumps & Snags
(W) Wooded	Marsh	C. Clay	⊙ Rock danger to navigation
(C) Cleared	Spring	M. Marl	T Submergent vegetation
(P) Pastured	Intermittent stream	Sd. Sand	⊥ Emergent vegetation
(A) Agricultural	Permanent inlet	St. Silt	⊥ Floating vegetation
B.M. Bench Mark	Permanent outlet	Gr. Gravel	⊕ Brush shelters
■ Dwelling	Dam	R. Rubble	
⊠ Resort	D.N.R. State owned land	Bc. Bedrock	
⊡ Camp			



◆ Access    ◆ Access with Parking    ◆ Boat Livery  
 Drawn by: C. Holt  
 Field work by: C. Busch, G. Lund, L. Sather

SPECIES OF FISH	ABUNDANCE		
	Abundant	Common	Present
Muskie			
N. Pike		X	
Walleye			X
L.M. Bass			
S.M. Bass			
Panfish	X		
Trout			

WATER AREA 3218 ACRES  
 UNDER 3 FT. 9 %  
 OVER 20 FT. 17 %  
 MAX. DEPTH 30 FEET.  
 TOTAL ALK. 25 P.P.M.  
 VOLUME 3347 ACRE FT.  
 SHORELINE 424 MILES

Source: Wisconsin Department of Natural Resources 608-266-2621  
Rooney Lake – Burnett County, Wisconsin DNR Lake Map  
Date – Jun 1971 - Historical Lake Map - Not for Navigation  
A Public Document - Please Identify the Source when using it.