

EQUIPMENT RECORDING SONAR MAPPED JULY 1971

TOPOGRAPHIC SYMBOLS		LAKE BOTTOM SYMBOLS	
(B) Brush	Steep slope	P. Peat	B Boulders
(PW) Partially wooded	~ Indefinite shoreline	Mk. Muck	• Stumps & Snags
(W) Wooded	~ Marsh	C. Clay	⊗ Rock danger to navigation
(C) Cleared	~ Spring	M. Marl	T Emergent vegetation
(P) Pastured	~ Intermittent stream	Sd. Sand	⊥ Submerged vegetation
(A) Agricultural	~ Permanent inlet	Sl. Silt	~ Floating vegetation
B.M. Bench Mark	~ Permanent outlet	Gr. Gravel	~ Brush shelters
■ Dwelling	~ Dam	R. Rubble	
■ Resort	~ D.N.R. State owned land	Bc Bedrock	
■ Camp			

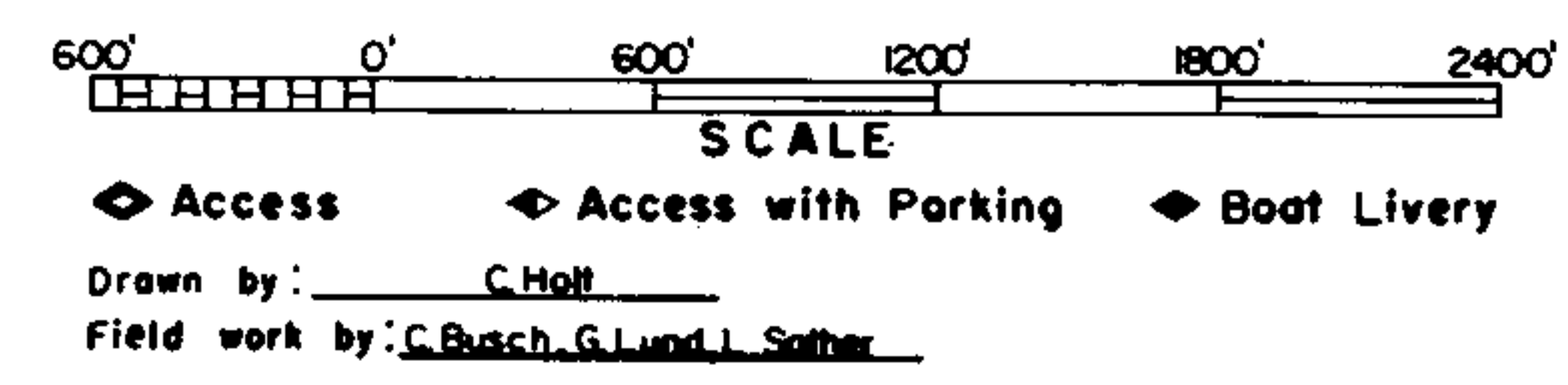

SPECIES OF FISH	ABUNDANCE		
	Abundant	Common	Present
Muskie			
N. Pike		X	
Walleye	X		
L.M. Bass		X	
S.M. Bass			X
Panfish		X	
Trout			

WATER AREA 9615 ACRES
 UNDER 3 FT. 7 %
 OVER 20 FT. 48 %
 MAX. DEPTH 73 FEET.
 TOTAL ALK. 42 P.P.M.
 VOLUME 22,993 ACRE FT.
 SHORELINE 830 MILES

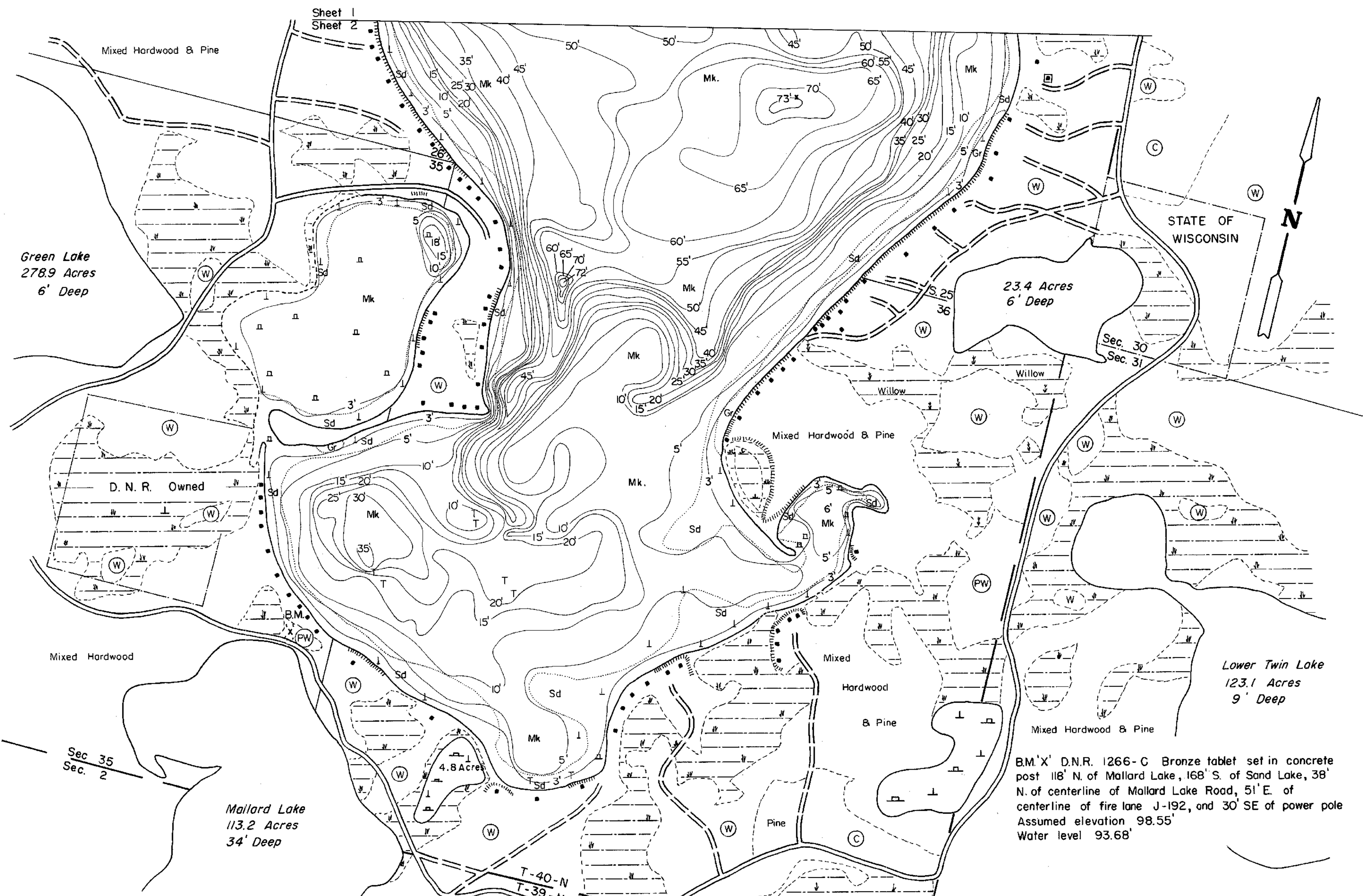

B.M. 'X' D.N.R. 1266-C Bronze tablet set in concrete post 118' N. of Mallard Lake, 168' S. of Sand Lake, 38' N. of centerline of Mallard Lake Road, 51' E. of centerline of fire lane J-192, and 30' SE of power pole Assumed elevation 98.55' Water level 93.68'

EQUIPMENT RECORDING SONAR MAPPED JULY 1971

- TOPOGRAPHIC SYMBOLS**
- (B) Brush
 - (PW) Partly wooded
 - (W) Wooded
 - (C) Cleared
 - (P) Pastured
 - (A) Agricultural
 - B.M. Bench Mark
 - Dwelling
 - Resort
 - Camp
 - ||||| Steep slope
 - - - Indefinite shoreline
 - Marsh
 - Spring
 - Intermittent stream
 - Permanent inlet
 - Permanent outlet
 - Dam
 - D.N.R. State owned land

- LAKE BOTTOM SYMBOLS**
- P. Peat
 - Mk. Muck
 - C. Clay
 - M. Marl
 - Sd. Sand
 - St. Silt
 - Gr. Gravel
 - R. Rubble
 - Bc. Bedrock
 - B Boulders
 - Stumps & Snags
 - Rock danger to navigation
 - T Submergent vegetation
 - Emergent vegetation
 - Floating vegetation
 - Brush shelters

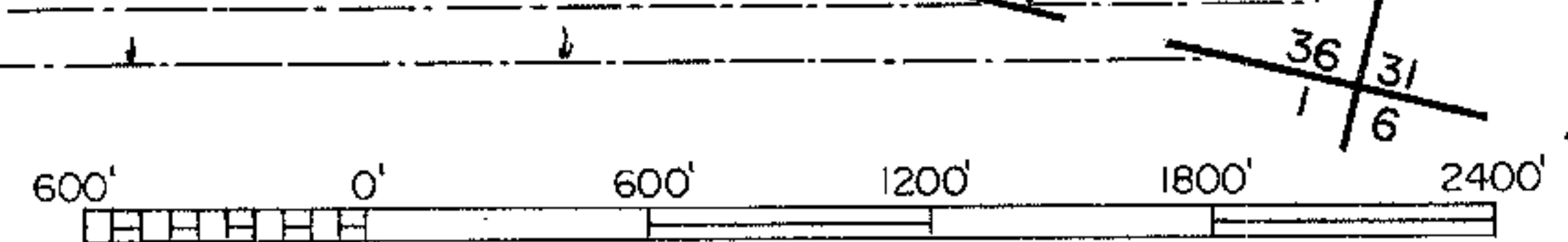

Access Access with Parking Boat Livery

Drawn by: C. Holt
Field work by: C. Busch, G. Lund, L. Sather

SPECIES OF FISH	Abundant Common Present		
	Abundant	Common	Present
Muskie			
N. Pike		X	
Walleye	X		
L.M. Bass		X	
S.M. Bass		X	
Panfish	X		
Trout			

WATER AREA 961.5 ACRES
UNDER 3 FT. 7 %
OVER 20 FT. 48 %
MAX. DEPTH 73 FEET.
TOTAL ALK. 42 P.P.M.
VOLUME 22,993 ACRE FT.
SHORELINE 8.30 MILES

Source: Wisconsin Department of Natural Resources 608-266-2621
Sand Lake – Burnett County, Wisconsin DNR Lake Map
Date – Jul 1971 - Historical Lake Map - Not for Navigation
A Public Document - Please Identify the Source when using it.