

LAKE SURVEY MAP

LAKE UPPER CHAIN
 SECTION 16-21-22
 TOWNSHIP 43 N
 RANGE 11 W
 TOWN OF WASCOTT
 COUNTY DOUGLAS

FORM 1117

WISCONSIN CONSERVATION DEPARTMENT
 BIOLOGY DIVISION
 LAKE AND STREAM IMPROVEMENT SECTION

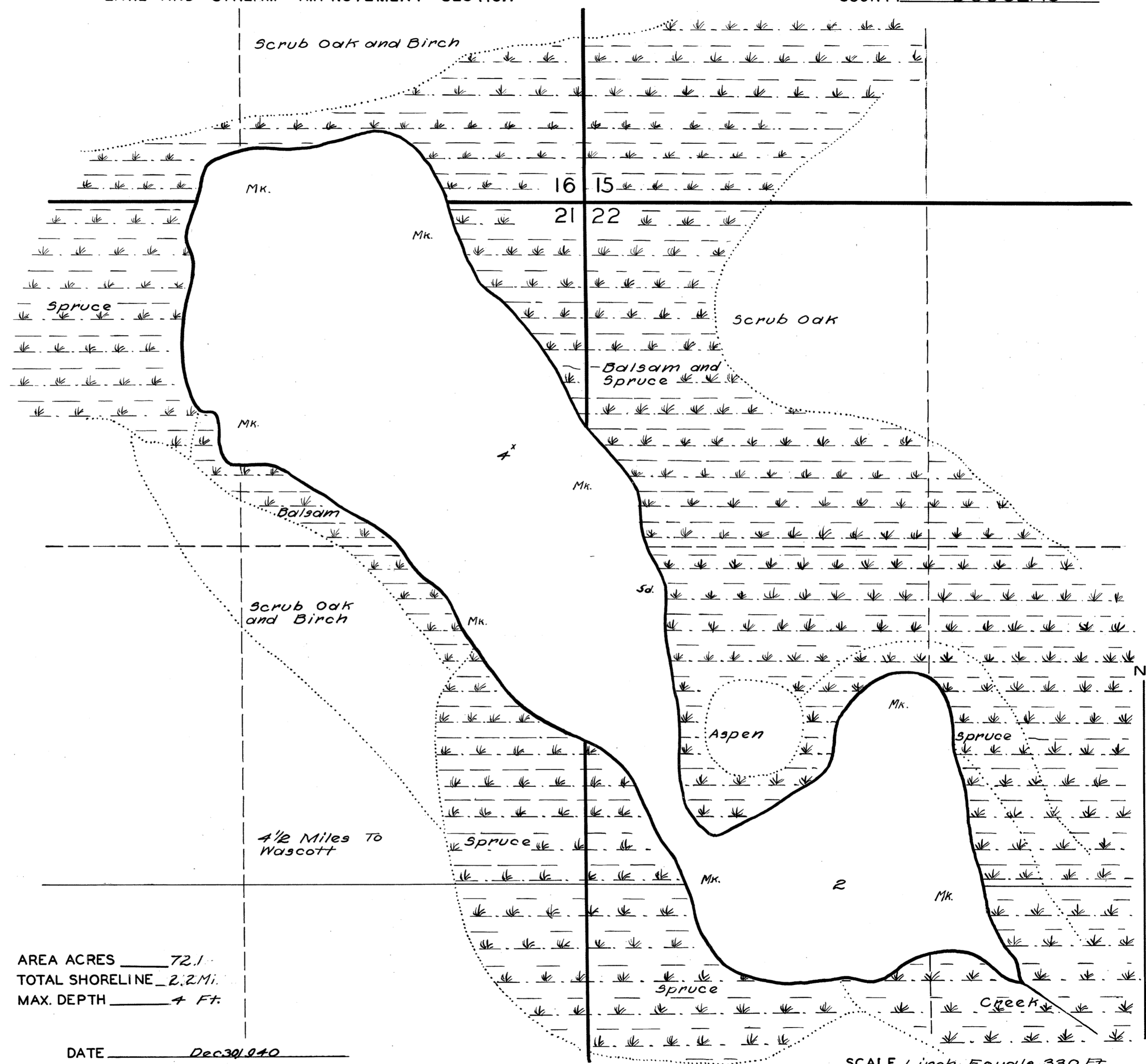

AREA ACRES 72.1
 TOTAL SHORELINE 2.2 Mi.
 MAX. DEPTH 4 Ft.

DATE Dec 30, 1940
 COMPILED BY _____
 TRACED BY W.P.S. (WPA)
 SOURCE OF INFORMATION _____
W.P.A. Lake Survey Project
 SOUNDINGS at 16.5 Ft. Intervals
 DATES OF MAP REVISION _____
 WORK AGENCY W. P. A.

SCALE 1 inch Equals 330 Ft.

LAKE IMPROVEMENT RECORD

TYPE-DATE			
BRUSH REFUGES			
SAPLING TAGLES			
SPAWNING BOXES			
MINNOW SPAWNS			
TOTAL			

LEGEND

- WEED BEDS
- ROCKY SHOALS
- Sd.* SAND
- Cl.* CLAY
- Gm.* GRAVEL
- Mk.* MUCK
 - DWELLING
 - ABANDONED DWELLING
 - RESORT

*Checked
 W.P.S.
 LAK
 6/21/41*

Source: Wisconsin Department of Natural Resources 608-266-2621
Upper Chain Lake - Douglas County, Wisconsin DNR Lake Map
Dec. 1940 Historical Lake Map - Not for Navigation
A Public Document - Please Identify the Source when using it.