

LAKE SURVEY MAP

LAKE WHITESIDE
 SECTION 8-17
 TOWNSHIP 44 N
 RANGE 10 W
 TOWN OF GORDON
 COUNTY DOUGLAS

FORM F1-117

WISCONSIN CONSERVATION DEPARTMENT
 BIOLOGY DIVISION
 LAKE AND STREAM IMPROVEMENT SECTION

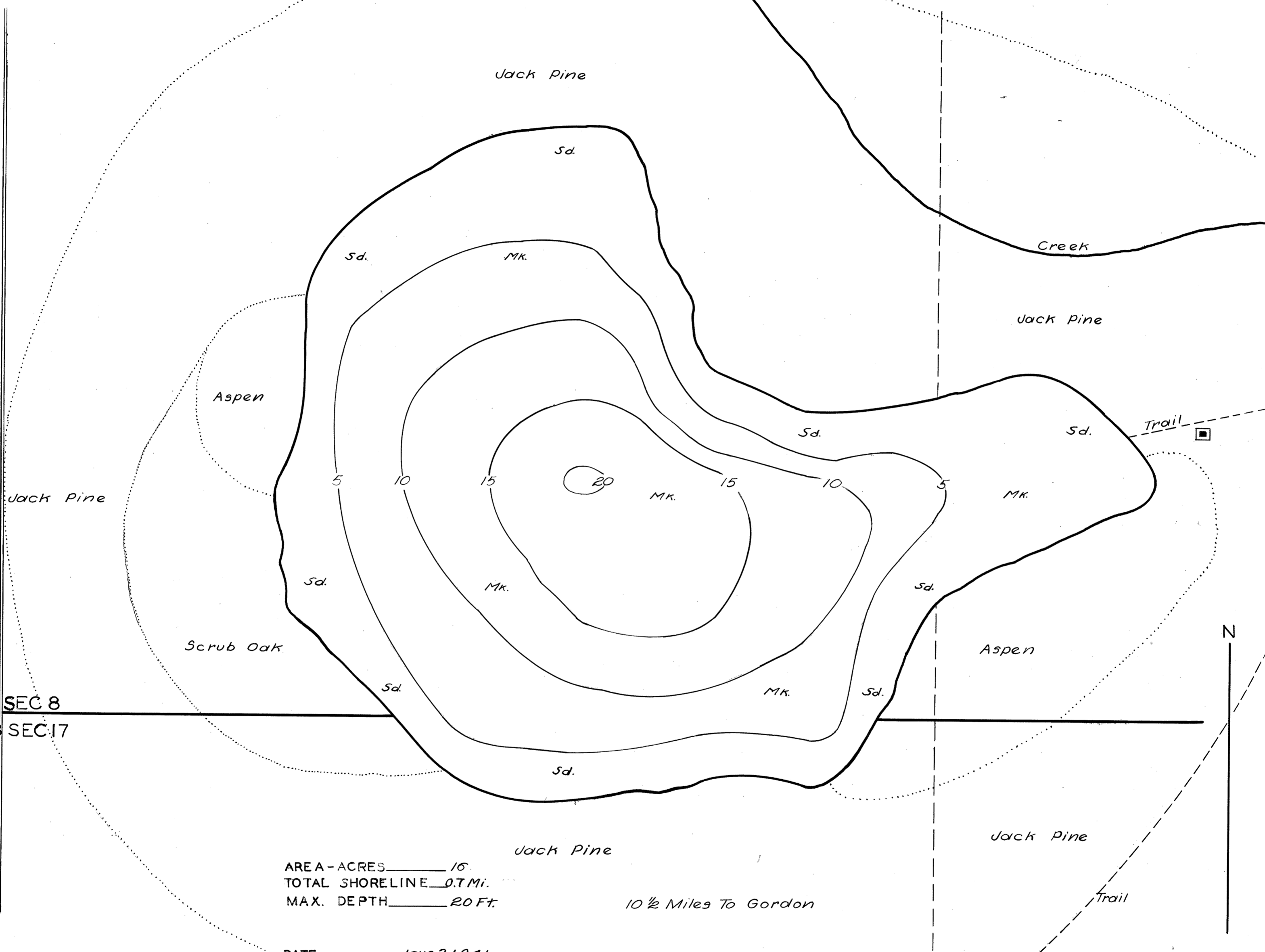

AREA - ACRES 16
 TOTAL SHORELINE 0.7 Mi.
 MAX. DEPTH 20 Ft.

10 1/2 Miles To Gordon

DATE Jan 21, 1941
 COMPILED BY W.P.S. W.P.A.
 TRACED BY _____
 SOURCE OF INFORMATION W.P.A. Lake Survey Project

 SOUNDINGS At 165' Intervals

 DATES OF MAP REVISION _____

 WORK AGENCY W P A

Checked
 W.P.S.
 D.A.B.
 7/11/41

LAKE IMPROVEMENT RECORD

TYPE	DATE				
BRUSH REFUGES					
SAPLING TANGLES					
SPAWNING BOXES					
MINNOW SPAWNING					
TOTAL					

LEGEND
 WEED BEDS
 ROCKY SHOALS
 Sd. SAND
 Cl. CLAY
 Gr. GRAVEL
 Mk. MUCK
 DWELLING
 ABANDONED DWELLING
 RESORT

Source: Wisconsin Department of Natural Resources 608-266-2621
Whiteside Lake - Douglas County, Wisconsin DNR Lake Map
Jan. 1941 Historical Lake Map - Not for Navigation
A Public Document - Please Identify the Source when using it.