

LAKE BONE (NORTH HALF)  
 SECTIONS 5-6-7-8-17-18-20-31-32  
 TOWNSHIP 35-36 N.  
 RANGE 16 W.  
 TOWN BONE LAKE - GEORGETOWN  
 COUNTY POLK

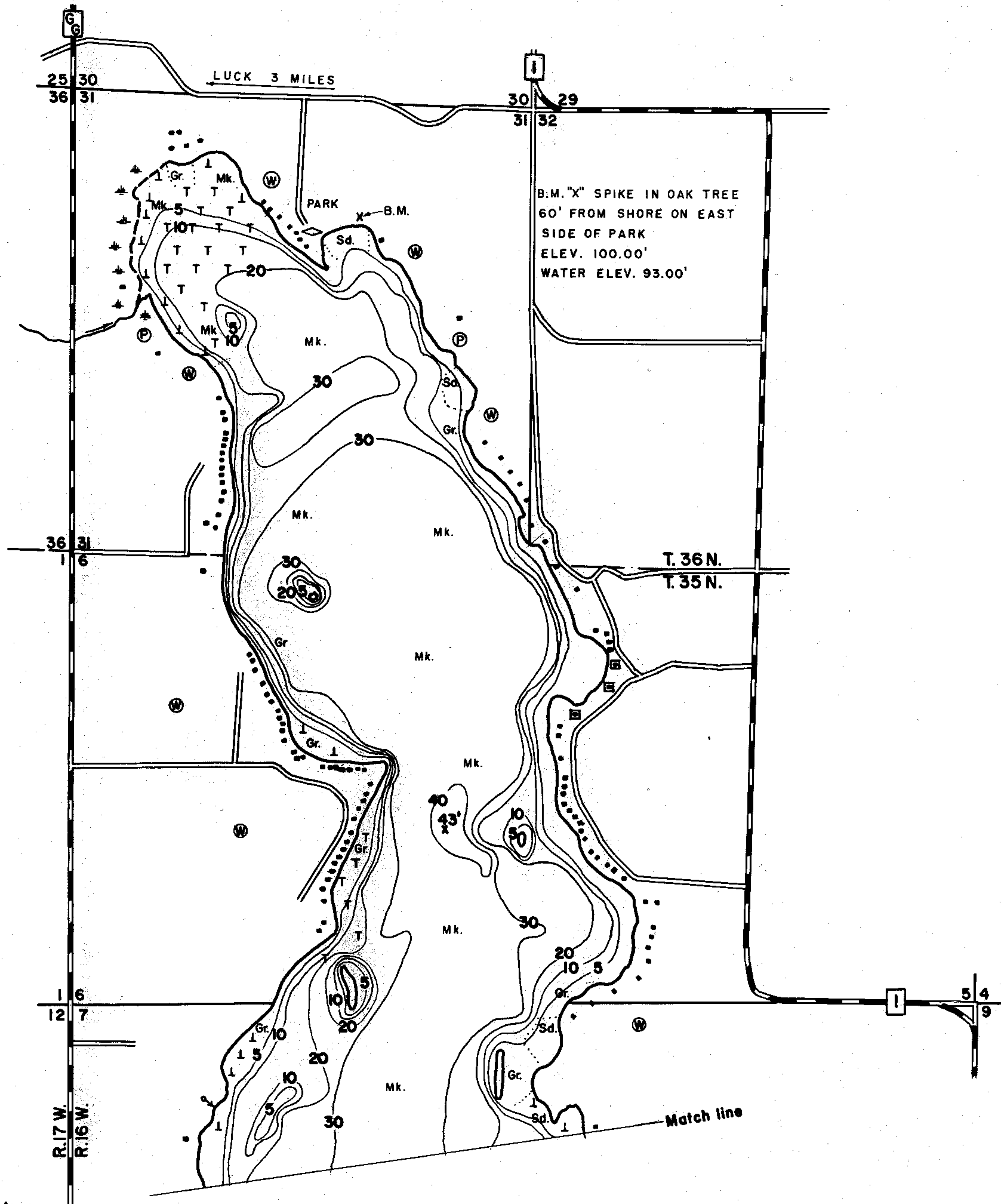

- LEGEND
- TOPOGRAPHIC SYMBOLS
- ⊙ Brush
  - ⊙PW Partially wooded
  - ⊙W Wooded
  - ⊙P Pastured
  - ⊙A Agricultural
  - B.M. Bench Mark
  - ||||| Steep slope
  - - - Indefinite shoreline
  - \* \* Marsh
  - Spring
  - Permanent inlet
  - ← Permanent outlet
  - ⊙ Resort, Youth Camp
- LAKE BOTTOM SYMBOLS
- Mk Muck
  - Sd Sand
  - Gr Gravel
  - Br Bedrock
  - T Submergent vegetation
  - ⊥ Emergent vegetation

SPECIES OF FISH							
	Muskie	N. Pike	Walleye	L. M. Bass	S. M. Bass	Perch	Trout
Abundant			X				
Common	X	X			X	X	
Rare				X			

FIELD WORK BY: R. Hopke, E. Nelson  
 DRAWN BY: W. Johnson  
 LAKE MAPPED AUGUST 1963  
 SOURCE OF INFORMATION W.C.D.  
 SOUNDINGS RECORDING SONAR  
 TOTAL ALK. 122 P.P.M.

1,000' 0' 1,000' 2,000' 3,000' 4,000' 5,000'  
 SCALE  
 ◊ ACCESS      ◊ ACCESS WITH PARKING      ◊ BOAT LIVERY

AREA 1,781 Acres  
 TOTAL SHORELINE 12.5 Miles  
 MAX. DEPTH 43 Feet  
 SCALE: As shown

LAKE SURVEY MAP

LAKE BONE (SOUTH HALF)  
 SECTIONS 5-6-7-8-17-18-20-31-32  
 TOWNSHIP 35-36 N.  
 RANGE 16 W.  
 TOWN BONE LAKE-GEORGETOWN  
 COUNTY POLK

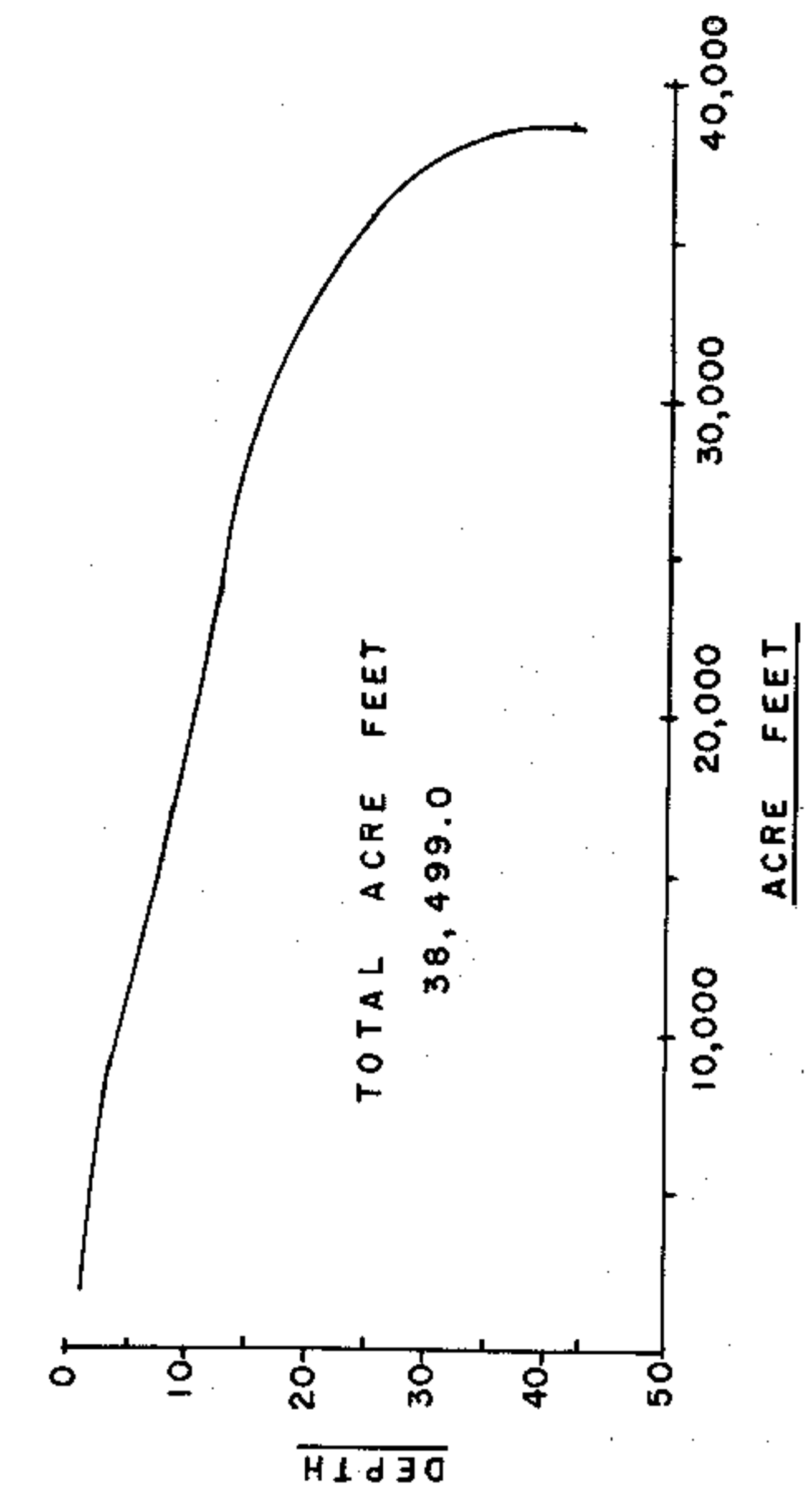
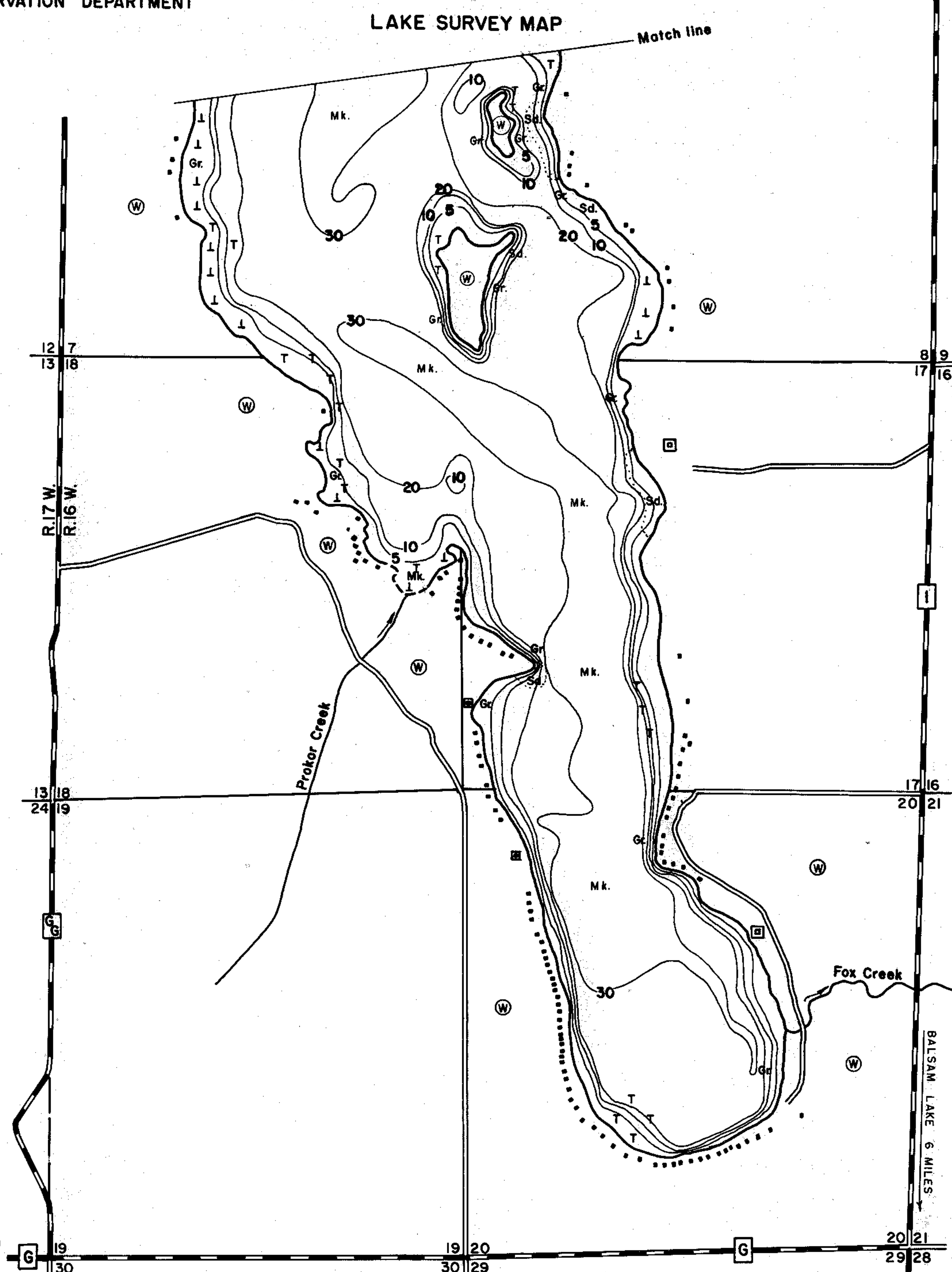
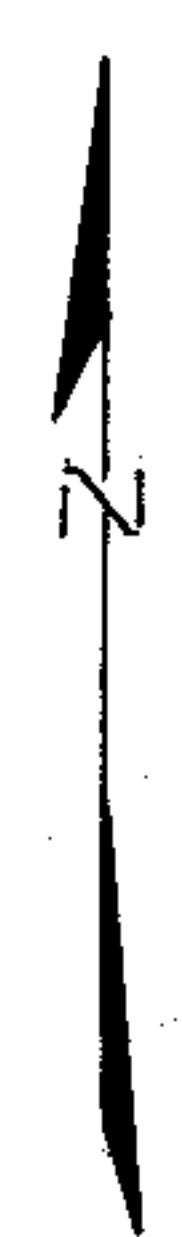

FIELD WORK BY: R. Hopke, E. Nelson  
 DRAWN BY: W. Johnson  
 LAKE MAPPED AUGUST 1963  
 SOURCE OF INFORMATION W.C.D.  
 SOUNDINGS RECORDING SONAR  
 TOTAL ALK. 122 PPM.

1,000' 0' 1,000' 2,000' 3,000' 4,000' 5,000'  
 SCALE  
 ◇ ACCESS      ◀ ACCESS WITH PARKING      ◆ BOAT LIVERY

AREA 1,781 Acres  
 TOTAL SHORELINE 12.5 Miles  
 MAX. DEPTH 43 Feet  
 SCALE: As shown

Source: Wisconsin Department of Natural Resources 608-266-2621  
Bone Lake – Polk County, Wisconsin DNR Lake Map  
Date – Aug 1963 - Historical Lake Map - Not for Navigation  
A Public Document - Please Identify the Source when using it.