

LAKE SURVEY MAP

TABOR LAKE
BURNETT COUNTY
SEC. 17, 18, 19 T. 41 N. R. 15 W.

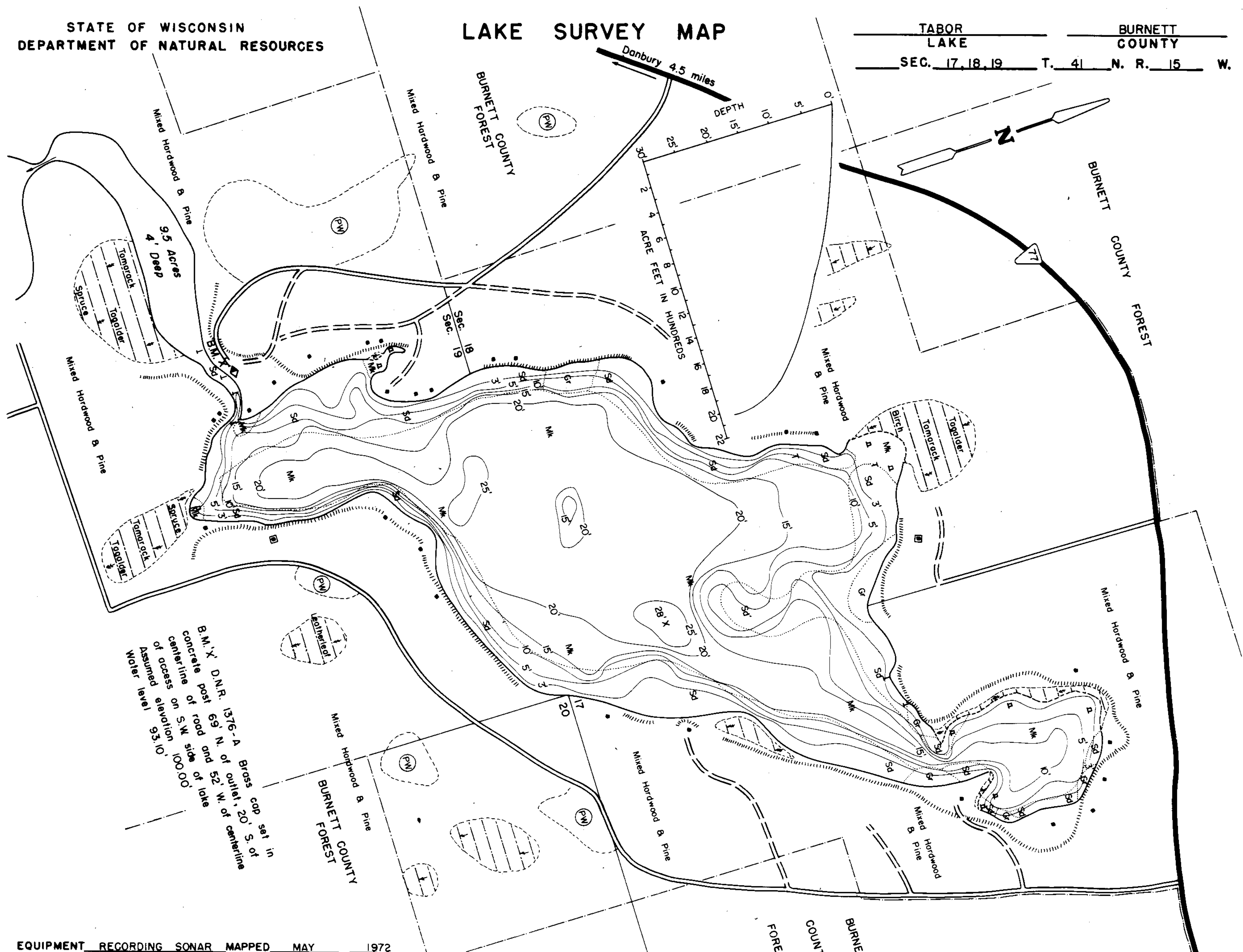

B.M. X, D.N.R. 1376-A
concrete post 69' N. of outlet, 20' S. of
centerline of road and 52' N. of centerline
of access on S.W. side of lake
Assumed elevation 93.01'
Water level

EQUIPMENT RECORDING SONAR MAPPED MAY 1972

- | TOPOGRAPHIC SYMBOLS | | LAKE BOTTOM SYMBOLS | |
|-----------------------|---------------------------|---------------------|-----------------------------|
| (B) Brush | Steep slope | P. Peat | B. Boulders |
| (FW) Partially wooded | ~ Indefinite shoreline | Mk. Muck | ☼ Stumps & Snags |
| (W) Wooded | ~ Marsh | C. Clay | ☼ Rock danger to navigation |
| (C) Cleared | ~ Spring | M. Marl | T. Submergent vegetation |
| (P) Pastured | ~ Intermittent stream | Sd. Sand | ⊥ Emergent vegetation |
| (A) Agricultural | ~ Permanent inlet | Sl. Silt | ⊥ Floating vegetation |
| B.M. Bench Mark | ~ Permanent outlet | Gr. Gravel | ⊥ Brush shelters |
| ■ Dwelling | ~ Dam | R. Rubble | |
| ■ Resort | ~ D.N.R. State owned land | Br. Bedrock | |
| ■ Camp | | | |



Access Access with Parking Boat Livery

Drawn by: C. Holt
Field work by: C. Busch, G. Lund, L. Sother

SPECIES OF FISH	Abundance		
	Abundant	Common	Present
Muskie			
N. Pike		X	
Walleye		X	
L.M. Bass		X	
S.M. Bass		X	
Panfish		X	
Trout			

WATER AREA 156.7 ACRES
 UNDER 3 FT. 15 %
 OVER 20 FT. 30 %
 MAX. DEPTH 28 FEET.
 TOTAL ALK. 49 P.P.M.
 VOLUME 2038 ACRE FT.
 SHORELINE 3.0 MILES

Source: Wisconsin Department of Natural Resources 608-266-2621
Tabor Lake – Burnett County, Wisconsin DNR Lake Map
Date – May 1972 - Historical Lake Map - Not for Navigation
A Public Document - Please Identify the Source when using it.