

# LAKE SURVEY MAP

YELLOW LAKE  
SEC. 19, 20, 29, 30, 31 T. 39 N. R. 16 W.  
6 39 16  
25, 36 40 17

Little Yellow Lake  
348.1 Acres  
Max. Depth 21'

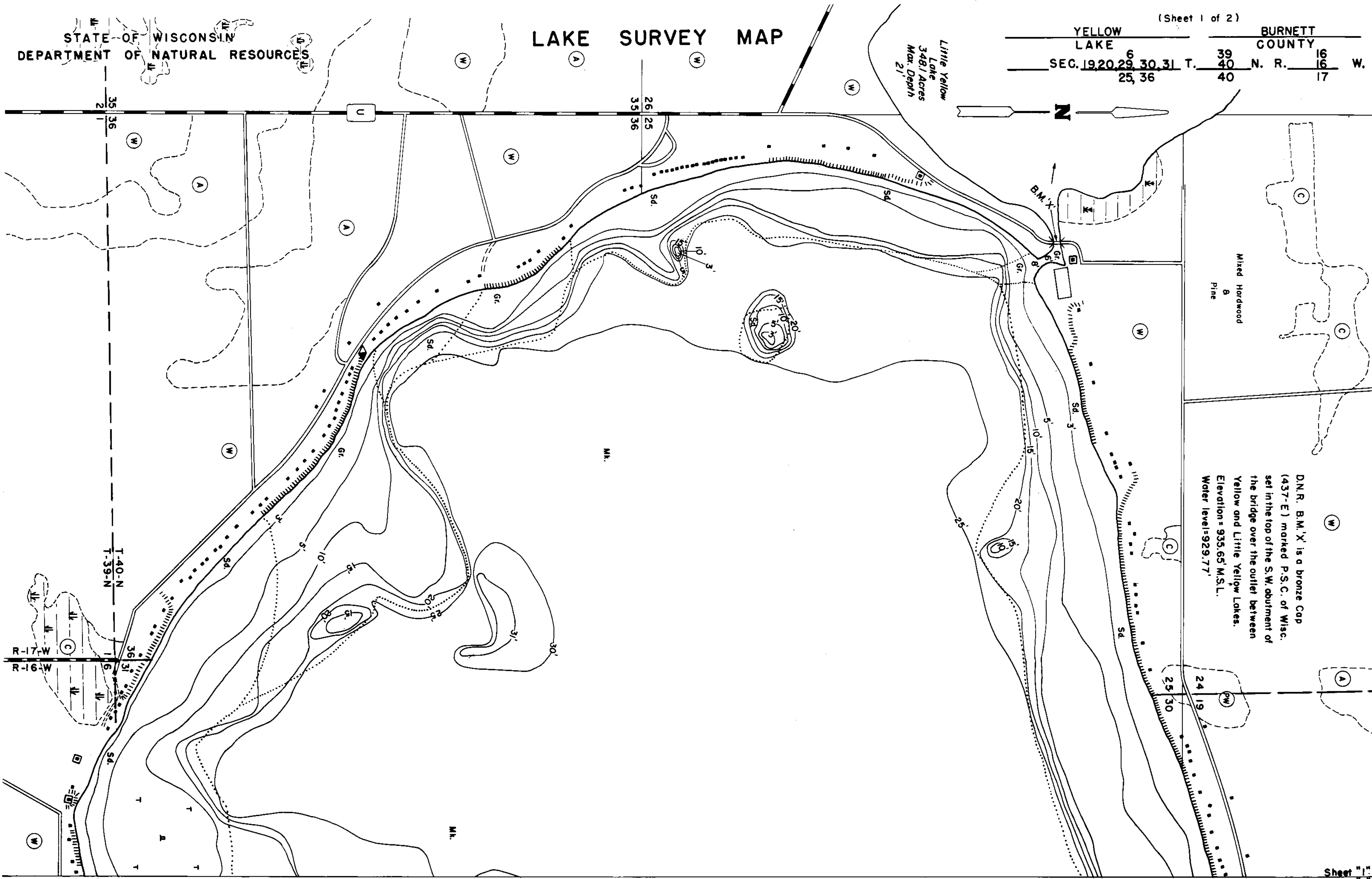

D.N.R. B.M. 'X' is a bronze cap (437-E) marked P.S.C. of Wisc. set in the top of the S.W. abutment of the bridge over the outlet between Yellow and Little Yellow Lakes.  
Elevation = 935.65' M.S.L.  
Water level = 929.77'

Sheet "1"  
Sheet "2"

EQUIPMENT RECORDING SONAR MAPPED AUGUST 1973  
MONTH YEAR

TOPOGRAPHIC SYMBOLS

- (B) Brush
- (W) Partially wooded
- (W) Wooded
- (C) Cleared
- (P) Pastured
- (A) Agricultural
- B.M. Bench Mark
- Dwelling
- Resort
- Camp

LAKE BOTTOM SYMBOLS

- Steep slope
- Indefinite shoreline
- Marsh
- Spring
- Intermittent stream
- Permanent inlet
- Permanent outlet
- Dam
- D.N.R. State owned land
- P. Peat
- Mk. Muck
- C. Clay
- M. Marl
- Sd. Sand
- St. Silt
- Gr. Gravel
- R. Rubble
- Bc. Bedrock
- B Boulders
- Stumps & Snags
- Rock danger to navigation
- T Submergent vegetation
- Emergent vegetation
- Floating vegetation
- Brush shelters

SPECIES OF FISH

	Abundant	Common	Present
Muskie		X	X
N. Pike		X	X
Walleye	X	X	X
L. M. Bass	X	X	X
S. M. Bass	X	X	X
Panfish	X	X	X
Lake Sturgeon		X	X
Cisco		X	X

WATER AREA 2287.0 ACRES  
UNDER 3 FT. 7 %  
OVER 20 FT. 68 %  
MAX. DEPTH 31 FEET.  
TOTAL ALK. 80 P.P.M.  
VOLUME 43334.2 ACRE FT.  
MAIN SHORELINE 7.87 MI.  
ISLAND SHORELINE MI.



Access Access with Parking Boat Livery

Drawn by: G. Thuesen  
Field work by: C. Busch, K. Cable, L. Sather



EQUIPMENT RECORDING SONAR MAPPED AUGUST 1973

- | TOPOGRAPHIC SYMBOLS   |                         | LAKE BOTTOM SYMBOLS |                           |
|-----------------------|-------------------------|---------------------|---------------------------|
| (B) Brush             | Steep slope             | P. Peat             | B. Boulders               |
| (PW) Partially wooded | Indefinite shoreline    | Mk. Muck            | Stumps & Snags            |
| (W) Wooded            | Marsh                   | C. Clay             | Rock danger to navigation |
| (C) Cleared           | Spring                  | M. Marl             | T Submergent vegetation   |
| (P) Pastured          | Intermittent stream     | Sd. Sand            | Emergent vegetation       |
| (A) Agricultural      | Permanent inlet         | St. Silt            | Floating vegetation       |
| B.M. Bench Mark       | Permanent outlet        | Gr. Gravel          | Brush shelters            |
| ■ Dwelling            | Dam                     | R. Rubble           |                           |
| □ Resort              | D.N.R. State owned land | Bc. Bedrock         |                           |
| □ Camp                |                         |                     |                           |

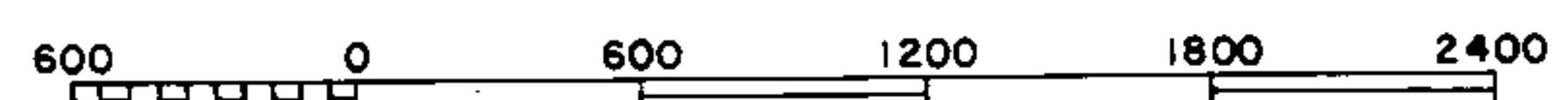

SCALE  
◆ Access    ◆ Access with Parking    ◆ Boat Livery

Drawn by: G. Thuesen  
Field work by: C. Busch, K. Cable, L. Sather

SPECIES OF FISH	ABUNDANCE		
	Abundant	Common	Present
Muskie			X
N. Pike			X
Walleye	X		X
L.M. Bass	X		X
S.M. Bass	X		X
Panfish	X		X
Lake Sturgeon			X
Cisco			X

WATER AREA 2287.0 ACRES  
UNDER 3 FT. 7 %  
OVER 20 FT. 68 %  
MAX. DEPTH 31 FEET.  
TOTAL ALK. 80 P.P.M.  
VOLUME 43334.2 ACRE FT.  
MAIN SHORELINE 7.87 MI.  
ISLAND SHORELINE MI.

Source: Wisconsin Department of Natural Resources 608-266-2621  
Yellow Lake – Burnett County, Wisconsin DNR Lake Map  
Date – Aug 1973 - Historical Lake Map - Not for Navigation  
A Public Document - Please Identify the Source when using it.