

# LAKE SURVEY MAP

LAKE MUCK  
 SECTION 35-36  
 TOWNSHIP 43 N  
 RANGE 12 W  
 TOWN OF WASCOTT  
 COUNTY DOUGLAS

FORM FI-117

WISCONSIN CONSERVATION DEPARTMENT  
 BIOLOGY DIVISION  
 LAKE AND STREAM IMPROVEMENT SECTION

*1/8 Mi. To C.T.H. T North*

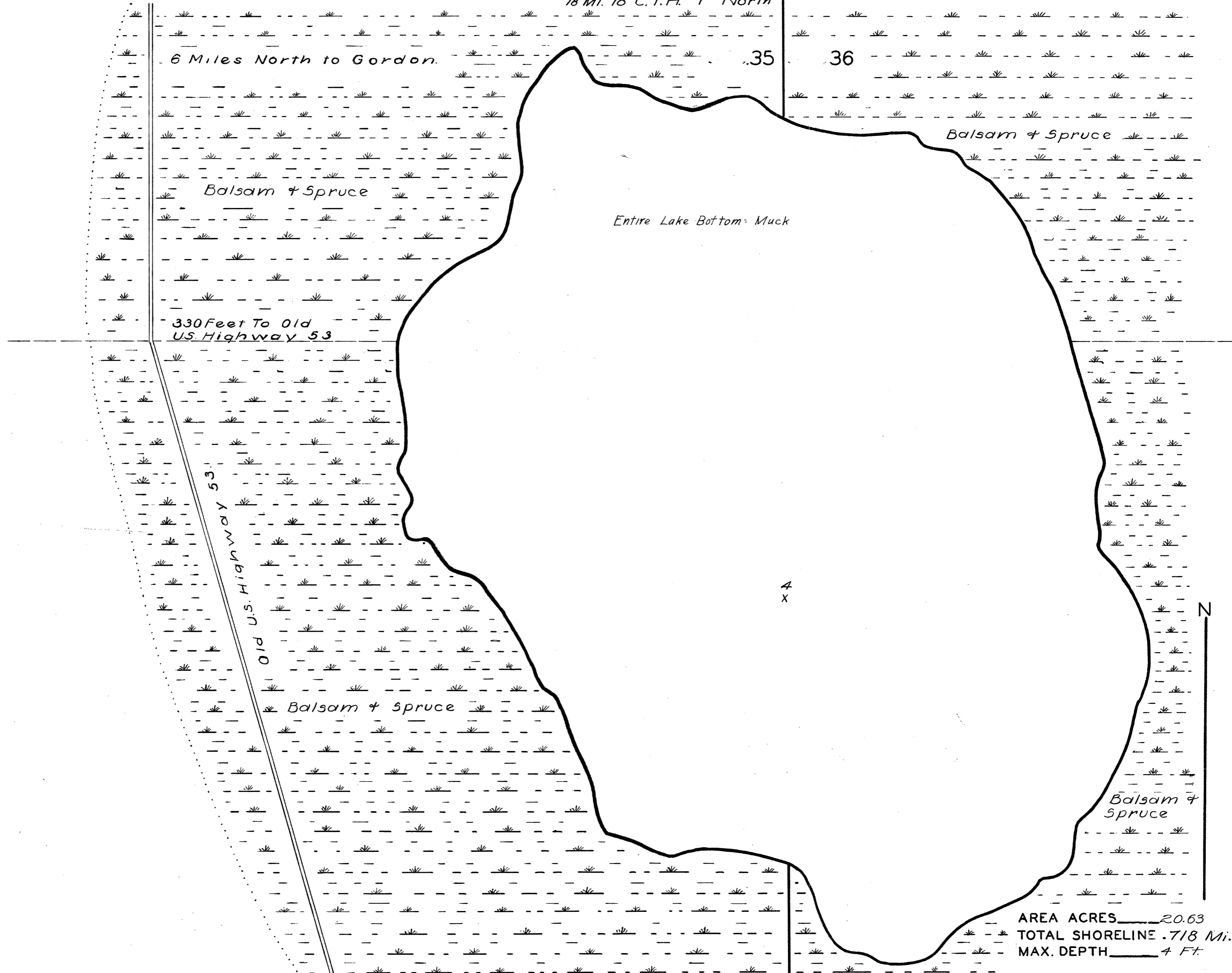

DATE Feb. 5 1941.  
 COMPILED BY \_\_\_\_\_  
 TRACED BY W.P.S.-N.L.M.(W.R.A.)  
 SOURCE OF INFORMATION W.R.A. Lake Survey Project.  
 \_\_\_\_\_  
 \_\_\_\_\_  
 SOUNDINGS At 165' Intervals.  
 \_\_\_\_\_  
 \_\_\_\_\_  
 DATES OF MAP REVISION \_\_\_\_\_  
 \_\_\_\_\_  
 WORK AGENCY W. P. A.

SCALE 1 inch Equals 110 Feet.

### LAKE IMPROVEMENT RECORD

TYPE	DATE	_____	_____	_____
◇ BRUSH REFUGES	_____	_____	_____	_____
~ SAPLING TANGLES	_____	_____	_____	_____
□ SPAWNING BOXES	_____	_____	_____	_____
* MINNOW SPAWERS	_____	_____	_____	_____
TOTAL _____				

### LEGEND

- WEED BEDS
- ⊙ ROCKY SHOALS
- Sd SAND
- Cl CLAY
- Gr GRAVEL
- Mk MUCK
- DWELLING
- ABANDONED DWELLING
- ▣ RESORT

*Checked  
 W.P.S.  
 E.M.K.  
 7/2/41*

Source: Wisconsin Department of Natural Resources 608-266-2621  
Muck Lake - Douglas County, Wisconsin DNR Lake Map  
Feb.1941 Historical Lake Map Not for Navigation  
A Public Document - Please Identify the Source when using it.