

LAKE SURVEY MAP

WISCONSIN CONSERVATION DEPARTMENT
BIOLOGY DIVISION
LAKE AND STREAM IMPROVEMENT SECTION

LAKE TRAPPERS
SECTION 27-26
TOWNSHIP 44 N
RANGE 6 W
TOWN OF PRATT
COUNTY BAYFIELD

FORM FH17

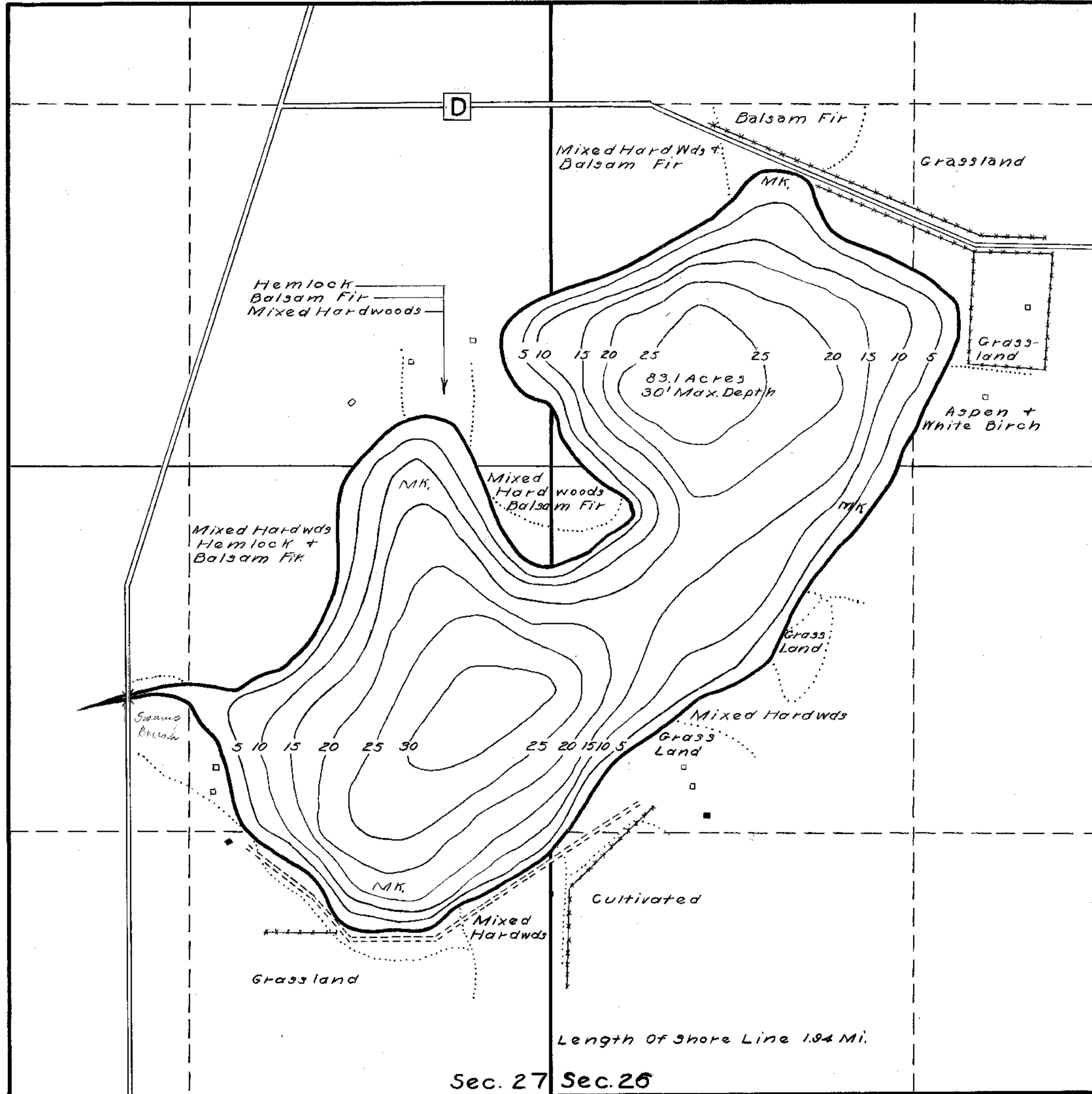

Length of Shore Line 1.94 Mi.

Sec. 27 Sec. 26

DATE Aug 4, 1939
COMPILED BY _____
TRACED BY W.P.S. (W.P.A.)
SOURCE OF INFORMATION
U.S. Forest Service Map
Lake + Stream Survey
SOUNDINGS Intervals = 5 Ft.
U.S. Forest Service
DATES OF MAP REVISION _____
WORK AGENCY _____

SCALE 1 inch = 330 Ft.

LAKE IMPROVEMENT RECORD

TYPE	DATE	_____	_____	_____	_____
⊗ BRUSH REFUGES	_____	_____	_____	_____	_____
- SAPLING TANGLES	_____	_____	_____	_____	_____
□ SPAWNING BOXES	_____	_____	_____	_____	_____
* MINNOW SPAWNERS	_____	_____	_____	_____	_____
TOTAL	_____	_____	_____	_____	_____

LEGEND

⊗ WEED BEDS
⊘ ROCKY SHOALS
3d SAND
c/ CLAY
Gr GRAVEL
MK MUCK
■ DWELLING
□ ABANDONED DWELLING
⊠ RESORT

Source: Wisconsin Department of Natural Resources 608-266-2621
Trappers Lake – Bayfield County, Wisconsin DNR Lake Map
Date – Aug 1939 - Historical Lake Map - Not for Navigation
A Public Document - Please Identify the Source when using it.