

LAKE SURVEY MAP

LAKE CHELONIA
 SECTION 5-8
 TOWNSHIP 45 N
 RANGE 7 W
 TOWN OF DRUMMOND
 COUNTY BAYFIELD

FORM FI-117

WISCONSIN CONSERVATION DEPARTMENT
 BIOLOGY DIVISION
 LAKE AND STREAM IMPROVEMENT SECTION

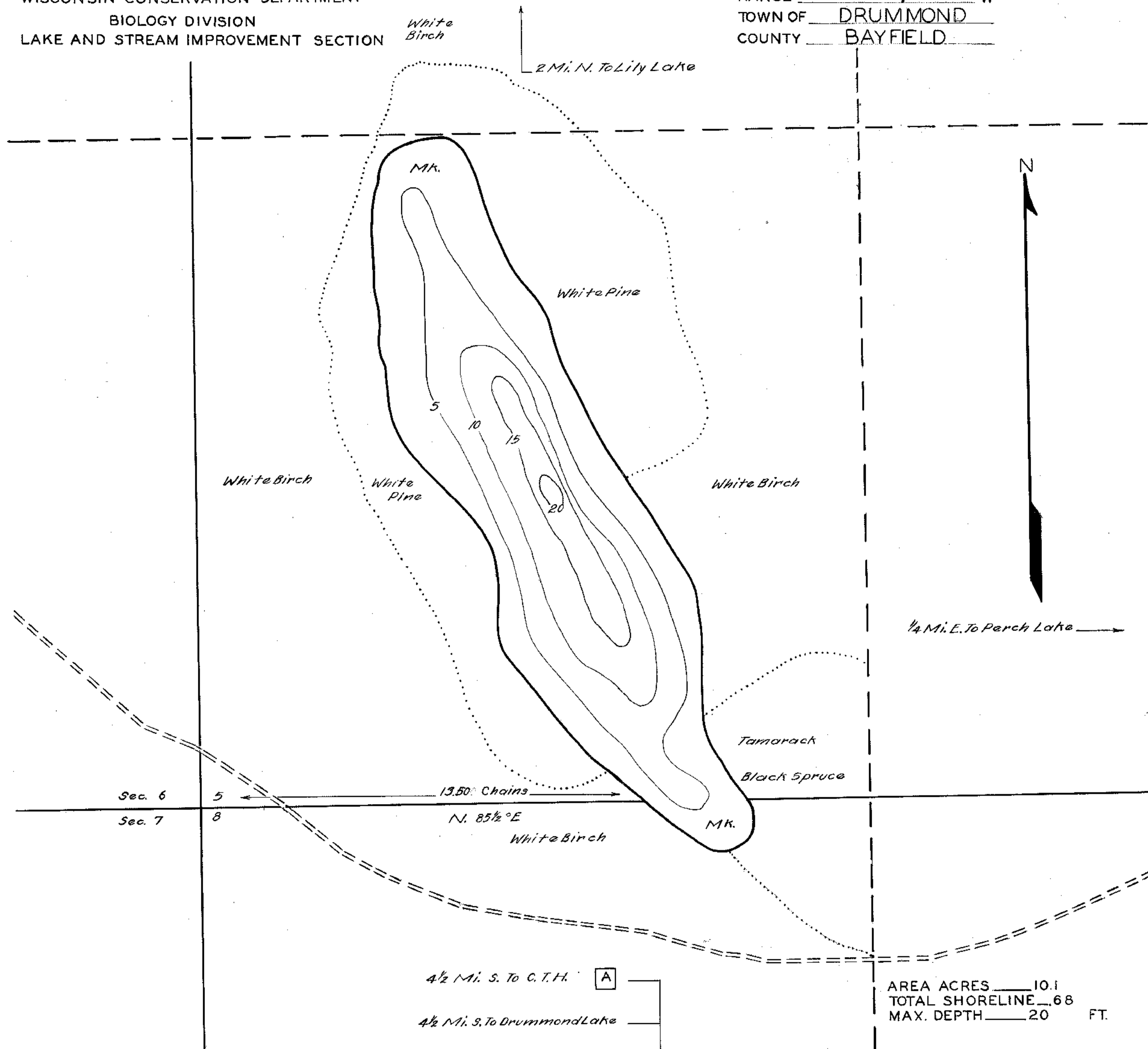

AREA ACRES 10.1
 TOTAL SHORELINE 68
 MAX. DEPTH 20 FT.

SCALE 1 INCH EQUALS 165 FT.
 0 10 50 100 150 200 300 400 500 FT.

- LEGEND
- WEED BEDS
 - ROCKY SHOALS
 - SD. SAND
 - CL. CLAY
 - GR. GRAVEL
 - MK. MUCK
 - DWELLING
 - ABANDONED DWELLING
 - RESORT

DATE OCT. 16 1941
 COMPILED BY _____
 TRACED BY W.T.Z. (W.P.A.)
 SOURCE OF INFORMATION _____
U.S. FOREST LAKE & STREAM SURVEY

 SOUNDINGS _____

 DATES OF MAP REVISION _____

 WORK AGENCY _____

Checked
 W.P.S.
 E.M.K.
 Nov. 6. 1941

Source: Wisconsin Department of Natural Resources 608-266-2621
Chelonia Lake – Bayfield County, Wisconsin DNR Lake Map
Date – Oct 1941 - Historical Lake Map - Not for Navigation
A Public Document - Please Identify the Source when using it.