

EQUIPMENT RECORDING SONAR MAPPED JUNE 1970

TOPOGRAPHIC SYMBOLS		LAKE BOTTOM SYMBOLS	
(B) Brush	Steep slope	P. Peat	B Boulders
(PW) Partially wooded	- - - Indefinite shoreline	Mk. Muck	% Stumps & Snags
(W) Wooded	Marsh	C. Clay	⊗ Rock danger to navigation
(C) Cleared	○ Spring	M. Marl	T Submergent vegetation
(P) Pastured	— Intermittent stream	Sd. Sand	⌞ Emergent vegetation
(A) Agricultural	— Permanent inlet	St. Silt	⊠ Floating vegetation
B.M. Bench Mark	— Permanent outlet	Gr. Gravel	⊕ Brush shelters
■ Dwelling	⌞ Dam	R. Rubble	
▣ Resort	D.N.R. State owned land	Bc. Bedrock	
⊠ Camp			



◆ Access ◆ Access with Parking ◆ Boat Livery

Drawn by: C. Holt
Field work by: C. Busch, C. Stocks, L. Sather

B.M. 'X' Railroad spike set in base of a 14" oak tree on the S.W. side of lake, 45' S. of lake, 66' S.W. of end of walking trail and 75' E. of a 'Y' shaped Norway Pine
Assumed elevation 10000'
Water level 85.04 taken 6/18/70
" " 84.78 taken 8/31/70

SPECIES OF FISH	Abundance		
	Abundant	Common	Present
Muskie			
N. Pike			
Walleye			
L.M. Bass	X		
S.M. Bass	X		
Panfish	X		
Trout			

WATER AREA 92.7 ACRES
UNDER 3 FT. 15 %
OVER 20 FT. 40 %
MAX. DEPTH 34 FEET.
TOTAL ALK. 44 P.P.M.
VOLUME 1411 ACRE FT.
SHORELINE 3.15 MILES

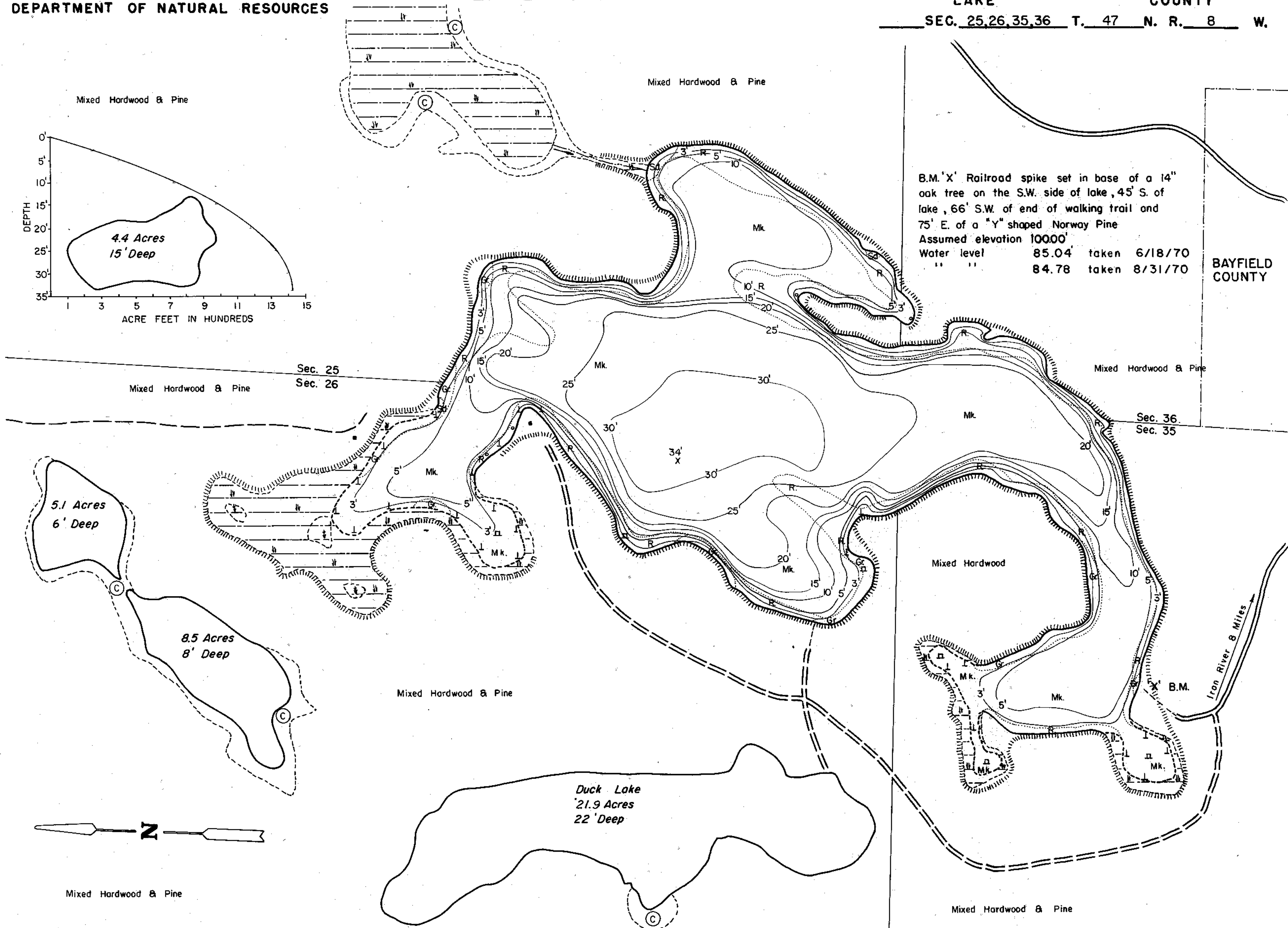

BAYFIELD COUNTY

Source: Wisconsin Department of Natural Resources 608-266-2621
Crooked Lake – Bayfield County, Wisconsin DNR Lake Map
Date – Jun 1970 - Historical Lake Map - Not for Navigation
A Public Document - Please Identify the Source when using it.