

LAKE SURVEY MAP

LAKE MOON
 SECTION 17-18
 TOWNSHIP 47 N
 RANGE 8 W
 TOWN OF IRON RIVER
 COUNTY BAYFIELD

FORM F-11

WISCONSIN CONSERVATION DEPARTMENT
 BIOLOGY DIVISION
 LAKE AND STREAM IMPROVEMENT SECTION

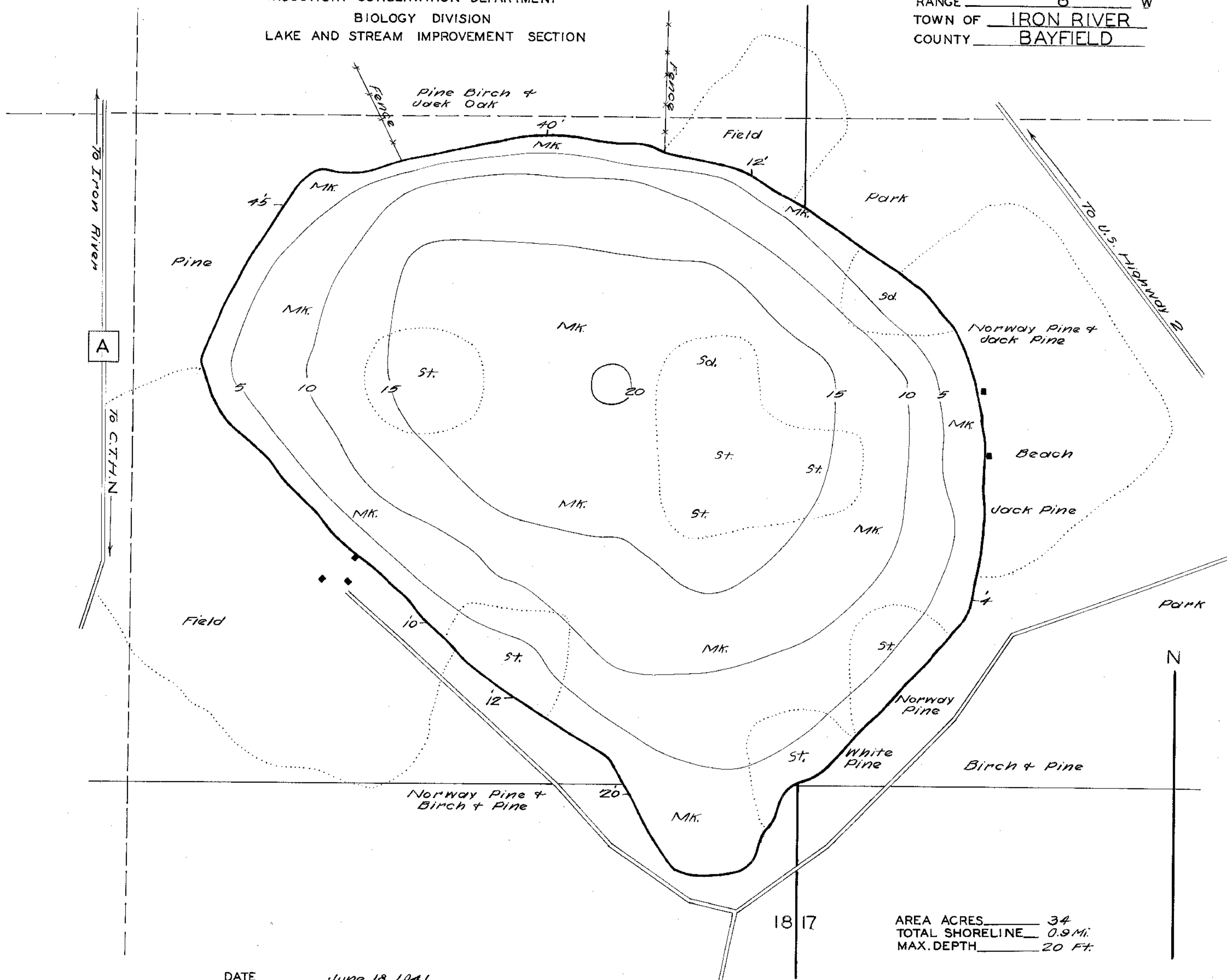

AREA ACRES 34
 TOTAL SHORELINE 0.9 Mi.
 MAX. DEPTH 20 Ft.

SCALE 1 inch Equals 150 Ft.

DATE June 18 1941
 COMPILED _____
 TRACED BY W.P.S. (W.P.A.)
 SOURCE OF INFORMATION W.P.A. Lake Survey Project
Aerial Photo
 SOUNDINGS AT 200' Intervals
 DATES OF MAP REVISION _____
 WORK AGENCY W.P.A.

LAKE IMPROVEMENT RECORD

TYPE	DATE			
○ BRUSH REFUGES	_____	_____	_____	_____
~ SAPLING TANGLES	_____	_____	_____	_____
□ SPAWNING BOXES	_____	_____	_____	_____
* MINNOW SPAWNERS	_____	_____	_____	_____
TOTAL	_____	_____	_____	_____

LEGEND

- WEED BEDS
- ROCKY SHOALS
- Sd. SAND
- Cl. CLAY
- Gv. GRAVEL
- Mk. MUCK
- DWELLING
- ABANDONED DWELLING
- RESORT
- St. SILT

Checked
 W.P.S.
 6/27/41

Source: Wisconsin Department of Natural Resources 608-266-2621
Moon Lake – Bayfield County, Wisconsin DNR Lake Map
Date – Jun 1941 - Historical Lake Map - Not for Navigation
A Public Document - Please Identify the Source when using it.