

Inch Lake  
31.4 Acres  
4' Max. Depth

Mixed Hardwood  
&  
Pine

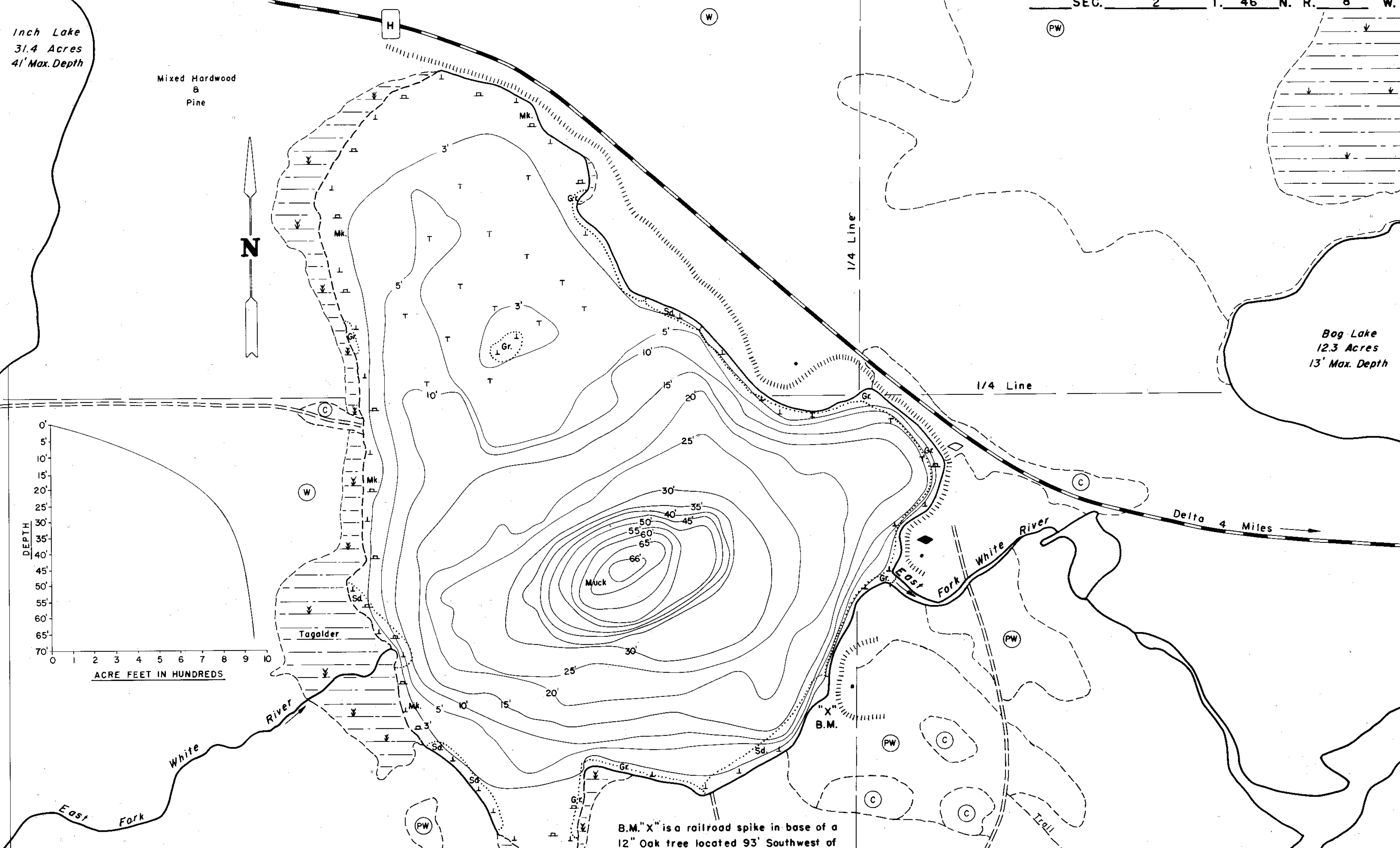

Bog Lake  
12.3 Acres  
13' Max. Depth

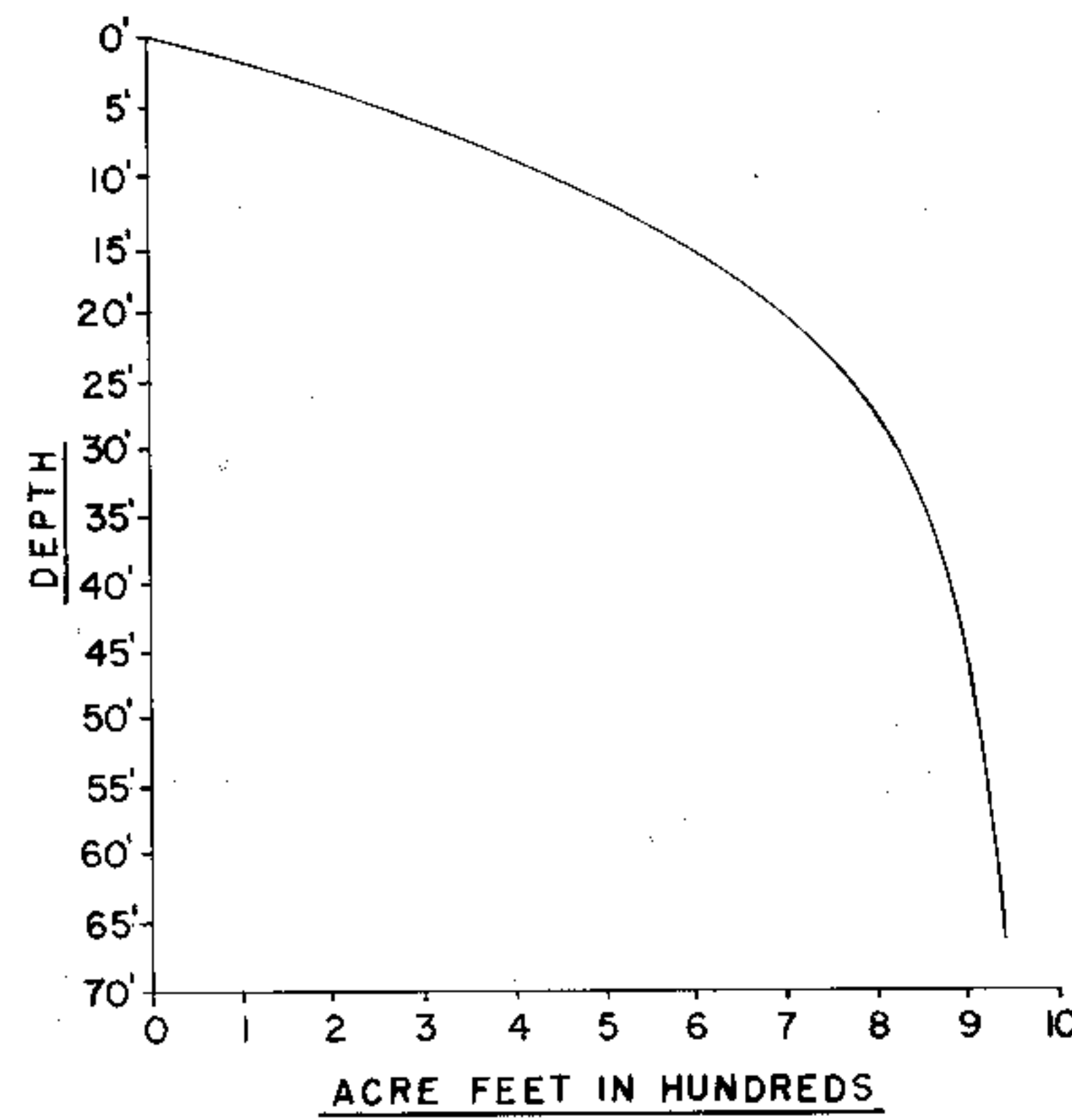

B.M. "X" is a railroad spike in base of a 12" Oak tree located 93' Southwest of the Southwest corner of the new cabin and 42' East of the lake on the Southeast side of lake.

Assumed Elevation = 100.00'  
Water Level = 95.05'

EQUIPMENT RECORDING SONAR MAPPED JUNE 1975

- TOPOGRAPHIC SYMBOLS
- (B) Brush
  - (PW) Partially wooded
  - (W) Wooded
  - (C) Cleared
  - (P) Pastured
  - (A) Agricultural
  - B.M. Bench Mark
  - Dwelling
  - Resort
  - ▣ Camp

- LAKE BOTTOM SYMBOLS
- P. Peat
  - Mk. Muck
  - C. Clay
  - M. Marl
  - Sd. Sand
  - St. Silt
  - Gr. Gravel
  - R. Rubble
  - Br. Bedrock
  - Steep slope
  - Indefinite shoreline
  - Marsh
  - Spring
  - Intermittent stream
  - Permanent inlet
  - Permanent outlet
  - Dam
  - D.N.R. State owned land
  - B. Boulders
  - Stumps & Snags
  - Rock danger to navigation
  - T Submergent vegetation
  - Emergent vegetation
  - Floating vegetation
  - Brush shelters

SPECIES OF FISH	Abundance		
	Abundant	Common	Present
Muskie			
N. Pike		X	
Walleye			
L.M. Bass		X	
S.M. Bass			
Panfish		X	
Trout			

WATER AREA 66.8 ACRES  
 UNDER 3 FT. 19 %  
 OVER 20 FT. 27 %  
 MAX. DEPTH 66 FEET.  
 TOTAL ALK. 55 P.P.M.  
 VOLUME 939.2 ACRE FT.  
 MAIN SHORELINE 1.5 MI.  
 ISLAND SHORELINE 0 MI.

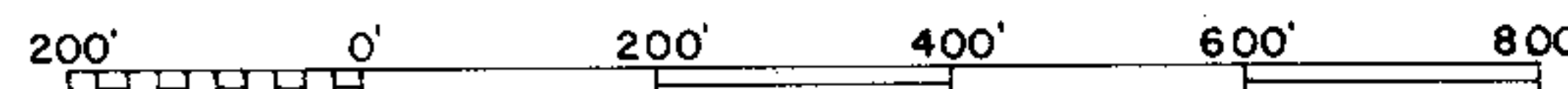

Access Access with Parking Boat Livery

Drawn by: G. Thuesen  
Field work by: C. Busch, K. Cable, L. Sather

Source: Wisconsin Department of Natural Resources 608-266-2621  
Hildur Lake – Bayfield County, Wisconsin DNR Lake Map  
Date – Jun 1975 - Historical Lake Map - Not for Navigation  
A Public Document - Please Identify the Source when using it.