

NOTICE OF ADOPTION OF AMENDMENT TO
AN ORDINANCE TO REGULATE BOATING UPON THE WATERS OF BASS LAKE
AND PRESCRIBING PENALTIES FOR VIOLATION THEREOF

Notice is hereby given that on November 15, 1999, the Bass Lake Rehabilitation District adopted the following amendments to AN ORDINANCE TO REGULATE BOATING UPON THE WATERS OF BASS LAKE AND PRESCRIBING PENALTIES FOR VIOLATION THEREOF. The amendatory language is underlined.

AMENDMENT TO ORDINANCE TO REGULATE BOATING
UPON THE WATERS OF BASS LAKE AND
PRESCRIBING PENALTIES FOR VIOLATION THEREOF.

The Bass Lake Rehabilitation District of the Township of St. Joseph and Township of Somerset, St. Croix County, does hereby ordain as follows:

Section I. Applicability and Enforcement

- (a) The provisions of this Ordinance shall apply to the waters of Bass Lake in the jurisdiction of the Town of St. Joseph and the Town of Somerset, St. Croix County, Wisconsin.
- (b) This chapter shall be enforced by the officers of the Bass Lake Water Patrol and the St. Croix County Sheriff's Department.

Section II. Intent

The intent of this ordinance is to provide for public health, safety and welfare during high water periods when the Bass lake surface level exceeds the ordinary high water mark of 886.1 feet above sea level, as well as when the lake recedes and/or is stabilized. A state of emergency exists when water levels are above 886.1 feet that mark for Bass Lake and the shoreline area surrounding Bass Lake in both the Township of St. Joseph and the Township of Somerset. Many homes are can flooded; many others are in imminent danger of flooding; many septic systems are under water or about to be under water; and the shoreline is extremely susceptible to erosion. Because of our concern for the water quality of the Lake and the potentially deleterious effect that the discharge of septic systems and large amounts of shoreline erosion will have, we have enacted this ordinance is enacted and necessary.

It is also the intent of this ordinance to provide for the public health, safety and welfare, including the public's interest in preserving the state's natural resources, by reducing the risk of bodily injury, property damage, shore erosion, and the spread of noxious aquatic weeds which can arise from the operation of speeding watercraft near shore, buoys, subsurface structures, docks, piers, anchored floats and areas of special aquatic vulnerability.

Section III. Definitions

- (a) "Slow-No-Wake" means that speed at which a boat moves as slowly as possible while still maintaining steerage control.

- (b) "Public access" means the access to the water by means of the public landing on the north end of Bass Lake.
- (c) "Boat" means all watercraft including but not limited to personal watercraft and jet skis, as well as any persons or objects towed by such watercraft.

Section IV. Slow-No-Wake Restrictions

- (a) No boat shall be operated ~~person shall operate a boat~~ at a speed greater than "slow-no-wake" on Bass Lake during periods when the surface water level exceeds the ~~ordinary-high-water mark of 886.1 feet above sea level.~~
- (b) No boat shall be operated at a speed greater than "slow-no-wake" on Bass Lake
 - (1) during any time from 8 p.m. to 8 a.m.; and
 - (2) at any time within 100 feet of any shore, ~~buoy~~ buoyed restricted area, dock, pier, anchored float, or restricted aquatic area designated and identified in this in Section IV(c)(1) and (2) of this ordinance. Provided, in addition, consistent with the Wisconsin Statutes regulating personal watercraft, including jet skis, the slow-no-wake area shall be 200 ft. from shore for such personal watercraft.
- (c) ~~The following areas of special aquatic vulnerability are hereby designated and identified:~~ local conditions on Bass Lake necessitating the placement of buoys creating buoyed restricted areas include the existence of areas of special aquatic vulnerability, the location of a busy public landing, and the presence of potentially hazardous subsurface conditions. These slow-No-Wake areas have been identified and designated as follows:
 - (1) ~~Northwest Bay; from west of a line running from the Northeast corner of parcel 201B (Jordan) to Parcel 202C (Packard); S1/2 Section 14, T30N R19W; and~~
 - (2) ~~Kelly's Swamp; the pond surrounded by parcels 253A, K, L, M, N, O and S; N1/2 Section 26, T30N, R19W.~~
 - (1) Northwest Bay; from west of a line running from the northeast corner of parcel 201B (Jordan) to the northeast corner of parcel 202C (Packard); S 1/2 Section 14, T 30 N, R 19 W;
 - (2) Kelly's swamp; the entire pond surrounded by parcels 253A, K, L, M, N, O and S; Section 26, T 30 N, R 19 W, as well as 100 feet out form its entrance;

- (3) Simon's Point, adjacent to parcel 253U; Section 26, T 30 N, R 19 W; and
- (4) the public access landing on 153rd Avenue.
- (d) Buoys may be placed in proximity to the locations and/or entrances of the above-designated restricted aquatic areas, Simon's Point, and the Public Landing, as well as such locations where the placement thereof is authorized by the Board of Commissioners.
- (e) Except as more restrictively provided herein boating and safety laws provided in Sections 30.50 to 30.71, Wis. Stats., are hereby adopted by reference.

Section V. Posting Requirements

The Bass Lake Inland Lake Protection and Rehabilitation District shall place ~~and endeavor to maintain~~ a copy of this Ordinance at the public access landing point on Bass Lake, in accordance with the requirements of the Wis. Admin. Code.

Section VI. Penalties

Wisconsin state boating penalties as found in Sec. 30.80, Wis. Stats., and deposits as established in the Uniform Deposit and Bail Schedule established by the Wisconsin Judicial Conference, are hereby adopted by reference with all references ~~to fines amended to forfeitures and all references to imprisonment deleted.~~

Section VII. Severability

The provisions of this ordinance shall be deemed severable and it is expressly declared that the Bass Lake Inland Lake Protection and Rehabilitation District would have passed the other provisions of this ordinance irrespective of whether or not one or more provisions may be declared invalid. If any provision of this ordinance or the application to any person or circumstances is held invalid, the remainder of the ordinance and the application of such provisions to other persons or circumstances shall not be affected.

Section VIII. Effective Date

This section will become effective upon passage and the day after publication.

Passed this 15th day of NOVEMBER, 1999.

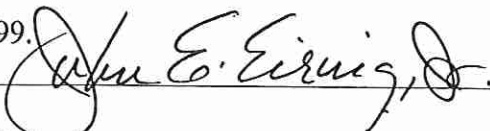

Chairperson

ATTEST:



Secretary

Placement Discontinue Change

BLE 2957 District _____

THE BASS LAKE REHAB. DISTRICT
 COUNTY OF ST. CROIX, WISCONSIN.

Instructions and qualifications on back of form. Complete form set (all 3 copies) and contact your local conservation warden.

SECTION I - APPLICANT AND PROPERTY OWNER

Property Owner's Name		Applicant's Name	
Street or Route		Street or Route	
City, State, Zip Code		City, State, Zip Code	
Telephone Number (include area code)		Telephone Number (include area code)	
I consent to the placement of water marker(s) adjacent to the waters of my private property.		Name of lake or body of water on which buoys are to be placed	
Property Owner's Signature		Date Signed	
		Location of marker(s)	
		Township	
		Range	
		Section	
Type of Marker(s)	Qty.	Type of Marker(s)	Qty.
Aid to Nav. Center	_____	Boat Excluded <input type="checkbox"/>	_____
Aid to Nav. Red	_____	Swim Area <input type="checkbox"/>	_____
Aid to Nav. Green	_____	Controlled Area <input type="checkbox"/>	_____
Mooring	_____	Hazard Warning <input type="checkbox"/>	_____
		Informational <input type="checkbox"/>	_____
Qty.		Describe:	
Non-standard		_____	

BASS LK. REHAB. DIST. / J. EIRING, CHAIR
1477 NORTH BAY ROAD
SOMERSET, WI 54025
715-247-3136
BASS LAKE
30N 19W 14-23-26

Type of Marker(s)	Qty.	Type of Marker(s)	Qty.	Message On Marker	Remarks
		Boat Excluded <input type="checkbox"/>			Name of Beach
		Swim Area <input type="checkbox"/>		Swim Area	
		Controlled Area <input type="checkbox"/>	<u>3</u>	<u>SLOW NO WAKE</u>	<u>000644</u>
		Hazard Warning <input type="checkbox"/>	<u>1</u>	<u>STUMP</u>	
		Informational <input type="checkbox"/>			

Attach a sketch(es) or chart(s) showing the proposed location of the marker(s). Express exact location of water marker(s) in distance from one or more fixed objects, whose location is known.

The above information provided in support of the application for placement of water marker(s) is true and correct.

Applicant's Signature John E. Eiring, (Chairman, B.L.R.D.) Date Signed 6-9-98

SECTION II - POLITICAL SUBDIVISION

Approved -- The above named applicant may place and maintain, subject to DNR approval, the described marker(s).
 Disapproved -- The placement of the described marker(s) may not take place.

Restrictions None Yes -Restrictions: _____

Approved By (Name) John E. Eiring Title Chairman Date Signed 6-9-98

Agency - Political Subdivision or DNR Bass Lake Rehab Dist. Applicant Shall Comply with all State and/or Local Requirements.

LEAVE BLANK -- DEPARTMENT OF NATURAL RESOURCES USE ONLY

Warden's Recommendation	LE Safety Specialist	<input checked="" type="checkbox"/> Approved <input type="checkbox"/> Disapproved
<input checked="" type="checkbox"/> Approved <input type="checkbox"/> Disapproved	By <u>TR Bokelman</u>	Date Signed <u>05-11-99</u>
By (Warden's Signature) <u>David M. Hausman</u>	Date Signed <u>6-11-98</u>	Bureau of Law Enforcement <input checked="" type="checkbox"/> Approved <input type="checkbox"/> Disapproved
Ordinance on File <input checked="" type="checkbox"/> Yes <input type="checkbox"/> No <input type="checkbox"/> Not Required	By <u>William B. Engler</u>	Date Signed <u>7/29/99</u>

Permit Distribution: Copy 1 - Dept. of Natural Resources, Madison, Copy 2 - Political Subdivision, Copy 3 - Permittee.

Waterway marker(s) may not be placed until all the requirements of Section NR 5.09, Wis. Adm. Code, are met.

Figure 1.0.2

BASS LAKE
 Sections 14-23-26
 Township 30 North
 Range 19 West
 Somerset and
 St. Joseph Townships
 St. Croix County

Bass Lake

St. Croix County

2957

Lake Elevation of 886.96 ft. m.s.l.
 is maximum recorded high water mark



Lake Bottom Symbols

- T Submergent Vegetation
- J Emergent Vegetation
- Floating Vegetation
- sd Sand
- sl Silt
- gr Gravel

0 .125 .25 Miles

▲ Groundwater Monitoring Wells

250° OFF OF SIMONS' POINT, 30' (Tree Stump)

140th Ave.

230° OFF OF R. BENISH, 75' (KELLYS SWAMP) (SNW)

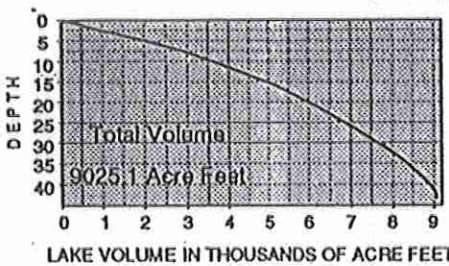
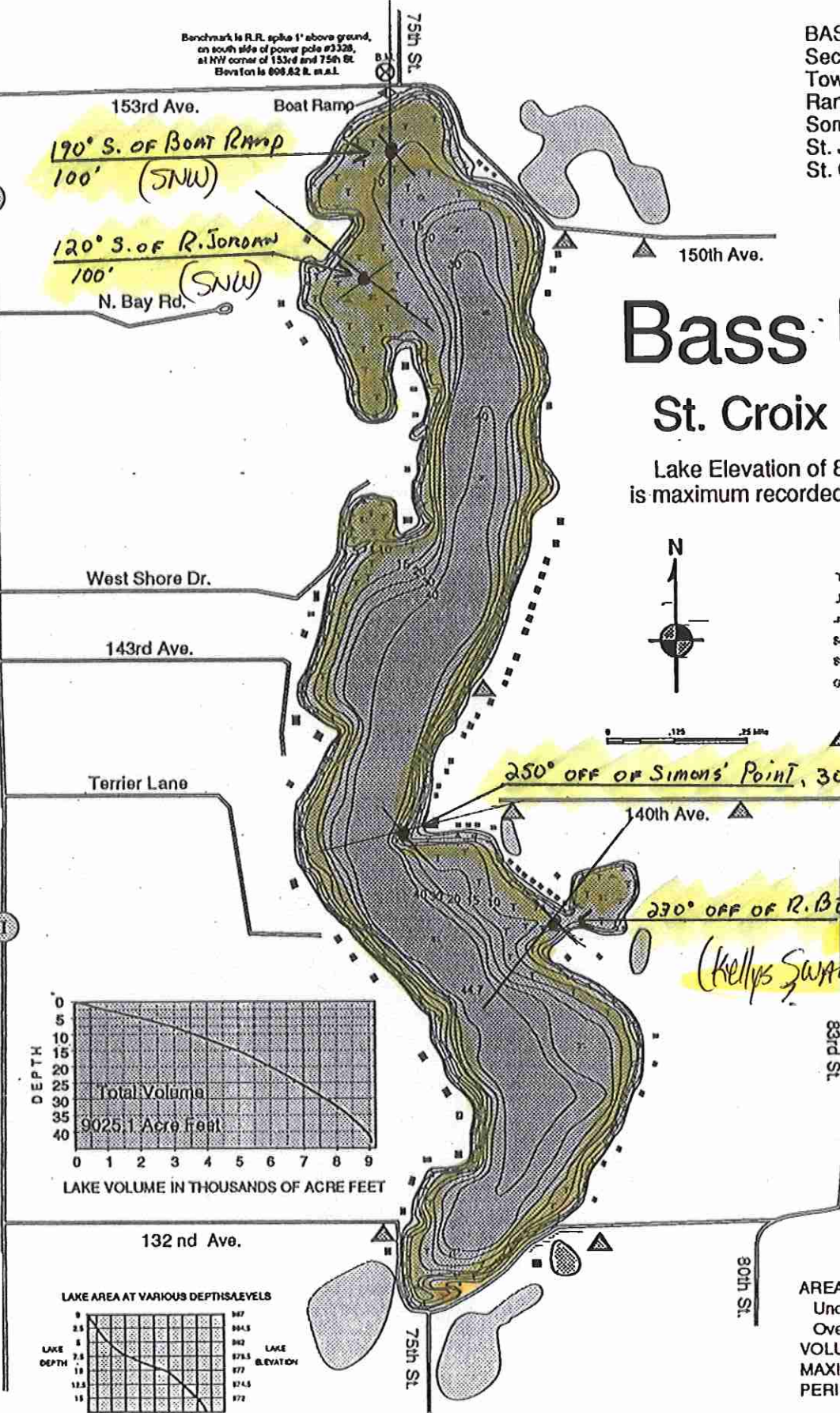

SPECIES OF FISH	Abundant	Common	Present
Northern Pike			X
Walleye			X
L M Bass		X	
Panfish	X		

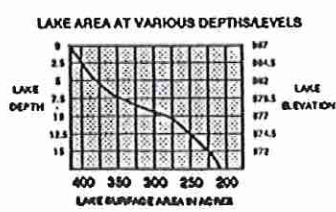

AREA 416.58 Acres
 Under 3 Feet 21.27 Acres
 Over 20 Feet 192.83 Acres
 VOLUME 9,057.37 Acre Feet
 MAXIMUM DEPTH 44.7 Feet
 PERIMETER 6.6 Miles

Lake Surveyed October, 1990

24 HOUR SLOW-NO-WAKE

Figure 1.0.2

BASS LAKE
 Sections 14-23-26
 Township 30 North
 Range 19 West
 Somerset and
 St. Joseph Townships
 St. Croix County

Bass Lake

St. Croix County

Lake Elevation of 886.96 ft. m.s.l.
 is maximum recorded high water mark

2957

Benchmark is P.L. spike 1' above ground,
 on south side of power pole #3325,
 at NW corner of 153rd and 75th St.
 Elevation is 886.92 ft. m.s.l.

Lake Bottom Symbols

- T Submergent Vegetation
- J Emergent Vegetation
- Floating Vegetation
- sa Sand
- sl Silt
- gr Gravel



Groundwater Monitoring Wells

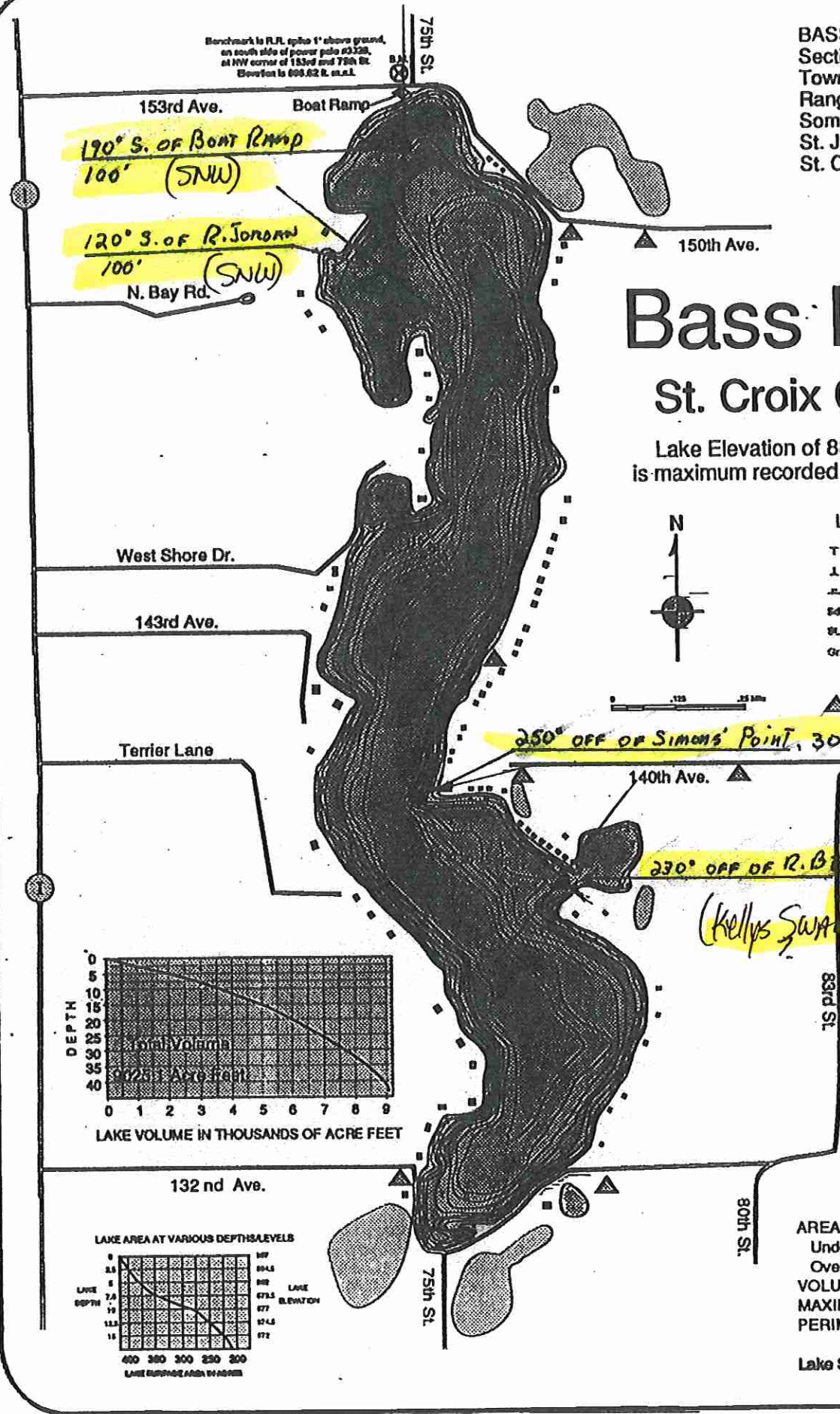

250° OFF OF SIMONS' POINT, 30' (Tree Stump)

230° OFF OF R. BENISH, 75' (SNW)
 (Kellys Swamp)

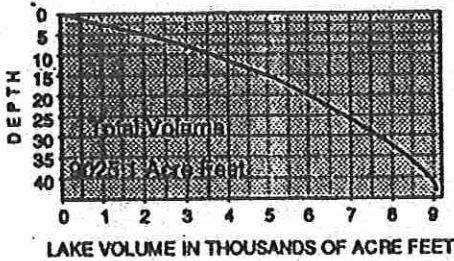

SPECIES OF FISH	Abundant	Common	Present
Northern Pike			X
Walleye			X
L M Bass		X	
Perch	X		

LAKE AREA AT VARIOUS DEPTHS/LEVELS



AREA 416.58 Acres
 Under 3 Feet 21.27 Acres
 Over 20 Feet 192.83 Acres
 VOLUME 9,057.37 Acre Feet
 MAXIMUM DEPTH 44.7 Feet
 PERIMETER 6.6 Miles

Lake Surveyed October, 1990

24 HOUR SLOW-NO-WAKE

AN ORDINANCE TO REGULATE BOATING UPON THE
WATERS OF BASS LAKE AND PRESCRIBING PENALTIES FOR VIOLATION THEREOF.

Section I. Applicability and Enforcement

- (a) The provisions of this Ordinance shall apply to the waters of Bass Lake in the jurisdiction of the Town of St. Joseph and the Town of Somerset, St. Croix County, Wisconsin.
- (b) This chapter shall be enforced by the officers of the Bass Lake Water Patrol and the St. Croix County Sheriff's Department.

Section II. Intent

The intent of this ordinance is to provide for public health, safety and welfare during high water periods when lake level exceeds the ordinary high water mark of 886.1. A state of emergency exists when water levels are above that mark for Bass Lake and the shoreline area surrounding Bass Lake in both the Township of St. Joseph and the Township of Somerset. Many homes are flooded; many others are in imminent danger of flooding; many septic systems are under water or about to be under water; and the shoreline is extremely susceptible to erosion. Because of our concern for the water quality of the Lake and the potentially deleterious effect that the discharge of septic systems and large amounts of shoreline erosion will have, we have enacted this ordinance.

It is also the intent of this ordinance to provide for the public health, safety and welfare, including the public's interest in preserving the state's natural resources, by reducing the risk of bodily injury, property damage, shore erosion, and the spread of noxious aquatic weeds which can arise from the operation of speeding watercraft near shore, docks, piers, anchored floats and areas of special aquatic vulnerability.

Section III. Definitions

- (a) "Slow-No-Wake" means that speed at which a boat moves as slowly as possible while still maintaining steering control.
- (b) "Public access" means the access to the water by means of the public landing on the north end of Bass Lake.
- (c) "Boat" means all watercraft including but not limited to personal watercraft and jet skis, as well as any persons or objects towed by such watercraft.

Section IV. Slow-No-Wake Restrictions

- (a) No person shall operate a watercraft boat at a speed greater than "slow-no-wake" on Bass Lake during periods when the surface water level exceeds the ordinary high water mark of 886.1.
- (b) No boat shall be operated at a speed greater than "slow-no-wake" on Bass Lake
- (1) during any time from 8 p.m. to 8 a.m.:
 - (2) at any time within 100 feet of any shore, dock, pier, anchored float, or restricted aquatic area designated and identified in this ordinance.
- (c) The following areas of special aquatic vulnerability are hereby designated and identified:
- (1) Northwest Bay; from west of a line running from the Northeast corner of parcel 201B (Jordan) to Parcel 202C (Packard); S1/2 Section 14, T30N R19W; and
 - (2) Kelly's Swamp; the pond surrounded by parcels 253A, K, L, M, N, O and S; N1/2 Section 26, T30N, R19W

Section V. Posting Requirements

The Bass Lake Inland Lake Protection and Rehabilitation District shall place and endeavor to maintain a copy of this Section Ordinance at all the public access points on Bass Lake.

Section VI. Penalties

Wisconsin state boating penalties as found in Sec. 30.80, Wis. Stats., and deposits as established in the Uniform Deposit and Bail Schedule established by the Wisconsin Judicial Conference, are hereby adopted by reference with all references to fines amended to forfeitures and all references to imprisonment deleted.

Section VII. Severability

The provisions of this ordinance shall be deemed severable and it is expressly declared that the Bass Lake Inland Lake Protection and Rehabilitation District would have passed the other provisions of this ordinance irrespective of whether or not one or more provisions may be declared invalid. If any provision of this ordinance or the application to any person or circumstances is held invalid, the

remainder of the ordinance and the application of such provisions to other persons or circumstances shall not be affected.

Section VIII. Effective Date

This section will become effective upon passage and the day after publication.

Passed this 16 day of March, 1998.

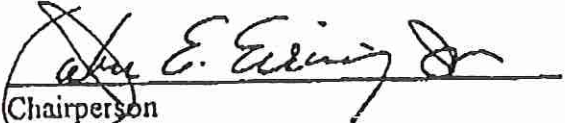
Chairperson

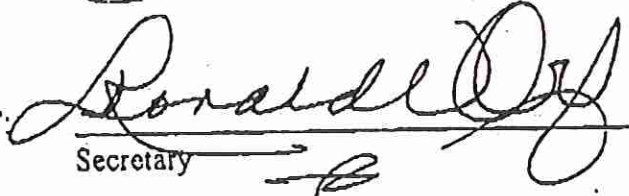
ATTEST: 
Secretary