

Local
4-19-99

000637

Chapter 14

LAKES AND WATERWAYS 14.14(3)

14.15 WATER EXHIBITIONS AND RACES (1) APPLICABILITY
and ENFORCEMENT. Persons or groups wishing to conduct any water exhibitions or
races as defined by State Statutes or the Wisconsin Administrative Code shall apply for a
special permit issued by the Town Clerk after Town Board approval.

(a) The provisions of this Ordinance shall apply to Lake Minocqua .

(b) Exceptions from State boating laws granted through the permitting
process apply only to the specific event days and times. These exceptions from State boating
laws do not apply the any practice time or dates.

(c) This chapter shall be enforced by the officers of the
Minocqua/Woodruff Boat Patrol.

(2) INTENT. The intent of this Ordinance is to provide safe and healthful
conditions for the enjoyment of aquatic recreation consistent with public rights and interests,
and the capability of the water resources.

(3) STATE BOATING AND SAFETY LAWS ADOPTED. State boating
laws as found in §30.50 to 30.71 and §30.742 and NR 5.19 are adopted by reference.

(4) WATER EXHIBITION AND RACE PERMIT. The permit shall
include the following information: Permittee, address, phone number, day(s) or date(s) of the
event, hours of the event, day(s) or date(s) of necessary practice, hours of the practice, legal
description of the event area, legal description of the practice area, and expiration date.

(5) PLACEMENT OF BUOYS. Under the authority granted in NR 5.09 (7)
(d), Wis. Adm. Code, the Minocqua Town Board hereby authorizes the permittee to place
waterski buoys at the event location described in the permit for the length of the permit.

(6) EXCLUSIVE USE AREA. An exclusive use event location on Lake
Minocqua is described as follows: An area immediately southwest of and parallel to Block
8 and Block 9, Henry Paine's Plat of the Village of Minocqua, Section 14, Township 39
North, Range 6 East, extending out approximately 500 feet. The permittee shall be granted
exclusive use of the event location described above during the authorized day(s) or date(s)
and hours of the permitted event. This section does not apply in the case of an emergency,
to the water patrol or to rescue craft, or for the ingress and egress of private riparian owners
within the exclusive use area.

(7) WATER EXHIBITION AND RACE AUTHORIZED AREA. A water

Chapter 14

LAKES AND WATERWAYS 14.14(3)

exhibition and race authorized practice area on Lake Minocqua is described as follows: That portion of Lake Minocqua lying west of the Highway 51 bridge; east of the Lake Minocqua/Lake Kawaguesaga Bearskin State Trail Trestle; south of the Lake Minocqua Bearskin State Trail Trestle; and north of the common Section Line of Sections 15 & 22, T39N, R6E. The permittee's use of this area is limited to not more than the following days and hours: Daily between the hours of 7:00 am to 10:00 am and 5:30 pm until one-half (½) hour before sunset.

(8) PENALTIES. Wisconsin state boating penalties as found in Wis. Stat. §30.80, and deposits as established in the Uniform Deposit and Bail Schedule established by the Wisconsin Judicial Conference, are hereby adopted by reference with all references to fines amended to forfeitures and all references to imprisonment deleted.

(9) SEVERABILITY. The provisions of this Ordinance shall be deemed severable and it is expressly declared that the Minocqua Town Board would have passed the other provisions of this Ordinance irrespective of whether or not one or more provisions may be declared invalid. If any provisions of this Ordinance or the application to any person or circumstances is held invalid, the remainder of the Ordinance and the application of such provisions to other persons and circumstances shall not be affected.

(10) EFFECTIVE DATE. This section will become effective upon passage and the day after publication. (Effective 00/00/99)

MINOCQUA (NE),
WOODRUFF (W)



SUBJECT
AREA

T.39N. - R.6E.
000637

Vilas County
Country

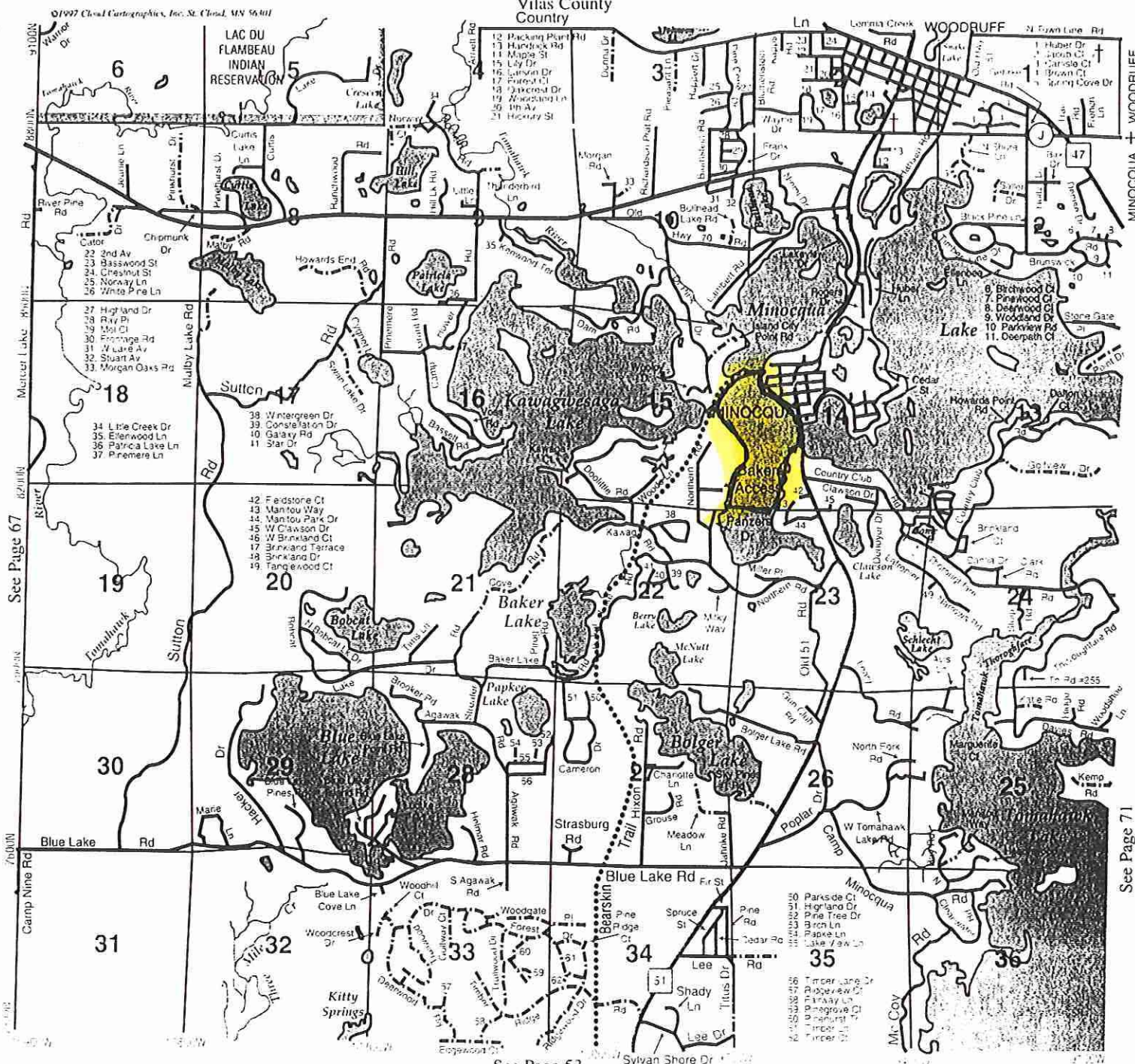

See Page 67

See Page 53

See Page 71



Motto

To Make the Best Better

Practice Area
Boundaries

000637

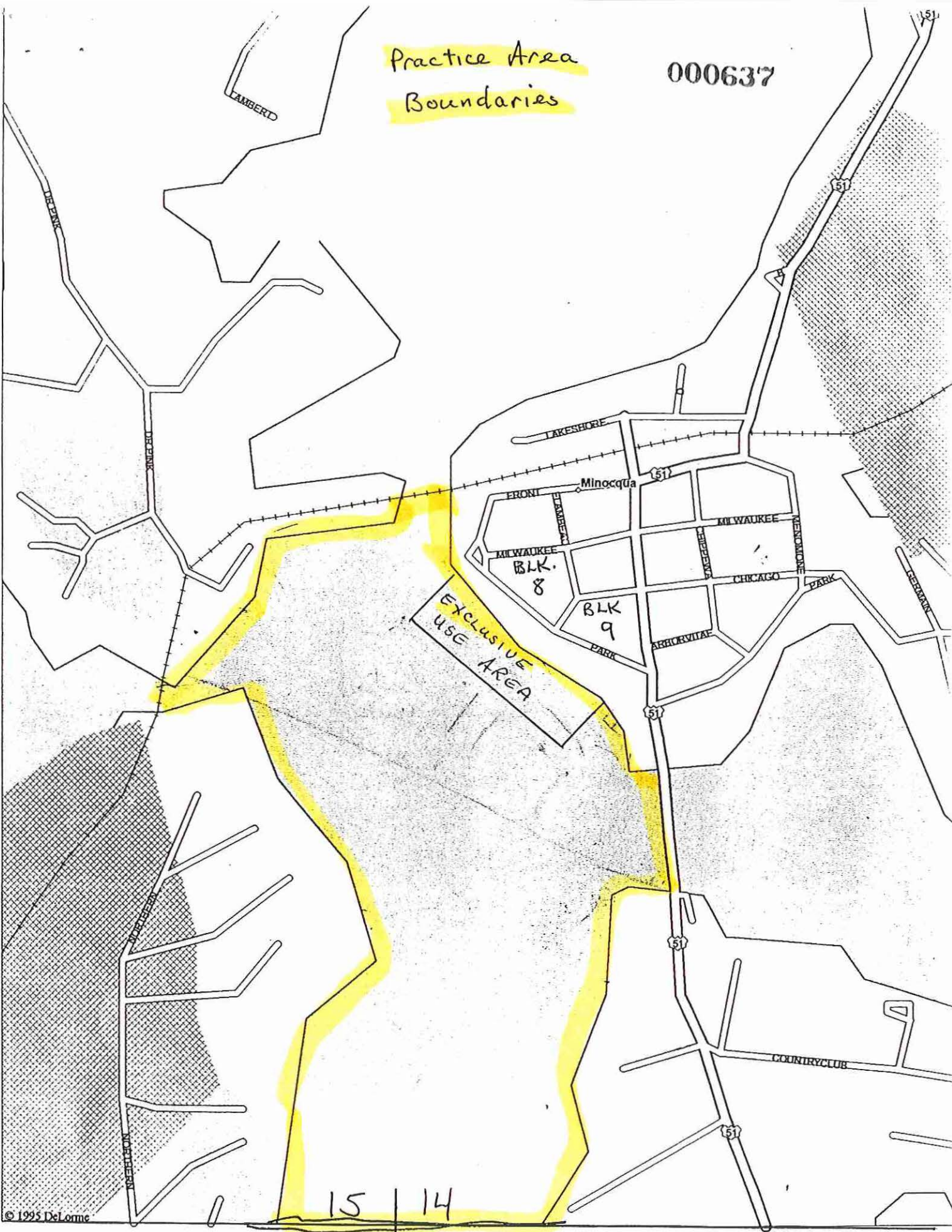

T39N R6E

15 | 14
22 | 23

000637

Village of MINOQUA

Exclusive Area use



Water
 Hydrants
 20' Right of Way
 10' Right of Way
 5' Right of Way

LEGEND

MINOQUA LAKE

Scale 1" = 100'