

**BOATING ORDINANCE**  
**Town of Minong**  
**Washburn County, Wisconsin**

The Town Board of the Town of Minong do ordain as follows:

**Section I.     Applicability and Enforcement**

- (a)     *The provisions of this Ordinance shall apply to the waters of the Minong Flowage.*
- (b)     *This chapter shall be enforced by the officers of the Town of Minong.*

**Section II     Intent**

*The intent of this ordinance is to provide safe and healthful conditions for the enjoyment of aquatic recreation consistent with public rights and interests, and the capability of the water resources.*

**Section III    State Boating and Safety Laws Adopted**

*State boating laws as found in ss. 30.50 to 30.71 are adopted by reference.*

**Section IV     No Wake Areas**

*No person shall operate a boat in the following area at a speed faster than "Slow - No Wake," as defined in 30.50(12), Wisconsin Statutes 1988, as "that speed at which a boat moves as slowly as possible while still maintaining steerage control." Said "No Wake" areas are:*

- (1)     *From the dam located in Section 13, T42N, R13W, upstream 200 yards.*

*This area will be indicated by buoys placed at each end of the restricted area.*

**Section V      Markers and Navigational Aids**

*Posting Ordinance*

- (a)     *Duty, the Town of Minong shall place and maintain suitable markers and signs in such waters as shall be appropriate to advise the public of the provisions of this chapter and post and maintain a copy of this Section at all public access points within the jurisdiction of the Township.*

**Section VI     Penalties**

*Wisconsin state boating penalties as found in ss. 30.80 are adopted by reference.*

Section VII Severability

*The provisions of this ordinance shall be deemed severable and it is expressly declared that the Town Board would have passed the other provisions of this Ordinance irrespective of whether or not one or more provisions may be declared invalid. If any provision of this ordinance or the application to any person or circumstances is held invalid, the remainder of the ordinance and the application of such provisions to other persons or circumstances shall not be affected.*

Section VIII Effective Date

*This section will become effective upon passage and the day after publication.*

Passed this \_\_\_\_\_ day of \_\_\_\_\_, 1994.

No WAKE BOYS  
Minong Flowage

000382

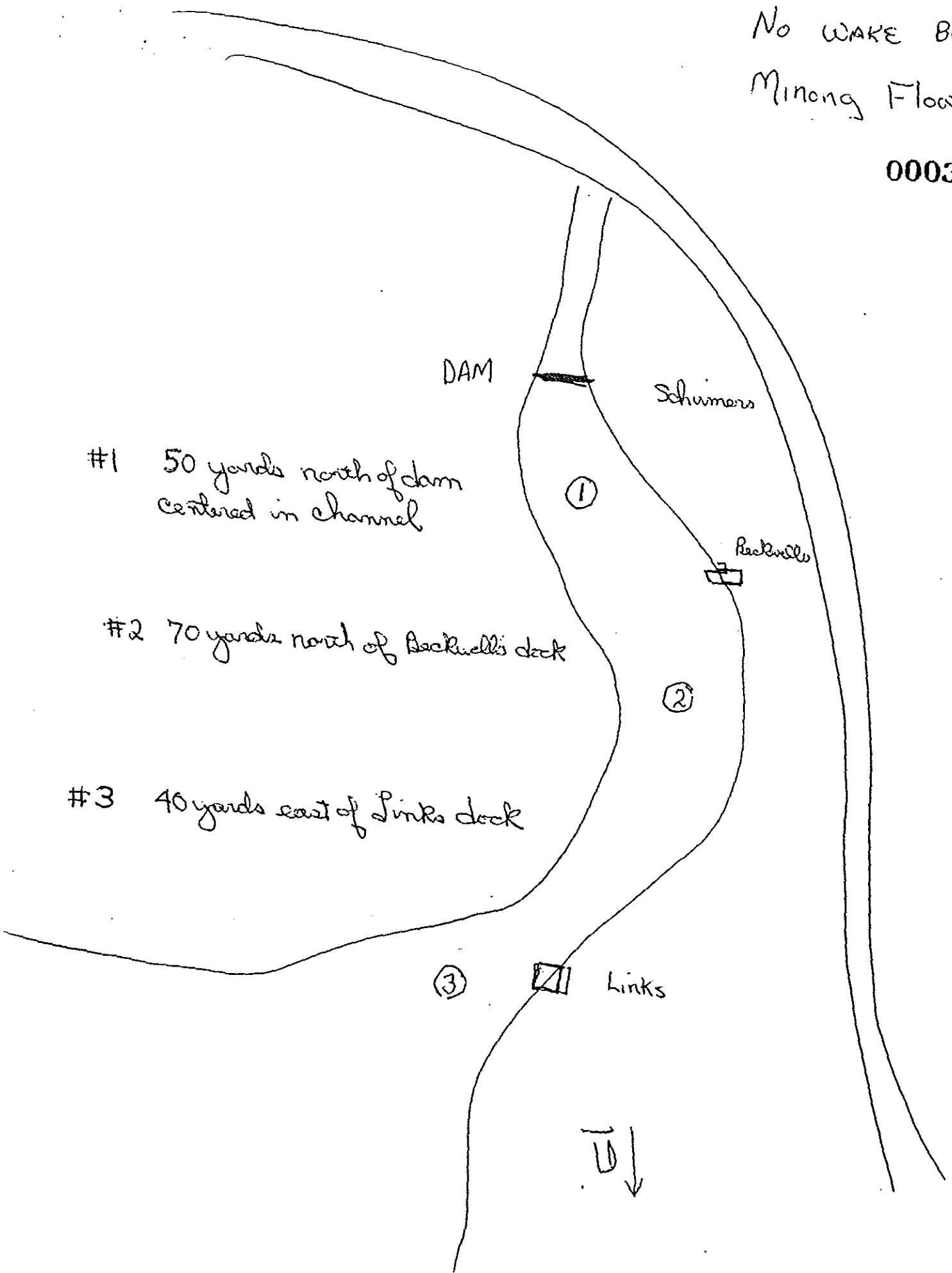

#1 50 yards north of dam  
centered in channel

#2 70 yards north of Beckwells dock

#3 40 yards east of Links dock

③ Links



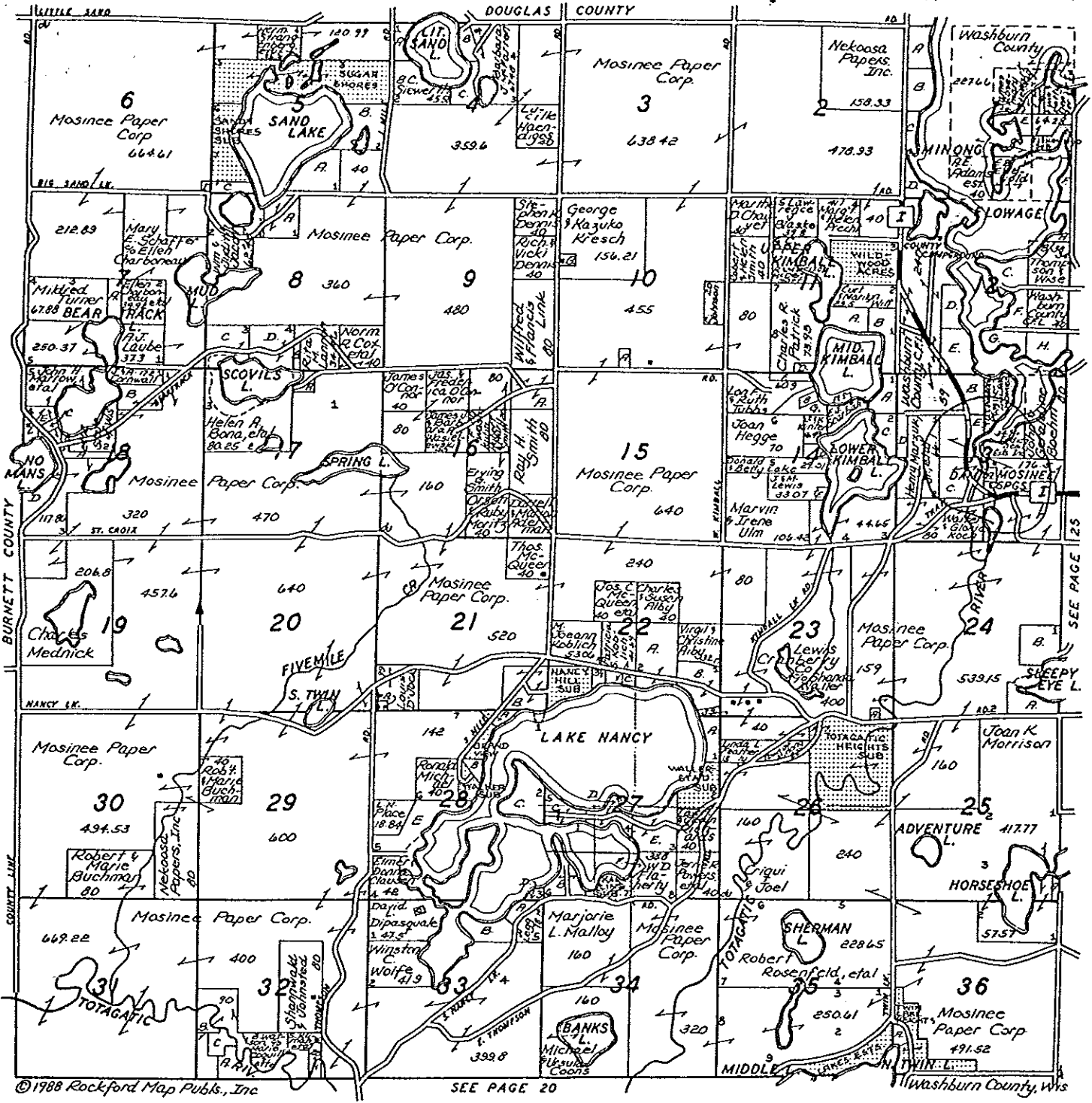

©1988 Rockford Map Pubs., Inc

SEE PAGE 20

Washburn County, Wis

**SMALL TRACTS**

Name	Sec.	Tr.	Ac.	Name	Sec.	Tr.	Ac.	Name	Sec.	Tr.	Ac.	Name	Sec.	Tr.	Ac.
WIP MINONG T.42N. - R.13W.				ECKWRIGHT, EARL	1	B	.81	MILLER, C	1	E		ANDERSON, F	4	A	5.9
				ECKWRIGHT, JANICE	1	B	.81	HILL, S	1	E		ANDERSON, MILD	4	A	5.9
BOWMAN, PATRICIA	1	A		HILL, F B	1	B	3	PENZKOYER, DENNIS	1	E		GRAHAM, CHAS	4	A	1.5
BOWMAN, ION	1	A	3.20	JOHNSON, M F	1	B	3.48	PENZKOYER, FLOREEN	1	E		GRAHAM, LAURA	4	A	1.5
BRISKEN, T R	1	A	3.01	JOHNSON, T J	1	B	3.48	RYDBERG, JAS	1	E		KARLING, JOS	4	A	3
GULDEN, DAVID	1	A		MC KEE, J A	1	B	3.40	RYDBERG, JEANNE	1	E		KAWELL, M L	4	A	3
GULDEN, SHIRLEY	1	A		KOMP, D	1	C	2.42	VAN ARMAN, LAURIE	1	E		KAWELL, MARG	4	A	3
JOHNSON, M F	1	A		LASKA, IRENE	1	C		VAN ARMAN, STEVEN	1	E		SCAFIDI & HOJNACKI	4	A	4
JOHNSON, T J	1	A		LASKA, RICH	1	C		ANNIS, GERALD	1	F	3	GERBER, D	4	B	1.29
OLSON, HAROLD	1	A		MC SHANE, MICH K	1	C		ANNIS, PATRICIA	1	F	3	GERBER, THOS	4	B	1.29
OLSON, LOIS	1	A		SHERILL, JOHN	1	C		BREVIQ, B	1	F	.92	GOETZ, JOYCE	4	B	1
SWEDENBORG, J B	1	A	3.2	SHERILL, JUDITH	1	C		BREVIQ, R	1	F	.92	GOETZ, RUSS	4	B	1
SWEDENBORG, M J	1	A	3.2	WEINIG, J & J	1	C	1	GONDERZIK, B	1	F	2	JOHNSON, GAIL	4	B	
TRONSTAD, IAN	1	A	3.1	GRAYWIN, HILERO	1	D	5	GONDERZIK, G	1	F	2	JOHNSON, LESLIE	4	B	
TRONSTAD, LE ROY	1	A	3.1	KAehler, DOR	1	D	3	KORNELI, PAMELA J	1	F		JONAS, DAN	4	B	.89
WOLF, HOLY	1	A	3.20	KAehler, LEON	1	D	3	KRONENBERG, HARY J	1	F	4	JONAS, DOI	4	B	.89
WOLF, ION	1	A	3.20	LAKE MINONG CONDO	1	D	5	KUPPER, ROBER	1	F		KELLER, HAL	4	B	1.52
BRIDGEMAN, S H	1	B	3.5	HAMEL, MARK ETAL	1	E		WASHBURN CO	1	F		KELLER, WESLEY	4	B	1.52
COQUILLETTE, D C	1	B	3.4	HOCKING, GEO W	1	E		WATTS, BERT ETAL	1	F	2	MC KENZIE, G	4	B	1.4
ECKWRIGHT & LAVELLE	1	B	3.48	KING, DAVID	1	E	1.34	WHITEHEAD, S D ETAL	1	F		MC KENZIE, S	4	B	1.4
				KING, KATHERINE	1	E	1.34	DENIER, RICH ETAL	1	G	3.45	MERTZIG, DENNIS	4	B	1.4

Continued on Page 35

CONDITION REPORT

*The local conditions necessitating this regulation is that a narrow channel connects the dam with the main portion of the Minong Flowage with. Because of the lack of state regulation and because of the danger of a boating accident, with boats traveling at a high rate of speed, this channel should be a "Slow - No Wake" area. At the present time, boats travel through this channel at a high rate of speed, creating an unsafe boating environment. This Ordinance would prevent boats from traveling in the channel at a high rate of speed and would protect public rights, interests and the capability of the water resource.*

*If this ordinance is not adopted, the impact on public health, safety or welfare could be great, creating a condition where the prospect of a boating accident is great.*