

TOWN OF RIB LAKE ORDINANCE

A Sole Ordinance to Regulate Water Traffic Boating and Water Sports upon the Waters of South Harper and North Harper Lake located in the Town of Rib Lake and prescribing penalties for the violation thereof:

The Town Board of the Town of Rib Lake, Taylor County, Wisconsin, do ordain as follows:

Sec. 1. Intent. The intent of this ordinance is to provide safe and healthful conditions for the enjoyment of aquatic recreation consistent with public rights and capability of the water resource.

Sec. 2. Applicability and Enforcement. The provisions of this ordinance shall apply to the waters of both North Harper Lake and South Harper Lake within the jurisdiction of the Town of Rib Lake. The provisions of this ordinance shall be enforced by the officers of the Town of Rib Lake, Harpers Lakes Association (Water Safety Patrol), and Taylor County Sheriff's Department.

Sec. 3. Definitions in this Ordinance. A. "Swimming Zone" means any authorized area of water established by regulatory markers to designate a swim area.
B. "Slow-no-Wake" means that speed at which a boat moves as slowly as possible while still maintaining steerage control on both North and South Harper Lakes.

Sec. 5. Speed Restrictions. No boat may operate at a speed in excess of slow-no-wake during the hours before 9:00 a.m. and after the hour of 7:00 p.m. as found in ss. 30.66(2) as found in Wisconsin Statutes.

Sec. 6. Controlled Areas. No boat or skier shall approach the "Swimming Zone" marked by buoys located on the far north end of South Harper Lake, along Rustic Road, within 100 feet at a speed in excess of "Slow-no-Wake" as found in ss. 30.68(7) of Wisconsin Statutes.

Sec. 7. Boats Excluded Area. The following area shall be a "Boat Excluded Area" and marked by two swim area buoys: Buoy number one (1) will be placed 120 feet south of the concrete boat landing on the north shore of South Harper Lake. Buoy number two (2) will be placed 100 feet due east of buoy number one and 120 feet south of the large red pine located on the east end of the swimming area.

Sec. 8. Penalties. Wisconsin State Boating Penalties as found in Wisconsin Statutes ss. 30.80(1) and (2) are adopted.

Sec. 9. Effective Date. This section will become effective upon passage and the day after publication.

Passed this _____ day of _____, 1990.

0191\LE8N1243.BLH

Approved January 21, 1991

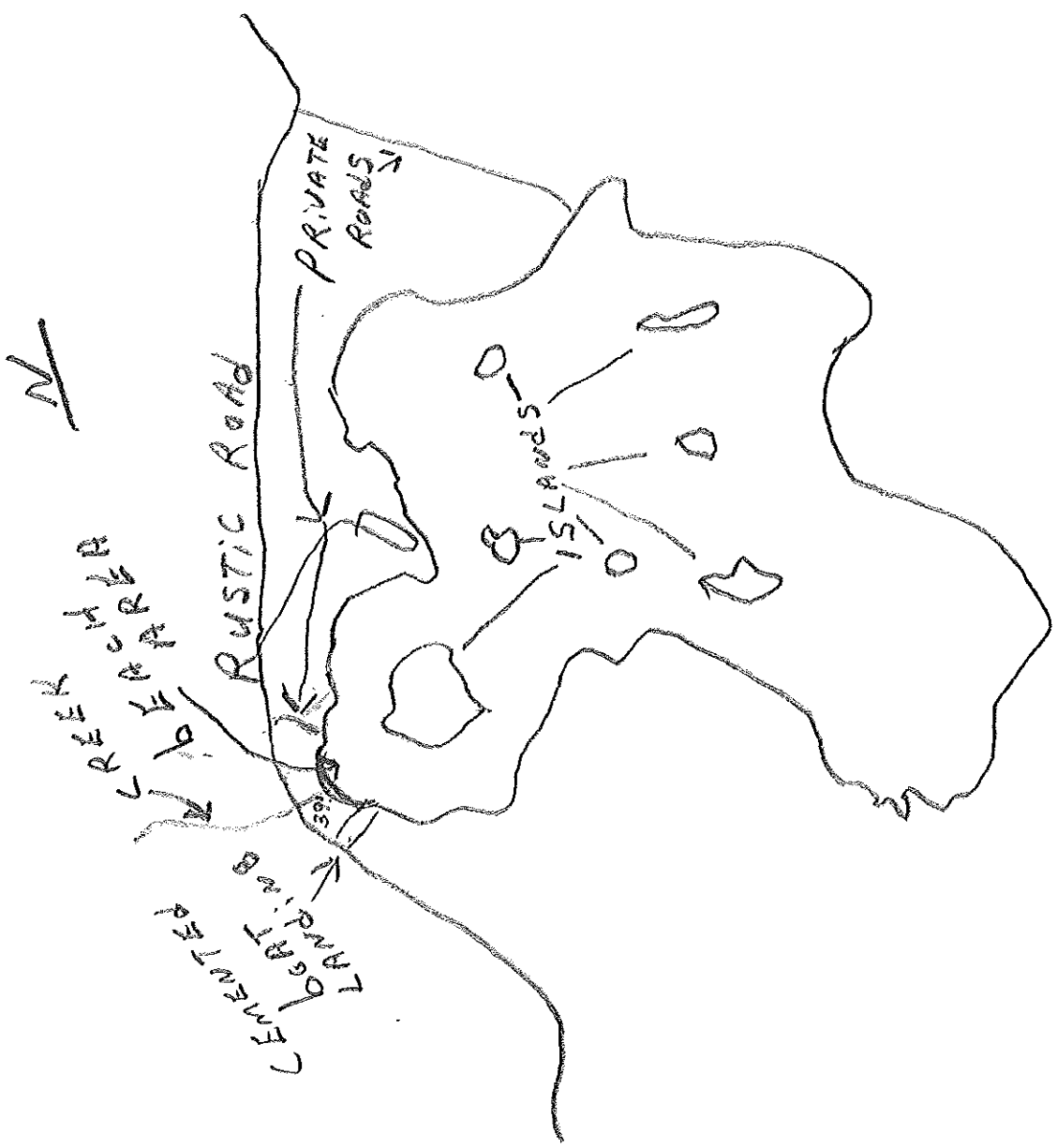

E

W

S

North Harper L.
53.7 Acres
35' Max. depth

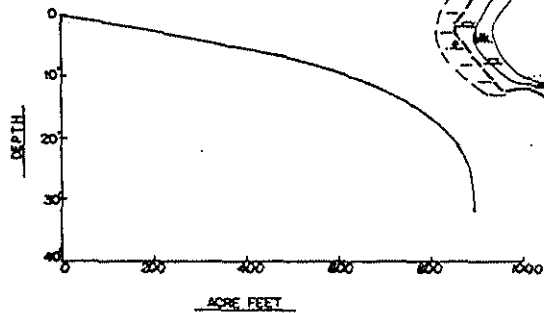
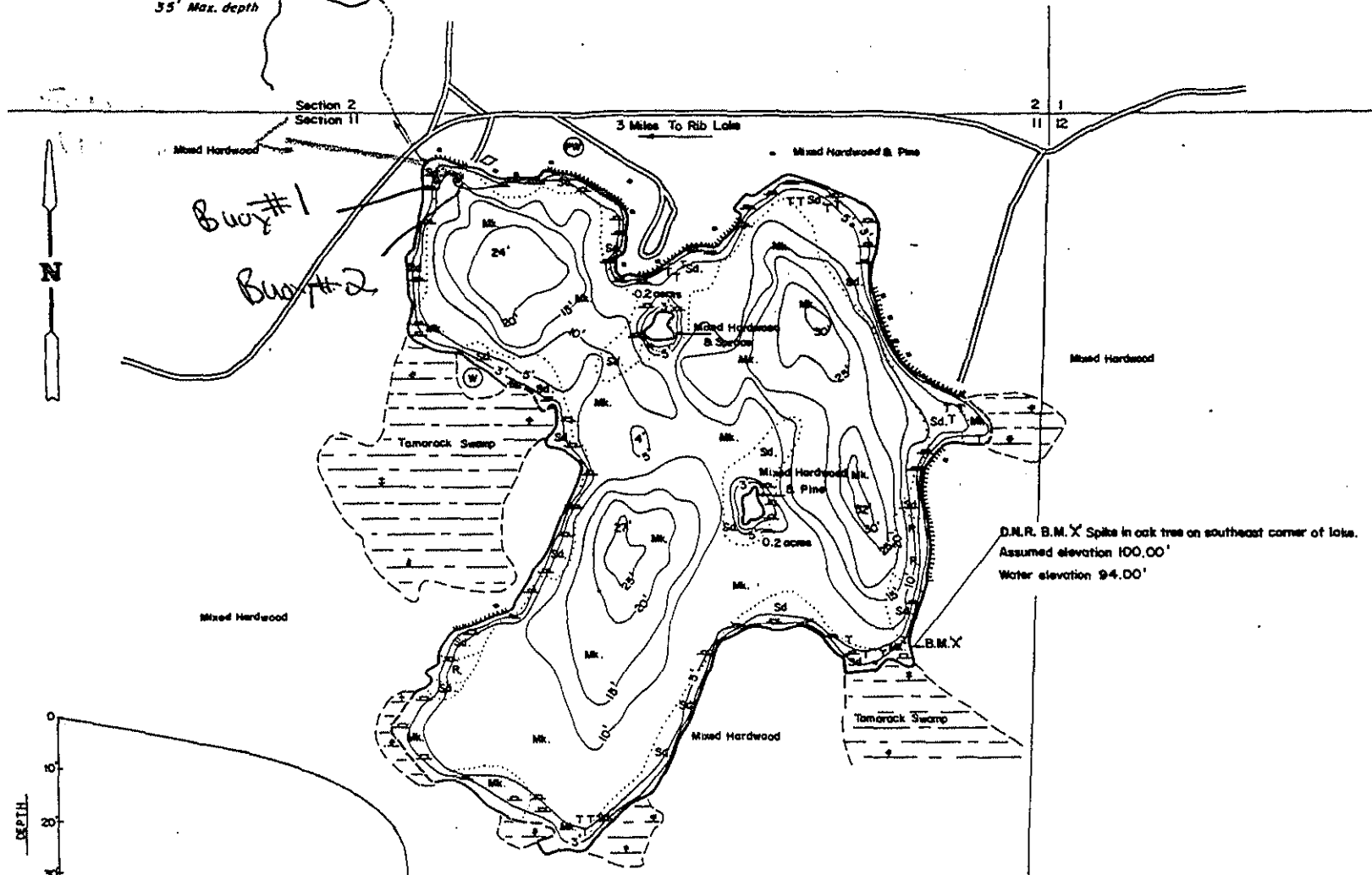

D.N.R. B.M. X Spike in oak tree on southeast corner of lake.
Assumed elevation 100.00'
Water elevation 94.00'

EQUIPMENT RECORDING SONAR MAPPED AUGUST 1965
MO. YR.

TOPOGRAPHIC SYMBOLS

- ⊙ Brush
- ⊙ Partially wooded
- ⊙ Wooded
- ⊙ Cleared
- ⊙ Pastured
- ⊙ Agricultural
- B.M. Bench Mark
- Dwelling
- ||||| Steep slope
- - - Indefinite shoreline
- ⊙ Marsh
- ⊙ Spring
- ⊙ Intermittent stream
- ⊙ Permanent inlet
- ⊙ Permanent outlet
- ⊙ Dam

WATER ELEV. 94.00'

LAKE BOTTOM SYMBOLS

- P. Peat
- Gr. Gravel
- Mk. Muck
- R. Rubble
- Br. Bedrock
- M. Marl
- Sd. Sand
- ⊙ Stumps & Snags
- ⊙ Submergent vegetation
- ⊙ Emergent vegetation



- ◇ Access
- ◇ Access with Parking
- ◇ Boat Livery

SPECIES OF FISH	
	ABUNDANT COMMON PRESENT
Muskie	X
N Pike	X
Walleye	X
L. M. Bass	X
S. M. Bass	X
Perch	X
Trout	X

80.1 ACRES WITH ISLANDS
AREA 73.7 ACRES
UNDER 3FT. 7.6 %
OVER 20FT. 13.9 %
VOLUME 894.6 ACRE FT.
TOTAL ALK. 13 P.P.M.
SHORELINE 2.0 MILES
MAX. DEPTH 32 FEET

LAKE SURVEY MAP

NORTH HARPER LAKE TAYLOR COUNTY
SEC. 211 T. 33 N. R. 2 E.

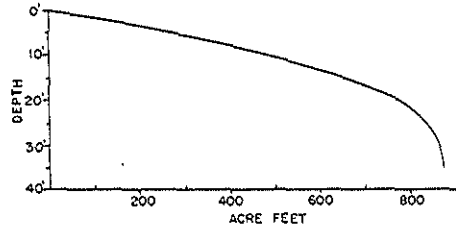
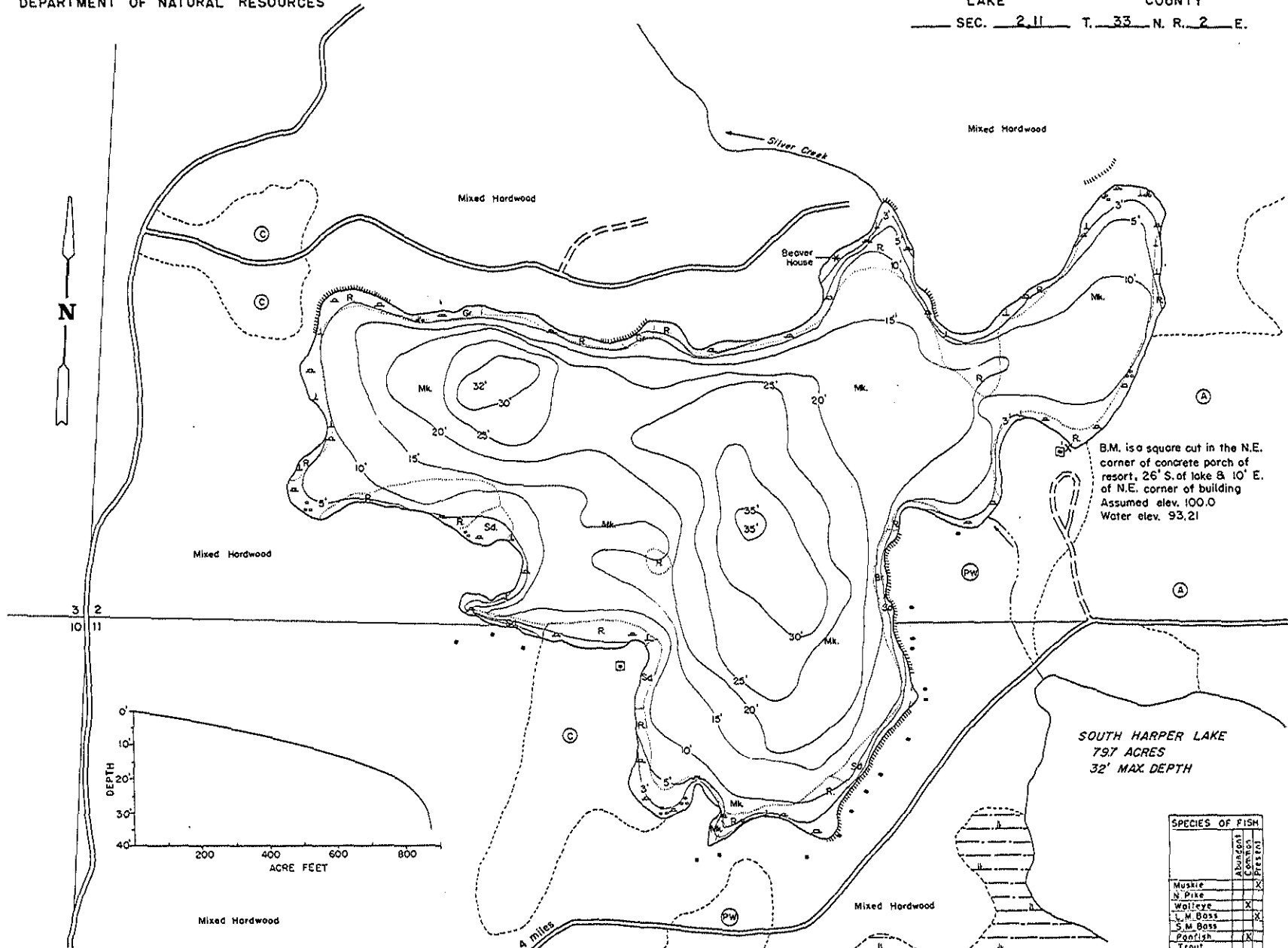

SOUTH HARPER LAKE
797 ACRES
32' MAX. DEPTH

SPECIES OF FISH	ABUNDANCE	
	Common	Present
Muskie		X
N. Pike		X
Walleye	X	
L. M. Bass	X	
S. M. Bass	X	
Panfish	X	
Trout		X

EQUIPMENT RECORDING SONAR, MAPPED AUG. 1967
MO. YR.

- TOPOGRAPHIC SYMBOLS
- ⊙ Brush
 - ⊙ Partially wooded
 - ⊙ Wooded
 - ⊙ Cleared
 - ⊙ Pastured
 - ⊙ Agricultural
 - B.M. Bench Mark
 - Dwelling
 - ⊙ Resort

WATER ELEV. 93.21

- LAKE BOTTOM SYMBOLS
- P, Peat
 - Gr, Gravel
 - St, Stumps & Snags
 - Mk, Muck
 - R, Rubble
 - C, Clay
 - Br, Bedrock
 - M, Marl
 - T, Submergent vegetation
 - Sd, Sand
 - l, Emergent vegetation
 - Sl, Silt
 - △, Floating vegetation



◇ Access ◇ Access with Parking ◇ Boat Livery
Field work by: C. Busch, G. Winter, L. Sather. Drawn by: C. Hall

AREA 53.7 ACRES
UNDER 3 FT. 2.8 %
OVER 20 FT. 32.8 %
VOLUME 877.0 ACRE FT.
TOTAL ALK. 28 P.P.M.
SHORELINE 1.85 MILES
MAX. DEPTH 35 FEET

CONDITION REPORT

The local conditions necessitating this regulation is that South Harper Lake is 80.1 acres and North Harper Lake is 53.7 acres. Both have many cottages on their shores. Also, both lakes are very well suited to swimming, water skiing, and fishing, which creates a very dangerous situation during the evening hours when people are swimming and fishing.

We, the Town of Rib Lake, along with the direction of the Harper Lakes Association, feel this is an unhealthy, dangerous situation that would be corrected by this ordinance.

0191\LE8N1243.BLH