

SAND  
LAKE  
(ONEIDA Co)

~~739-9-30~~  
T 37-7-5,6

BIRCH LAKE

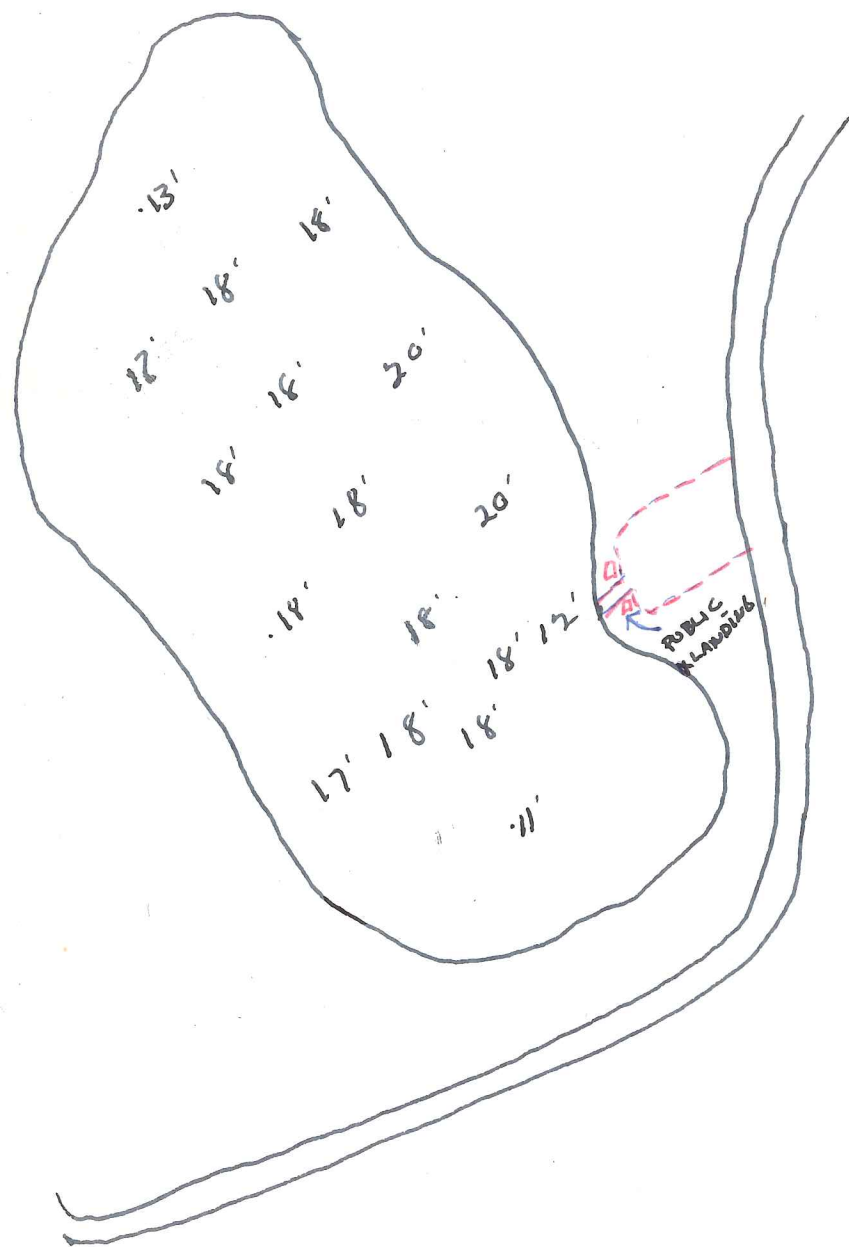

Very clear water, leather leaf on some areas  
Hard sand - majority of shoreline  
8-10 cottages  
Small panfish numerous  
Submerged vegetation scarce

Too Shallow - Too Warm

Land L. 5-37-7

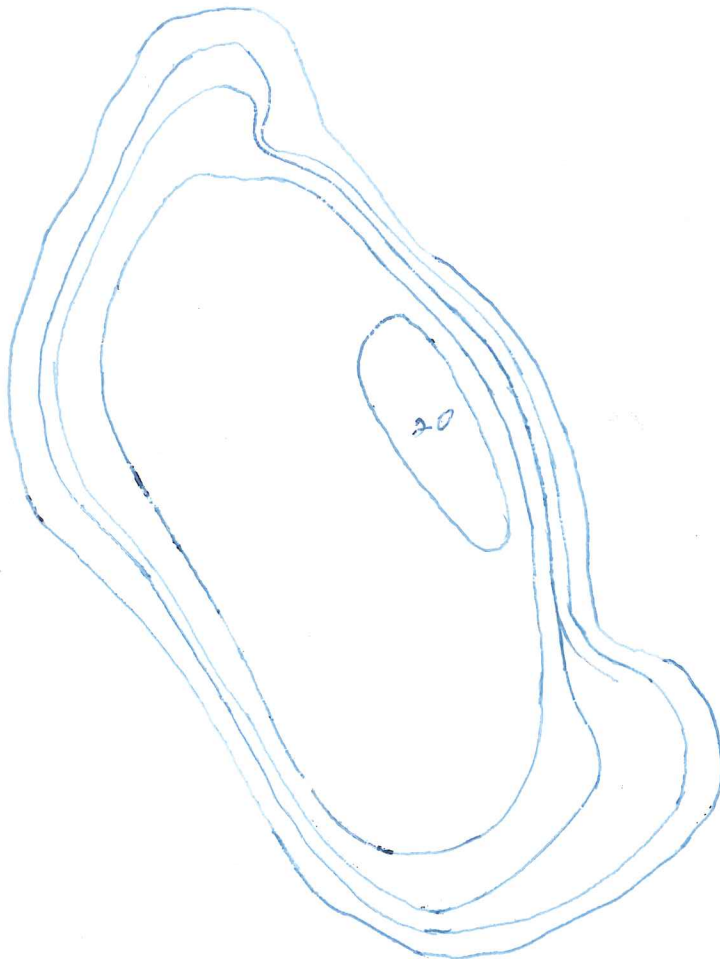

	<u>area</u>	<u>area ft</u>
0-5	7.6	19.0
5-10	5.9	44.3
10-15	7.1	88.8
15-20	18.5	323.8
20-	1.9	38.0
	<u>41.0</u>	<u>513.9</u>