

Revised LPL 573



Thomas Hill: *View of Lake Tahoe, Looking Across Emerald Bay, 1874*

---

# Shoreland Inventory of Bear Lake, Oneida County, Wisconsin

---

Date of Inventory: June 8, 1999

Revised: June 8, 2001

Prepared by:  
Blue Water Science  
St. Paul, Minnesota  
(651) 690.9602

June 2001

# Shoreland Inventory, Bear Lake, Oneida County

**Date of Inventory: June 8, 1999**

The shoreland area encompasses three components: the upland fringe, the shoreline, and shallow water area by the shore. A photographic inventory of the Bear Lake shoreline was conducted on June 8, 1999. The objectives of the survey were to characterize existing shoreland conditions which will serve as a benchmark for future comparisons.

For each photograph we looked at the shoreline and the upland condition. Our criteria for natural conditions were the presence of 50% native vegetation in the understory and at least 50% natural vegetation along the shoreline in a strip at least 15 feet deep. We evaluated shorelands at the 75% natural level as well.

A summary of the inventory results is shown in Table 1. Based on our subjective criteria over 75% of the parcels in the Bear Lake shoreland area meet the natural rankings for shorelines and upland areas. This is good for a lake in northern Wisconsin. However in the next 10 years there could be pressure to reduce natural conditions. Proactive volunteer native landscaping should maintain existing conditions and improve other parcels.

**Table 1. Summary of buffer and upland conditions in the shoreland area of Bear Lake. Approximately 115 parcels were examined.**

	<b>Bear Lake Oneida County 115 parcels</b>	<b>Big Bearskin Lake Oneida County 130 parcels</b>	<b>Ballard-Irving- White Birch Lakes Vilas County 110 parcels</b>
Shorelines with >50% natural buffer	84%	80%	96%
Shorelines with >75% natural buffer	77%	67%	95%
Upland areas >50% natural conditions	93%	73%	98%
Upland areas >75% natural conditions	78%	63%	96%
Date of Survey	June 8, 1999	August 10, 1999	July 23, 1999

A comparison of Bear Lake conditions to other lakes in Wisconsin and Minnesota is shown in Table 2.

Results for individual parcels are shown in Table 3.

**Table 2. Summary of shoreland inventories from Bear Lake and 14 other lakes in Minnesota and Wisconsin.**

Lake	Eco-region	Date of Survey	Total Number of Parcels (#)	Undevel. Parcels # (%)	Natural Upland Condition		Natural Shoreline Condition		Parcels with Erosion # (%)	Parcels with Shoreline Structure # (%)
					> 50% # (%)	>75% # (%)	> 50% # (%)	>75% # (%)		
Bear Oneida Co, WI	LF	6.8.99	115	7 (6)	107 (93)	90 (78)	97 (84)	89 (77)	1 (1)	9 (8)
Nancy Lake Washburn Co, WI	LF	9.21.00	217	41 (19)	167 (77)	141 (65)	174 (80)	156 (72)		11 (5)
Big Bearskin Oneida Co, WI	LF	8.10.99	130	--	95 (73)	82 (63)	104 (80)	87 (67)	--	0
Ballard chain Vilas Co, WI	LF	7.23.99	110	--	108 (98)	106 (96)	106 (96)	105 (95)	--	0
Comfort Chisago Co, MN	CHF	10.9- 11.2.98	100	--	62 (62)	--	50 (50)	--	--	12 (12)
Maple Grove Lake Summary, MN	CHF	9.30 - 10.12.99	644	89 (14)	431 (67)	312 (48)	385 (60)	310 (48)	3 (1)	129 (20)
Cedar Island	CHF	9.30 - 10.12.99	93	5 (5)	58 (62)	33 (35)	51 (55)	36 (39)	0	21 (22)
Eagle	CHF	9.30 - 10.12.99	90	13 (14)	58 (64)	47 (52)	42 (47)	37 (41)	0	32 (35)
Edward	CHF	9.30 - 10.12.99	34	4 (12)	31 (91)	30 (88)	26 (76)	24 (71)	2 (6)	1 (3)
Fish	CHF	9.30 - 10.12.99	170	12 (7)	126 (74)	75 (44)	97 (57)	70 (41)	1 (1)	34 (20)
Pike	CHF	9.30 - 10.12.99	9	5 (56)	9 (100)	9 (100)	9 (100)	9 (100)	0	0
Rice	CHF	9.30 - 10.12.99	137	45 (33)	97 (71)	87 (64)	111 (81)	102 (74)	0	25 (19)
Weaver	CHF	9.30 - 10.12.99	111	5 (5)	52 (47)	31 (28)	49 (44)	32 (29)	0	16 (14)
Powers City of Woodbury, MN	CHF		30	27 (90)	27 (90)	27 (90)	29 (97)	29 (97)	0	0
Upper Prior Scott Co, MN	CHF	9.30- 10.12.99	366	37 (10)	187 (51)	132 (36)	128 (35)	113 (31)	15 (4)	168 (46)
Lower Prior Scott Co, MN	CHF	9.24- 30.99	691	66 (10)	249 (36)	166 (24)	152 (22)	117 (17)	35 (5)	373 (54)

\* CHF = Central Hardwood Forest Ecoregion

\*\* LF = Lake and Forests Ecoregion\* CHF = Central Hardwood Forest Ecoregion

**Table 3. Bear Lake shoreland inventory, June 8, 1999. Shorelands that meet the natural condition of either 50% or 75% of natural cover are shown with a "+". Shorelands with less than 50% or 75% natural cover are shown with "-".**

		Shoreline		Upland	
		50%	75%	50%	75%
1	-14	+	+	+	+
	-15	+	+	+	-
	-16	+	+	+	+
	-17	+	+	+	-
	-18	+	+	+	+
	-20	-	-	+	-
	-22	+	+	+	+
	-23	+	-	-	-
	-24	+	-	+	-
	-26	+	+	+	-
	-27	+	-	+	-
	-28	+	+	+	+
	-29	+	-	+	-
	-30	+	+	+	+
	-32	+	+	+	+
	-33	+	+	+	+
	-34	+	+	+	+
-35	+	+	+	+	
-36	+	+	+	+	
-37	+	+	+	+	
2	-2	+	+	+	+
	-3	-	-	+	+
	-4	-	-	+	-
	-5	-	-	+	+
	-6	+	+	+	+
	-7	+	+	+	+
	-9	+	+	+	+
	-10	+	+	+	+
	-12	+	+	+	+
	-13	+	+	+	+
	-14	+	+	+	+
	-15	+	+	+	+
	-16	-	-	+	+
	-17	+	-	+	-
	-18	+	+	+	+
	-19	-	-	+	-
	-20	+	+	+	+
-21	+	+	+	+	
-22	+	+	+	+	
-23	+	+	+	+	
-24	+	+	+	+	
-25					

		Shoreline		Upland	
		50%	75%	50%	75%
3	-2	+	+	+	+
	-3	+	+	+	+
	-4	+	+	+	+
	-7	+	+	+	+
	-8	+	+	+	+
	-9	-	-	-	-
	-11	+	+	+	+
	-12	+	+	+	+
	-13	+	+	+	+
	-14	+	+	+	+
	-15	-	-	+	-
	-17	-	-	-	-
	-19	+	+	+	+
	-20	+	+	+	+
	-21	+	+	+	+
	-22	+	+	+	+
	-23	+	+	+	+
-24	+	+	+	+	
-25	+	+	+	+	
4	-2	+	+	+	+
	-3	+	+	+	+
	-4	+	+	+	+
	-5	+	+	+	+
	-6	+	+	+	+
	-9	-	-	+	-
	-10	+	+	+	+
	-11	+	+	+	+
	-12	+	+	+	+
	-13	+	+	+	+
-14	-	-	-	-	
-17	+	+	+	+	
-18	+	-	-	-	
-20	+	+	+	+	
-21	+	+	+	+	
-23	+	+	+	+	
-24	+	+	+	+	

		Shoreline		Upland	
		50%	75%	50%	75%
5	-1	+	+	+	+
	-2	-	-	+	+
	-3	-	-	+	+
	-4	+	+	+	+
	-6	-	-	-	-
	-7				
	-8	+	+	+	+
	-9	+	+	+	+
	-11	-	-	+	-
	-12	-	-	-	-
	-13	+	-	+	-
	-14	-	-	+	+
	-15	+	+	+	-
	-17	-	-	+	-
	-18	+	+	+	+
	-19	+	+	+	+
	-20	+	+	+	+
	-23	+	-	-	-
	-24	+	-	+	-

		Shoreline		Upland	
		50%	75%	50%	75%
6	-8	+	+	+	+
	-9	+	+	+	+
	-11	+	+	+	+
	-12	+	+	+	-
	-14	+	+	+	+
	-15	+	+	+	+
	-16	+	+	+	+
	-17	+	+	+	+
	-18	+	+	+	-
	-19	-	-	-	-
	-20	+	+	+	+
	-22	-	-	+	+
	-23	+	+	+	+
	-24	+	+	+	+
	-25	+	+	+	+
7	-1	+	+	+	+
	-2	+	+	+	+
	-3	+	+	+	+

+ = meets criteria

- = does not meet criteria

# KEY to picture labels

example:

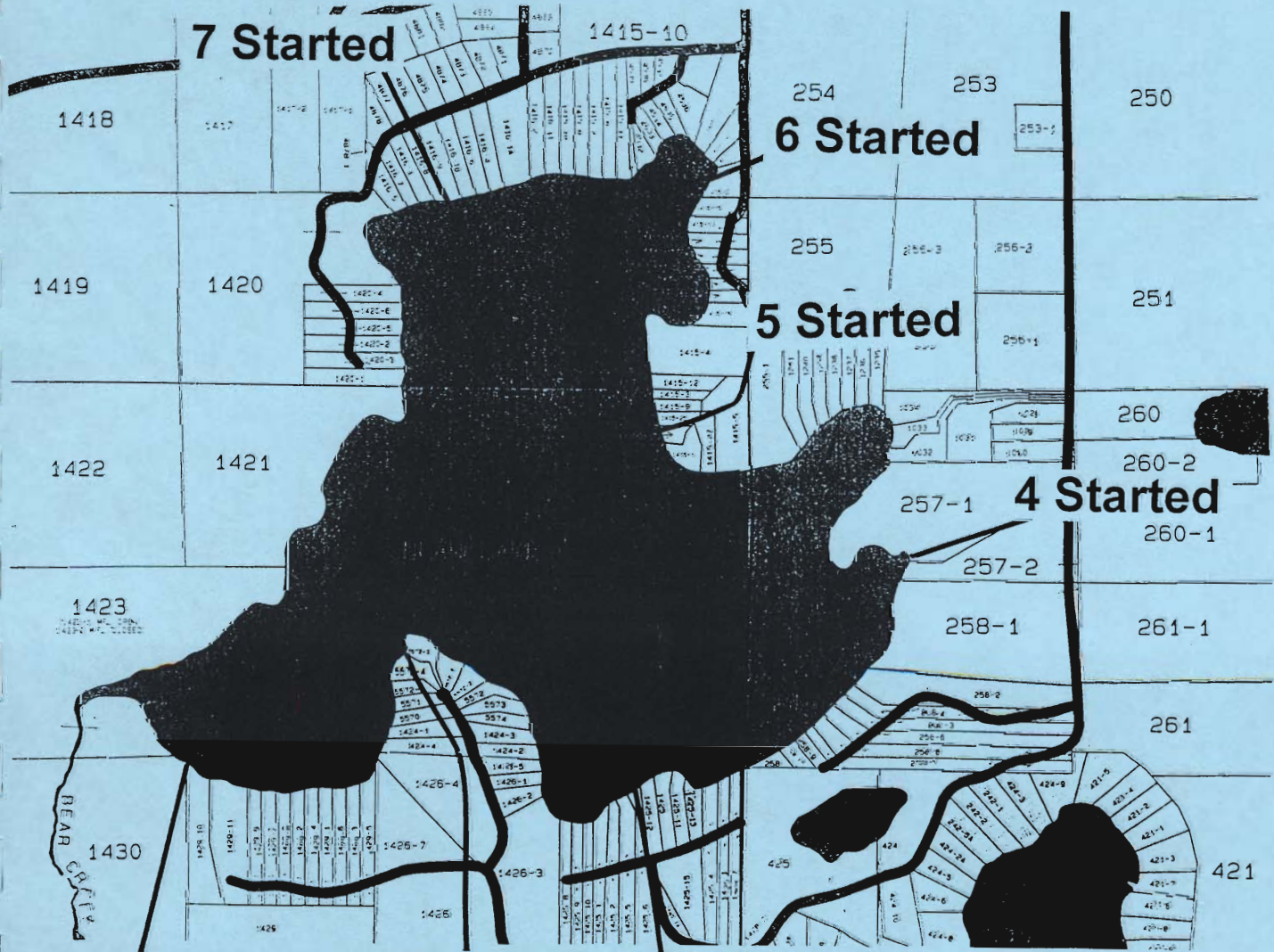
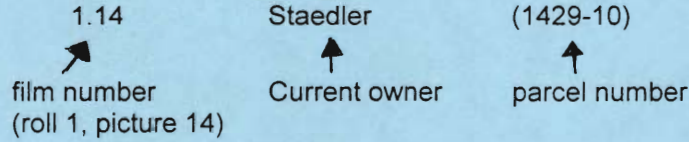

Key to shoreland inventory segments.  
Photography taken on June 8, 1999.

# KEY to picture labels

example: 1, 14      Staedler      (1429-10)  
 film number      Current owner      parcel number  
 (roll 1, picture 14)



114 Staedler (1429-10)



115 Bethlaff (1429-11)



116 Dalinski (1429-9)

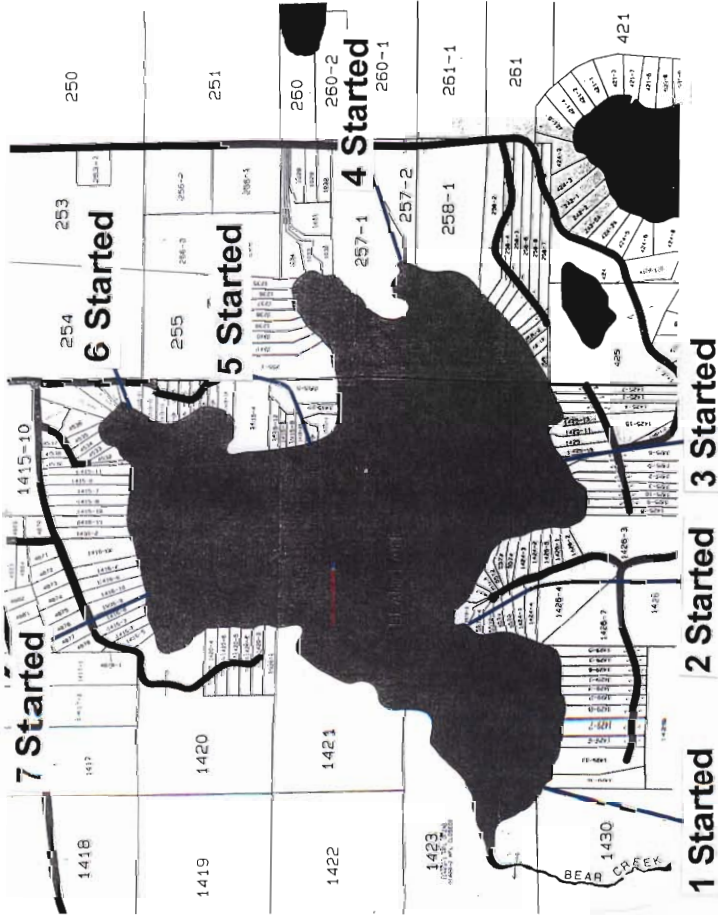

Bear Lake



1.17 Wallace (1429-7)



1.18 Swirth (1429-8)



1.20 Bess (1429-2)



1.22 Theisen (1429-4)



1.23 Smith (1429-1)



1.24 Johnson (1429-6)







1.26 Barney (1429-3)



1.27 Winshell (1429-8)



1.28 Laskowski (1426-7)



1.29 Laskowski (1426-7)



1.30 Wesley (1426-4)



1.32 Dick Lemanski (1424-4)





1.33 Wierschem (1424-1)



1.34 Wierschem (1424-1)



1.35 Anderson (5570)



1.36 Anderson (5571)



1.37 Mazza (5572-4)



2.2 Mazza (5572-5)

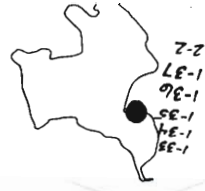



2.3 Primozich (5572-3)



2.4 Primozich (5572-3)



2.5 Primozich (5572-3)



2.6 Weissgerber (5572-2)



2.8 Ice Proof dock- Parker (5572-1)



2.9 Brehobl (5572)





2.10 Brehobel (5572)



2.12 Pederson (5573)



2.13 Machin (5574)



2.14 Schampers (1424-3)



2.15 Butler/Finke (1424-2)



2.16 Knaapp (1426-5)





2.17 Larsen (1426-1)



2.18 Staffell (1426-2)



2.19 (1426-2) + (1426-1)



2.20 Krienke (1426-3)



2.21 Vacant lot - Knapp (1425-8)



2.22 Paupore (1425-9)





2.23 Radosevich (1425-10)



2.24 Styzza (1425-3)

This page is missing properties

- 1425-2
- 1425-5
- 1425-6
- 1425-12
- 1425-11



3.2 Testin



3.3 Schiefelben



3.4 Kapelis





3.7 Ruch (H25-13)



3.8 Kopecky (H25-4)



3.9 Minnihan (H25-1)



3.11 Munsch (H25-7)



3.12 Interlochen woods H-425



3.13 Doelger H-258

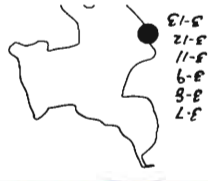



3.14 Doelger (H-258)



3.15 Kurszewski (H-258-10)



3.17 Weisenberger (H-258-9)







3.22 Repinski (H-258-3)



3.23 Brown/Pillen (H-258-4-2)



3.24 Weber/Pilen (H-258-2-1)



3.19 Zakrzewski (H-258-7)



3.20 Noethling (H-258-8)



3.21 Lenzner (H-258-6)





3.25 Van Prosen (H:257-1)



4.1 Sunset Resort (H:257-142)



4.8 Sunset Resort (H:257-142)

Hapke: Not preferred



4.4 Sunset Resort (H:257-142)



4.5 Sunset Resort (H:257-142)



4.6 Ahrens (H1239); Bahm (H1238); Caywood (H1237)  
Batell (H1236); Wolf (H1235 + H1234)





419 Hapke (H1032 + H1033)



410 WOLF (H1034)



411 Bate II (H1236)



412 Baywood (H1237)



413 Bahm (H1238)



414 Ahrens (H1239)





4.17 Braun (H1241) / Nuckols (H1240)



4.18 Bender (H353)



4.20 Mundt (H15-5)

Missing - Williams (H15-26)



4.21 Mundt (H15-5)



4.23 Mundt (H15-27)



4.24 Lee (H15-1)





5.1 Bewick (1415-26)



5.2 Nowicki (1415-9)



5.3 Hughes (1415-3)



5.4 Hughes (1415-12)



5.6 Londs (1415-4)



5.7 Londs (1415-4)





5.8 Lands (1415-4)



5.9 Lands (1415-4)



5.11 Jacobi (1415-18)



5.12 Ring (1415-17)



5.13 Stensburg (1415-2)



5.14 Kruse (1415-16)





5.19 Roloff (H15-16)



5.15 Johnson (H15-13)



5.17 Huber (H15-14)



5.18 Morris (H15-19)





5.20 Reimer/Roloff (14/15-21)



5.23 Lepak (14/15-23)



5.24 Lepak (14/15-23)







6.8 Chynoweth (1415.22)



6.9 Large (4506) / Jolsonik (41835)



6.11 Hamilton (4504) / Cole (4538)



6.12 Patmythes (41532)



6.14 Public landing (1415.31)



6.15 Spencer (1415.11)



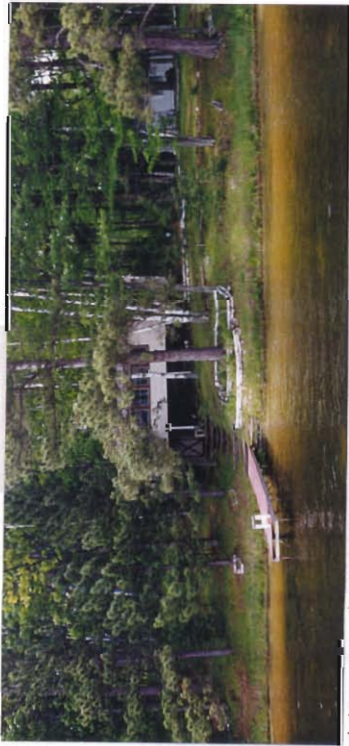

6.16 Seidel (1418.6)



6.17 Davis (1415.7)



6.18 Redent (1418.8)



6.19 Mundt (1415-10)



6.20 Motz (1416-11)



6.22 Howells (1416.2)





7.1 Tannah (1416-10)



7.2 Church (1416-9)



7.3 Blomquist (1416-8)



6.23 Willie (1416-1A)



6.24 Robbery (1416-4)



6.25 Obel (1416-6)





7.4 Swierski (1416-3)



7.5 Daniels (1416-7)



7.6 Jansen (1416-5)





7.8 Janssen (1420)



7.9 Borneman (1420-4)



7.10 Borneman (1420-6)



7.8  
7.9  
7.10



7.11 Vogel (H20-5)



7.12 Harris (H20-2)



7.13 Robery (H20-3)



7.14 BricheHo (H20-1)



7.15 State land (H21)



7.17 State land (H21)





7.23 Houden (1423-2)



7.24 Houden (1423-2)



7.25 Houden (1423-2)



7.16 State land (1421)



7.21 State land (1421)



7.22 Houden (1423-1)



**Bear Lake: Lake Shoreline Inventory: June 8, 1999.**

Photo	Notes
Roll 1	
12 and 13	NO PICTURES #12 and #13 background native vegetation Nearshore: brasenia (watershield); mucky bottom; Emergent vegetation sagittaria
14	1 <sup>st</sup> house: STAEDLER (1429-10)
15	DETTLAFF (1429-11) Shoreline filled in Spruce and tamarack removed
16	JALINSKI (1429-9) brasenia, spatterdock, white lilies and arrowhead in 3 feet of water
17	WALLACE (1429-7) natural shoreline vegetation with some removal
18	SWIRTH (1429-8) natural shoreline, some vegetation removed
20	BEGGS (1429-2) some vegetation has been removed (noticeable)
22	THEISEN (1429-4)
23	SMITH (1429-1) Brasenia in nearshore area, little bit of clearing
24	JOHNSON (1429-6) bent grass
25	NO PICTURE
26	BARNEY (1429-3) New addition
27	WINCHELL (1429-5) Some clearing
28 and 29	LASKOWSKI (1429-7) Half is natural and some is cleared
30	WESLEY (1426-4) Unbuilt, natural arrowhead and white lilies
32	DICK LEMANSKI (1424-4) half natural bottom conditions becoming sandy
33 and 34	WIERSCHEM (1424-1) natural vegetation on one side double lot
35 and 36	ANDERSON (5570 and 5571) double lot
37	MAZZA (5572-4 and 5572-5) Around point, one side



Photo	Notes
Roll 2	
3, 4, and 5	PRIMOZIGH (5572-3) 1940 this was an old lighthouse around point Brunner'S Point
6	WEISSGERBER (5572-2)
8	PARYER (5572-1) 100 steps
9	DREHOBL (5572) bottom gravel rock plant poor
10	DREHOBL (5572) natural part of shoreline
Lake level has 6 inches in outlet stream	
12	PEDERSON (5573) left a dead tree in place no emergent vegetation
13	MACHIN (5574) House on the hill lots of vegetation bottom is firm
14	SCHAMPERS (1424-3) Boat house
15	BUTLER/FINKE (1424-2)
16	KNAPP (1426-5) vegetation cleared away
17	LARSEN (1426-1) shoreline vegetation clear no chance for erosion control here
18	STAFFEIL (1426-2) clearing but no lawn
19	LARSEN (1426-1)/STAFFEIL (1426-2)
20	KRIENKE (1425-8)
21	KNAPP (1425-8) vacant lot
22, 23, 24	22=PANPORE (1425-9); 23=RADOSEVICH (1425-10); 24= (1425-3) District wanted this property, floating board walk
25	

Photo	Notes
Roll 3	
2	vacant lot, Butler tree down
3	SCHIE FELBEIN shoreline is sandy
4	KAPELIS
7	RUCH (1425-13) Few trees trimmed out, no lawn big cabin one lake
8	KOPECKY (1425-4)
9	MINNIHAN (1425-1) Big dish, gone
11	MUNSCH (1425-7)
12	Interlocken woods boat landing (H425) Access to lake for walk in little lake behind property
13 and 14	DOELGER (H258) spring
15	KURSZEWski (H258-10) boat house
17	WEISENGERGER (H258-9)
19	ZAKRZEWSKI (H258-7)
20	NOETHLING (H258-8)
21	LENZEN (H258-6) sand bottom
22	REPINSKI (H258-3)
23	BROWN (H258-4) PILLEN (H258-2)
24	PILLEN/WEBER (H258-1)
25	VAN PROOIJEN (H257-1 and H257-2)

Photo	Notes
Roll 4	
2, 3, 4, and 5	(H257-1 AND H257-2) Ruths bay undeveloped from bay side (Sunset Resort) Sunset Resort along shoreline
6	(H1034, H1234-H1239)
9	HAPKE (H1032-H1033) Old Northern bay resort
10	WOLF (H1034) developed area
11	BATELL (H1236) 6-7 lots that have been developed in last 5 years
12	CAYWOOD (H1237)
13	DAHM (H1238) log cabin
14	AHGREMS (H1239) Bear Lake marina
17	BRAUN (H1241)/NUCKOLS (H1240)
18	BENDER (H255) few trees out
20	MUNDT (1415-5) Double lot natural shoreline one of the oldest places, 40-50s
21	MUNDT lot 2 (1415-5)
Secchi disc: 10 feet	
23	MUNDT (1415-27)
24	LEE (1415-1)

Photo	Notes
Roll 5	
1	DEWICK (1415-25) Old time fishhouse
2	NOWICK (1415-9)
3	HUGHES (1415-3) Old stone wall
4	HUGHES (1415-12) empty lot natural shoreline no signs of erosion
6	LANDS (1415-4) cabin since the 40s
7	LANDS (1415-4) Around the point, ice ridge
8	LANDS (1415-4) Old wave action, under oak tree old lake level
9	JACOBI (1415-18) and LANDS (1415-4) Natural shoreline
11	JACOBI (1415-18)
12	RING (1415-17)
13	STENSBERG (1415-2)
14	KRUSE (1415-16)
15	JOHNSON (1415-13) plants between places
17	HUBER (1415-14)
18	MARCIS (1415-19)
19	ROLOFF (1415-15) lot line is white stake
20	REIMER (1415-21) and ROLOFF (1415-15) Native vegetation
23	LEPAK (1415-2)
24	LEPAK (1415-24)

Photo	Notes
Roll 6	
8	CHYNOWETH (1415-22) Little critters place
9	LARGE (4536) and JOSWICK (4535)
11	HAMILTON (4534) and COLE (4533)
12	PATNYTHES (4532) Old resort
14	MINOCQUA (1415-31) Boat landing, Town of Minocqua
15	SPENCER (1415-11) Next to the landing
16	SEIDEL (1415-6)
17	DAVIS (1415-7)
18	RADANT (1415-8) paved access
19	MUNDT (1415-10) little cabin by shoreline
20	MOTZ (1416-11)
22	HOWELLS (1416-2)
23	WILLIE (1416-1A) one of the oldest places
24	ROBERY (1416-4)
25	OBEL (1416-6)

Photo	Notes
Roll 7	
1	TAWAH (1416-10)
2	CHURCH (1416-9)
3	BLOMQUIST (1416-8)
4	SWIERSKI (1416-3) vacant lot
5	DANIELS (1416-7) new place, were told that they plan on leaving the shoreline as is
6	JANSEN (1416-5)
8	JANSEN (1420) loon on nest
9	BORNEMAN (1420-4)
10	BORNEMAN (1420-6) lots of underscore
11	VOGEL (1420-5) hill was cut into erosion potential low
12	HARRIS (1420-2)
13	ROBERY (1420-3) vacant lot
14	BRICHETTO (1420-1) log cabin
15	vacant land state land (1421) the point, foot traffic, no development
16	Shoreline - state land (1421)
17	dead fall - state land (1421)
21	Undeveloped areas, rushes - state land (1421)
22	HOUDEN (1423-1) dock, no house yet
23	HOUDEN (1423-2) trees are changing
24	HOUDEN (1423-2) Bear Creek, natural
25	HOUDEN, etc (1423-2) Bear Creek