

B.M. 'X'-1787 is a brass cap stamped Wisconsin Conservation Commission set in a concrete post located 55' East of center of Schwaller Road, 21' North of center of access road at public access on West side of lake. Assumed elevation=100.00' Water level=87.70' taken 4-19-73

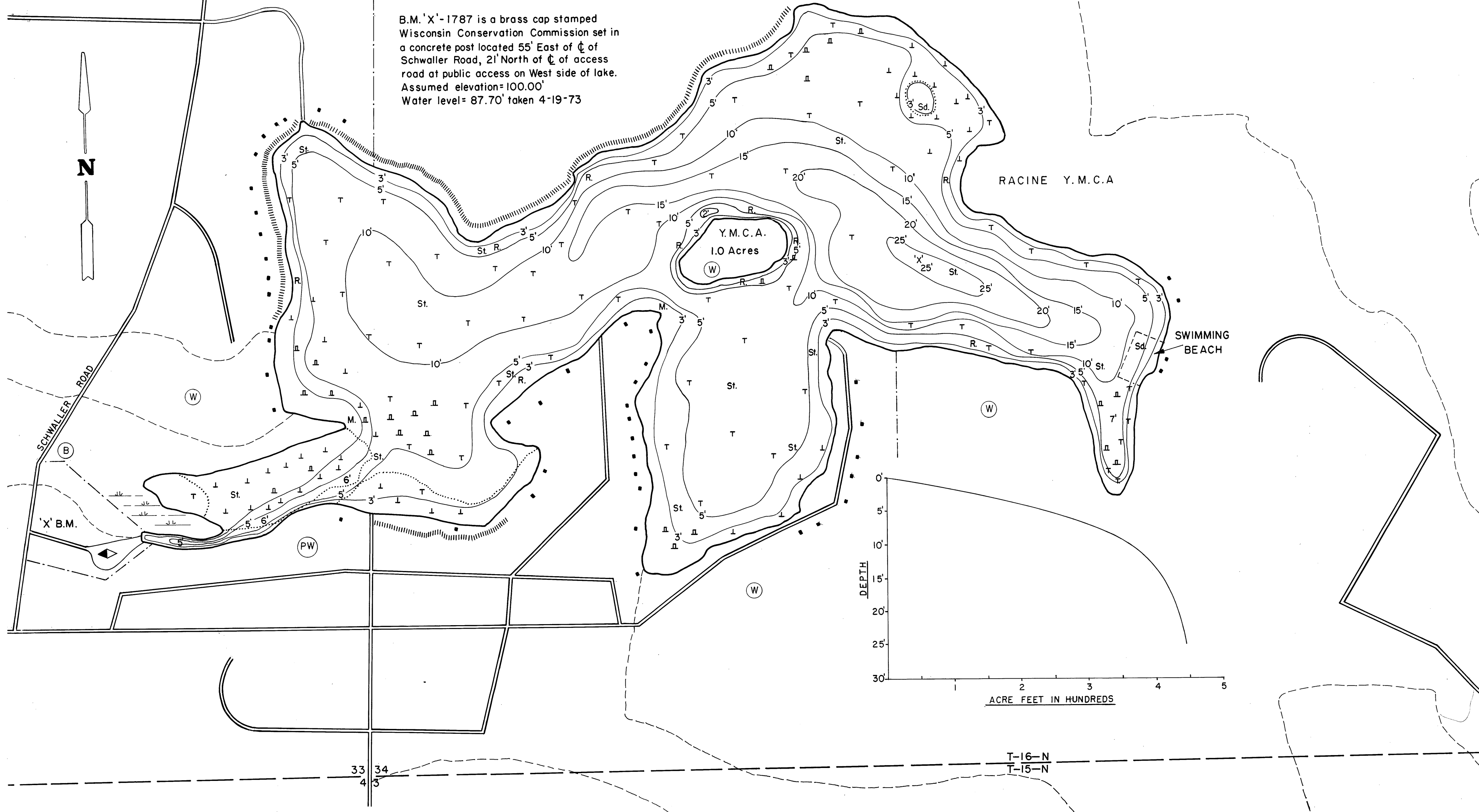

EQUIPMENT RECORDING SONAR MAPPED JUNE 1974
MONTH YEAR

TOPOGRAPHIC SYMBOLS		LAKE BOTTOM SYMBOLS	
(B) Brush	Steep slope	P. Peat	B Boulders
(PW) Partially wooded	- - - Indefinite shoreline	Mk. Muck	⊗ Stumps & Snags
(W) Wooded	Marsh	C. Clay	⊗ Rock danger to navigation
(C) Cleared	o Spring	M. Marl	T Submergent vegetation
(P) Pastured	--- Intermittent stream	Sd. Sand	⊥ Emergent vegetation
(A) Agricultural	==== Permanent inlet	St. Silt	⊥ Floating vegetation
B.M. Bench Mark	==== Permanent outlet	Gr. Gravel	⊕ Brush shelters
■ Dwelling	⊥ Dam	R. Rubble	
□ Resort	D.N.R. State owned land	Br. Bedrock	
□ Camp			



Access Access with Parking Boat Livery
 Drawn by: G.Thuesen
 Field work by: D.Boese, R.Thrun

SPECIES OF FISH	Abundance		
	Abundant	Common	Present
Muskie			
N.Pike		X	
Walleye		X	
L.M.Bass	X		
S.M.Bass			
Panfish	X		
Trout			

WATER AREA 54 ACRES
 UNDER 3 FT. 15.4 %
 OVER 20 FT. 6.15 %
 MAX. DEPTH 25 FEET.
 TOTAL ALK. 137 P.P.M.
 VOLUME 445.29 ACRE FT.
 MAIN SHORELINE 2.24 MI.
 ISLAND SHORELINE 0.15 MI.

Source: Wisconsin Department of Natural Resources 608-266-2621
Little Elkhart Lake – Sheboygan County, Wisconsin DNR Lake Map
Date – Jun 1974 - Historical Lake Map - Not for Navigation
A Public Document - Please Identify the Source when using it.