

B.M. X' top of iron pipe by iron fence post
20' from lake.
Assumed elevation 100.00'
Water elevation 95.20'

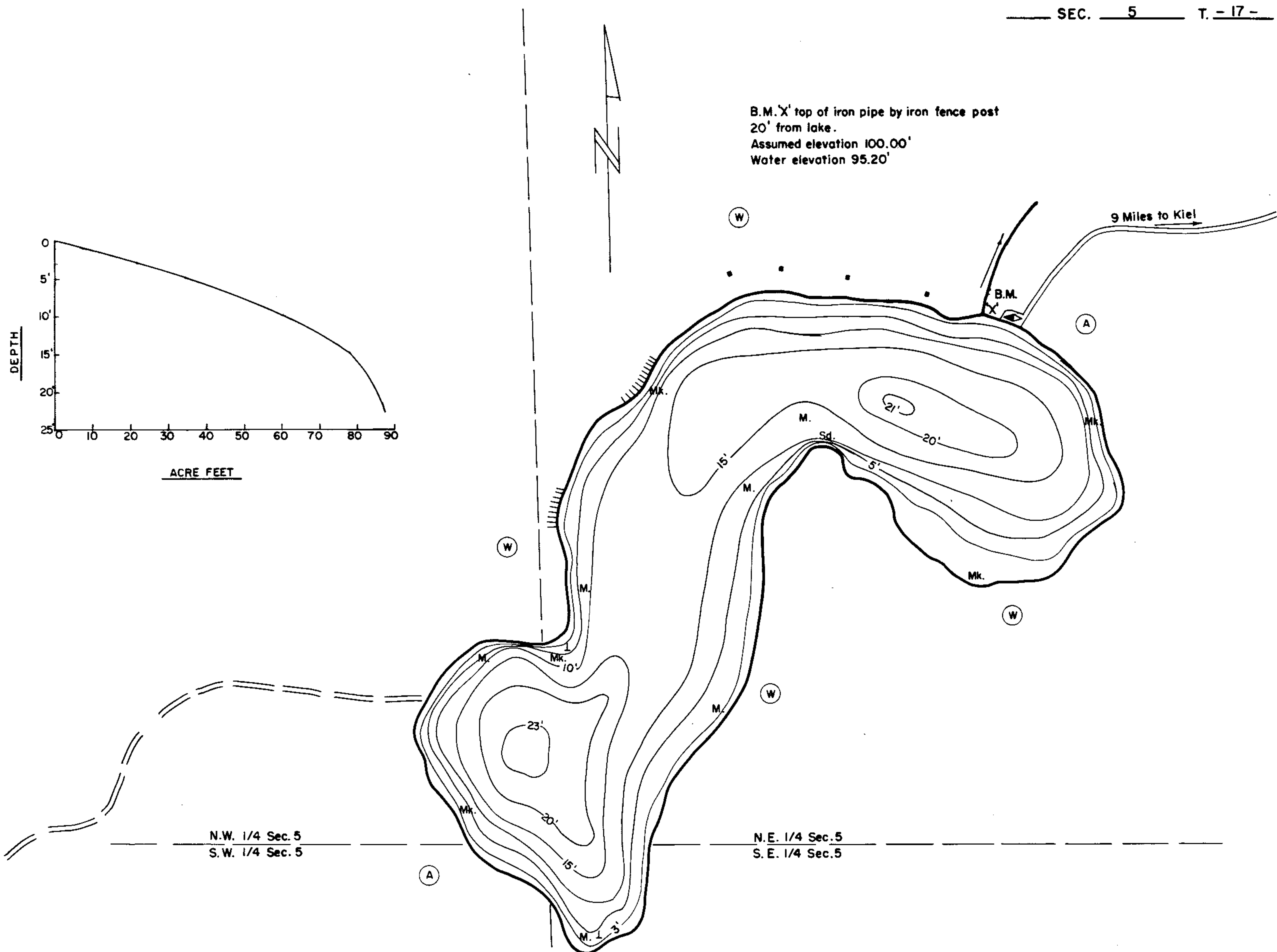

N.W. 1/4 Sec. 5
S.W. 1/4 Sec. 5

N.E. 1/4 Sec. 5
S.E. 1/4 Sec. 5

| SPECIES OF FISH | | |
|-----------------|----------|------|
| | Abundant | Rare |
| Muskie | | |
| N. Pike | X | |
| Walleye | | |
| L. M. Bass | X | |
| S. M. Bass | | |
| Panfish | X | |
| Trout | | |

EQUIPMENT RECORDING SONAR MAPPED MAY 1964
MO. YR.

- | TOPOGRAPHIC SYMBOLS | | LAKE BOTTOM SYMBOLS | |
|-----------------------|----------------------------|---------------------|-----------------------------|
| (B) Brush | Steep slope | P. Peat | Gr. Gravel % Stumps & Snags |
| (PW) Partially wooded | - - - Indefinite shoreline | Mk. Muck | R. Rubble |
| (W) Wooded | Marsh | C. Clay | Br. Bedrock |
| (C) Cleared | Spring | M. Marl | T Submergent vegetation |
| (P) Pastured | Intermittent stream | Sd. Sand | ↑ Emergent vegetation |
| (A) Agricultural | Permanent inlet | St. Silt | ⊕ Floating vegetation |
| B.M. Bench Mark | Permanent outlet | | |
| • Dwelling | Dam | | |
| ▣ Resort | | | |

WATER ELEV. 95.20'

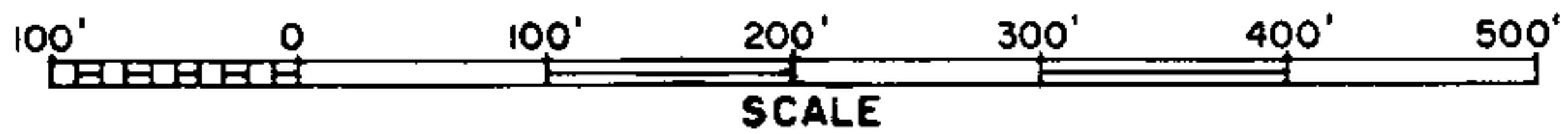

◇ Access ◆ Access with Parking ◆ Boat Livery
Field work by: H. Schmutz, F. Hilbert Drawn by: J. Roth

AREA 7.7 ACRES
UNDER 3 FT. 11.7 %
OVER 20 FT. 9.1 %
VOLUME 87.4 ACRE FT.
TOTAL ALK. 188 P.P.M.
SHORELINE 0.5 MILES
MAX. DEPTH 23 FEET

Source: Wisconsin Department of Natural Resources 608-266-2621
Spring Lake – Manitowoc County, Wisconsin DNR Lake Map
Date – May 1964 - Historical Lake Map - Not for Navigation
A Public Document - Please Identify the Source when using it.