

LAKE MARL
SECTION 14
TOWNSHIP T. 19. N
RANGE R. 9. E
TOWN DEERFIELD
COUNTY WAUSHARA

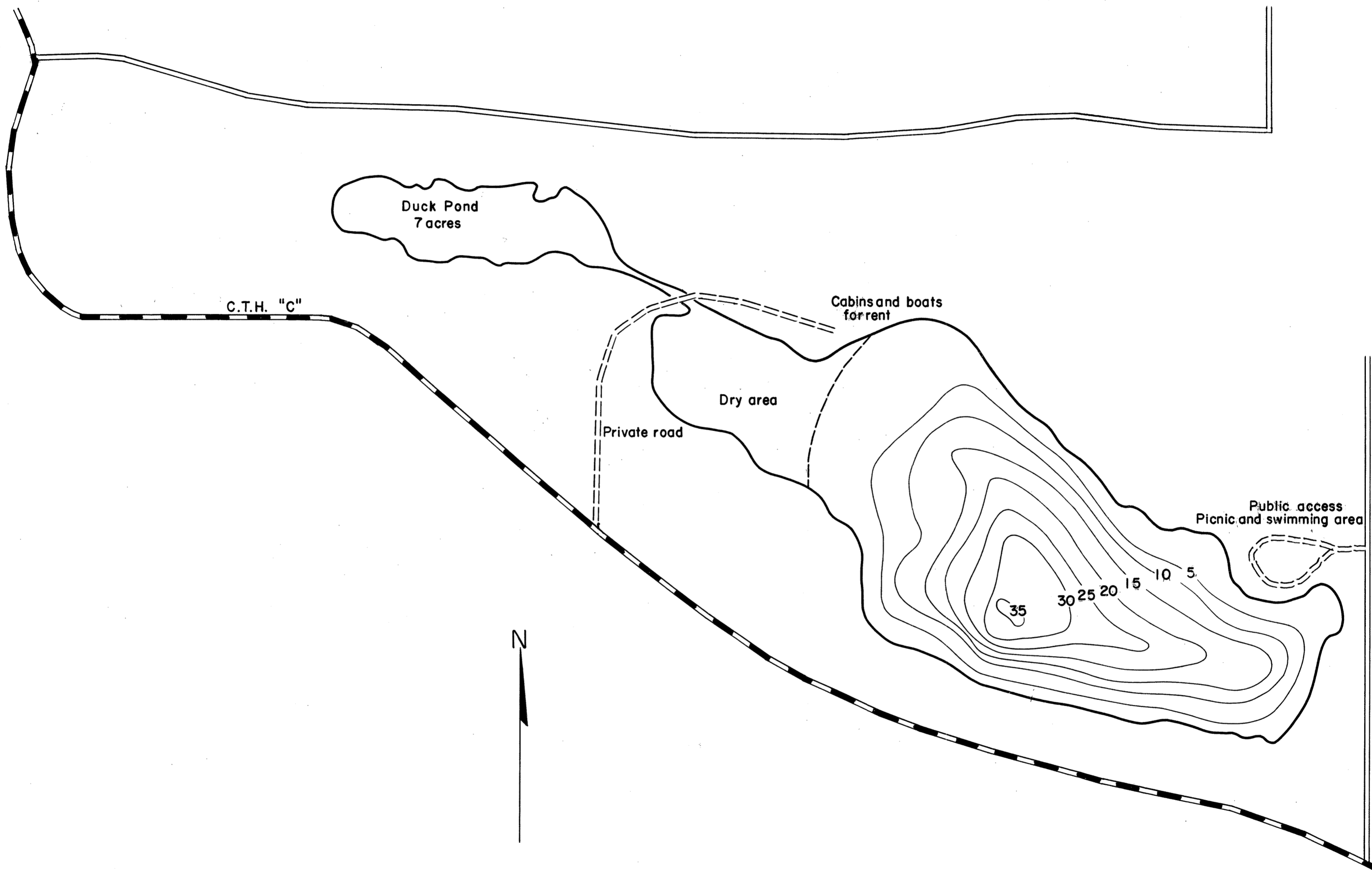

Lake mapped 7/28/55

AREA 49 Acres
TOTAL SHORELINE 1.4 Miles
MAX. DEPTH 35 Feet
SCALE: 16" = 1 Mile

Source: Wisconsin Department of Natural Resources 608-266-2621

Marl Lake – Waushara County, Wisconsin DNR Lake Map

Date – Jul 1955 - Historical Lake Map - Not for Navigation

A Public Document - Please Identify the Source when using it.