

LAKE SURVEY MAP

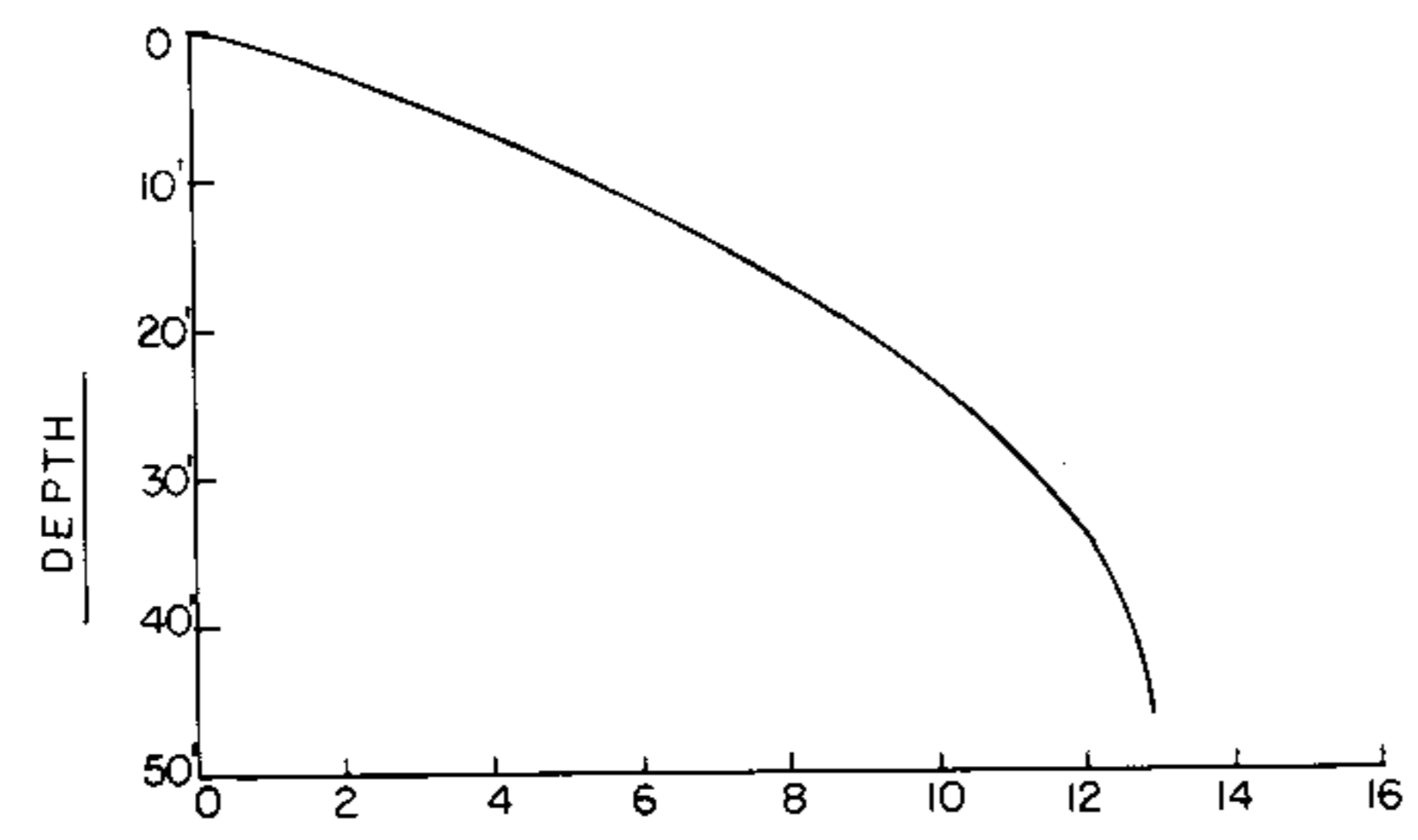

ACRE FEET IN HUNDREDS
78.34 ACRES
UNDER 3 FT. 33.17%
OVER 20 FT. 40.20%
VOLUME 1286.1 ACRE FEET
SHORELINE 2.14 MILES
MAX. DEPTH 46 FT.

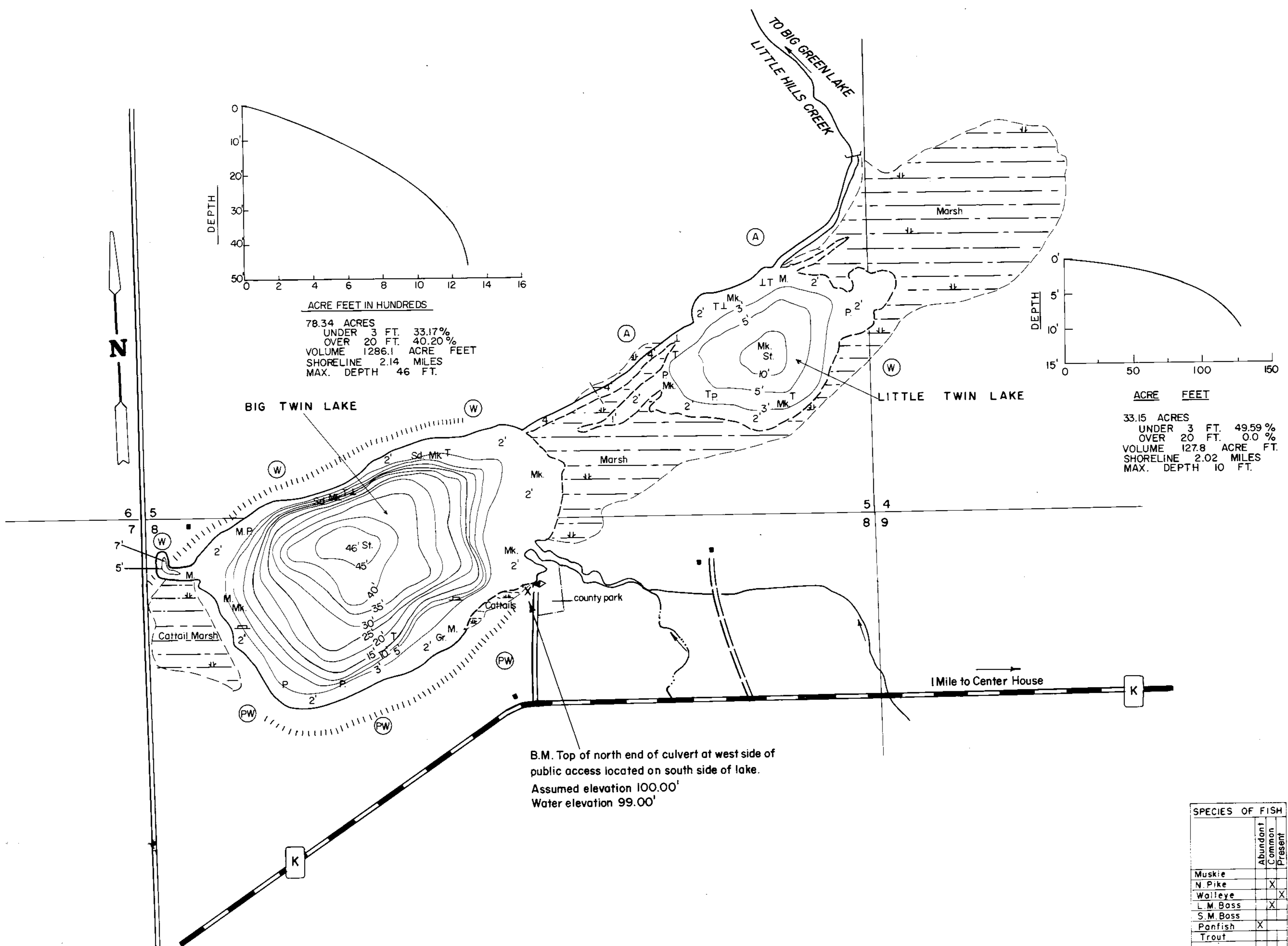
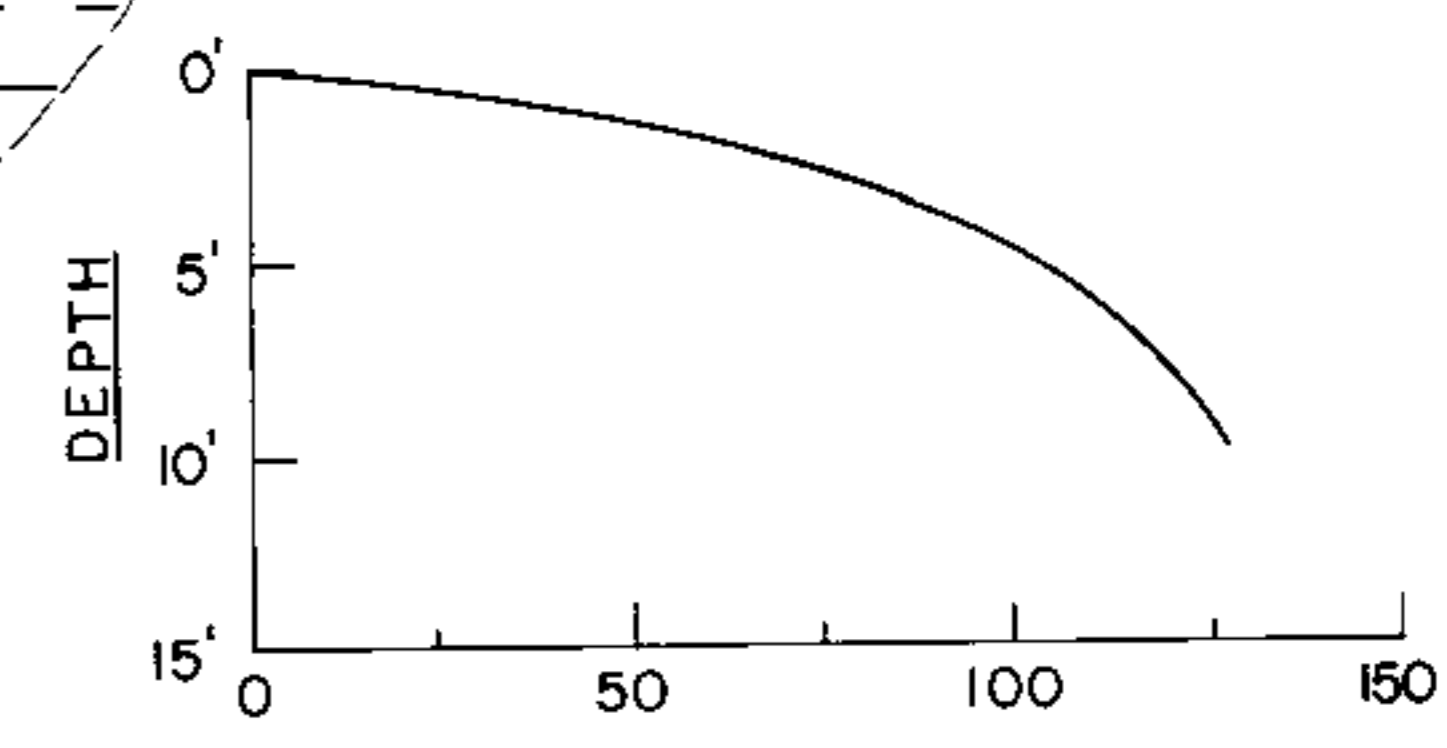

ACRE FEET
33.15 ACRES
UNDER 3 FT. 49.59%
OVER 20 FT. 0.0%
VOLUME 127.8 ACRE FT.
SHORELINE 2.02 MILES
MAX. DEPTH 10 FT.

B.M. Top of north end of culvert at west side of public access located on south side of lake.
Assumed elevation 100.00'
Water elevation 99.00'

1 Mile to Center House

EQUIPMENT RECORDING SONAR MAPPED MAY 1966
MO. YR.

- TOPOGRAPHIC SYMBOLS
- (B) Brush
 - (PW) Partially wooded
 - (W) Wooded
 - (C) Cleared
 - (P) Pastured
 - (A) Agricultural
 - B.M. Bench Mark
 - Dwelling
 - Resort
 - ||||| Steep slope
 - - - Indefinite shoreline
 - Marsh
 - Spring
 - Intermittent stream
 - Permanent inlet
 - Permanent outlet
 - Dam
- LAKE BOTTOM SYMBOLS
- P. Peat
 - Mk. Muck
 - C. Clay
 - M. Marl
 - Sd. Sand
 - St. Silt
 - Gr. Gravel
 - R. Rubble
 - Br. Bedrock
 - T Submergent vegetation
 - l Emergent vegetation
 - ⊕ Stumps & Snags
 - ⊕ Floating vegetation

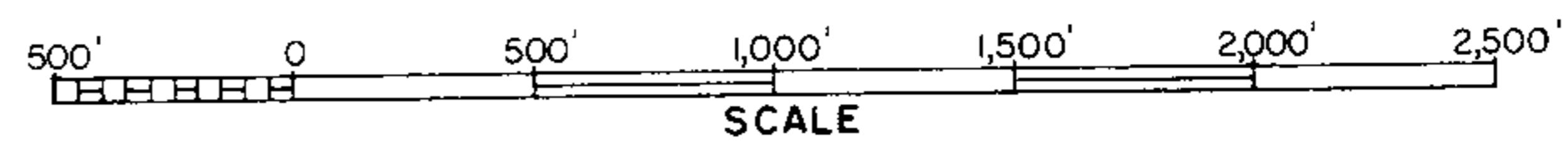

◇ Access ◆ Access with Parking ◆ Boat Livery
Field work by: H.Schmude, T.Corbett Drawn by: J.Roth

SPECIES OF FISH		
	Abundant	Common
Muskie		
N. Pike		X
Walleye		X
L.M. Bass		X
S.M. Bass		X
Panfish	X	
Trout		

TOTALS
AREA 111.49 ACRES
UNDER 3 FT. 38.6%
OVER 20 FT. 28.3%
VOLUME 1413.9 ACRE FT.
TOTAL ALK. 280 P.P.M.
SHORELINE 4.1 MILES
MAX. DEPTH 46 FEET

Source: Wisconsin Department of Natural Resources 608-266-2621
Big Twin Lake (Twin Lakes) and Little Twin Lake – Green Lake County, Wisconsin DNR Lake Map
Date – May 1966 - Historical Lake Map - Not for Navigation
A Public Document - Please Identify the Source when using it.