

LAKE SURVEY MAP

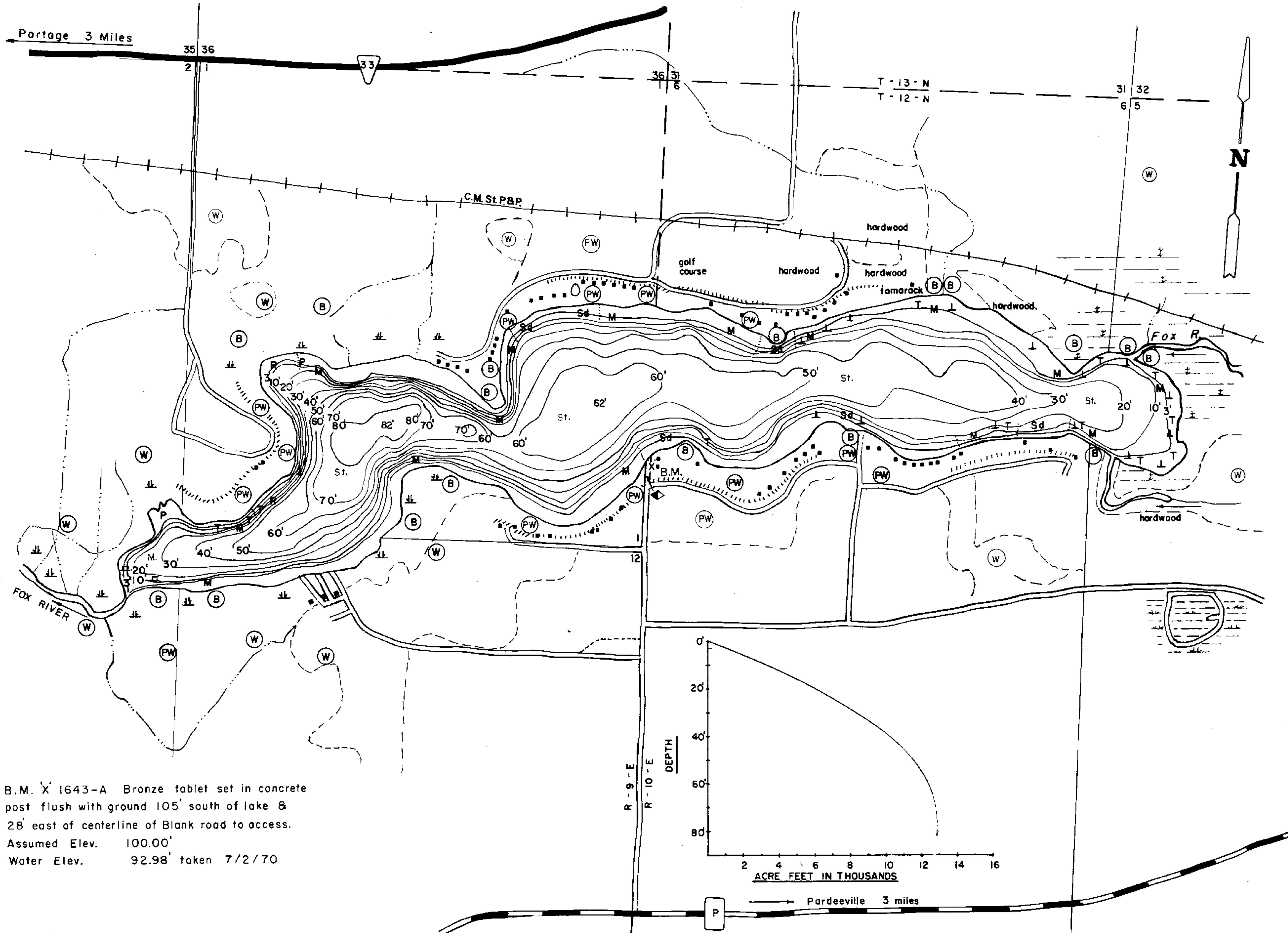

B.M. X 1643-A Bronze tablet set in concrete post flush with ground 105' south of lake & 28' east of centerline of Blank road to access.
Assumed Elev. 100.00'
Water Elev. 92.98' taken 7/2/70

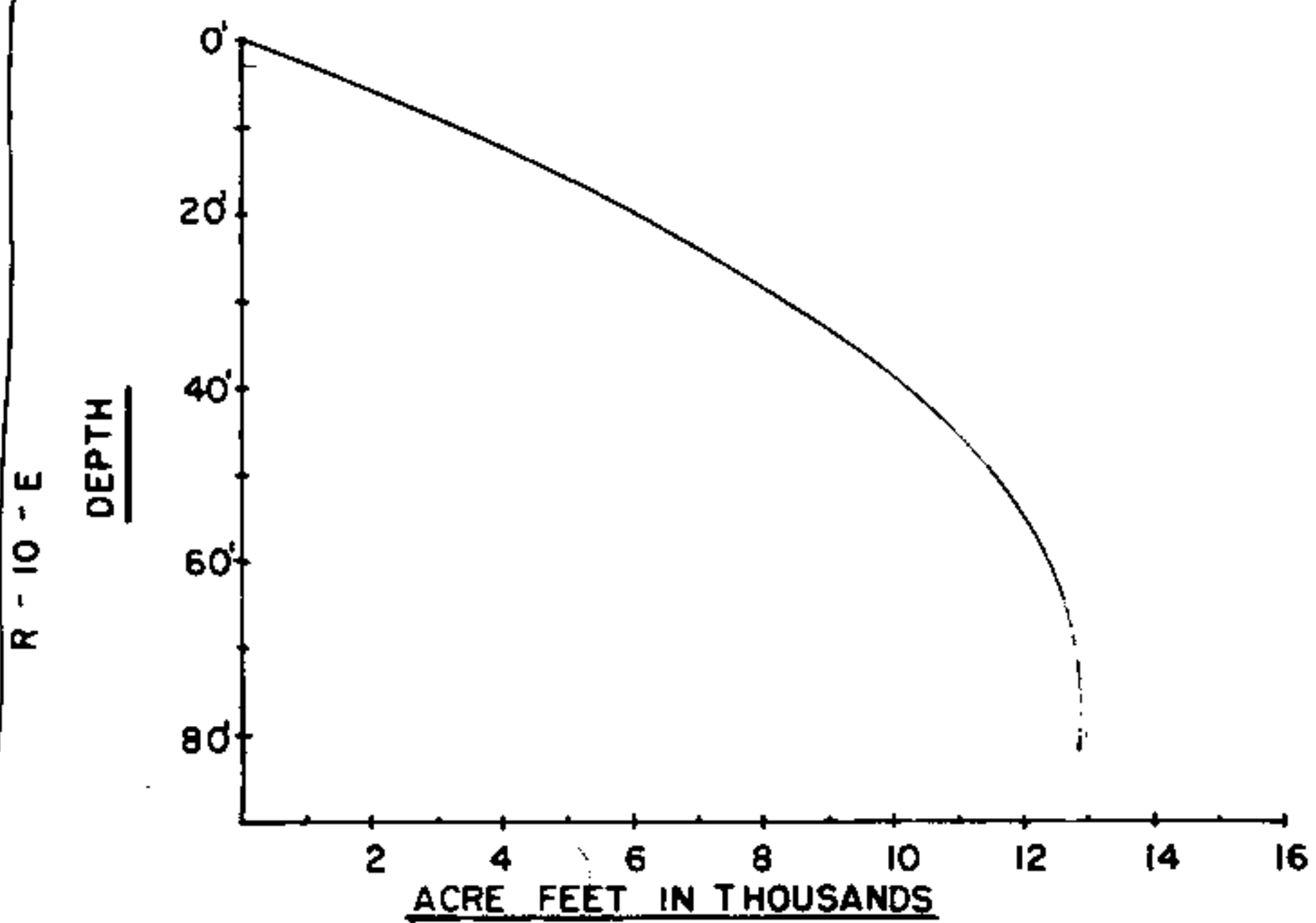

EQUIPMENT RECORDING SONAR MAPPED JULY 1969

- | TOPOGRAPHIC SYMBOLS | | MONTH | YEAR |
|-----------------------|-------------------------------|-------------|-----------------------------|
| | | LAKE | BOTTOM |
| (B) Brush | Steep slope | P. Peat | B Boulders |
| (PW) Partially wooded | ----- Indefinite shoreline | Mk. Muck | o Stumps & Snags |
| (W) Wooded | ----- Marsh | C. Clay | ⊗ Rock danger to navigation |
| (C) Cleared | ----- Spring | M. Marl | T Submergent vegetation |
| (P) Pastured | ----- Intermittent stream | Sd. Sand | ⊥ Emergent vegetation |
| (A) Agricultural | ----- Permanent inlet | St. Silt | ⊥ Floating vegetation |
| B.M. Bench Mark | ----- Permanent outlet | Gr. Gravel | ⊥ Brush shelters |
| ■ Dwelling | ----- Dam | R. Rubble | |
| ■ Resort | ----- D.N.R. State owned land | Bc. Bedrock | |
| ■ Camp | | | |

800' 0 800' 1600' 2400' 3200'
SCALE
◆ Access ◆ Access with Parking ◆ Boat Livery
Drawn by: T. Hampton
Field work by: J. Bail & M. Kepper

SPECIES OF FISH	ABUNDANCE		
	Abundant	Common	Present
Muskie			
N. Pike			
Walleye			X
L.M. Bass			X
S.M. Bass			
Panfish	X		
Traut			

WATER AREA 405.88 ACRES
UNDER 3 FT. 19 %
OVER 20 FT. 63 %
MAX. DEPTH 82 FEET.
TOTAL ALK. 210 P.P.M.
VOLUME 12,897.56 ACRE FT.
SHORELINE 6.04 MILES

Source: Wisconsin Department of Natural Resources 608-266-2621
Swan Lake – Columbia County, Wisconsin DNR Lake Map
Date – Jul 1969 - Historical Lake Map - Not for Navigation
A Public Document - Please Identify the Source when using it.