

# LAKE SURVEY MAP

WISCONSIN CONSERVATION DEPARTMENT  
 BIOLOGY DIVISION  
 LAKE AND STREAM IMPROVEMENT SECTION

LAKE PREACHER, Minister FORM FI-17  
 SECTION 22  
 TOWNSHIP 24 N  
 RANGE 10 E  
 TOWN OF NEW HOPE  
 COUNTY PORTAGE

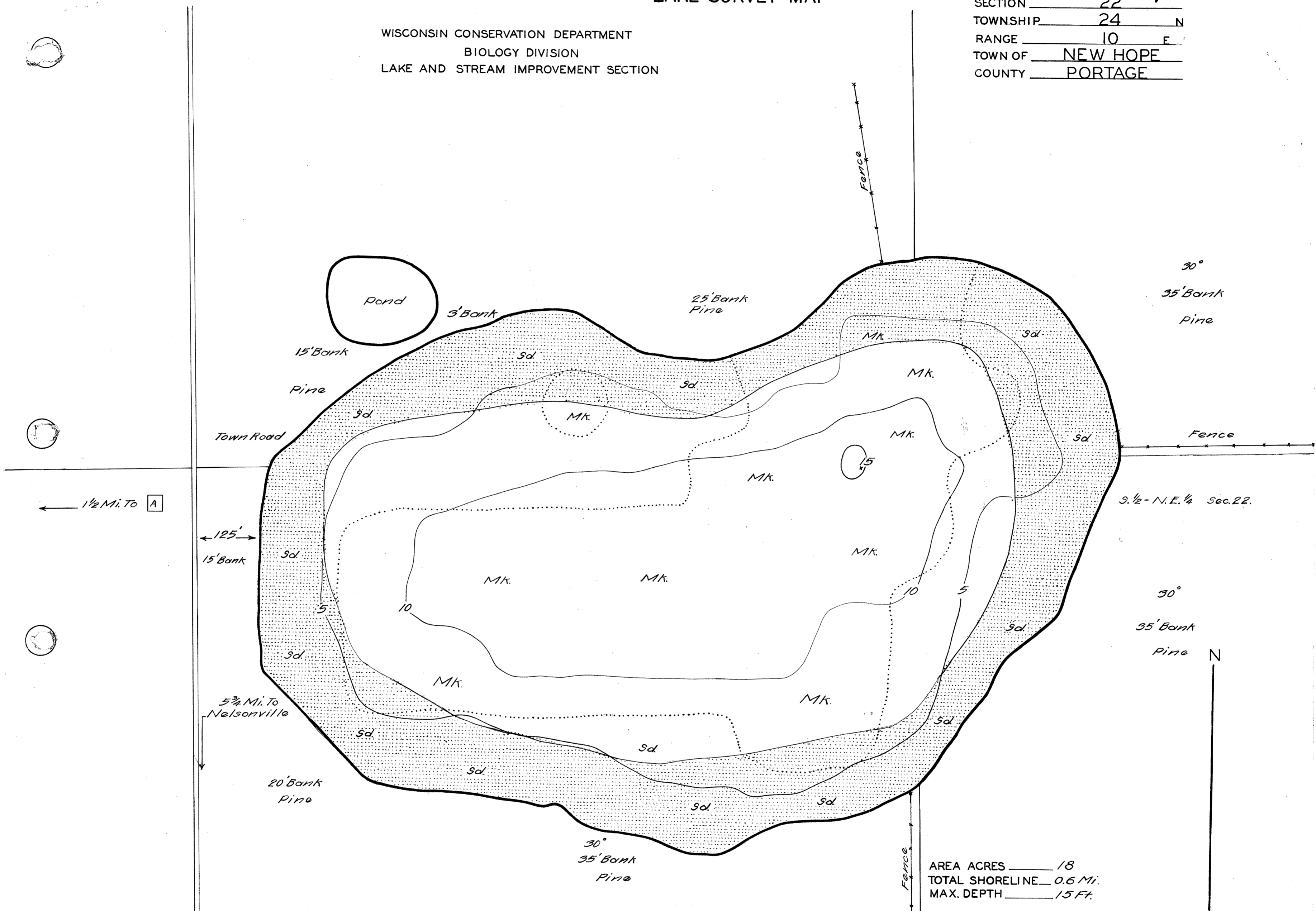

AREA ACRES 18  
 TOTAL SHORELINE 0.6 Mi.  
 MAX. DEPTH 15 Ft.

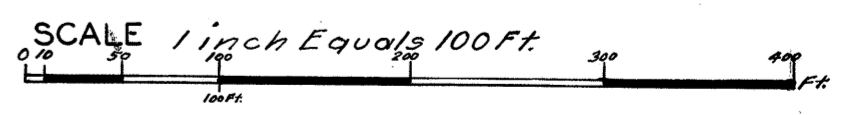

DATE July 28 1941  
 COMPILED BY \_\_\_\_\_  
 TRACED BY W. T. Z. (W.P.A.)  
 SOURCE OF INFORMATION \_\_\_\_\_  
W.P.A. Lake Survey Project  
 \_\_\_\_\_  
 \_\_\_\_\_  
 SOUNDINGS 100 Ft. intervals  
 \_\_\_\_\_  
 \_\_\_\_\_  
 DATES OF MAP REVISION \_\_\_\_\_  
 \_\_\_\_\_  
 WORK AGENCY W. P. A.

| LAKE IMPROVEMENT RECORD |       |       |       |
|-------------------------|-------|-------|-------|
| TYPE                    | DATE  |       |       |
| ○ BRUSH TANGLES         | _____ | _____ | _____ |
| — SAPLING TANGLES       | _____ | _____ | _____ |
| □ SPAWNING BOXES        | _____ | _____ | _____ |
| * MINNOW SPAWNERS       | _____ | _____ | _____ |
| TOTAL                   | _____ | _____ | _____ |

- LEGEND
- WEED BEDS
  - ⊕ ROCKY SHOALS
  - Sd SAND
  - Cl CLAY
  - Gn GRAVEL
  - Mk MUCK
  - DWELLING
  - ABANDONED DWELLING
  - ▣ RESORT

Source: Wisconsin Department of Natural Resources 608-266-2621  
Preacher Lake (Minister Lake) – Portage County, Wisconsin DNR Lake Map  
Date – Jul 1941 - Historical Lake Map - Not for Navigation  
A Public Document - Please Identify the Source when using it.