

# LAKE SURVEY MAP

LAKE STOLTENBERG  
 SECTION 5-8  
 TOWNSHIP 23 N  
 RANGE 10 E  
 TOWN OF AMHERST  
 COUNTY PORTAGE

FORM FH-17

WISCONSIN CONSERVATION DEPARTMENT  
 BIOLOGY DIVISION  
 LAKE AND STREAM IMPROVEMENT SECTION

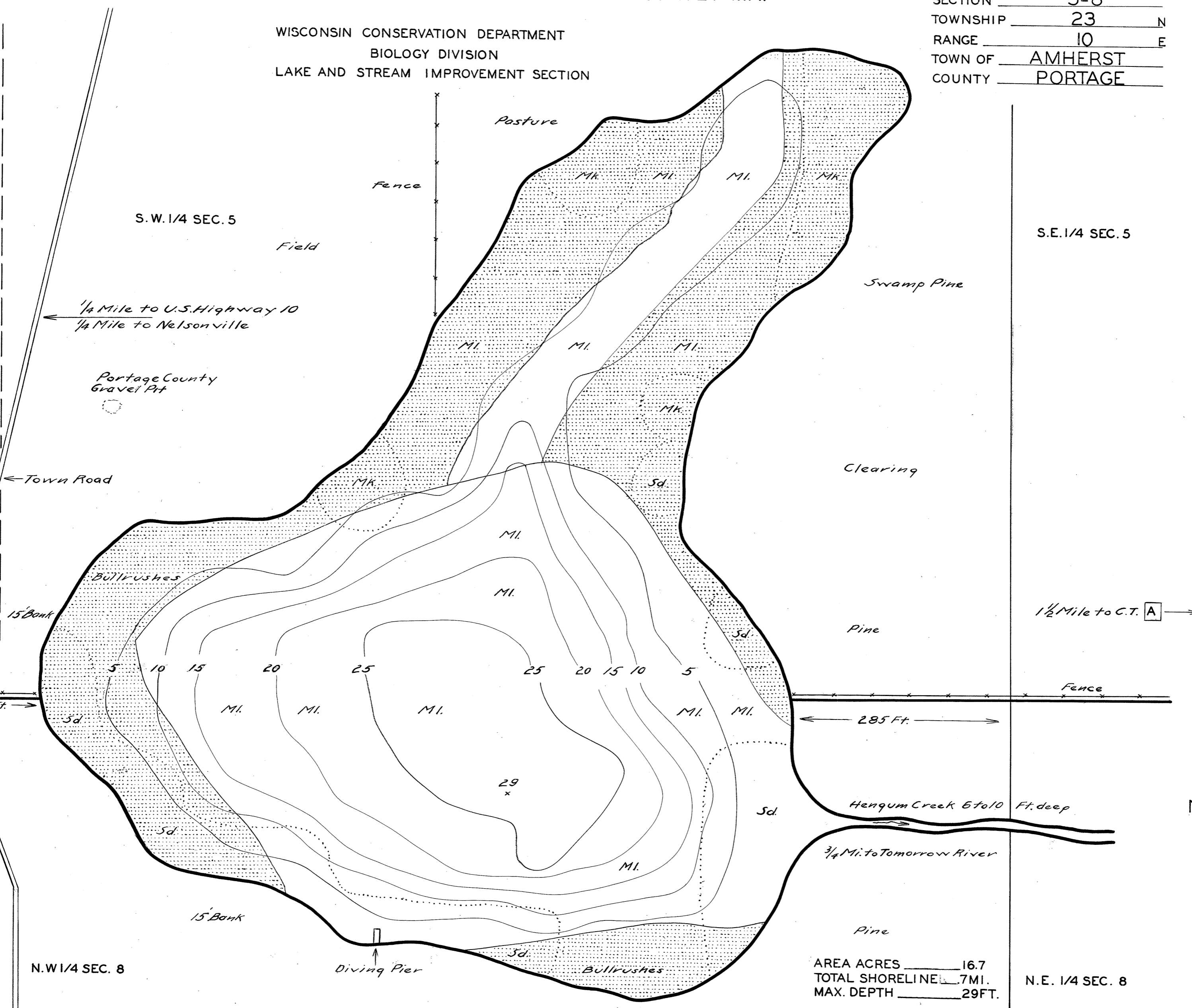

AREA ACRES 16.7  
 TOTAL SHORELINE .7 MI.  
 MAX. DEPTH 29 FT.

SCALE 1 INCH EQUALS 100 FT.

DATE AUG 7 1941  
 COMPILED BY \_\_\_\_\_  
 TRACED BY E.M.K. (W.P.A.)  
 SOURCE OF INFORMATION \_\_\_\_\_  
W.P.A. LAKE SURVEY PROJECT  
MAR. 1941  
 SOUNDINGS AT 100 FT. OR LESS \_\_\_\_\_  
MAR. 1941 INTERVALS \_\_\_\_\_  
 DATES OF MAP REVISION \_\_\_\_\_  
 WORK AGENCY W.P.A.

LAKE IMPROVEMENT RECORD	
TYPE	DATE
BRUSH REFUGES	_____
SAPLING TANGLES	_____
SPAWNING BOXES	_____
MINNOW SPAWNERS	_____
TOTAL	_____

- LEGEND
- WEED BEDS
  - ROCKY SHOALS
  - SD. SAND
  - CL. CLAY
  - GR. GRAVEL
  - MK. MUCK
  - DWELLING
  - ABANDONED DWELLING
  - RESORT
  - ML. MARL

*Field*  
 Checked  
 W.P.S.  
 E.M.K.  
 8/19/41

Source: Wisconsin Department of Natural Resources 608-266-2621  
Stoltenberg Lake – Portage County, Wisconsin DNR Lake Map  
Date – Aug 1941 - Historical Lake Map - Not for Navigation  
A Public Document - Please Identify the Source when using it.