

# LAKE SURVEY MAP

WISCONSIN CONSERVATION DEPARTMENT  
BIOLOGY DIVISION  
LAKE AND STREAM IMPROVEMENT SECTION

LAKE SILVER  
SECTION 28-29-32-33  
TOWNSHIP 20 N  
RANGE 11 E  
TOWN OF SPRINGWATER  
COUNTY WAUSHARA

FORM F-117

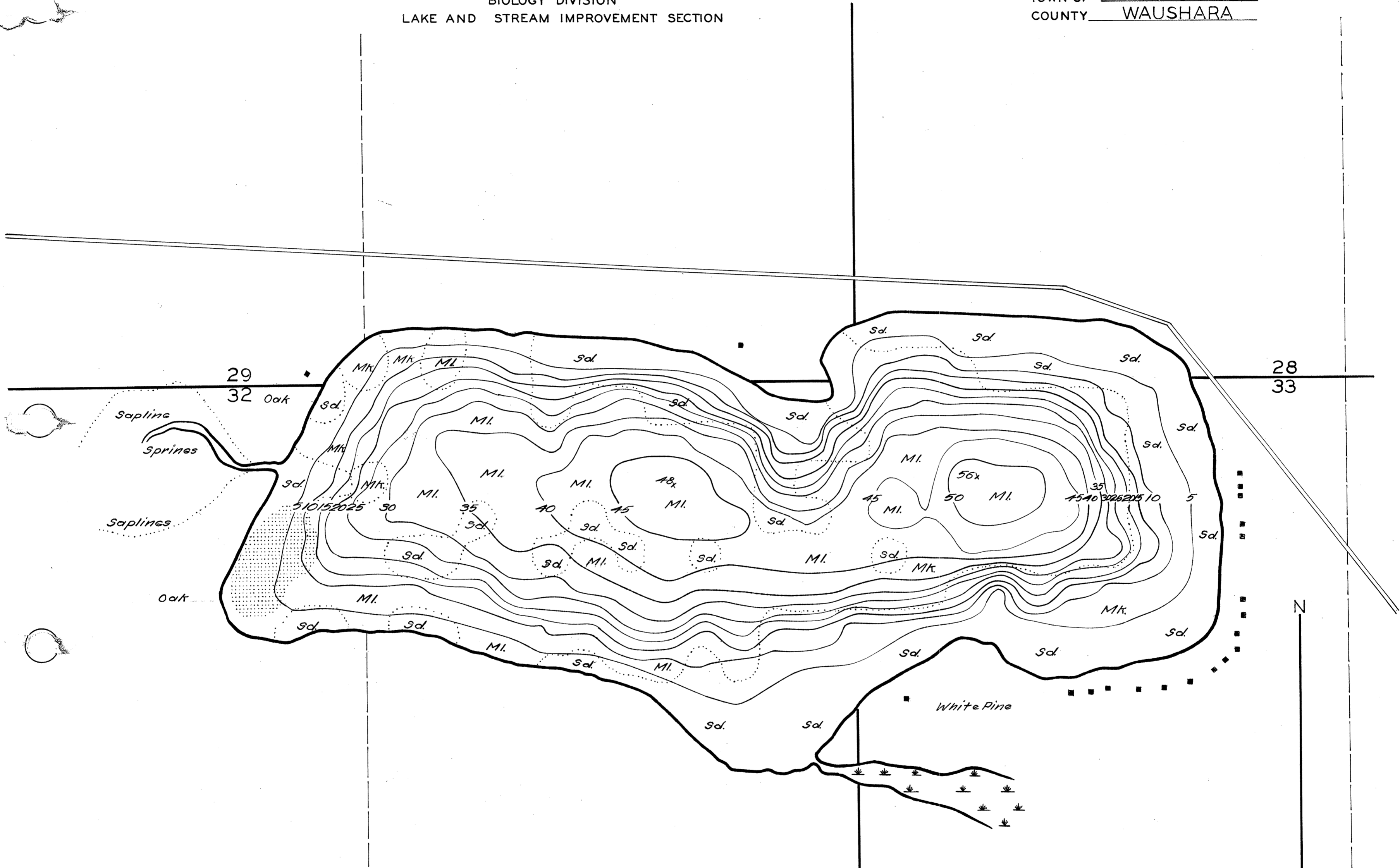

AREA ACRES 52.5  
TOTAL SHORELINE 1.4 Mi.  
MAX. DEPTH 56 Ft.

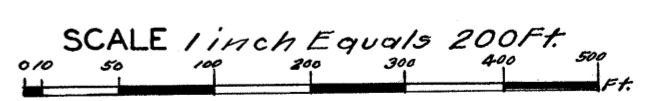

DATE July 1 1941  
COMPILED BY \_\_\_\_\_  
TRACED BY W.T.Z. (W.P.A.)  
SOURCE OF INFORMATION \_\_\_\_\_  
W.P.A. Lake Survey Project  
SOUNDINGS 100 Ft. intervals  
DATES OF MAP REVISION \_\_\_\_\_  
WORK AGENCY W. P. A.

### LAKE IMPROVEMENT RECORD

TYPE	DATE			
BRUSH REFUGES				
SAPLING TANGLES				
SPAWNING BOXES				
MINNOW SPAWNERS				
TOTAL				

- ### LEGEND
- WEED BEDS
  - ROCKY SHOALS
  - Sd.* SAND
  - Cl.* CLAY
  - Gr.* GRAVEL
  - Mk.* MUCK
  - DWELLING
  - ABANDONED DWELLING
  - RESORT
  - Ml.* Marl

*Checked*  
*W.P.S.*  
*D.B.*  
*7/3/41*

Source: Wisconsin Department of Natural Resources 608-266-2621

**Silver Lake** – Waushara County, Wisconsin DNR Lake Map

Date – Jul 1941 - Historical Lake Map - Not for Navigation

A Public Document - Please Identify the Source when using it.