

# LAKE SURVEY MAP

LAKE THORN FORM FI-117  
 SECTION 36  
 TOWNSHIP 23 N  
 RANGE 10 E  
 TOWN OF AMHERST  
 COUNTY PORTAGE

WISCONSIN CONSERVATION DEPARTMENT  
 BIOLOGY DIVISION  
 LAKE AND STREAM IMPROVEMENT SECTION

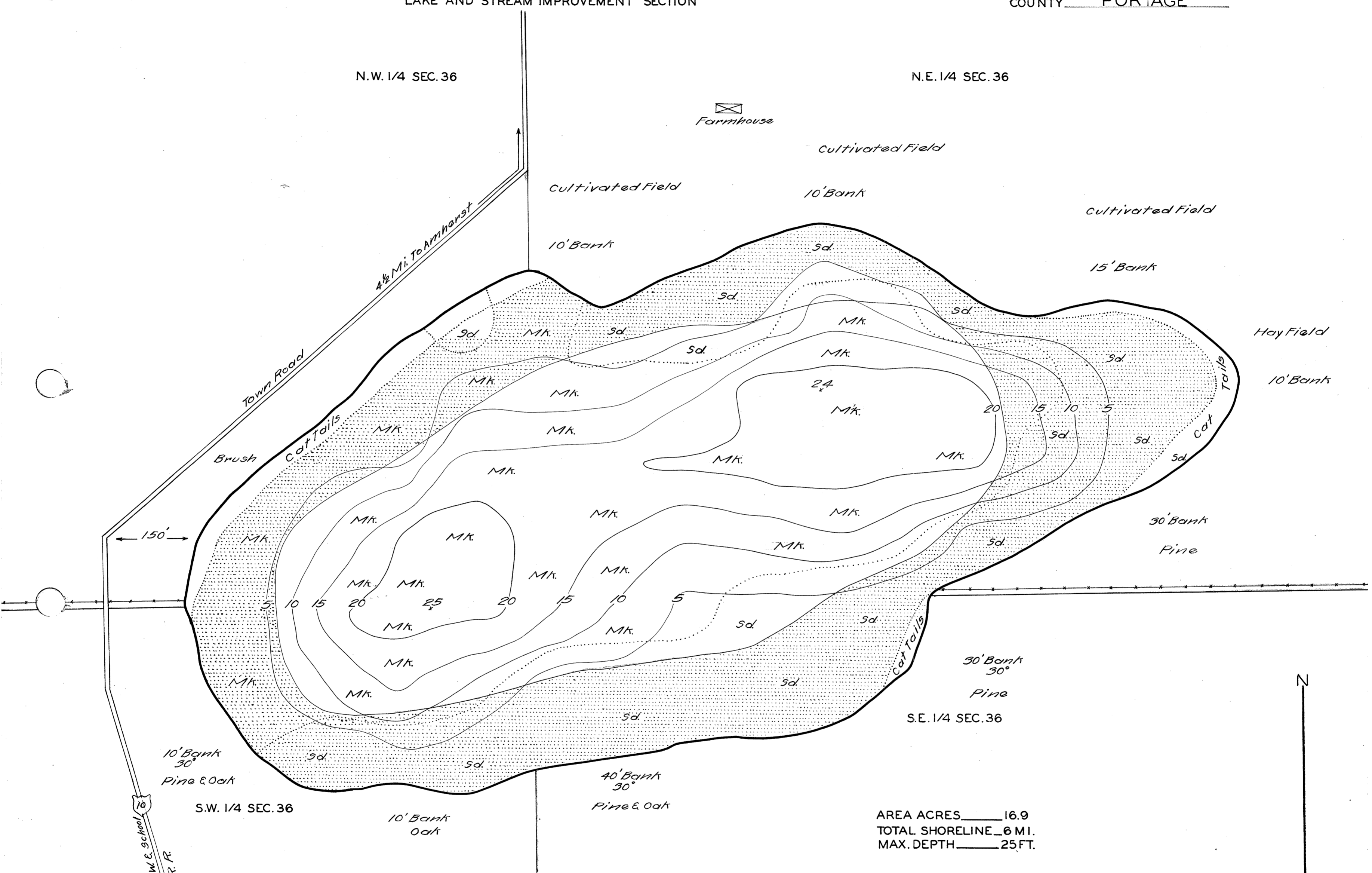

AREA ACRES 16.9  
 TOTAL SHORELINE 6 MI.  
 MAX. DEPTH 25 FT.

DATE AUG. 25 1941  
 COMPILED BY \_\_\_\_\_  
 TRACED BY W.T.Z. W.P.A.  
 SOURCE OF INFORMATION \_\_\_\_\_  
W.P.A. LAKE IMPROVEMENT PROJECT  
1941  
 SOUNDINGS AT 100 FT. INTERVALS \_\_\_\_\_  
 DATES OF MAP REVISION \_\_\_\_\_  
 WORK AGENCY W.P.A.

### LAKE IMPROVEMENT RECORD

TYPE	DATE	DATE	DATE	DATE	DATE
o BRUSH REFUGES	_____	_____	_____	_____	_____
- SAPLING TANGLES	_____	_____	_____	_____	_____
= SPAWNING BOXES	_____	_____	_____	_____	_____
* MINNOW SPAWNERS	_____	_____	_____	_____	_____
TOTAL	_____	_____	_____	_____	_____

SCALE 1 INCH EQUALS 100 FT.

- LEGEND**
- WEED BEDS
  - ROCKY SHOALS
  - SD SAND
  - CL CLAY
  - GR GRAVEL
  - MK MUCK
  - DWELLING
  - ABANDONED DWELLING
  - RESORT

Checked by  
 W.P.S.  
 E.M.K.  
 9/3 1941

Source: Wisconsin Department of Natural Resources 608-266-2621  
Thorn Lake – Portage County, Wisconsin DNR Lake Map  
Date – Aug 1941 - Historical Lake Map - Not for Navigation  
A Public Document - Please Identify the Source when using it.