

LAKE SURVEY MAP

Lower & Upper TIGERTON POND
LAKE

SHAWANO
COUNTY

SEC. 9, 16, 17 T. 26 N. R. 12 E.

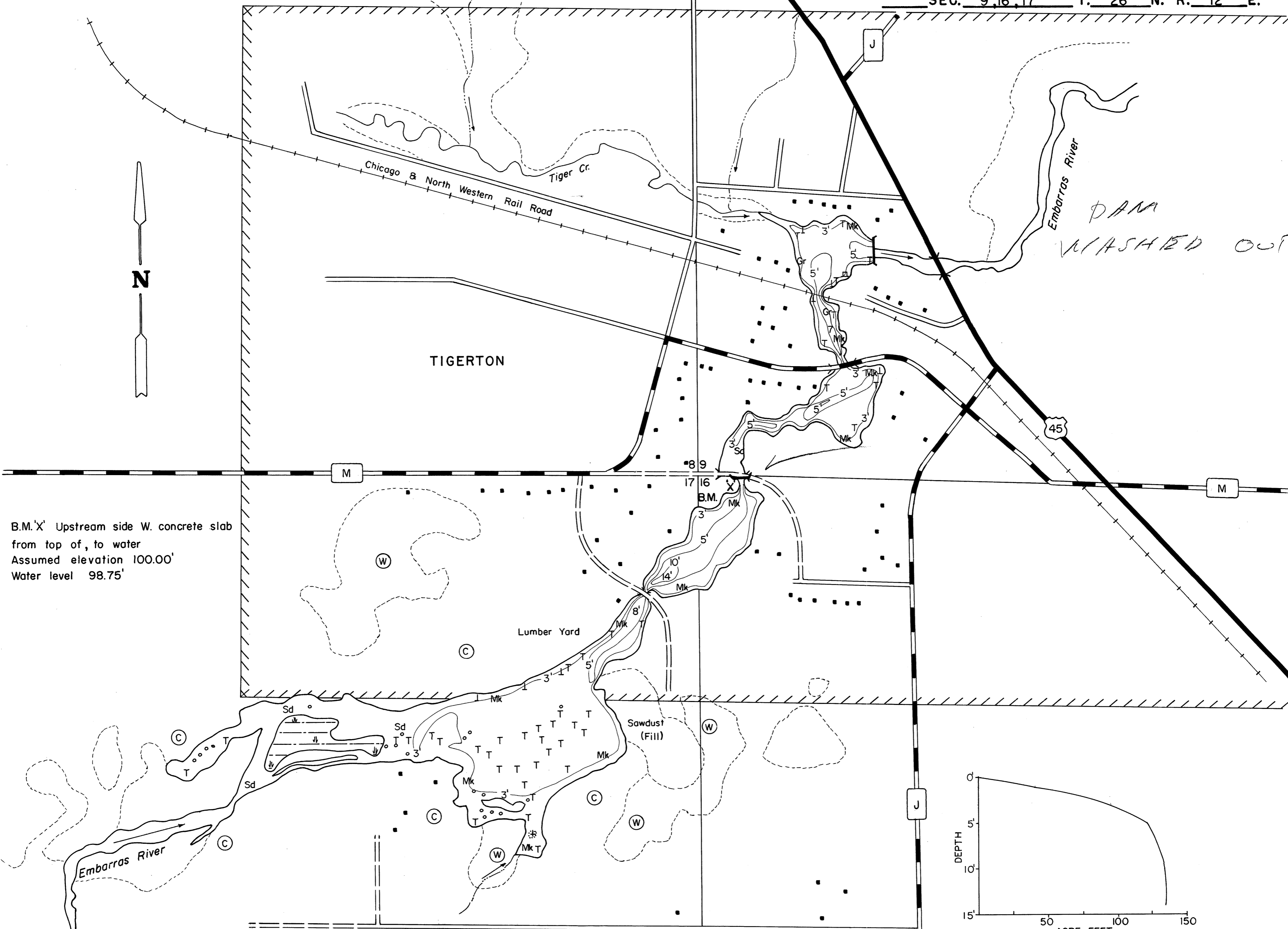

B.M. 'X' Upstream side W. concrete slab
from top of, to water
Assumed elevation 100.00'
Water level 98.75'

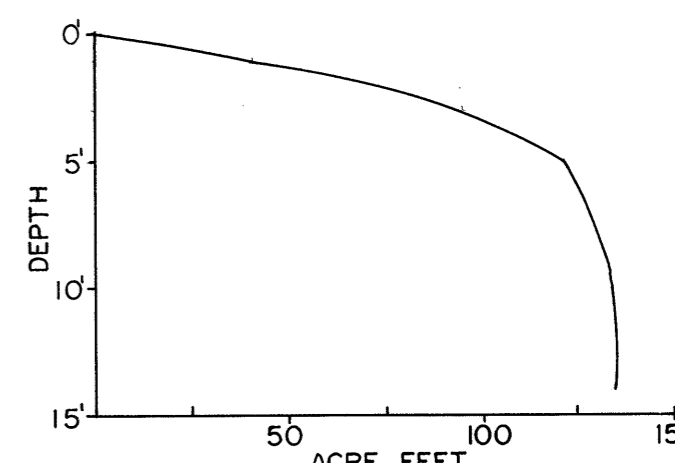

EQUIPMENT RECORDING SONAR MAPPED JULY 1969

- TOPOGRAPHIC SYMBOLS
- (B) Brush
 - (PW) Partially wooded
 - (W) Wooded
 - (C) Cleared
 - (P) Pastured
 - (A) Agricultural
 - B.M. Bench Mark
 - Dwelling
 - Resort
 - Camp
 - ||||| Steep slope
 - - - Indefinite shoreline
 - Marsh
 - Spring
 - Intermittent stream
 - Permanent inlet
 - Permanent outlet
 - Dam
 - D.N.R. State owned land

- LAKE BOTTOM SYMBOLS
- P. Peat
 - Mk. Muck
 - C. Clay
 - M. Marl
 - Sd. Sand
 - St. Silt
 - Gr. Gravel
 - R. Rubble
 - Br. Bedrock
 - B Boulders
 - Stumps & Snags
 - Rock danger to navigation
 - T Submergent vegetation
 - Emergent vegetation
 - Floating vegetation
 - Brush shelters

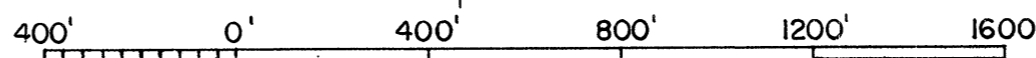

SCALE

- ◇ Access
- ◀ Access with Parking
- ◆ Boat Livery

Drawn by: C. Holt

Field work by:

SPECIES OF FISH	Abundant Common Present		
	Abundant	Common	Present
Muskie			
N. Pike			
Walleye			
L.M. Bass			
S.M. Bass			
Panfish			
Trout			

WATER AREA 40.9 ACRES
 UNDER 3 FT. 43.3 %
 OVER 20 FT. 0 %
 MAX. DEPTH 14 FEET.
 TOTAL ALK. 180 P.P.M.
 VOLUME 134.8 ACRE FT.
 SHORELINE 3.04 MILES

Source: Wisconsin Department of Natural Resources 608-266-2621
Lower and Upper Tigerton Pond – Shawano County, Wisconsin DNR Lake Map
Date – Jul 1969 - Historical Lake Map - Not for Navigation
A Public Document - Please Identify the Source when using it.