

# LAKE SURVEY MAP

ROBERTS LAKE  
SEC. 15, 6, 7 T. 34 N. R. 13, 14 E.  
FOREST COUNTY

R-13-E  
R-14-E

T-35-N  
T-34-N

NICOLET

NATIONAL

FOREST

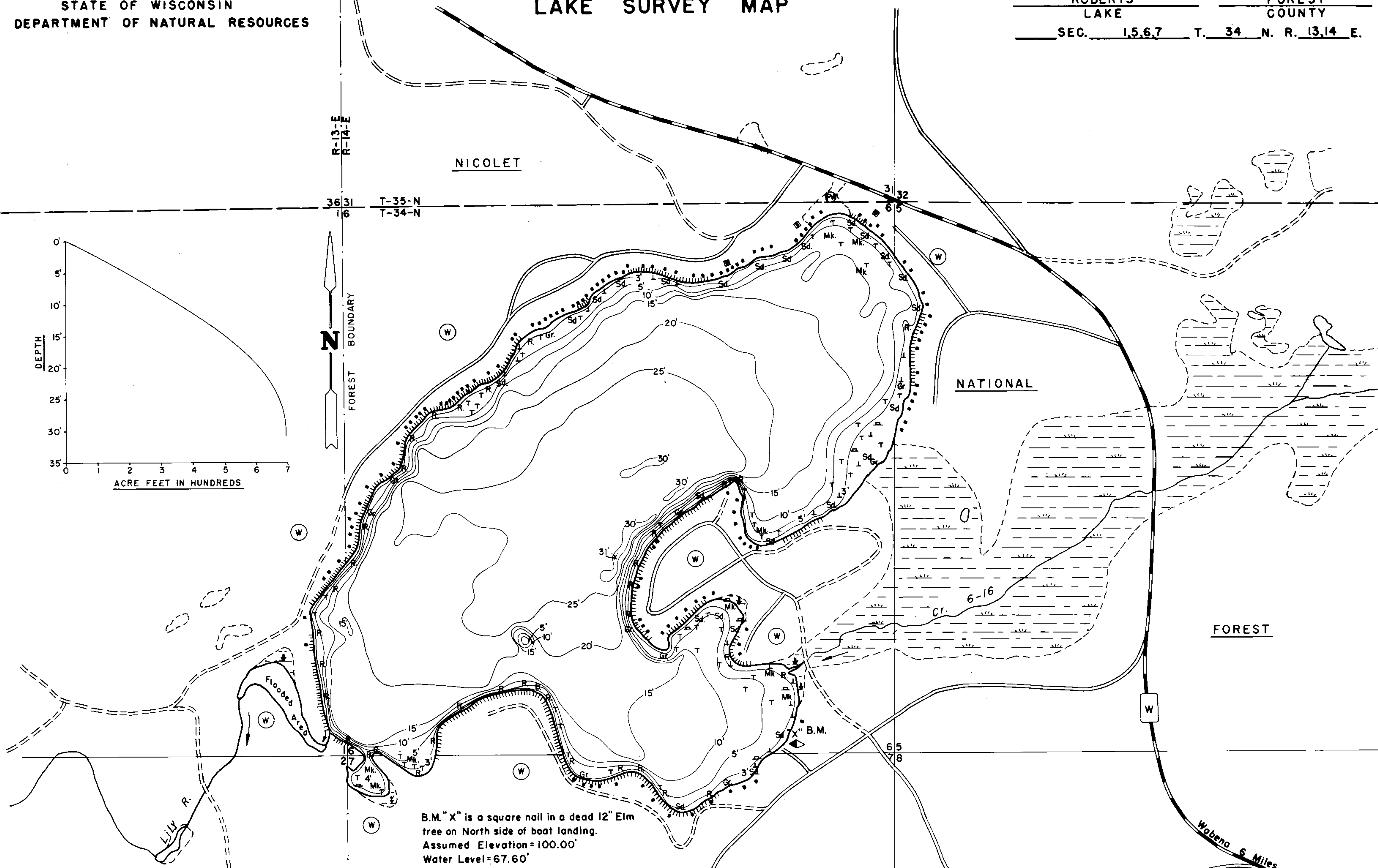
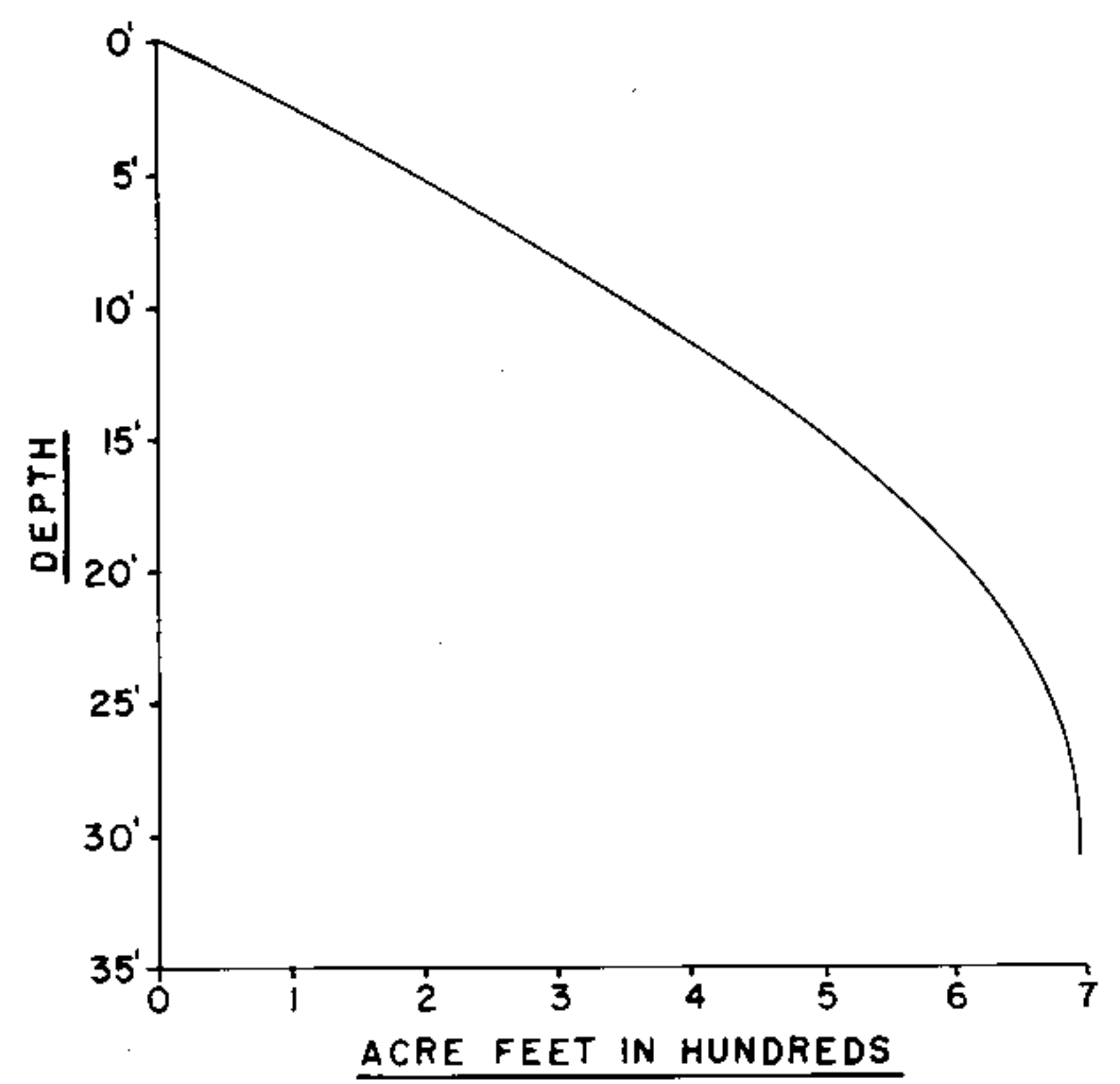

B.M. "X" is a square nail in a dead 12" Elm tree on North side of boat landing.  
Assumed Elevation = 100.00'  
Water Level = 67.60'

EQUIPMENT RECORDING SONAR MAPPED		SEPT	1975
TOPOGRAPHIC SYMBOLS		MONTH	YEAR
(B) Brush	Steep slope	P. Peat	B Boulders
(PW) Partially wooded	- - - Indefinite shoreline	Mk. Muck	o Stumps & Snags
(W) Wooded	Marsh	C. Clay	Rock danger to navigation
(C) Cleared	Spring	M. Marl	T Submergent vegetation
(P) Pastured	Intermittent stream	Sd. Sand	l Emergent vegetation
(A) Agricultural	Permanent inlet	St. Silt	△ Floating vegetation
B.M. Bench Mark	Permanent outlet	Gr. Gravel	▽ Brush shelters
■ Dwelling	Dam	R. Rubble	
■ Resort	D.N.R. State owned land	Br. Bedrock	
(C) Camp			

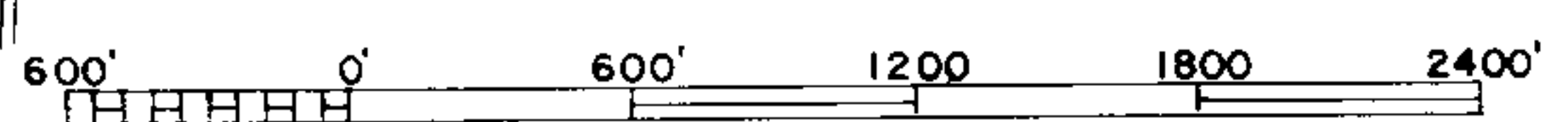

◆ Access    ◀ Access with Parking    ◆ Boat Livery  
 Drawn by: G. Thuesen  
 Field work by: J. Smith, K. Kaplan

SPECIES OF FISH	Abundance		
	Abundant	Common	Present
Muskie		X	
N. Pike		X	
Walleye		X	
L. M. Bass		X	
S. M. Bass		X	
Panfish	X		
Trout			

WATER AREA 414.5 ACRES  
 UNDER 3 FT. 5.5 %  
 OVER 20 FT. 41.8 %  
 MAX. DEPTH 31 FEET.  
 TOTAL ALK. 95 P.P.M.  
 VOLUME 6974.75 ACRE FT.  
 MAIN SHORELINE 4.5 MI.  
 ISLAND SHORELINE 0 MI.

Source: Wisconsin Department of Natural Resources 608-266-2621  
Roberts Lake – Forest County, Wisconsin DNR Lake Map  
Date – Sep 1975 - Historical Lake Map - Not for Navigation  
A Public Document - Please Identify the Source when using it.