

LAKE SURVEY MAP

B.M. "X" is located top of local regulation sign on North side of public landing on West end of lake.
Assumed Elevation = 100.00'
Water Level = 92.7'

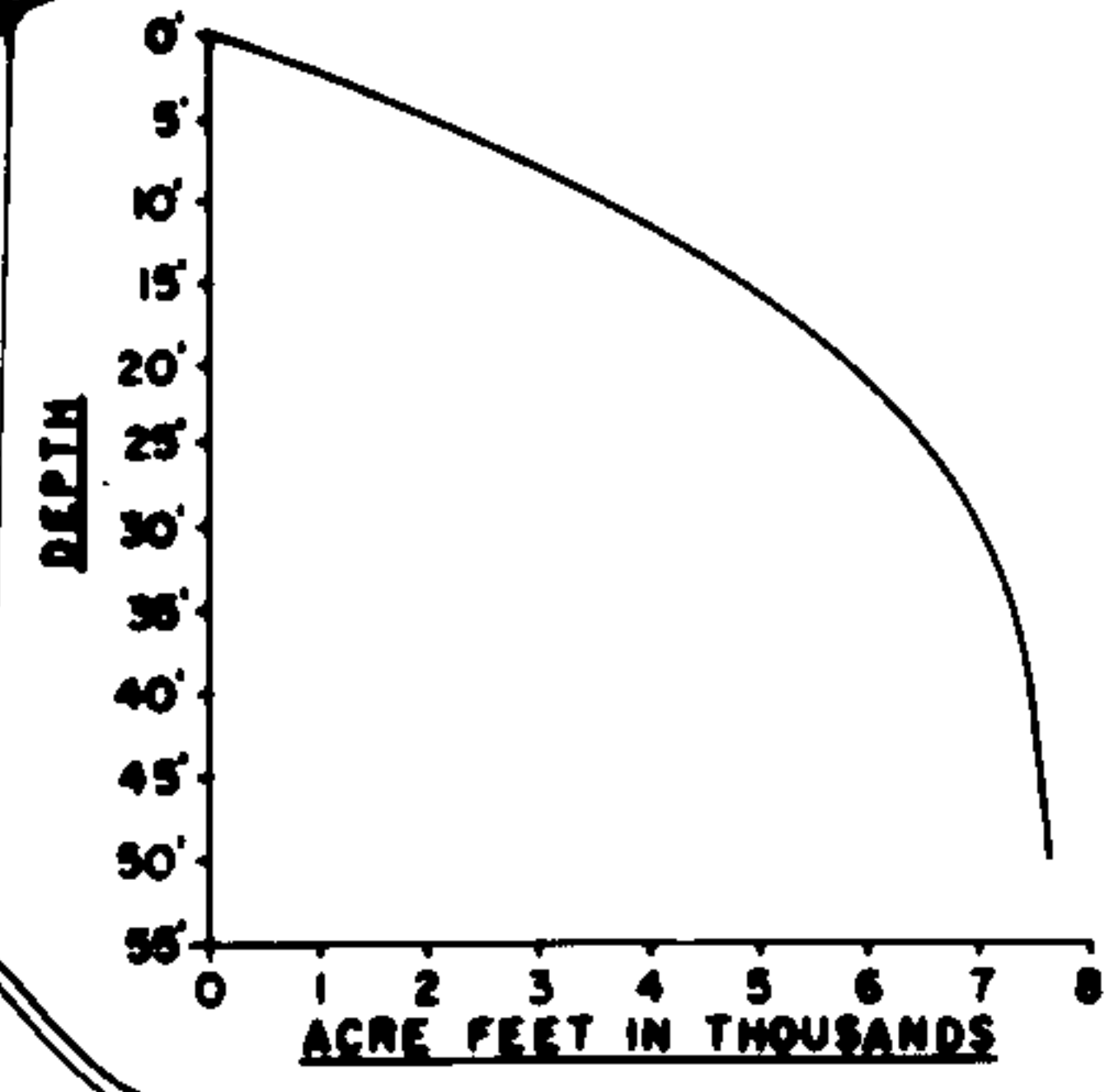
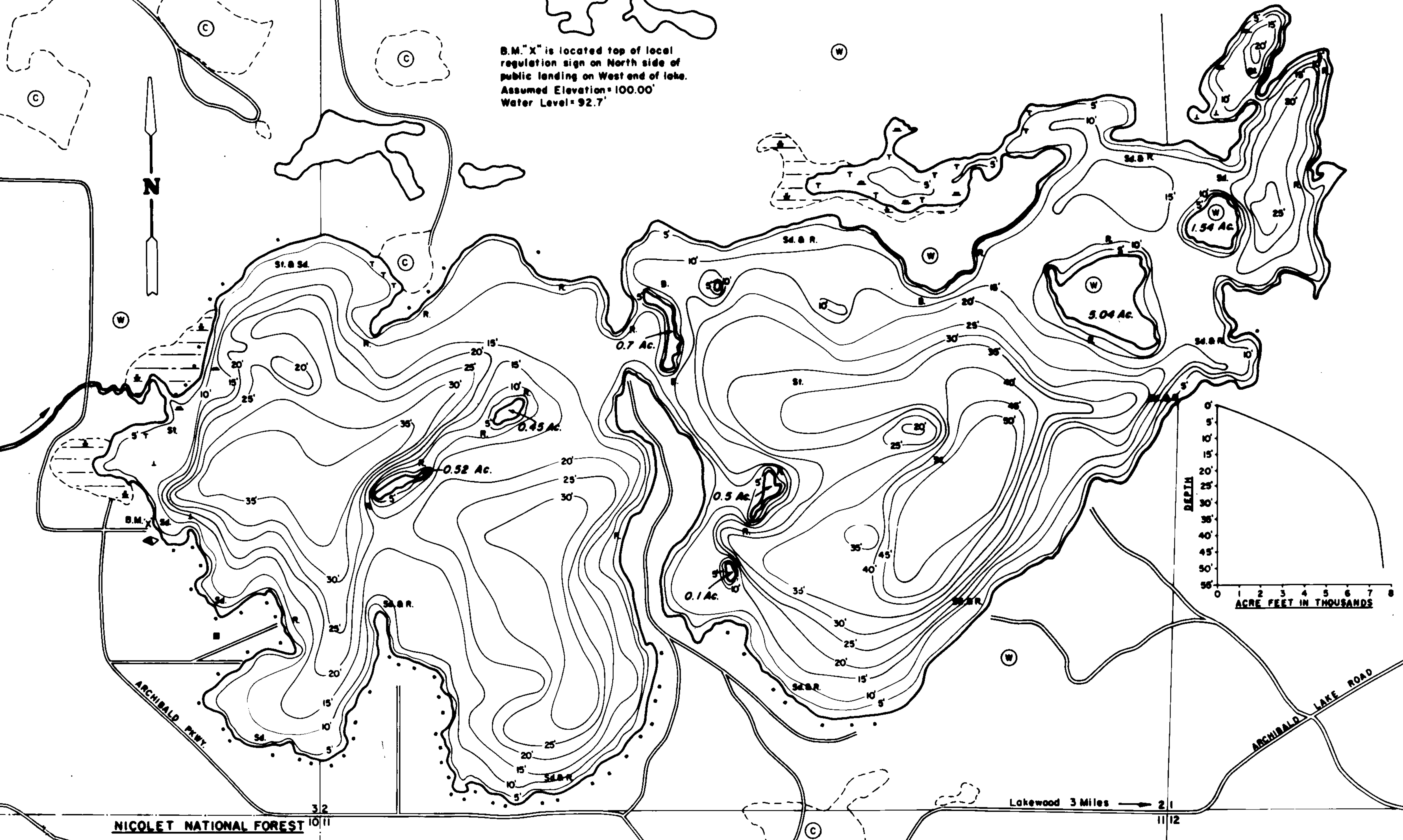

EQUIPMENT RECORDING SONAR MAPPED JUNE 1974

TOPOGRAPHIC SYMBOLS		LAKE BOTTOM SYMBOLS	
(B) Brush	() Steep slope	P. Peat	B. Boulders
(PW) Partially wooded	(---) Indefinite shoreline	Mh. Muck	S. Stumps & Snags
(W) Wooded	(---) Marsh	C. Clay	(X) Rock danger to navigation
(C) Cleared	(---) Spring	M. Marl	T. Submergent vegetation
(P) Pastured	(---) Intermittent stream	Sd. Sand	l. Emergent vegetation
(A) Agricultural	(---) Permanent inlet	St. Silt	F. Floating vegetation
B.M. Bench Mark	(---) Permanent outlet	Gr. Gravel	(---) Brush shelters
(■) Dwelling	(---) Dam	R. Rubble	
(□) Resort	(---) D.N.R. State owned land	Bc. Bedrock	
(□) Camp			

SPECIES OF FISH	Abundance		
	Abundant	Common	Present
Muskie		X	
N. Pine		X	
Walleye		X	
L.M. Bass		X	
S.M. Bass		X	
Panfish		X	
Trout			

WATER AREA 393 ACRES
 UNDER 3 FT. 9.59 %
 OVER 20 FT. 41.73 %
 MAX. DEPTH 50 FEET.
 TOTAL ALK. 85 P.P.M.
 VOLUME 7601.05 ACRE FT.
 MAIN SHORELINE 7.47 MI.
 ISLAND SHORELINE 1.33 MI.



Access Access with Parking Boat Livery
 Drawn by: G. Thuesen
 Field work by: A. Beese, R. Thrus

Source: Wisconsin Department of Natural Resources 608-266-2621
Archibald Lake – Oconto County, Wisconsin DNR Lake Map
Date - Jun 1974 - Historical Lake Map - Not for Navigation
A Public Document - Please Identify the Source when using it.